

MIAMI BEACH

PUBLIC WORKS DEPARTMENT

WASHINGTON AVENUE & 8TH STREET
 INTERACTIVE DIGITAL KIOSK DEPLOYMENT PROJECT
 FEBRUARY 2026
 IKE SMART CITY
MIB-033

CITY OF MIAMI BEACH

MAYOR: STEVEN MEINER

COMMISSIONERS: MONICA MATTEO-SALINAS
 LAURA DOMINGUEZ
 ALEX J. FERNANDEZ
 TANYA K. BHATT
 DAVID SUAREZ
 JOSEPH MAGAZINE

CITY MANAGER: ERIC CARPENTER

CITY ATTORNEY: RICARDO J. DOPICO

PUBLIC WORKS DIRECTOR: JOHN NORRIS

CITY ENGINEER: CRISTINA ORTEGA

SCOPE OF WORK: THE PROJECT CONSISTS OF THE
 INSTALLATION OF ONE (1) DIGITAL INTERACTIVE KIOSK
 AT THE LOCATION INDICATED ON THESE DESIGN PLANS.

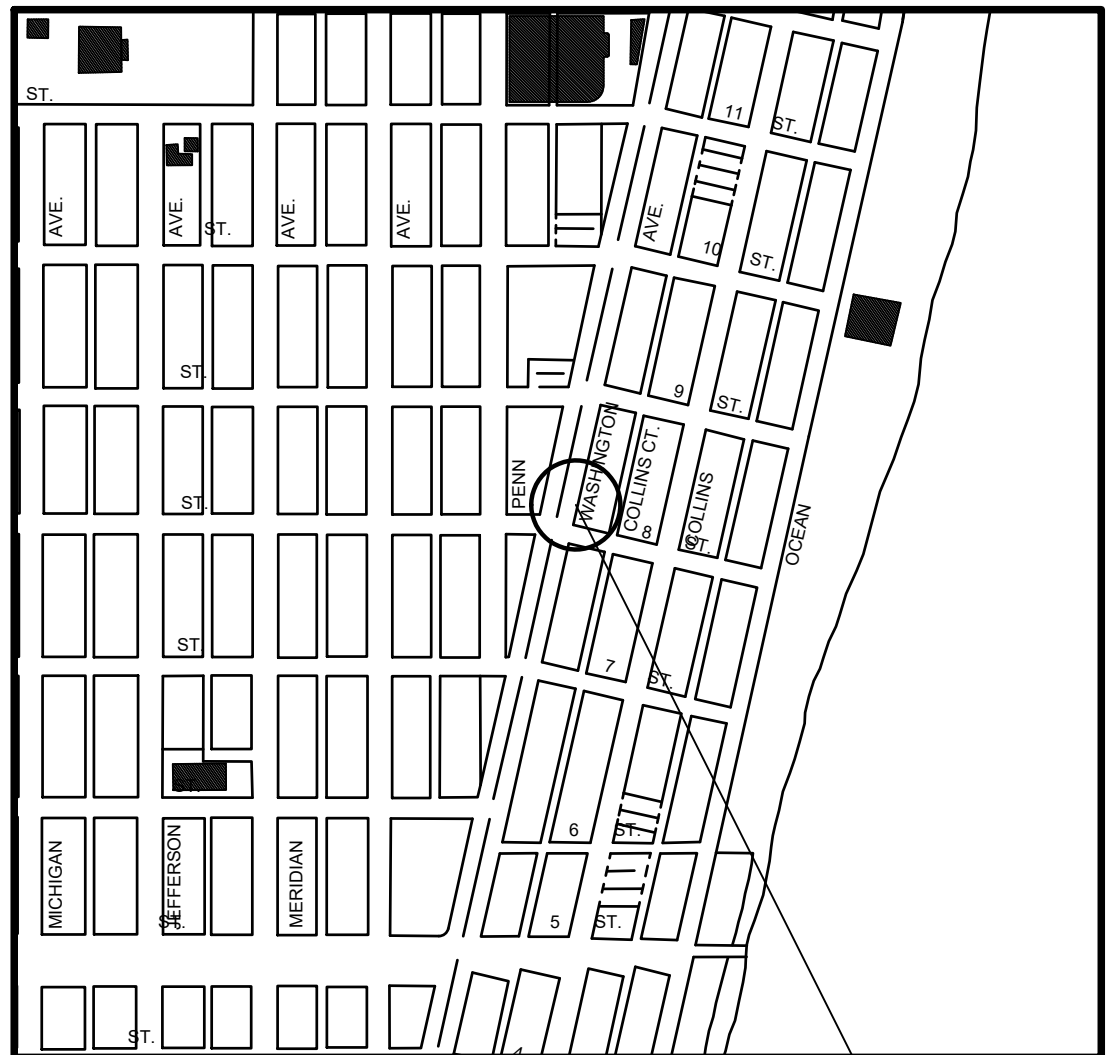

LOCATION MAP

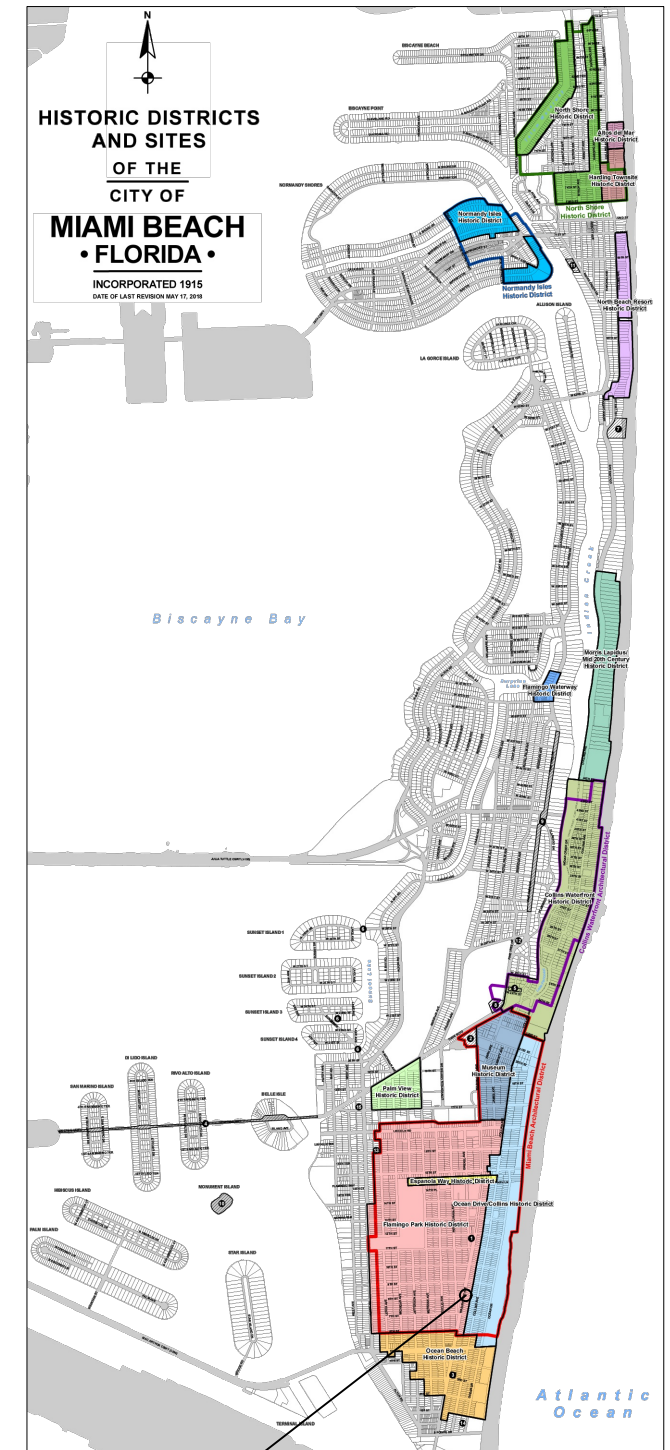

PROJECT LOCATION
 FLAMINGO PARK HISTORIC DISTRICT

ENGINEER OF RECORD: VANESSA A. MELA, P.E. NO. 77676

Work Order _____ Sheet 1 of 5 Drawing **G0-01**

NOTES:

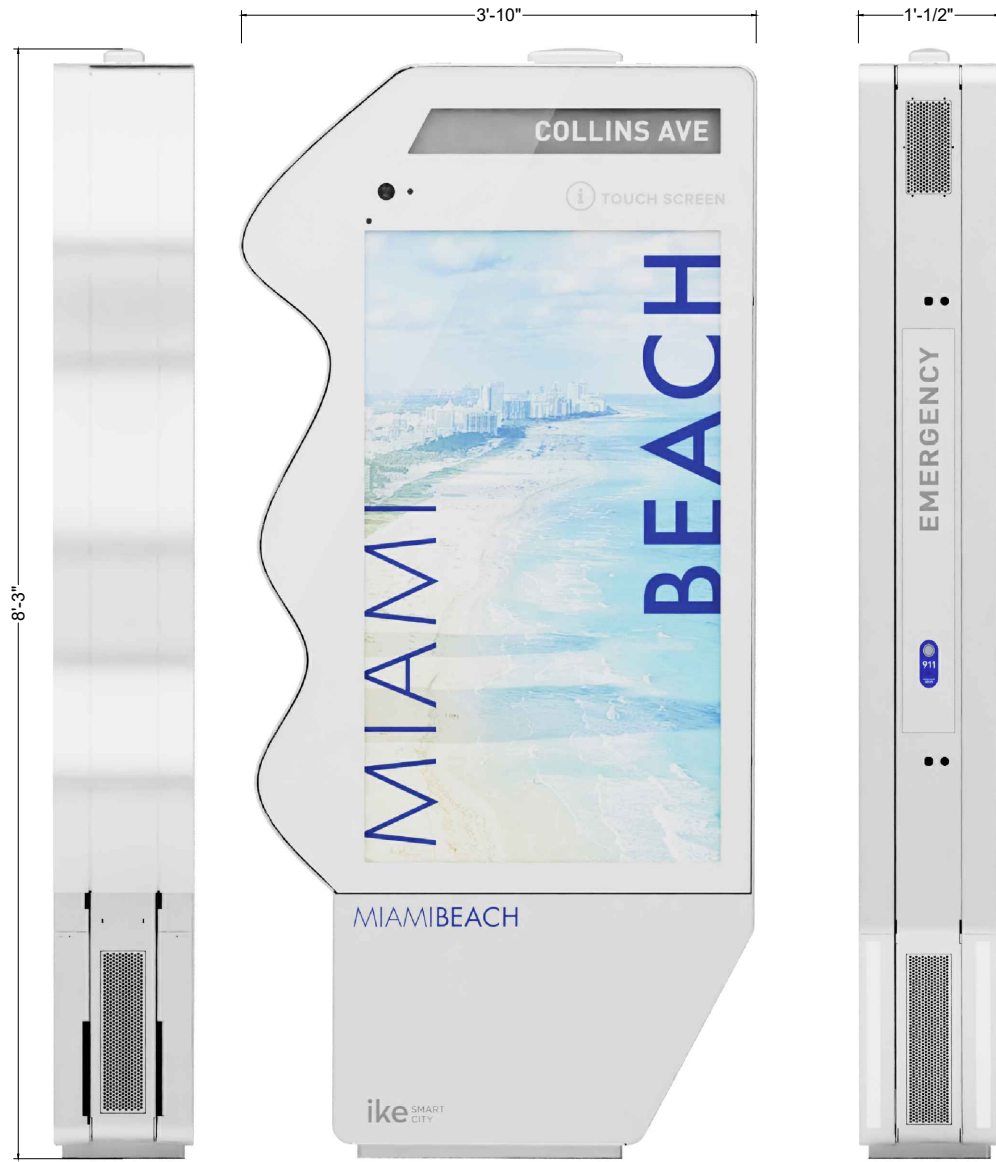

IKE MIAMI BEACH

specification

Dimension	2515.3 x 1166.8 x 317.4 mm 99.03 x 45.94 x 12.44 inch
Glass Color	Neutral_SW7656 Pink_Pantone236C Turquoise_SW6751
Kiosk Powder Coating Color	Pantone 10101C
Kiosk Weight	373 kg 822.32 lbs
Wave Kit Dimension	1858.5 x 348.2 x 316.0 mm 73.17 x 13.71 x 12.44 inch
Wave Kit Weight	17 kg (TBD) 37.47 lbs (TBD)
Total Weight	400 kg (TBD) 881.85 lbs (TBD)

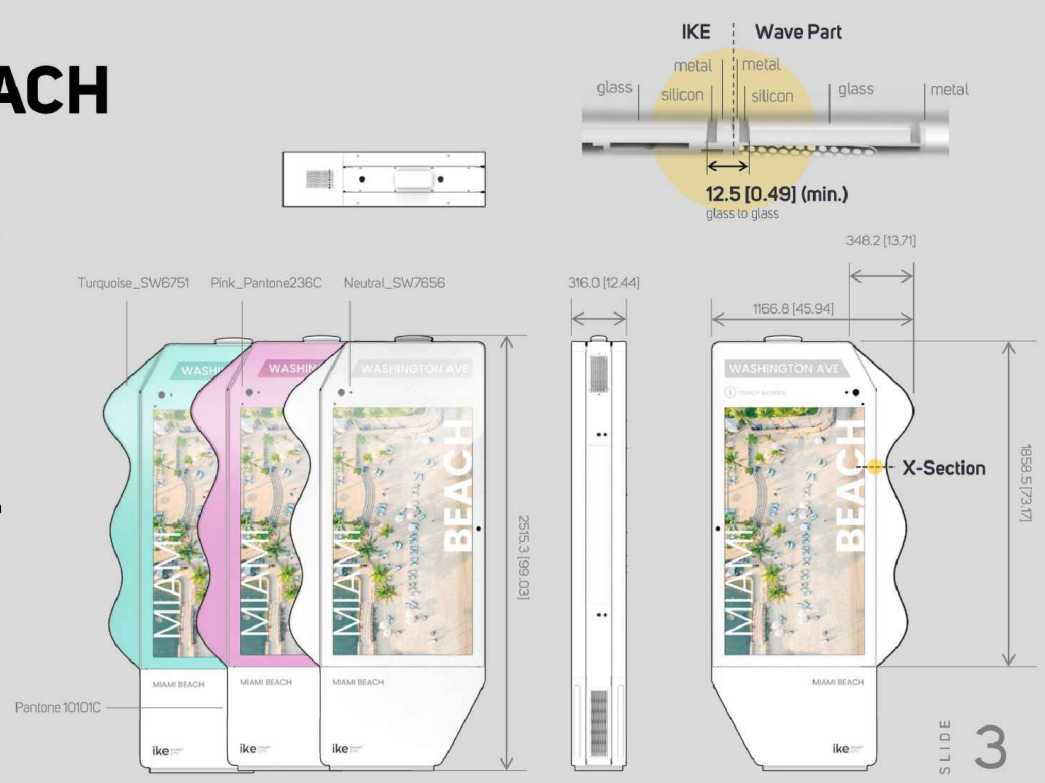

GLASS COLOR: NEUTRAL_SW7656
KIOSK POWDER COATING COLOR: PANTONE 1010C

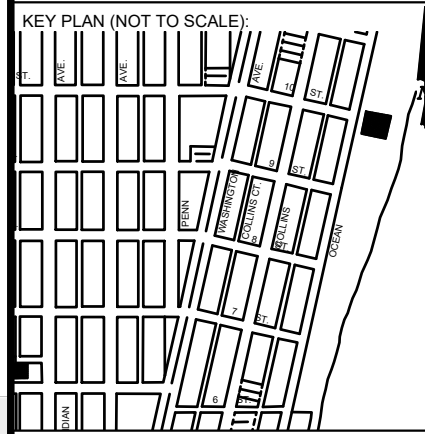

P.E. SEAL:

NO.	DATE	REVISION	APP'D. BY
5			
4			
3			
2			
1			

NOTES:



NORTHBOUND VIEW



SOUTHBOUND VIEW



WESTBOUND VIEW



P.E. SEAL:

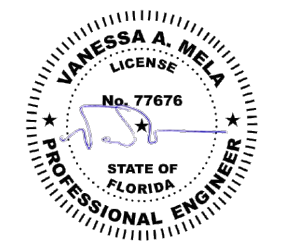

5			
4			
3			
2			
1			
NO.	DATE	REVISION	APP'D. BY



NOTES:

SIDEWALK LEVEL DETAIL

SCALE 1"=5'

NOTE: THIS IS A 2D DETAIL, REFER TO THE ARCHITECTURAL DRAWING FOR ACTUAL DIMENSIONS BETWEEN THE KIOSK AND THE SURROUNDING ELEMENTS

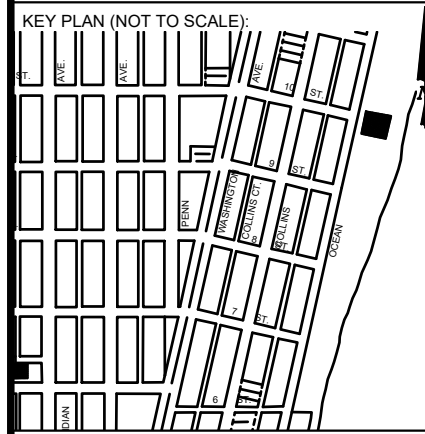
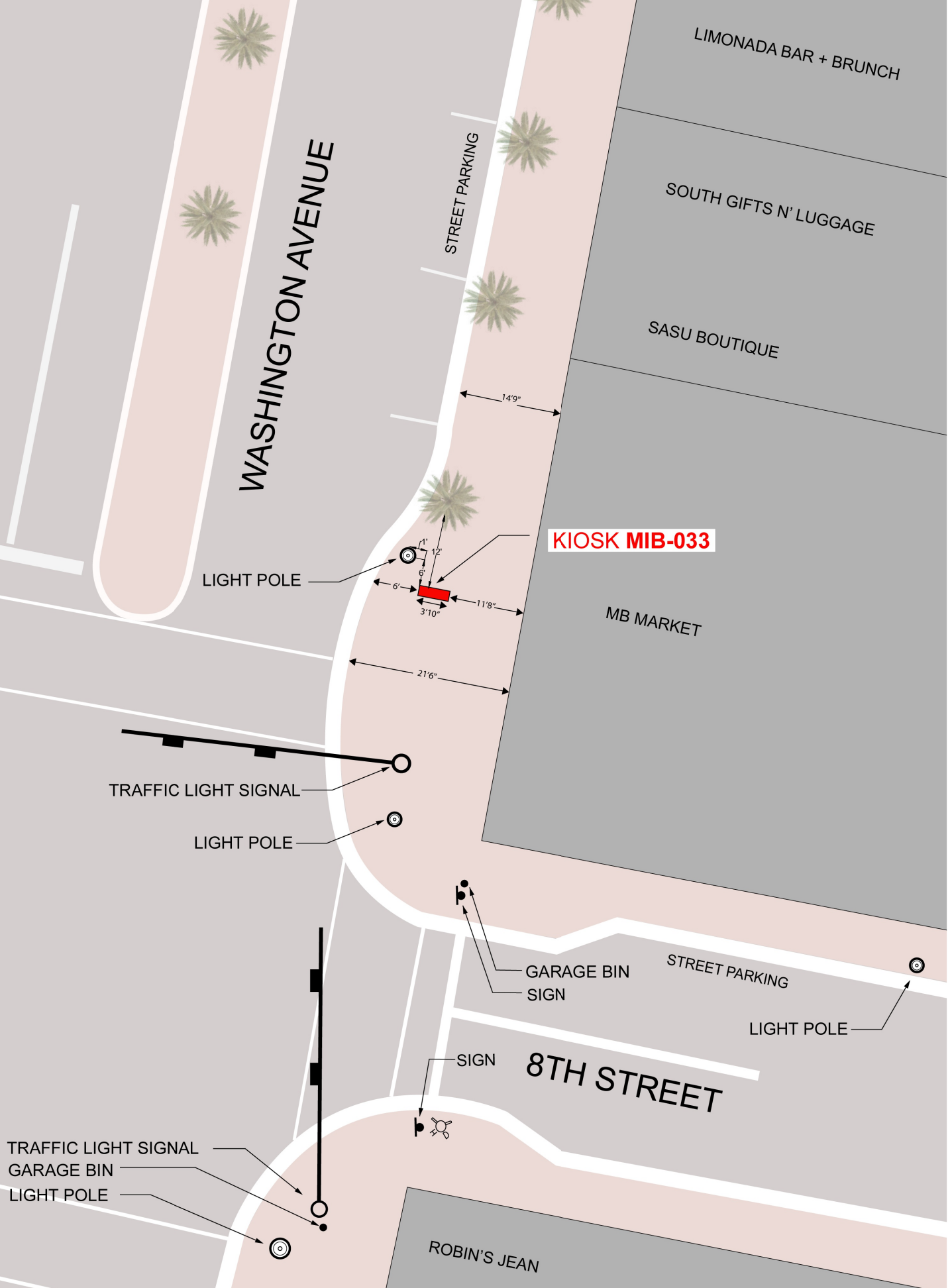
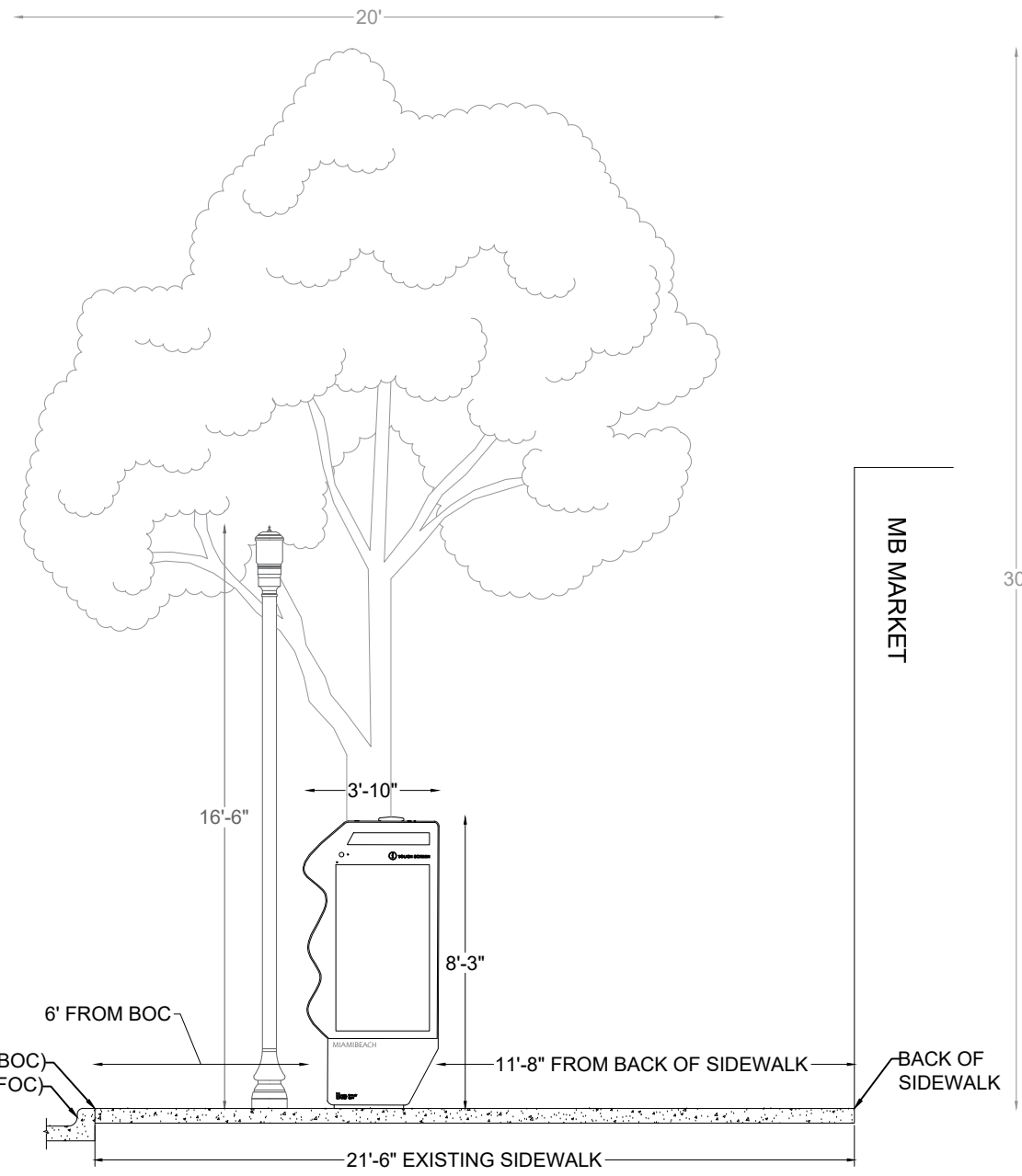

P.E. SEAL:

NO.	DATE	REVISION	APP'D. BY
5			
4			
3			
2			
1			

CLOSEST TRANSIT BUS SHELTER

SCALE 1"-100'

PROXIMITY TO ADJACENT BUILDINGS

SCALE 1"-50'

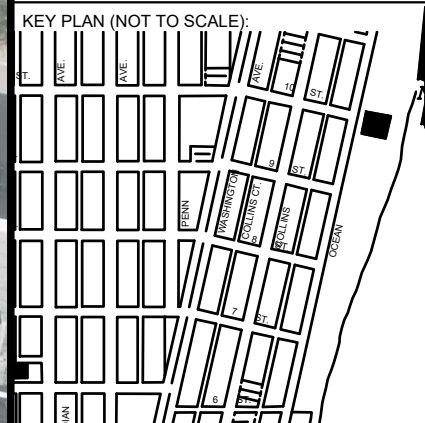

P.E. SEAL:

NO.	DATE	REVISION	APP'D. BY
5			
4			
3			
2			
1			

SPECIFIC PURPOSE SURVEY

MIA - 033

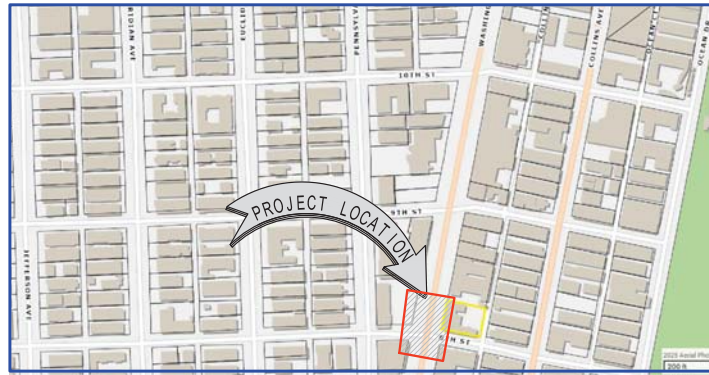

LOCATION MAP

Not to Scale

A portion of Washington Avenue and 8th Street. Right of Way, lying on the said intersection and being in City of Miami Beach, Miami-Dade County, Florida.

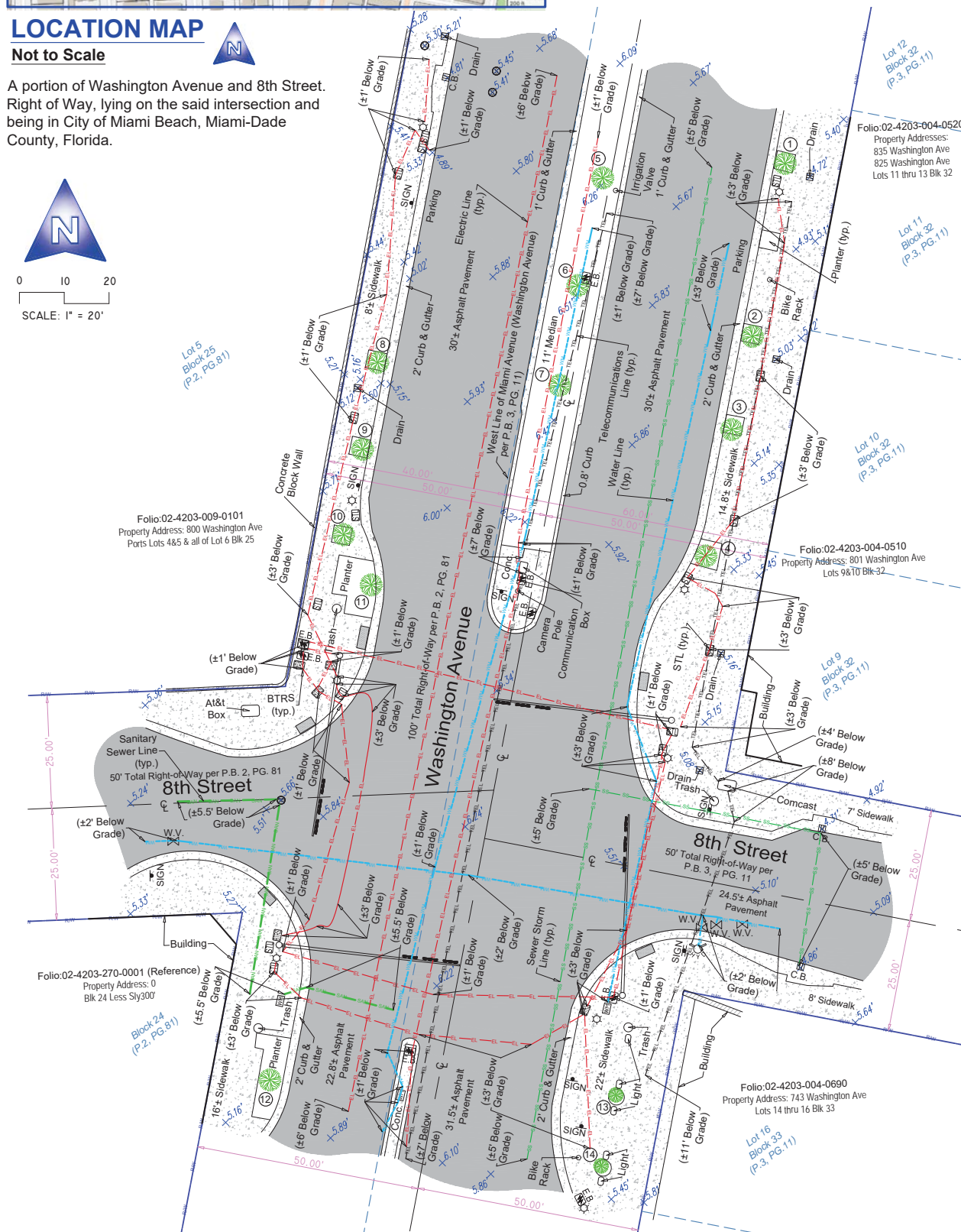
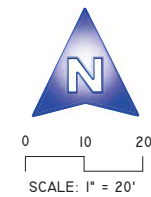

SURVEYOR'S REPORT AND GENERAL NOTES

(Not valid without the attached Survey Map)

- This is not a Boundary Survey.
- These lands are subject to additional restrictions of record that were not furnished to the undersigning registered surveyor. A title search has not been performed by the surveyor.
- North arrow direction is based on an assumed Meridian. Bearings are based on an assumed meridian on a well-established line, said line is being noted as BR on the Survey Map.
- Only above ground improvements are shown herein. Foundations, underground features and utilities have not been located by this surveyor. Refer to SUE effort notes below.
- Survey markers found in the field have no identification unless otherwise shown. Any survey marker set by our company is labeled LB 7262 or PSM 6169.
- This Survey Map is intended to be displayed at the scale shown hereon. Data is expressed in U.S. Survey Foot.
- This Survey Map is being prepared for the use of the party/parties that it is certified to and does not extend to any unnamed individual, entity or assignee.
- FLOODPLAIN INFORMATION:** As scaled from Federal Insurance Rate Map (FIRM) of Community No. 120651 (City of Miami Beach), Panel 0319, Suffix L, revised on Sept 11th, 2009, this real property falls in Zone "AE" with Base Flood Elevation 8 feet (NGVD 1929).
- HORIZONTAL ACCURACY:** Accuracy obtained thru measurements and calculations meets and exceeds the minimum horizontal feature accuracy for a Suburban area being equal to 1 foot in 7,500 feet.
- VERTICAL CONTROL AND ACCURACY:** The elevations as shown are referred to the National Geodetic Vertical Datum of 1929 (NGVD 1929). The closure in feet, as computed, meets the standard of plus or minus 0.05 feet times the squared root of the loop distance in miles. Elevation are based on a level loop from and to the following official Bench Marks:
Bench Mark # 1: City of Miami Beach Bench Mark CMB 8 02 06. Elevation = 5.31 feet (NAVD88)
Bench Mark # 2: Florida Department of Transportation Bench Mark FDOT BM 03. Elevation = 4.74 feet (NAVD88)
Conversion Factor (ACF) from NAVD 1988 to NGVD 1929 datum is (+) 1.56 feet or (minus) 1.56 feet.
- SUE NOTES:**
Subsurface Utility investigation was performed by South Florida Utility Location Services using GPR (Ground Penetrating Radar) and RD (Radiodetection Technology) for designation and location of underground facilities. The horizontal accuracy of this method is +/- 1.5 feet approximately, and is subject to equipment limitations. This Survey depicts the location of the marks indicating the approximate location of the buried pipes and conduits. There might be additional underground facilities not discovered at the time of this survey. Underground utility references as shown on this survey drawing is solely based on information marked on the field by South Florida Utility Location Services for this project. Contact information below:

South Florida Utility Location Services
15323 SW 31st Terrace, Miami, Florida 33185
(786) 547 9086 Office, Email: rogerh@sf-uls.com, Contact Person: Roger Hasbani

Surveyor is not responsible for any errors or omissions that could arise from the information provided. Call 811 or visit www.sunshine811.com before digging.

- = RED PAINT LINE APPARENT ELECTRIC CONDUIT
- = BLUE PAINT LINE APPARENT WATER LINE
- = GREEN PAINT LINE APPARENT SANITARY SEWER LINE
- = RIGHT OF WAY LINE
- = ORANGE PAINT LINE APPARENT COMMUNICATION LINE
- = GREEN PAINT LINE APPARENT STORM SEWER LINE
- = YELLOW PAINT LINE APPARENT GAS LINE

I hereby certify to Main Street Engineering that this Survey conforms to the Standards of Practice as set forth by the Florida Board of Professional Surveyors and Mappers in applicable provisions of Chapter 5J-17, Florida Administrative Code pursuant to Section 472.027 Florida Statutes. This Survey is accurate and correct to the best of my knowledge and belief.

Digitally signed by Odalys C Bello
DN: c=US, o=Bello and Bello Land Surveying Corp., dnQualifier=A01410C000001884E3867E, 8000DD40A, cn=Odalys C Bello

Odalys C. Bello-Iznaga
Professional Surveyor and Mapper LS6169 · State of Florida
Field Work Date: 01/14/2026

LEGEND & ABBREVIATIONS

	= CONCRETE (CONC.)
	= CONCRETE BLOCK WALL
	= WOOD DECK
	= COVERED AREA
	= ASPHALT
	= TILE
	= PAVERS
	= STONE
	= CHAIN LINK FENCE (CLF)
	= WOOD FENCE (WF)
	= IRON METAL BARS FENCE (IF)
	= OVERHEAD WIRES
	= WATER VALVE (WV)
	= POWER POLE (PP)
	= GUY ANCHOR
	= WATER METER (WM)
	= CONC. LIGHT POLE (LP)
	= WELL
	= STREET SIGN
	= SANITARY MANHOLE
	= DRAINAGE MANHOLE
	= MANHOLE
	= FIRE HYDRANT
	= CABLE BOX (CATV)
	= FPL TRANSFORMER
	= CATCH BASIN OR INLET
	= EXISTING ELEVATION
	= PERMANENT REFERENCE MONUMENT (FRM)
	= PROPERTY CORNER
	= PERMANENT CONTROL POINT (PCP)
	= POINT OF TANGENCY
	= POINT OF CURVATURE
	= POINT OF COMPOUND CURVE
	= POINT OF REVERSE CURVE
	= BENCH MARK
	= BEARING REFERENCE
	= TEMPORARY BENCH MARK
	= PROPERTY LINE
	= CENTER LINE
	= MONUMENT LINE
	= BASE LINE
	= FIELD MEASURED
	= PER FLAT
	= PROFESSIONAL SURVEYOR AND MAPPER
	= AIR CONDITIONER PAD
	= ENCROACHMENT
	= FINISHED FLOOR ELEVATION
	= DENOTES PLAT BOOK XX - PAGE XX
	= OFFICIAL RECORD BOOK
	= CONCRETE BLOCK STRUCTURE
	= RIGHT OF WAY
	= ELEVATION
	= SECTION
	= TOWNSHIP
	= RANGE
	= CALCULATED
	= RECORD
	= CITY OF MIAMI MUNICIPAL ATLAS X-X

Additional and deletions to this Survey Map are prohibited. This Survey Map and Report are not valid without the signature and original raised seal or without the authenticated electronic signature and seal of the undersigning Florida licensed Surveyor and Mapper.

Property Address:
801 Washington Avenue Miami Beach, FL 33139 (Reference Only)
Project No. 25381 D.B.: M.G. Page 1 of 1

BELLO & BELLO LAND SURVEYING
LB#7262
12230 SW 131st AVENUE MIAMI FL 33186
P: 305.251.9606 • P: 305.220-2424
e-mail: info@belloland.com • www.belloland.com

