

# PROPOSED

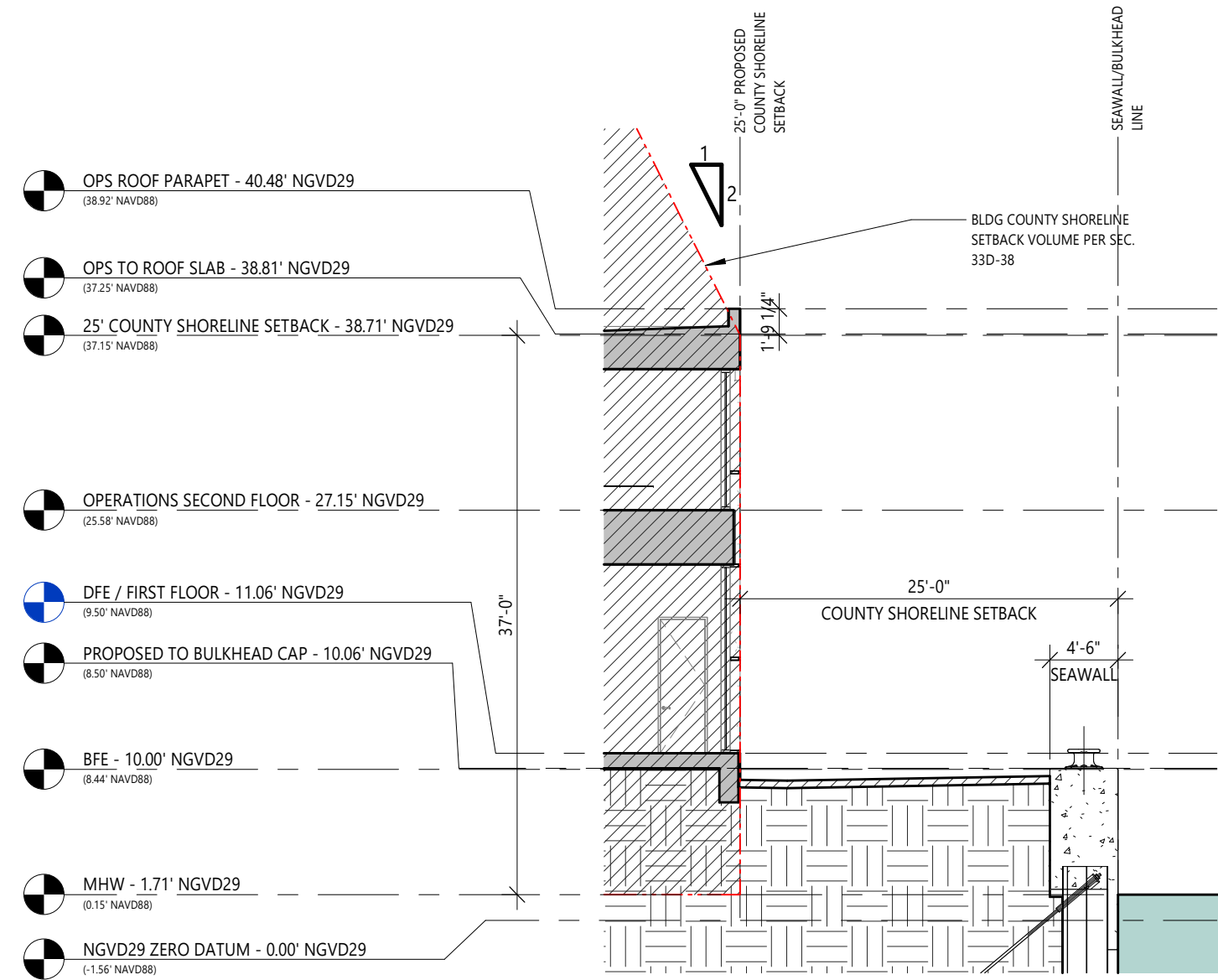
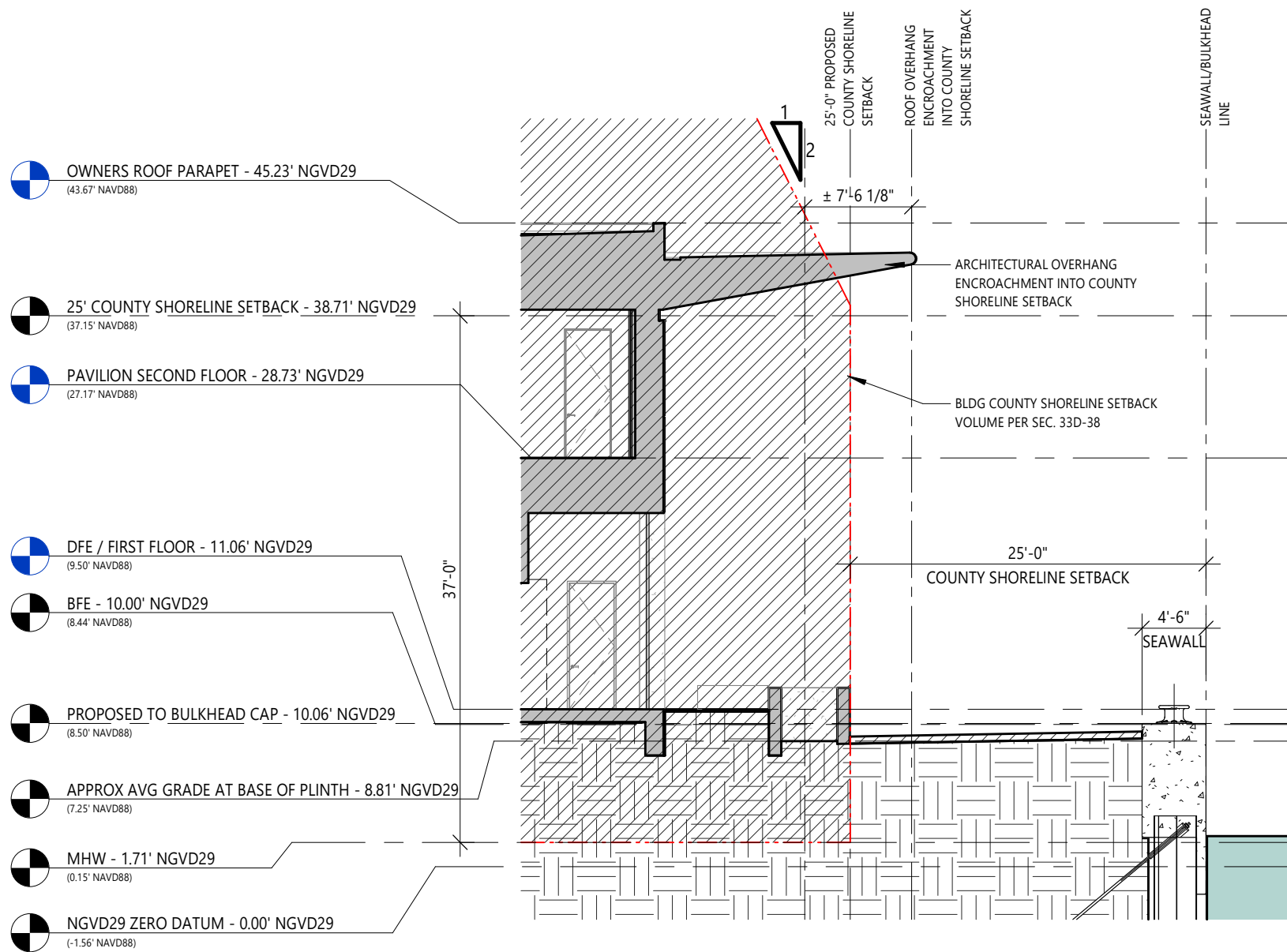

1 OWNERS PAVILION COUNTY SHORELINE SETBACK DIAGRAM  
3/32" = 1'-0"

2 MARINA OPERATIONS COUNTY SHORELINE SETBACK DIAGRAM  
3/32" = 1'-0"

BMA Project No. 2025.05.1

ONE ISLAND PARK



**BMA**  
ARCHITECTS

P: 631.537.7277  
3401 N. Miami Ave, Suite 202 Miami, FL 33127

**Owner's Representative / PM:**  
Coastal Group Marinas  
Holtec Center, 1001 N. US Hwy One,  
Suite 710 Jupiter, FL 33477  
P: 561.385.1429

**Design Architect:**  
Winch Design  
Parklife House, 133 Deodar Road  
London SW15 2NU  
P: +44 (0) 20 8392 8400

**Structural Engineer:**  
TYLin Group  
32 Old Slip 10th and 17th Floors  
New York, NY 10005  
P: 212.228.0662

**Landscape Design Architect:**  
Wirtz International Landscape Architects  
Botermelkdijk 464 2900 Schoten België  
P: +32 (0) 3 680 13 22

**Landscape Architect of Record:**  
Christopher Cawley Landscape Architecture  
7245 NE 4th Ave, Suite 104  
Miami, FL 33138  
P: 786.536.2961

**MEPS Engineer:**  
Hanington Engineering Consultants  
233 Mount Airy Road, Suite 202  
Basking Ridge, NJ 07920  
P: 973.691.0602

**Civil Engineer:**  
Kimley Horn  
2 Alhambra Plaza, Suite 500  
Coral Gables, FL 33134  
P: 305.673.2025

Graphic Scale: 1 inch = 11 feet

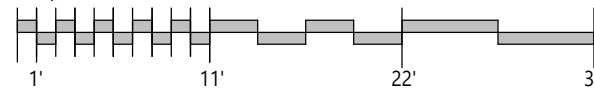

DRB26-1176: 04-03-2026 FINAL SUBMITTAL 04/05/26 COMB  
No. Issue Date To

Scale  
3/32" = 1'-0"  
SHORELINE SETBACKS

DRB26-1176: 04-03-2026  
FINAL SUBMITTAL  
Dwg. no.  
**A71**

Drawn By  
JG

PREVIOUSLY APPROVED

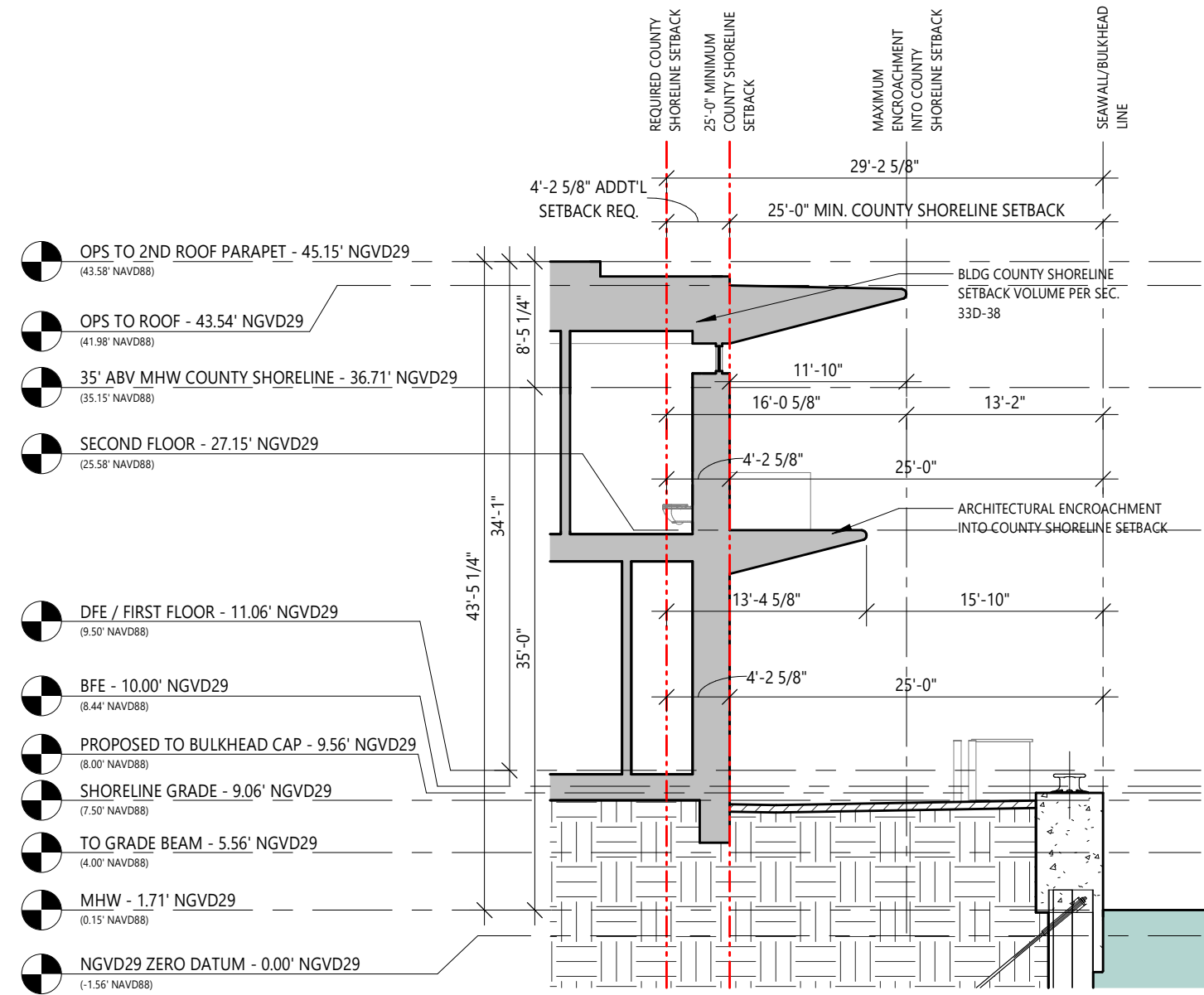
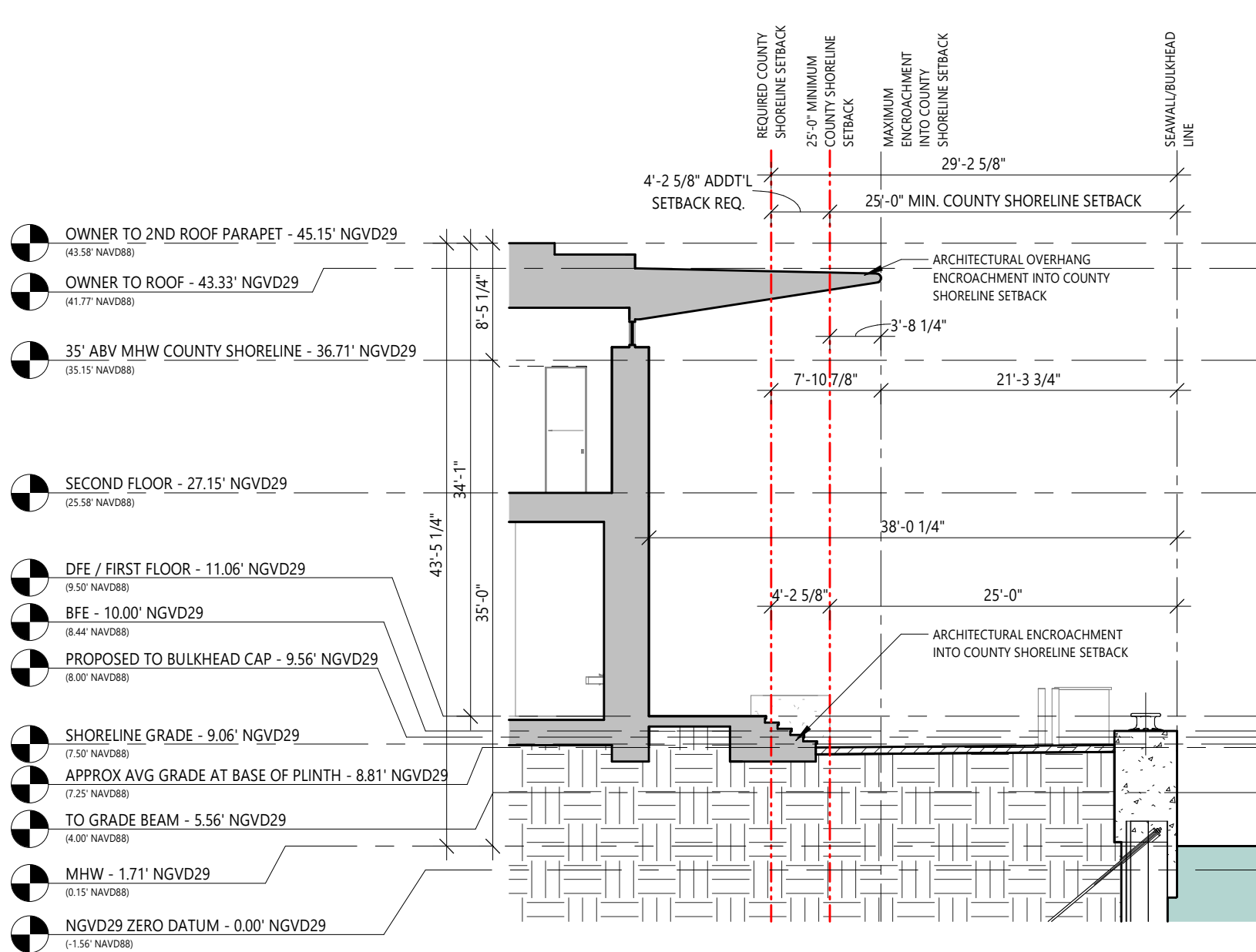

1 OWNERS PAVILION COUNTY SHORELINE SETBACK DIAGRAM  
3/32" = 1'-0"

2 MARINA OPERATIONS COUNTY SHORELINE SETBACK DIAGRAM  
3/32" = 1'-0"

BMA Project No. 2025.05.1

ONE ISLAND PARK  
Blaze Makoid  
MIAMI BEACH, FL

**BMA**  
ARCHITECTS  
P: 786.409.4462  
2200 NW 2nd Ave Miami, FL 33127

**Project Management:**  
Envoie Projects  
220 East 42nd Street, Suite 408  
New York, NY 10017  
P: 646.395.5499

**Owner's Representative / PM:**  
Coastal Group Marinas  
Holtec Center, 1001 N. US Hwy One,  
Suite 710 Jupiter, FL 33477  
P: 561.385.1429

**Design Architect:**  
Winch Design  
Parklife House, 133 Deodar Road  
London SW15 2NU  
P: +44 (0) 20 8392 8400

**Structural Engineer:**  
TYLin Group  
32 Old Slip 10th and 17th Floors  
New York, NY 10005  
P: 212.228.0662

**Landscape Design Architect:**  
Wirtz International Landscape Architects  
Botermelkijk 464 2900 Schoten België  
P: +32 (0) 3 680 13 22

**Landscape Architect of Record:**  
Christopher Cawley Landscape Architecture  
7245 NE 4th Ave, Suite 104  
Miami, FL 33138  
P: 786.536.2961

**MEPS Engineer:**  
Hanington Engineering Consultants  
233 Mount Airy Road, Suite 202  
Basking Ridge, NJ 07920  
P: 973.691.0602

**Civil Engineer:**  
Kimley Horn  
2 Alhambra Plaza, Suite 500  
Coral Gables, FL 33134  
P: 305.673.2025

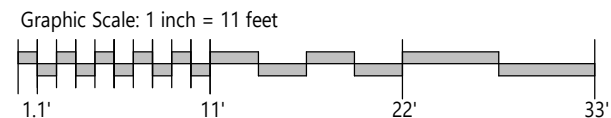

No.	Issue	Date	To
DRB25-1121-09-07-2025	FINAL SUBMITTAL	09/07/2025	MB

Scale  
3/32" = 1'-0"  
SHORELINE SETBACKS

Drawn By  
JG

Dwg. no.  
**A71**

PROPOSED



BMA Project No. 2025.05.1

ONE ISLAND PARK



MIAMI BEACH, FL

**BMA**  
ARCHITECTS

P: 631.537.7277  
3401 N. Miami Ave, Suite 202 Miami, FL 33127

**Owner's Representative / PM:**  
Coastal Group Marinas  
Holtec Center, 1001 N. US Hwy One,  
Suite 710 Jupiter, FL 33477  
P: 561.385.1429

**Design Architect:**  
Winch Design  
Parklife House, 133 Deodar Road  
London SW15 2NU  
P: +44 (0) 20 8392 8400

**Structural Engineer:**  
TYLin Group  
32 Old Slip 10th and 17th Floors  
New York, NY 10005  
P: 212.228.0662

**Landscape Design Architect:**  
Wirtz International Landscape Architects  
Botermelkdijk 464 2900 Schoten België  
P: +32 (0) 3 680 13 22

**Landscape Architect of Record:**  
Christopher Cawley Landscape Architecture  
7245 NE 4th Ave, Suite 104  
Miami, FL 33138  
P: 786.536.2961

**MEPS Engineer:**  
Hanington Engineering Consultants  
233 Mount Airy Road, Suite 202  
Basking Ridge, NJ 07920  
P: 973.691.0602

**Civil Engineer:**  
Kimley Horn  
2 Alhambra Plaza, Suite 500  
Coral Gables, FL 33134  
P: 305.673.2025

DRB26-1176: 04-03-2026 FINAL SUBMITTAL 04/05/26 COMB  
No. Issue Date To

Scale Drawn By  
DH, BG

GATEHOUSE RENDERING

Dwg. no.

A80

PREVIOUSLY APPROVED



BMA Project No. 2025.05.1

ONE ISLAND PARK



MIAMI BEACH, FL



P: 786.409.4462  
2200 NW 2nd Ave Miami, FL 33127

**Project Management:**  
Envoie Projects  
220 East 42nd Street, Suite 408  
New York, NY 10017  
P: 646.395.5499

**Owner's Representative / PM:**  
Coastal Group Marinas  
Holtec Center, 1001 N. US Hwy One,  
Suite 710 Jupiter, FL 33477  
P: 561.385.1429

**Design Architect:**  
Winch Design  
Parklife House, 133 Deodar Road  
London SW15 2NU  
P: +44 (0) 20 8392 8400

**Structural Engineer:**  
TYLin Group  
32 Old Slip 10th and 17th Floors  
New York, NY 10005  
P: 212.228.0662

**Landscape Design Architect:**  
Wirtz International Landscape Architects  
Botermelkdijk 464 2900 Schoten België  
P: +32 (0) 3 680 13 22

**Landscape Architect of Record:**  
Christopher Cawley Landscape Architecture  
7245 NE 4th Ave, Suite 104  
Miami, FL 33138  
P: 786.536.2961

**MEPS Engineer:**  
Hanington Engineering Consultants  
233 Mount Airy Road, Suite 202  
Basking Ridge, NJ 07920  
P: 973.691.0602

**Civil Engineer:**  
Kimley Horn  
2 Alhambra Plaza, Suite 500  
Coral Gables, FL 33134  
P: 305.673.2025

No.	Issue	Date	To
	DRB25-1121: 09-07-2025 FINAL SUBMITTAL	09/07/2025	MB

DRB25-1121: 09-07-2025  
FINAL SUBMITTAL

Scale  
GATEHOUSE ENTRY  
RENDERING

Drawn By  
DH, BG

Dwg. no.  
A80

PROPOSED



BMA Project No. 2025.05.1

ONE ISLAND PARK



MIAMI BEACH, FL

**BMA**  
ARCHITECTS

P: 631.537.7277  
3401 N. Miami Ave, Suite 202 Miami, FL 33127

**Owner's Representative / PM:**  
Coastal Group Marinas  
Holtec Center, 1001 N. US Hwy One,  
Suite 710 Jupiter, FL 33477  
P: 561.385.1429

**Design Architect:**  
Winch Design  
Parklife House, 133 Deodar Road  
London SW15 2NU  
P: +44 (0) 20 8392 8400

**Structural Engineer:**  
TYLin Group  
32 Old Slip 10th and 17th Floors  
New York, NY 10005  
P: 212.228.0662

**Landscape Design Architect:**  
Wirtz International Landscape Architects  
Botermeeldijk 464 2900 Schoten België  
P: +32 (0) 3 680 13 22

**Landscape Architect of Record:**  
Christopher Cawley Landscape Architecture  
7245 NE 4th Ave, Suite 104  
Miami, FL 33138  
P: 786.536.2961

**MEPS Engineer:**  
Hanington Engineering Consultants  
233 Mount Airy Road, Suite 202  
Basking Ridge, NJ 07920  
P: 973.691.0602

**Civil Engineer:**  
Kimley Horn  
2 Alhambra Plaza, Suite 500  
Coral Gables, FL 33134  
P: 305.673.2025

No.	Issue	Date	To
DRB26-1176-04-03-2026	FINAL SUBMITTAL	04/05/26	COMB

Scale  
OPERATIONS RENDERING

Drawn By  
DH, BG  
Dwg. no.  
**A82**



BMA Project No. 2025.05.1

ONE ISLAND PARK



P: 786.409.4462  
2200 NW 2nd Ave Miami, FL 33127

**Project Management:**  
Envoie Projects  
220 East 42nd Street, Suite 408  
New York, NY 10017  
P: 646.395.5499

**Owner's Representative / PM:**  
Coastal Group Marinas  
Holtec Center, 1001 N. US Hwy One,  
Suite 710 Jupiter, FL 33477  
P: 561.385.1429

**Design Architect:**  
Winch Design  
Parklife House, 133 Deodar Road  
London SW15 2NU  
P: +44 (0) 20 8392 8400

**Structural Engineer:**  
TYLin Group  
32 Old Slip 10th and 17th Floors  
New York, NY 10005  
P: 212.228.0662

**Landscape Design Architect:**  
Wirtz International Landscape Architects  
Botermelkdijk 464 2900 Schoten België  
P: +32 (0) 3 680 13 22

**Landscape Architect of Record:**  
Christopher Cawley Landscape Architecture  
7245 NE 4th Ave, Suite 104  
Miami, FL 33138  
P: 786.536.2961

**MEPS Engineer:**  
Hanington Engineering Consultants  
233 Mount Airy Road, Suite 202  
Basking Ridge, NJ 07920  
P: 973.691.0602

**Civil Engineer:**  
Kimley Horn  
2 Alhambra Plaza, Suite 500  
Coral Gables, FL 33134  
P: 305.673.2025

No.	Issue	Date	To
	DRB25-1121: 09-07-2025 FINAL SUBMITTAL	09/07/2025	MB

Scale  
WEST WATERWAY RENDERING

Drawn By  
DH, BG  
Dwg. no.  
A82

DRB25-1121: 09-07-2025  
FINAL SUBMITTAL