

PLANT LIST

PROPOSED PLANT LIST							
SYM	BOTANICAL NAME	COMMON NAME	SPEC	NATIVE	DROUGHT	QTY	
TREES + PALMS							
Rre	<i>Roystonea regia</i>	Florida Royal Palm	45' OA 18" GW 20" CAL	*	*	5	
Bsi	<i>Bursera simaruba</i>	Gumbo Limbo	20' HT 8"-10" DBH	*	*	3	
Tba	<i>Tabebuia bahamensis</i>	Bahama Tabebuia Tree	14'-16' HT OA 4"-6" DBH	*	*	1	
Cer1	<i>Conocarpus erectus var. sericeus</i>	Silver Buttonwood Tree	8'-10' OA STD. 2"-3" DBH	*	*	16	
Cer2	<i>Conocarpus erectus</i>	Green Buttonwood Tree	18" OA 4"-6" DBH Multi w/ Character	*	*	3	
SHRUBS + ACENTS							
PL	<i>Psychotria ligustrifolia</i>	Bahama Coffee	15G		*	27	
SR	<i>Serenoa Repens</i>	Silver Saw Palmetto	25G @ 4' HT	*	*	4	
TF	<i>Tripsacum floridiana</i>	Gamma Grass	7 GAL	*	*	20	
AO	<i>Silver odorata bromeliad</i>	Alcantarea Odorata	30" X 30"		*	9	
HP	<i>Hamelia patens</i>	Firebush	15G		*	56	
CC	<i>Capparis cynophallophora</i>	Jamaican Caper	25G	*	*	25	
CW	<i>Carapa guianensis</i>	Crabwood	25G	*	*	27	
CG	<i>Clusia guttifera Hedge</i>	Small Leaf Clusia	25G	*	*	88	
DS	<i>Dioon spinulosum</i>	Giant Dioon	4' HT	*	*	1	
FK	<i>Pennisetum fakahatchee</i>	Fakahatchee Grass	7G	*	*	2	
ZF	<i>Zamia Floridana</i>	Coontie Palm	15G	*	*	4	
ZP	<i>Zamia pumila</i>	Coontie Palm	15G	*	*	33	
GROUNDCOVERS							
EL	<i>Emodea littoralis</i>	Golden Creeper	1 GAL @ 18" OC	*	*	54	
TD	<i>Tripsacum floridiana</i>	Gamma Grass	3 GAL @ 36" OC	*	*	452	
AG	<i>Perennial Peanut</i>	Wild Peanut	1 GAL @ 18" OC	*	*	1430	
CM	<i>Carissa</i>	Emerald Blanket	3 GAL @ 24" OC	*	*	165	
BM	<i>Philodendron</i>	Burle Marx	3 GAL @ 24" OC	*	*	116	
ZP	<i>Zamia pumila</i>	Coontie	3 GAL @ 24" OC	*	*	70	
SOD	<i>Empire Zoysia</i>		3,084 SF				

LANDSCAPE LEGEND

Transect Zone CD-1 Lot Area: 46,845.00 Acres: 1.080 **REQUIRED/ ALLOWED** **PROVIDED**

TREES
A. Number of trees required per net lot acre, less existing number of trees
 meeting minimum requirements =
 22 trees x 1.080 net lot acres - number of existing trees (19) = **5** **23**

B. % Natives required: Number of trees provided x 30% =
 23 x .30 = 7 Native Trees required **7** **22**

C. % Drought tolerant and low maintenance:
 Number of trees provided x 50% =
 22 x .5 = 11 Drought & Low Maintenance Trees required **11** **22**

D. Street Trees (maximum average spacing of 20' o.c.):
 237 linear feet along street / 20 =
 237 / 20 = 12 Street Trees required. **12** **12**

E. Street trees located directly beneath power lines: (maximum average spacing of 20' o.c.):
 linear feet along street / 20 = **N/A** **N/A**

SHRUBS
A. Number of shrubs required: Number of trees required x 12 =
 5 X 12 = 216 Shrubs required **60** **296**

B. % Native shrubs required: Number of shrubs provided x 30% =
 296 X .30 = Native shrubs required **89** **115**

GENERAL PLANTING NOTES

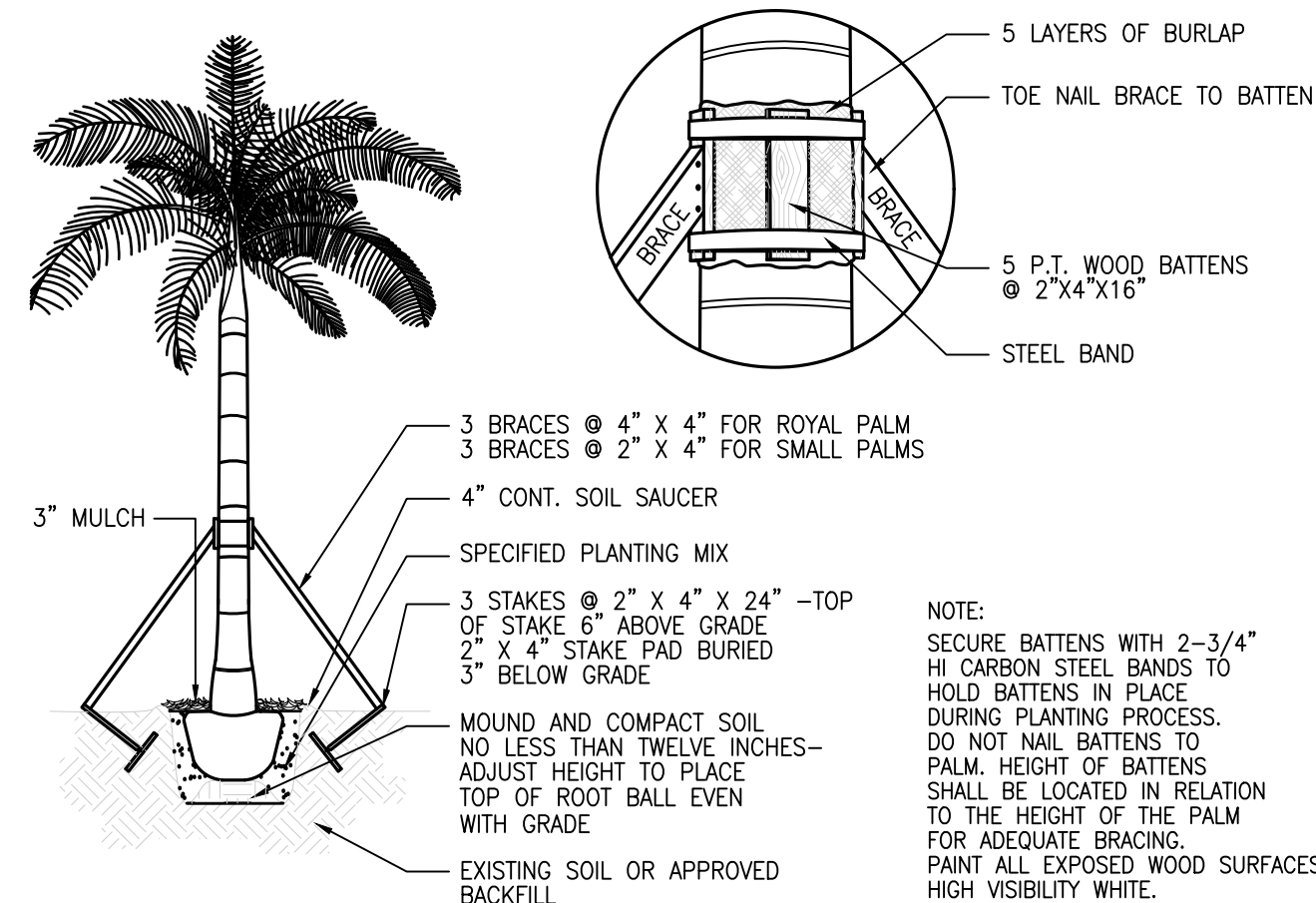
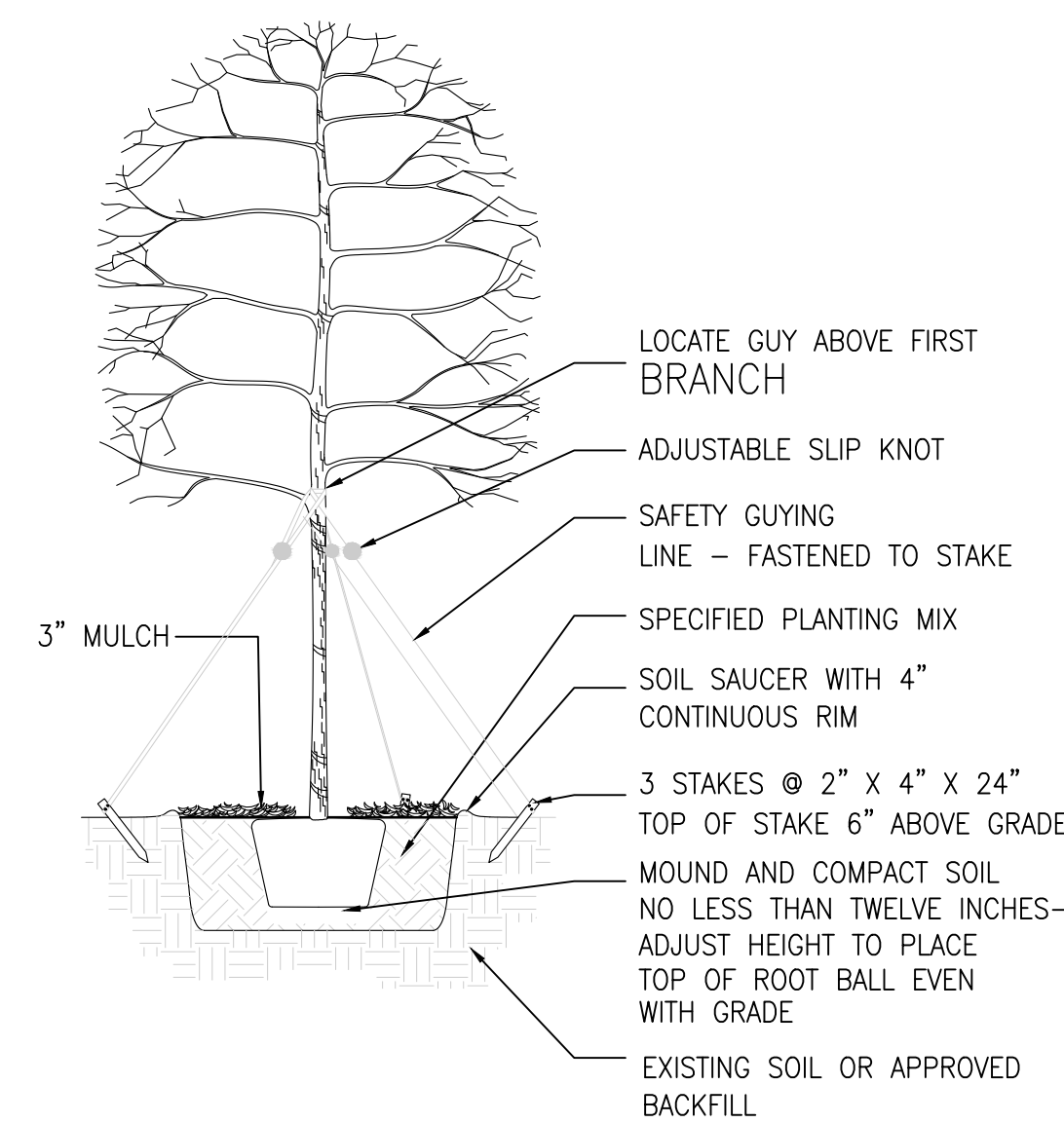
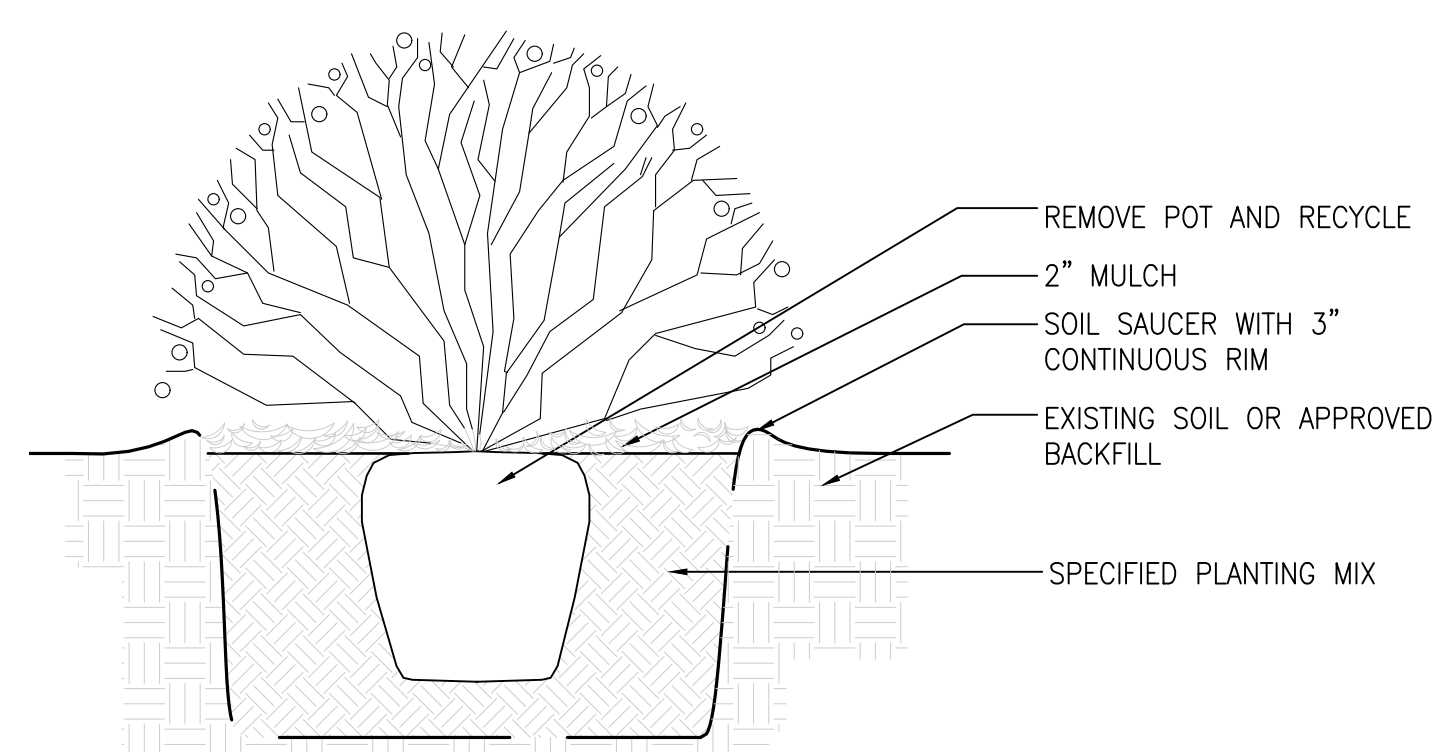

EXIST. BLDG LEVEL 1: OFFICE 9,000 SF
 EXIST. BLDG LEVEL 2: OFFICE 12,291 SF
 4,215 SF / 300 SF / SPACE: 14.05 SP
 6,660 SF / 300 SF / SPACE: 22.20 SP
 12,291 SF / 400 SF / SPACE: 30.72 SP
 TOTAL PARKING REQ'D: 66.97 SP
 67 SP

EXISTING PARKING PROVIDED: 55 SP
 PARKING PROVIDED: 53 SP
 (2 EXISTING SP ALLOCATED FOR CARPOOL)
 PARKING DEFICIENCY 14 SP

PARKING REDUCTION:
 30 LONG TERM BICYCLE SPACES 6 SP
 10 LONG TERM BICYCLE SPACES 1 SP
 2 VANPOOL/CARPOOL SPACES 6 SP
 2 DROP-OFF/LOADING ZONE SPACES 6 SP
 4 MOTORCYCLE SPACES 1 SP

REDUCED PARKING REQ'D: 47 SP
 PARKING SURPLUS: 6 SP

NOTE: LED LIGHTING POSTS TO REDUCE LIGHT POLLUTION AND PROVIDE LIGHTING SECURITY.

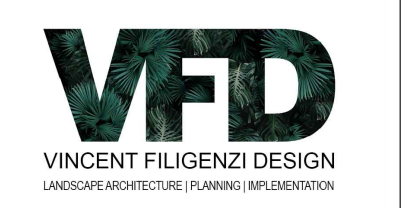
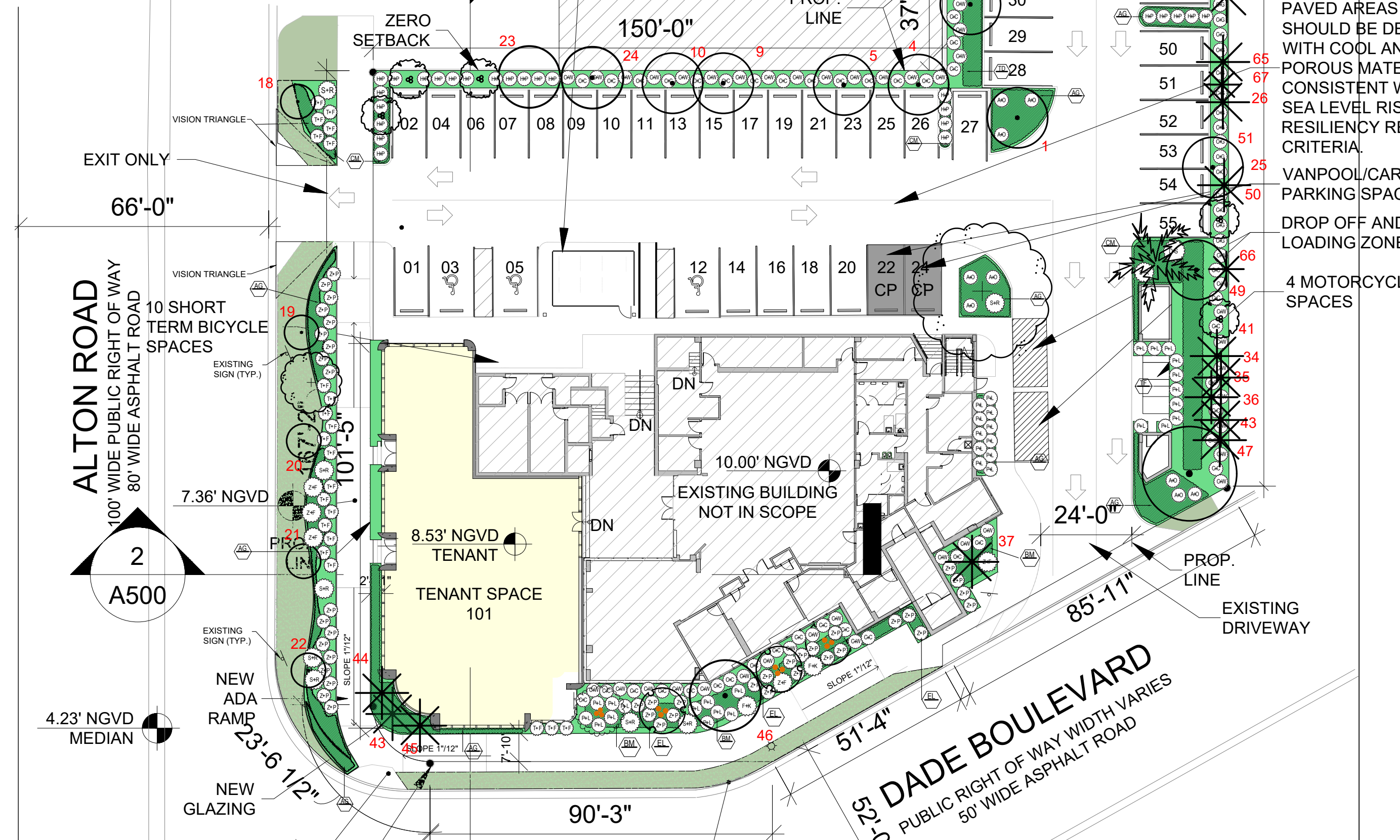

LANDSCAPE ARCHITECT
 FL RLA LIC #6687191
 9822 NE 2ND AVE SUITE #10
 MIAMI SHORES, FL 33138
 P. 786.348.8909
 www.VincentFiligenzi.com

PROFESSIONAL SEAL:

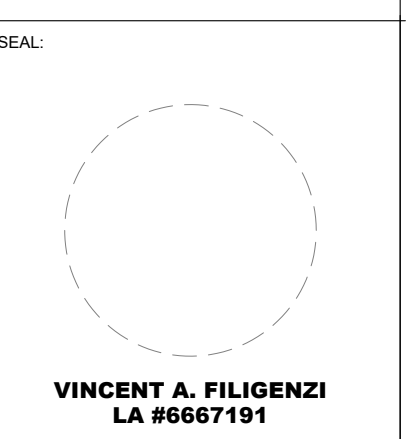

NOTE:
 These architectural drawings and plans
 architect VFD INC. These drawings and
 plans shall not be reproduced for use by
 any individual or entity or any other
 project without express written
 permission.

2ND LEVEL COMMERCIAL
 TENANT IMPROVEMENT
 1801 ALTON ROAD
 MIAMI BEACH, FLORIDA 33139

SHEET ISSUE:	REV #	DATE	DESCRIPTION

PLANT LIST

PROPOSED PLANT LIST						
SYM	BOTANICAL NAME	COMMON NAME	SPEC	NATIVE	DROUGHT	QTY
GROUNDCOVERS						
EL	<i>Erodea littoralis</i>	Golden Creeper	1 GAL @ 18" OC	*	*	1090
MULCH						
	Mulch	Pine Straw	1744 SQ FEET			

PLANT SYMBOL

 GOLDEN CREEPER

 GENERAL PLANTING AREA

 PLANTING BED

GREEN ROOF COVERAGE

NEW ROOF
1,698 SF

GREEN ROOF
1,698 SF

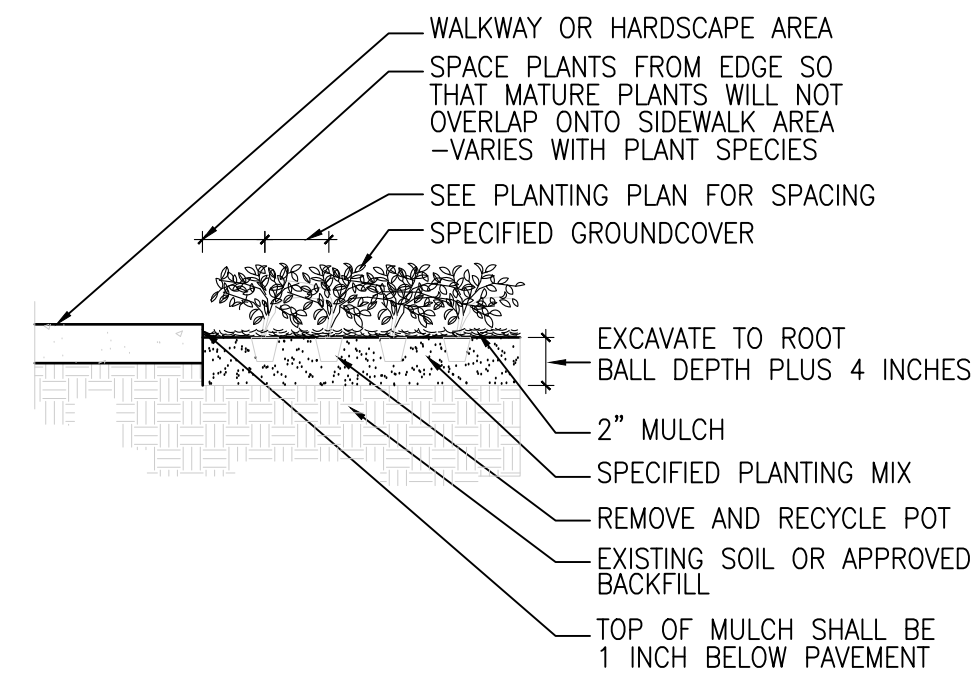

GROUNDCOVER EDGE PLANTING CONDITION
SCALE: N.T.S.

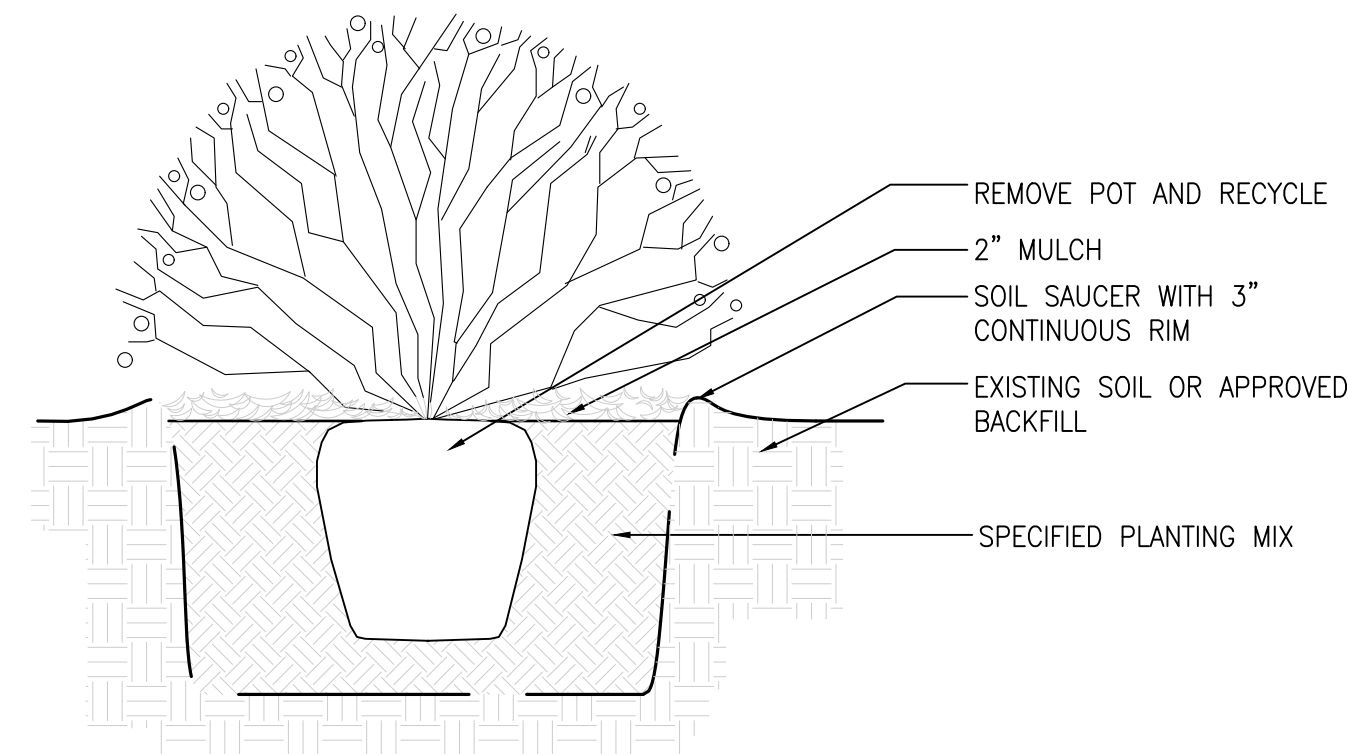

TYP SHRUB PLANTING DETAIL
SCALE: N.T.S.

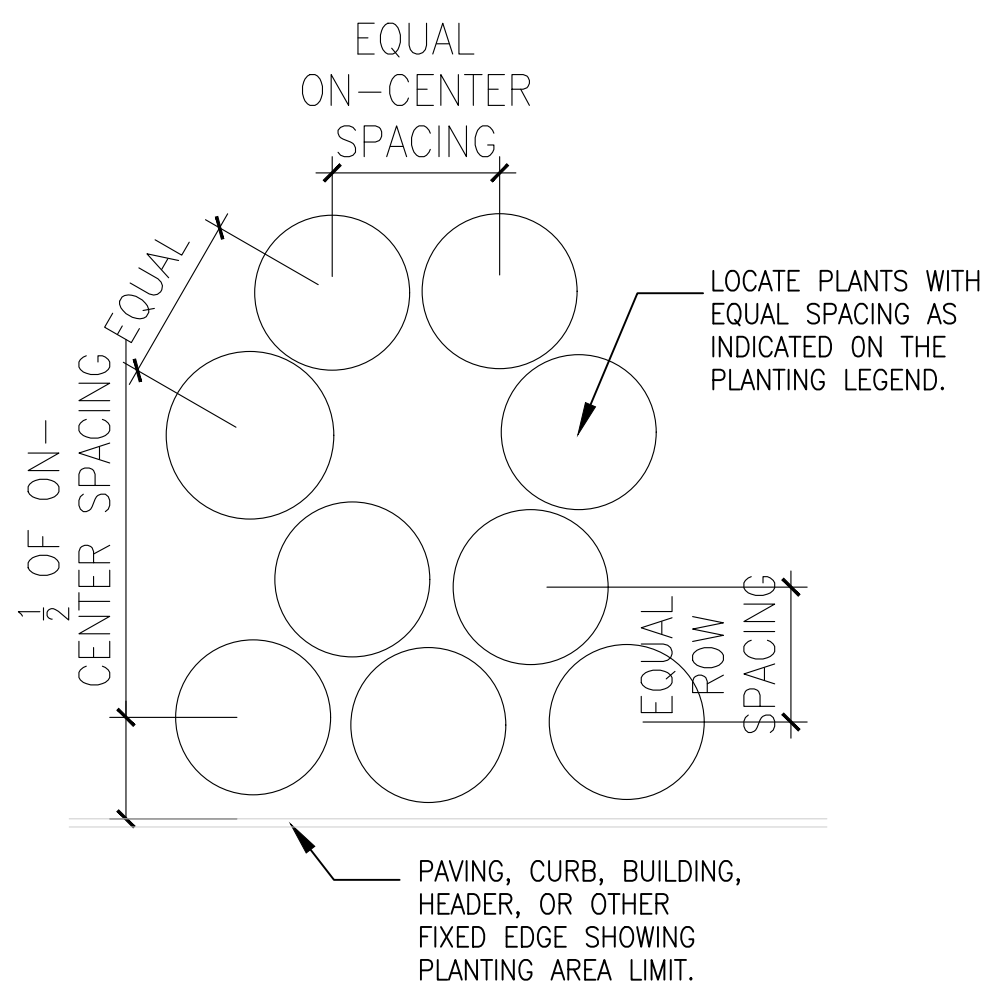

TYP SHRUB SPACING DETAIL

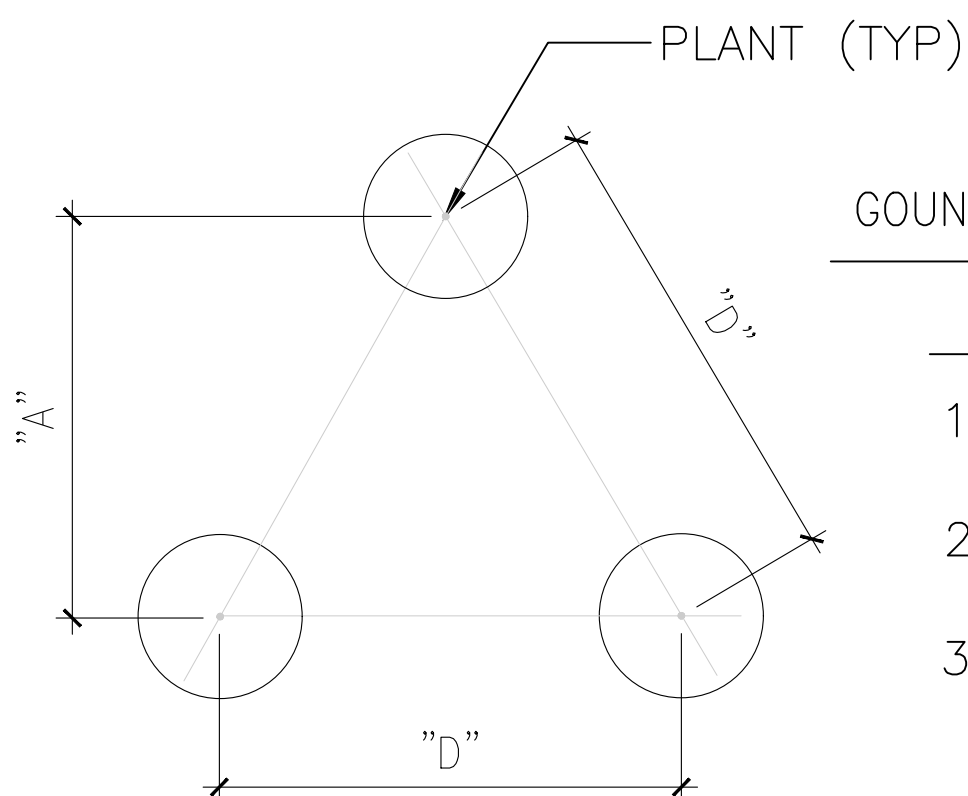

GROUNDCOVER & PERENNIAL SPACING

"D"	"A"
18" O.C.	15" O.C.
24" O.C.	21" O.C.
36" O.C.	31" O.C.

TYP TRIANGULAR PLANT SPACING CHART FOR GROUNDCOVERS
SCALE: N.T.S.

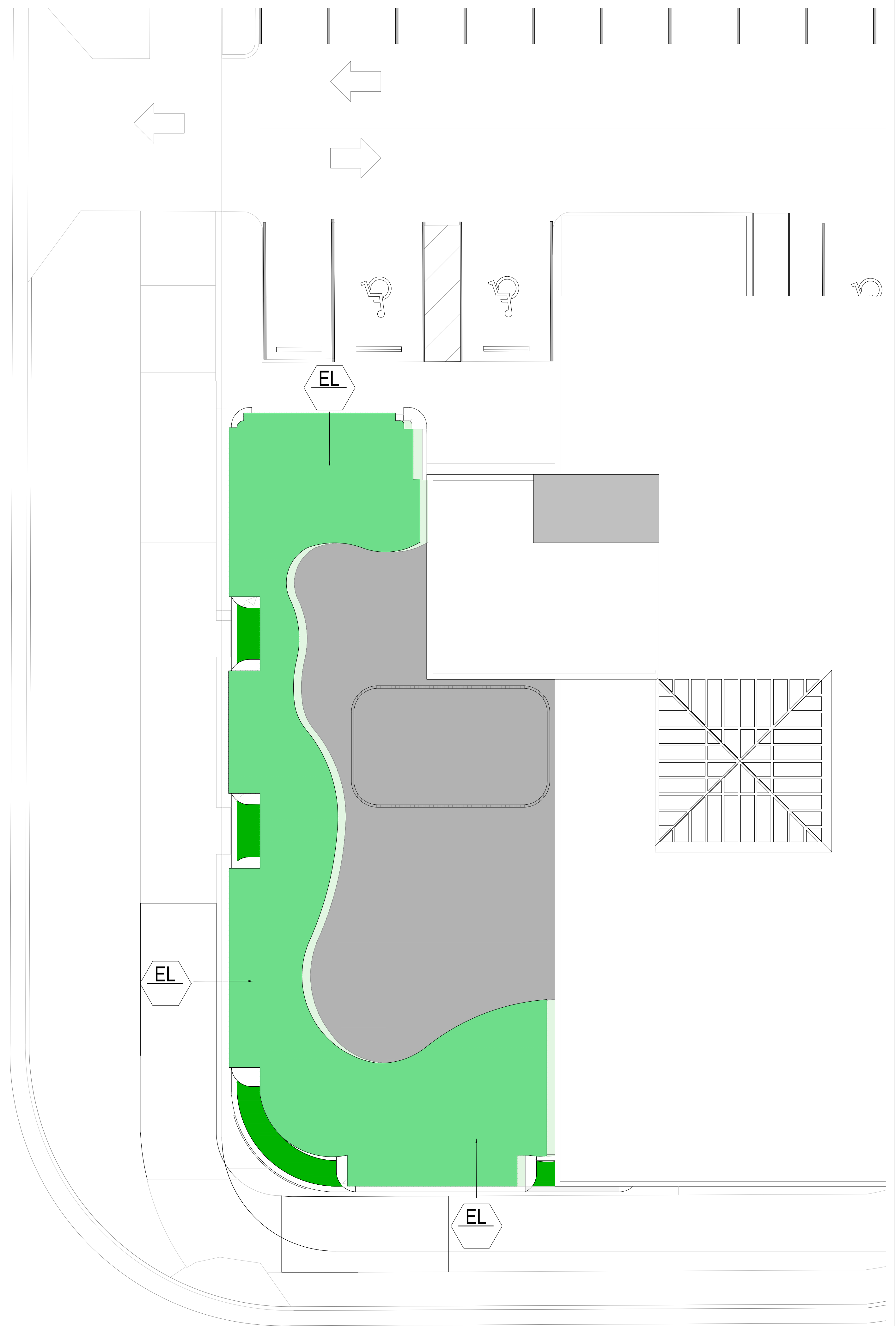

OVERALL ROOFTOP PLAN
Scale: 1/8" = 1'-0"



LANDSCAPE ARCHITECT
FL RLA LIC #6667191
9822 NE 2ND AVE SUITE #10
MIAMI SHORES, FL 33138
P. 786.346.8909
www.VincentFiligenzi.com

PROFESSIONAL SEAL:

SEAL:

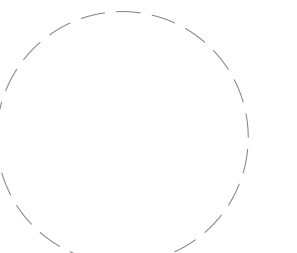

VINCENT A. FILIGENZI
LA #6667191

NOTE:
These architectural drawings and plans are the property of Vincent Filigenzi Design, VFD INC. These drawings and plans shall not be reproduced for use by any individual or entity or any other project without the express written permission.

2ND LEVEL COMMERCIAL
TENANT IMPROVEMENT
1801 ALTON ROAD
MIAMI BEACH, FLORIDA 33139

SHEET ISSUE:	REV #	DATE	DESCRIPTION

DRAWN BY: SJ
CHECKED BY: VF
DATE: 09.12.2024

DISCIPLINE / SHEET TITLE:

ROOFTOP
PLAN

SHEET NUMBER:

LP-1.2