

4-6-25 Design Review Board Final Submittal

DRB24-1059

1425 Marseille Dr

Residential

1425 Marseille Dr, Miami Beach, FL 33141

DRAWING INDEX

Sheet No.	Sheet Title
L-101	TREE DISPOSITION PLAN
L-102	LANDSCAPE PLAN
L-102.1	LANDSCAPE PLAN (RENDERED)
L-102.2	LANDSCAPE PLAN (1st FLOOR)
L-102.3	LANDSCAPE PLAN (2nd FLOOR)
L-103	LANDSCAPE DETAILS AND NOTES
L-104	PLANT MATERIAL

PARAMETRIKA LAND & DESIGN
Gabriela Alborno
Valeria Quintanilla LA6667640



1425 Marseille Dr
1425 Marseille Dr
Miami Beach, FL 33141

Rev #3: 04/05/2025

SHEET TITLE
Cover sheet

ISSUE DATE
03/30/2024

REVISION
March, 2024

DESIGN
GA

DRAWN
TY

SCALE

SEAL
VALERIA QUINTANILLA
LA6667640

SHEET NUMBER



MARSEILLE DR.
(70'-0" RIGHT OF WAY)

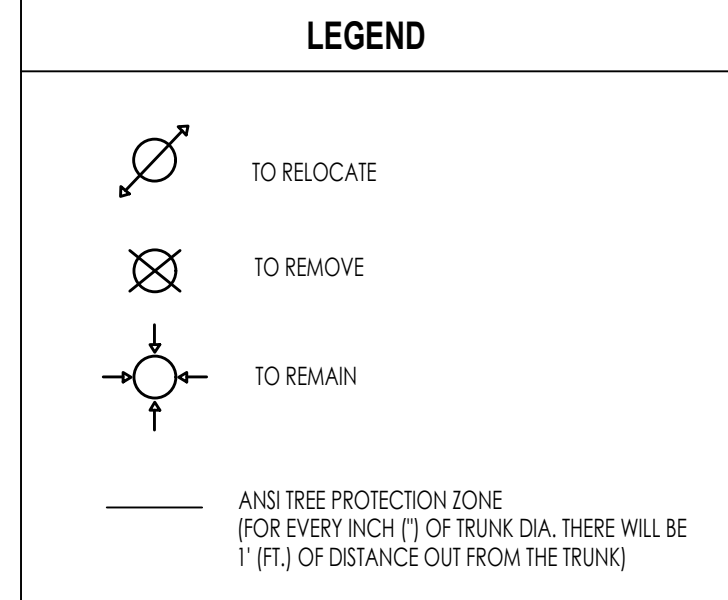
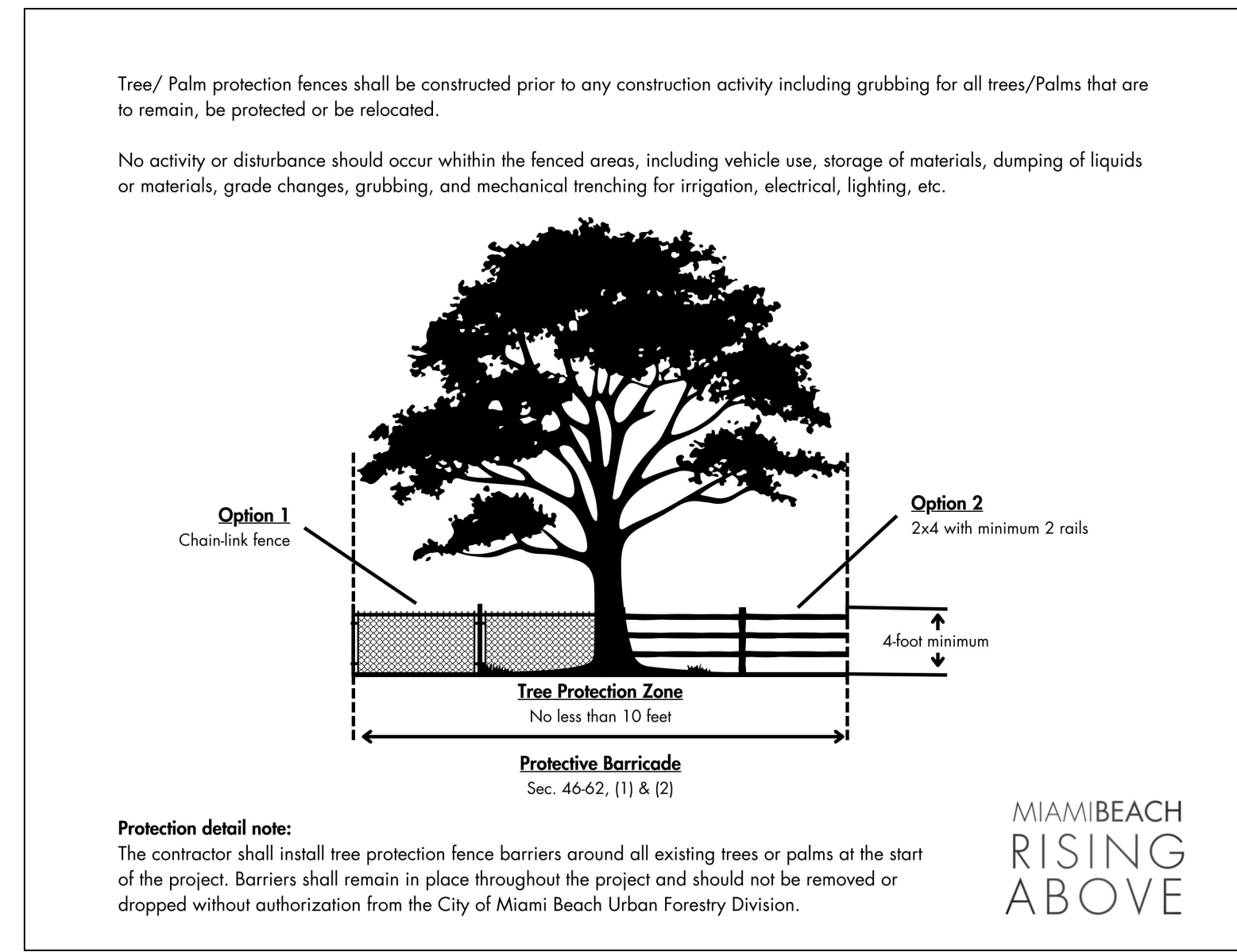
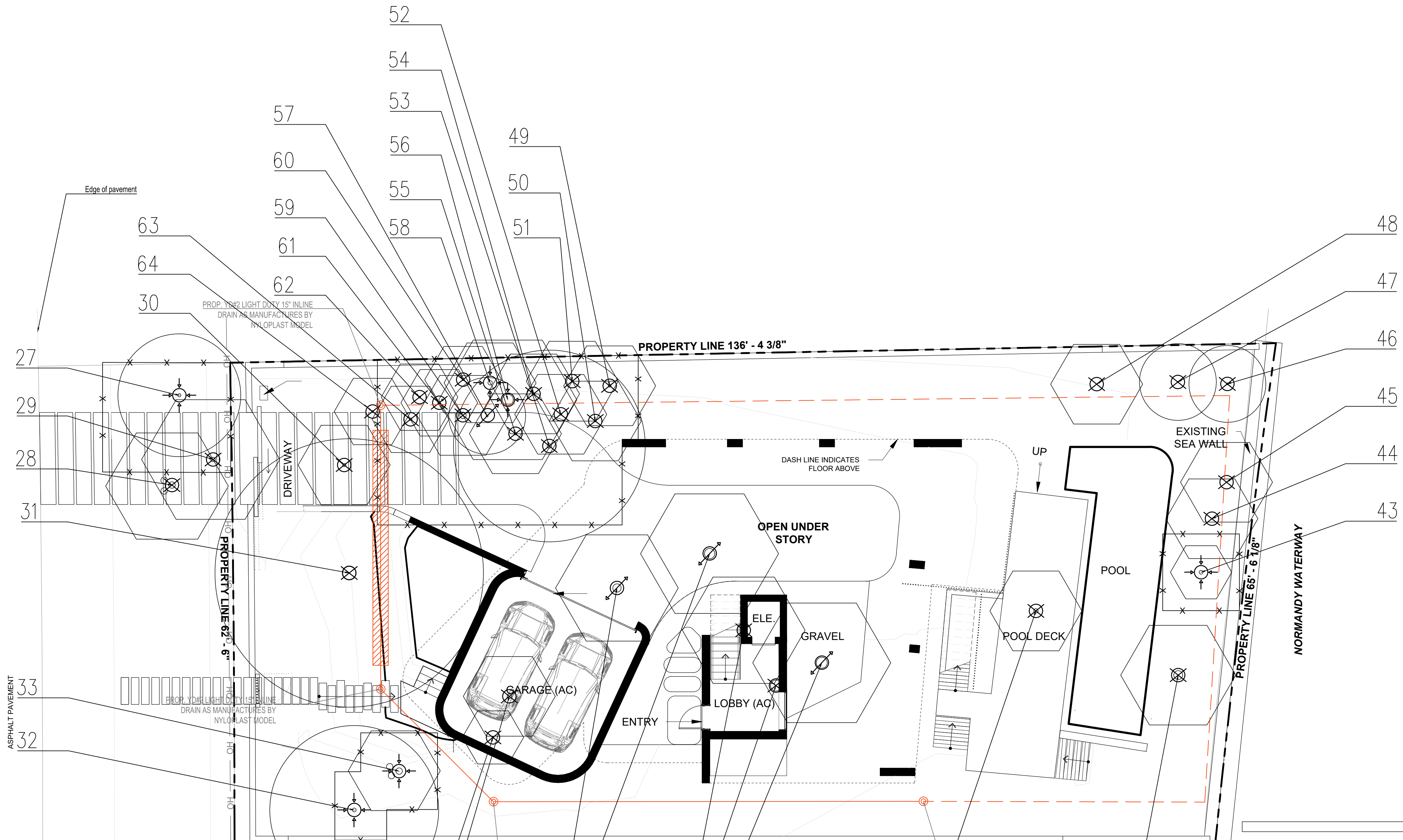

EXISTING TREES & PALMS												
Number	Common name	Botanical Name	Height (')	DBH (")	Number of stems	Spread (')	Condition	Critical Root Zone Radius'	Prohibited?	Specimen?	Disposition	Mitigation
27	silver buttonwood	Conocarpus erectus var. sericeus	18	5	1	16	Good	10			To remain	
28	Senegeal date palm	Phoenix reclinata	15	cluster	1	16	Good	10			To remove	N/A
29	coconut palm	Cocos nucifera	25	7	1	18	Good	10			To remove	N/A
30	Alexander palm	Archontophoenix alexandrae	18	5	1	12	Good	N/A			To remove	N/A
31	strangler fig	Ficus aurea	30	22	1	35	Good	15		Yes	To remove	N/A (invasive)
32	coccoloba	Ocotea elliptica	22	6	1	22	Good	10			To remain	
33	Alexander palm	Archontophoenix alexandrae	25	cluster	1	12	Good	10			To remain	
34	solitaire palm	Ptychosperma elegans	35	3	1	8	Good	N/A			To remove	N/A
35	Senegeal date palm	Phoenix reclinata	42	7	1	12	Good	10			To remove	N/A
36	coconut palm	Cocos nucifera	42	13	1	16	Good	10		Yes	To relocate	
37	coconut palm	Cocos nucifera	60	16	1	18	Good	11		Yes	To relocate	
38	coconut palm	Cocos nucifera	35	8	1	16	Fair	10		Yes	To remove	*
39	royal palm	Royalstonia regia	35	17	1	18	Fair	11		Yes	To relocate	
40	royal palm	Royalstonia regia	25	17	1	0	Poor	11		Yes	To remove	N/A
41	coconut palm	Cocos nucifera	16	7	1	12	Good	10			To remain	
42	Chinese fan palm	Livistona chinensis	60	14	1	15	Good	10		Yes	To remove	N/A
43	coconut palm	Cocos nucifera	16	6	1	8	Poor	10			To remain	
44	coconut palm	Cocos nucifera	15	0	1	12	Poor	N/A			To remove	N/A
45	coconut palm	Cocos nucifera	15	0	1	12	Poor	N/A			To remove	N/A
46	sedgemo	Coccoloba uifera	10	3	2	10	Poor	10			To remove	N/A
47	Madagascar olive	Novantheria emarginata	10	2	3	10	Poor	10			To remove	N/A
48	coconut palm	Cocos nucifera	12	0	1	12	Fair	N/A			To remove	N/A
49	Montgomery palm	Veitchia arcuata	22	4.4	1	12	Good	N/A			To remove	N/A
50	Montgomery palm	Veitchia arcuata	22	3	1	12	Good	N/A			To remove	N/A
51	Montgomery palm	Veitchia arcuata	22	3	1	12	Good	N/A			To remove	N/A
52	Montgomery palm	Veitchia arcuata	20	3	1	12	Good	N/A			To remove	N/A
53	minisops	Mimusops elengi	35	7	1	25	Good	10			To remove	7
54	Montgomery palm	Veitchia arcuata	25	4	1	12	Good	N/A			To remove	N/A
55	Montgomery palm	Veitchia arcuata	25	4	1	12	Good	N/A			To remove	N/A
56	royal palm	Royalstonia regia	60	17	1	18	Good	11		Yes	To remove	
57	minisops	Mimusops elengi	22	3	1	10	Good	10			To relocate	
58	Alexander palm	Archontophoenix alexandrae	35	7	1	12	Good	10			To remain	
59	Alexander palm	Archontophoenix alexandrae	28	5	1	12	Good	10			To remove	N/A
60	solitaire palm	Ptychosperma elegans	28	3	1	10	Good	N/A			To remove	N/A
61	solitaire palm	Ptychosperma elegans	28	3.3	1	10	Good	N/A			To remove	N/A
62	solitaire palm	Ptychosperma elegans	28	3	1	10	Good	N/A			To remove	N/A
63	solitaire palm	Ptychosperma elegans	28	4	1	10	Good	N/A			To remove	N/A
64	solitaire palm	Ptychosperma elegans	26	3	1	10	Good	N/A			To remove	N/A
TOTAL DBH REMOVED											3	
TOTAL PALMS REMOVED											3	

REPLACEMENT PALMS					
Qty.	Botanical Name	Common name	Height (')	DBH (")	Canopy (')
3	Ptychosperma elegans	Alexander Palm	16	4	10
3					

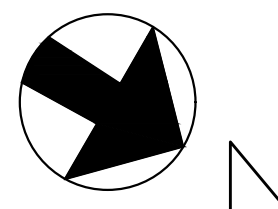

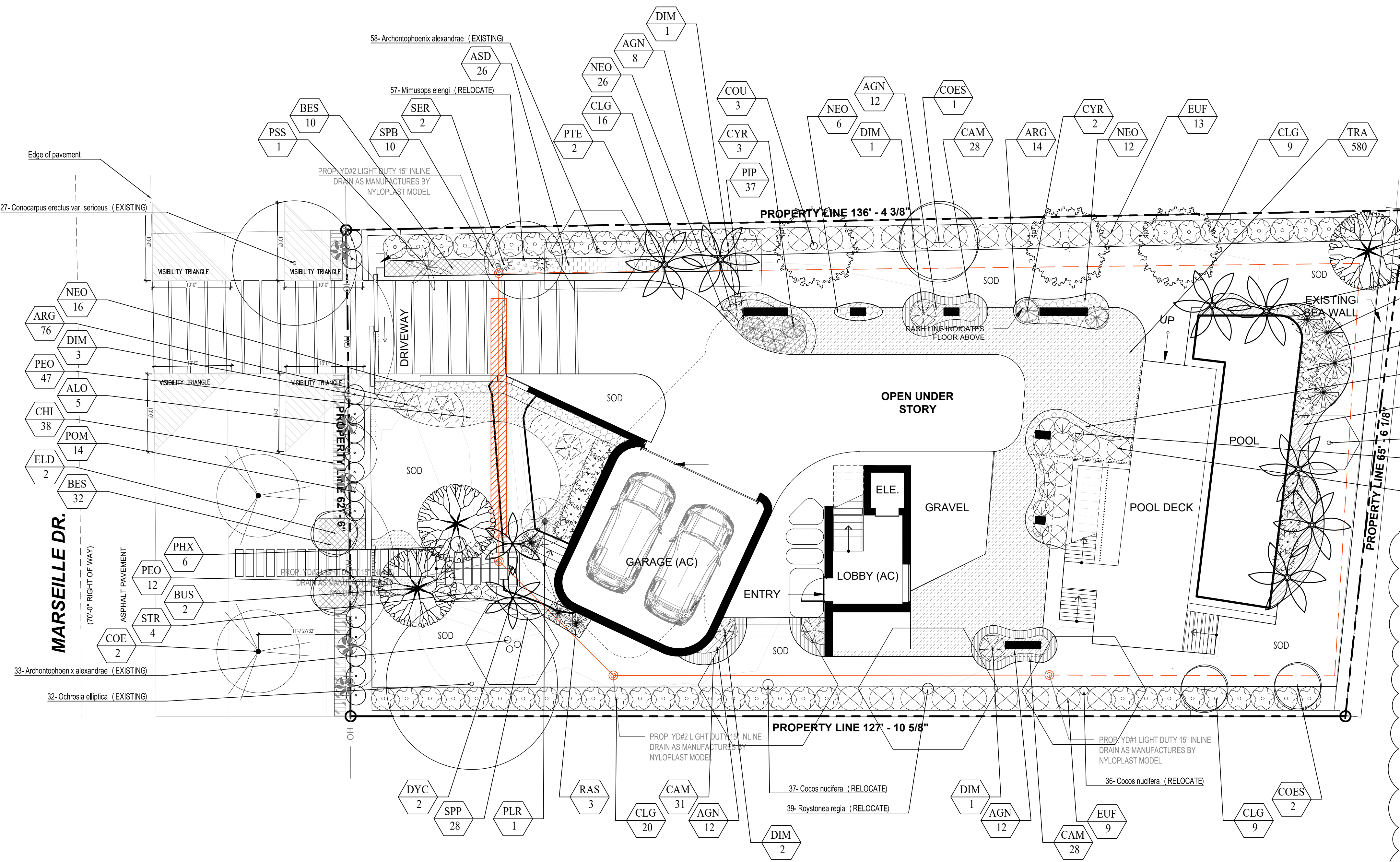

PLANT LIST									
Qty.	Label	Botanical Name	Common name	Height	DBH	Spread	Native	Drought Tolerance	Specifications
TREES									
3	BUS	Bursera simaruba	Gumbo Limbo	16'	2"	10'	YES	Tolerant	
3	COES	Conocarpus erectus 'sericeus'	Silver Buttonwood	16'	2"	10'	YES	Tolerant	
3	COU	Coccoloba uvifera	Seagrape	16'	2"	10'	YES	Tolerant	
2	ELD	Elaeocarpus decipiens	Japanese blueberry	12'	2"	6'	NO	Tolerant	
1	PIR	Plumeria Rubra	Frangipani	6'	1 1/2"	6'	NO	Tolerant	
Qty.	Label	Botanical Name	Common name	Height	DBH	Spread	Native	Drought Tolerance	Specifications
STREET TREES									
2	COE	Conocarpus erectus	Green Buttonwood	16'	2"	10'	YES	Tolerant	
Qty.	Label	Botanical Name	Common name	Height	DBH	Spread	Native	Drought Tolerance	Specifications
PALMS									
2	DYC	Dypsis cabadae	Cabada Palm	10'		8'	NO	Tolerant	
1	PSS	Pseudophoenix sargentii	Buccaneer Palm	6'		6'	YES	Tolerant	
7	PTE	Phycosperma elegans	Alexander Palm	16'	4"	10'	NO	Tolerant	12" Clear trunk
4	THR	Thrinax radiata	Thatch Palm	4'		4'	YES	Tolerant	
Qty.	Label	Botanical Name	Common name	Height		Spread	Native	Drought Tolerance	Specifications
SHRUBS									
44	AGN	Agave americana	Agave	24"		24"	NO	Tolerant	24" o.c.
5	ALO	Alcornoque 'Caldora'	Alcornoque	24"		24"	NO	Tolerant	
26	ASD	Asparagus densiflorus 'Myers'	Fox tail Fern	24"		24"	NO	Tolerant	24" o.c.
42	BES	Begonia semperflorens	White begonia	24"		24"	NO	Tolerant	24" o.c.
40	BUF	Buddleia frutescens	Buddleia	24"		24"	NO	Tolerant	24" o.c.
38	CH	Chrysobalanus icaco 'Green'	Green Coccoloba	24"		24"	YES	Tolerant	18" o.c.
5	CYR	Cycas revoluta	Sago Palm	3'		3'	NO	Tolerant	
8	DIM	Dioon meliae	Palm tree	24"		24"	NO	Tolerant	
9	HEC	Heliconia caribaea	Heliconia	36"		36"	NO	Tolerant	36" o.c.
21	MIS	Microsorium scolopendrium	Wart Fern	24"		24"	NO	Tolerant	18" o.c.
8	MOD	Monstera deliciosa	Swiss Cheese Plant	24"		24"	NO	Tolerant	24" o.c.
60	NEO	Nephrolepis obliterata	Kimberly fern	24"		24"	NO	Tolerant	24" o.c.
59	PEO	Pennisetum orientale	White fountain grass	24"		24"	NO	Tolerant	24" o.c.
6	PHX	Phibiscion varicad	Xanadu	24"		24"	NO	Tolerant	24" o.c.
14	PGM	Podocarpus macrophyllus	Podocarpus	36"		36"	NO	Tolerant	36" o.c.
3	RAS	Radermachera sinica	Radermachera	4'		4'	NO	Tolerant	48" o.c.
2	SER	Serenia repens	Saw Palmetto	24"		24"	YES	Tolerant	
10	SPB	Spartina bakeri	Sand Cordgrass	18"		18"	YES	Tolerant	18" o.c.
4	STR	Strelitzia reginae	Bird of Paradise	24"		24"	NO	Tolerant	24" o.c.
28	SPP	Spaethoglottis pilicora	Ground Orchid	18"		18"	NO	Tolerant	18" o.c.
40	TRF	Trichostema flavescens	Dwarf Fakahatchee	18"		18"	YES	Tolerant	24" o.c.
Qty.	Label	Botanical Name	Common name	Height		Spread	Native	Drought Tolerance	Specifications
LARGE SHRUBS									
54	CLG	Clusia guifera	Small Leaf Clusia	6'		3'	NO	Tolerant	3'
28	EUF	Eugenia toleda	Spanish Stopper	6'		4'	YES	Tolerant	4' o.c.
Qty.	Label	Botanical Name	Common name	Height		Spread	Native	Drought Tolerance	Specifications
GROUNDCOVER									
90	ARG	Arachis glabrata	Ornamental peanut	12"		12"	NO	Tolerant	12" o.c.
87	CAM	Callisia macrocarpa	Natal plum	12"		12"	NO	Tolerant	12" o.c.
37	PIF	Pilea peperomioides	Pilea	12"		12"	NO	Tolerant	12" o.c.
580	TRA	Trachelospermum asiaticum	Asiatic Jasmine	12"		12"	YES	Tolerant	12" o.c.
Qty.	Label	Botanical Name	Common name	Height		Spread	Native	Drought Tolerance	Specifications
SOD									
2,150 sq ft	SOD	Zoysia lawn	Zoysia						

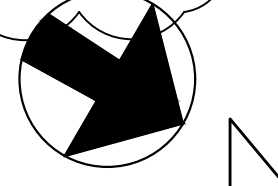

PARAMETRIKA LAND & DESIGN
Gabriela Albomoz
Valeria Quintanilla LA6667640



1425 Marseille Dr
1425 Marseille Dr
Miami Beach, FL 33141

Rev #3: 04/05/2025

SHEET TITLE
Landscape plan

ISSUE DATE
03/30/2024

REVISION
March, 2024

DESIGN
GA

DRAWN
TY

SCALE
1/8" = 1'-0"

SEAL
VALERIA QUINTANILLA
LA6667640

SHEET NUMBER
L-102

3

MARSEILLE DR.

(70'-0" RIGHT OF WAY)

ASPHALT PAVEMENT

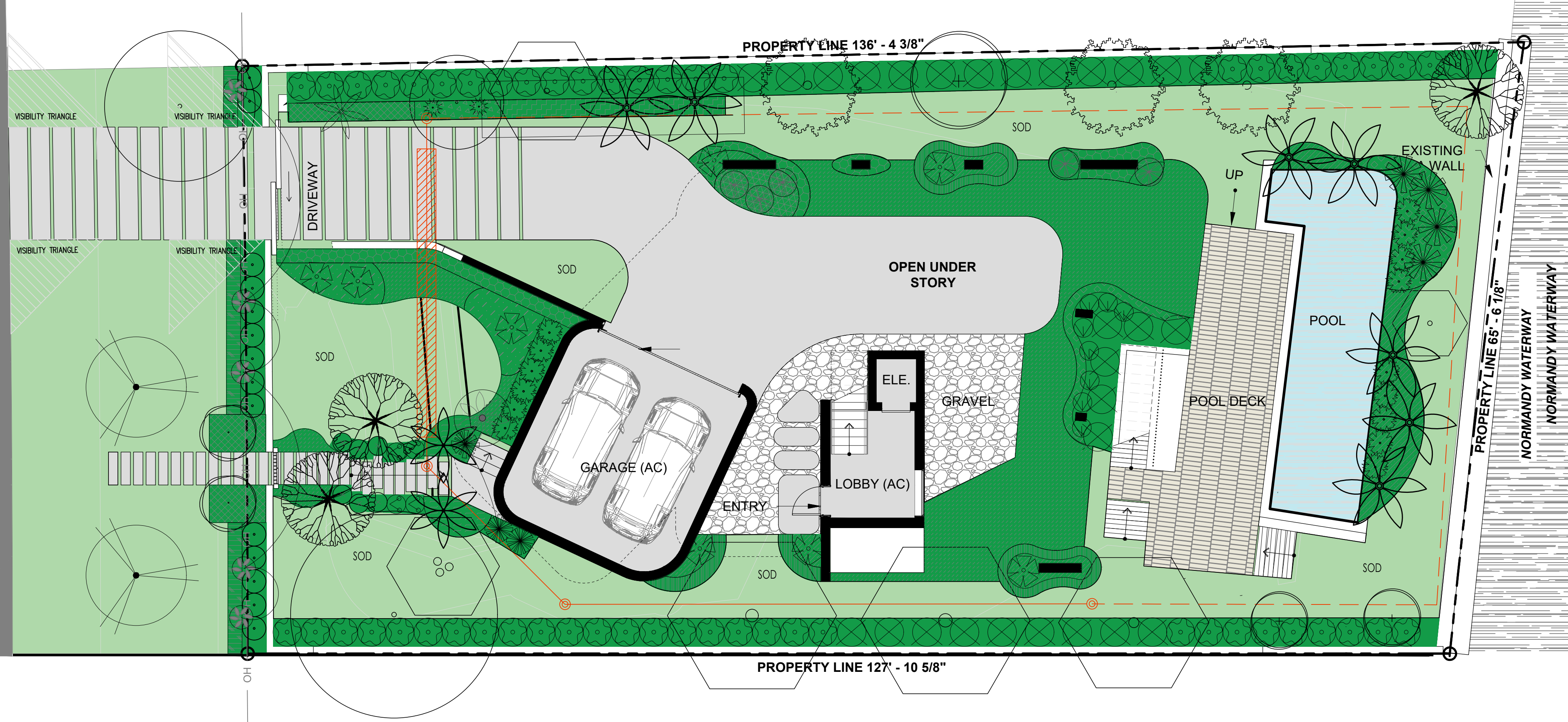

PLANT LIST									
Qty.	Label	Botanical Name	Common name	Height	DBH	Spread	Native	Drought tolerance	Specifications
TREES									
3	BUS	Bursera imbricata	Gunibo Limbo	16'	2"	10'	YES	Tolerant	
3	COE	Conocarpus erectus 'sericeus'	Silver Buttonwood	16'	2"	10'	YES	Tolerant	
3	COU	Coccoloba lyfifera	Seagrape	16'	2"	10'	YES	Tolerant	
2	ELD	Elaeocarpus decipiens	Japanese blueberry	12'	2"	6'	NO	Tolerant	
1	FLR	Plumeria Rubra	Frangipani	6'	1 1/2"	6'	NO	Tolerant	
Qty.	Label	Botanical Name	Common name	Height	DBH	Spread	Native	Drought tolerance	Specifications
SHRUBS									
2	COE	Conocarpus erectus	Green Buttonwood	16'	2"	10'	YES	Tolerant	
Qty.	Label	Botanical Name	Common name	Height	DBH	Spread	Native	Drought tolerance	Specifications
PALMS									
2	DYC	Dypsis ciliatoides	Casaba Palm	10'		8'	NO	Tolerant	
1	PSS	Pseudophoenix sargentii	Buccanier Palm	6'		6'	YES	Tolerant	
7	PTE	Psychoparma elegans	Alexander Palm	16'	4"	10'	NO	Tolerant	12' Clear trunk
4	THR	Trinax radiata	Thatch Palm	4'		4'	YES	Tolerant	
Qty.	Label	Botanical Name	Common name	Height		Spread	Native	Drought tolerance	Specifications
SHRUBS									
44	AGN	Aglaonema nitidum	Aglaonema	24"		24"	NO	Tolerant	24" o.c.
5	ALO	Alocasia 'Calkson'	Alocasia	24"		24"	NO	Tolerant	
26	ASD	Asparagus densiflorus 'Myers'	Foxtail Fern	24"		24"	NO	Tolerant	24" o.c.
42	BES	Begonia semperflorens	White begonia	24"		24"	NO	Tolerant	24" o.c.
40	BUF	Bulbine frutescens	Bulbine	24"		24"	NO	Tolerant	24" o.c.
38	CH	Chrysobalanus icaya 'Green'	Green Cocoplum	24"		24"	YES	Tolerant	18" o.c.
5	CYR	Cycas revoluta	Sago Palm	3'		3'	NO	Tolerant	
8	DIM	Dioscorea sp.	Patma tree-like	24"		24"	NO	Tolerant	
9	HEC	Heliconia caribaea	Heliconia	36"		36"	NO	Tolerant	36" o.c.
21	MIS	Microsorium scolopendrium	Wart Fern	24"		24"	NO	Tolerant	18" o.c.
8	MOD	Monstera deliciosa	Swiss Cheese Plant	24"		24"	NO	Tolerant	24" o.c.
40	NEO	Nephrolepis obliterata	Kimberly fern	24"		24"	NO	Tolerant	24" o.c.
59	PEO	Pennisetum orientale	White fountain grass	24"		24"	NO	Tolerant	24" o.c.
6	PHX	Philodendron xanadu	Xanadu	24"		24"	NO	Tolerant	24" o.c.
14	POM	Podocarpus macrophyllus	Podocarpus	36"		36"	NO	Tolerant	36" o.c.
3	RA3	Radermachera sinica	Radermachera	4'		4'	NO	Tolerant	48" o.c.
2	SER	Serecoa repens	Saw Palmetto	24"		24"	YES	Tolerant	
10	SPB	Spartina bakeri	Sand Cordgrass	18"		18"	YES	Tolerant	18" o.c.
4	STR	Strelitzia reginae	Bird of Paradise	24"		24"	NO	Tolerant	24" o.c.
28	SPP	Spathoglottis plicata	Ground Orchid	18"		18"	NO	Tolerant	18" o.c.
40	TRF	Tropaeolum foetidum	Dwarf Falahatchee	18"		18"	YES	Tolerant	24" o.c.
Qty.	Label	Botanical Name	Common name	Height		Spread	Native	Drought tolerance	Specifications
LARGE SHRUBS									
54	CLG	Clerodendron glaberrimum	Small Leaf Clerodendron	6'		3'	NO	Tolerant	3'
28	EUF	Eugenia foetida	Spanish Shagger	6'		4'	YES	Tolerant	4" o.c.
Qty.	Label	Botanical Name	Common name	Height		Spread	Native	Drought tolerance	Specifications
GROUNDCOVER									
90	ARG	Atrochil gabrata	Ornamental peonys	12"		12"	NO	Tolerant	12" o.c.
87	CAM	Calusa macrocarpa	Natal pilum	12"		12"	NO	Tolerant	12" o.c.
37	PIP	Pilea peperomioides	Pilea	12"		12"	NO	Tolerant	12" o.c.
380	TRA	Trachelospermum asiaticum	Asiatic Jasmine	12"		12"	YES	Tolerant	12" o.c.
Qty.	Label	Botanical Name	Common name	Height		Spread	Native	Drought tolerance	Specifications
SOB									
2,150 sq ft	SOD	Zoysia Lawn	Zoysia						



PARAMETRIKA LAND & DESIGN
Gabriela Albomoz
Valeria Quintanilla LA6667640



1425 Marseille Dr

1425 Marseille Dr
Miami Beach, FL 33141

Rev #3: 04/05/2025

SHEET TITLE
Landscape plan (Rendered)

ISSUE DATE
03/30/2024

REVISION
March, 2024

DESIGN
GA

DRAWN
TY

SCALE
1/8" = 1'-0"

SEAL

VALERIA QUINTANILLA
LA6667640

SHEET NUMBER
L-102.1

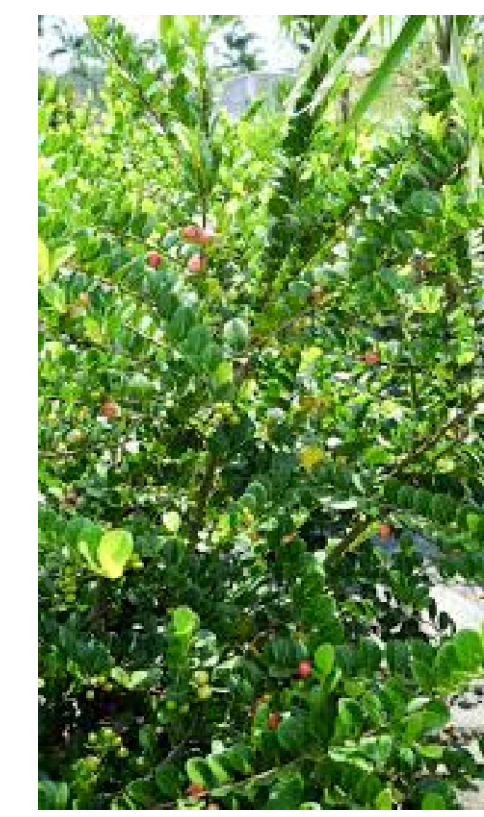
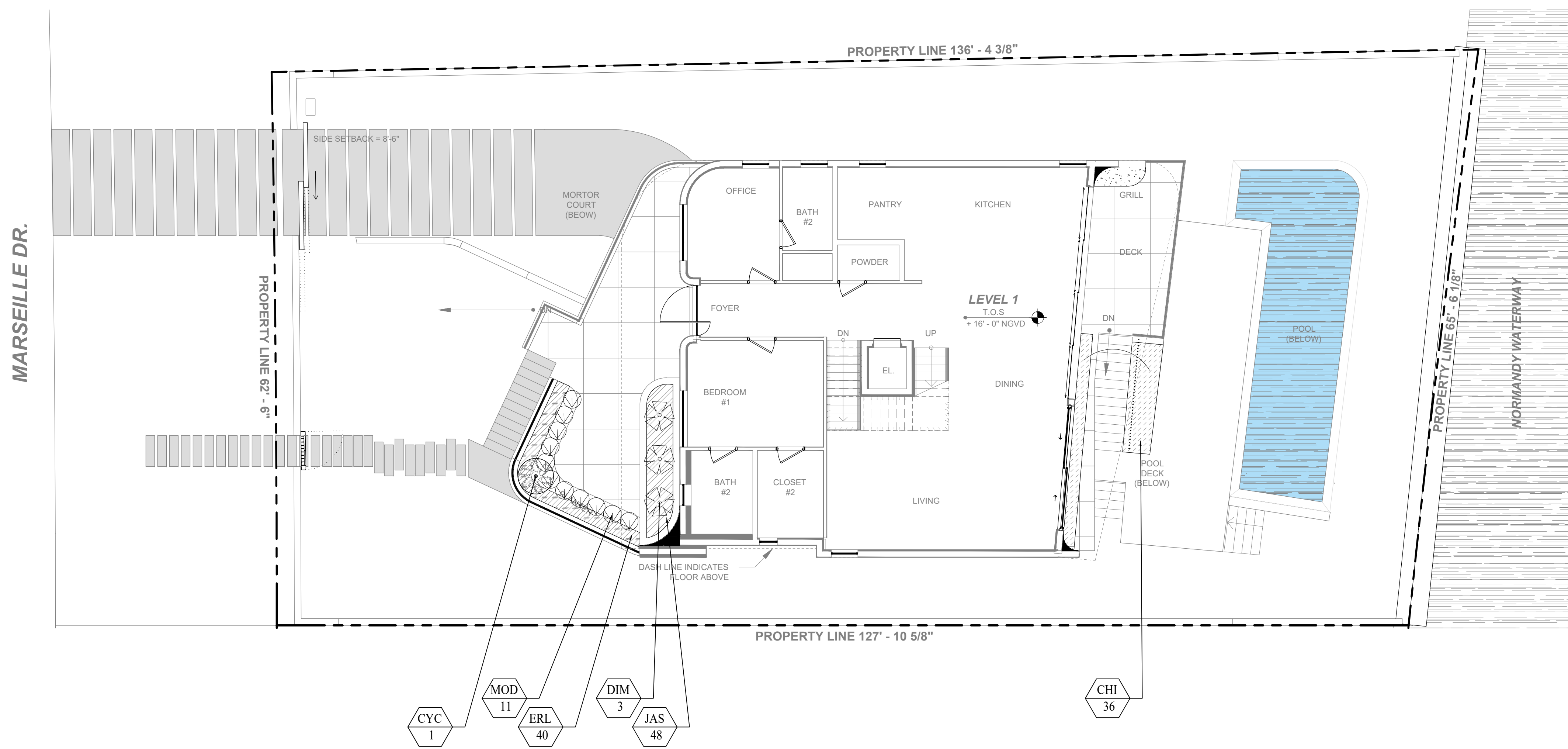

Chrysobalanus icaco
"Horizontal"

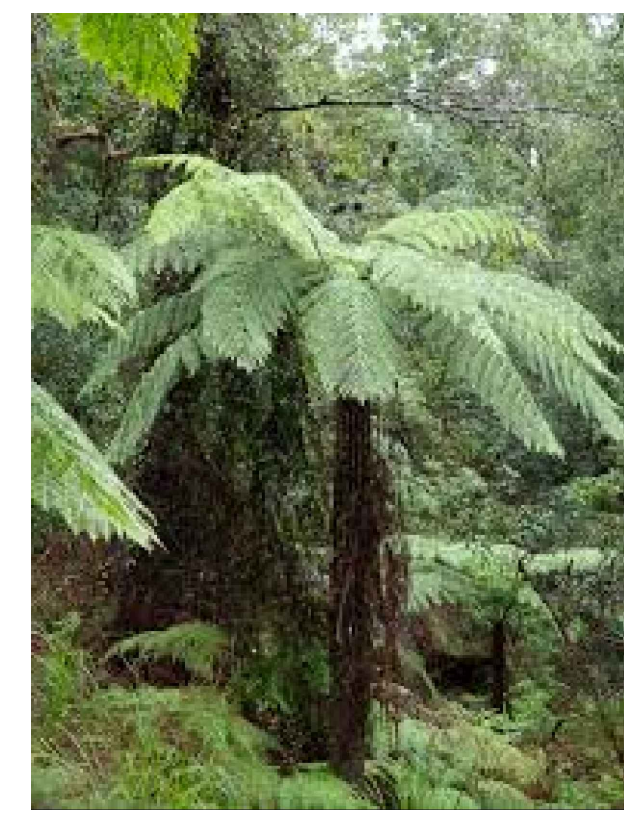

Cyathea cooperi



Dioon mejiae

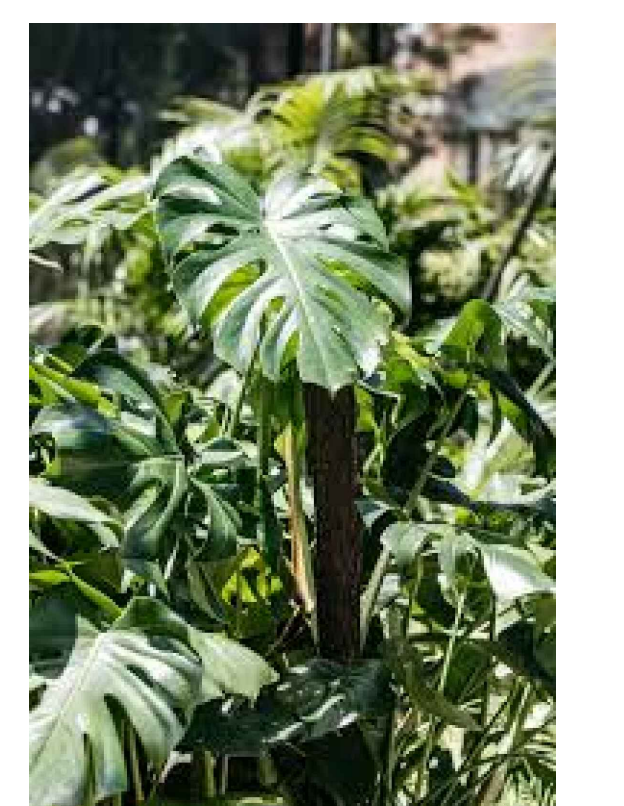

Monstera deliciosa

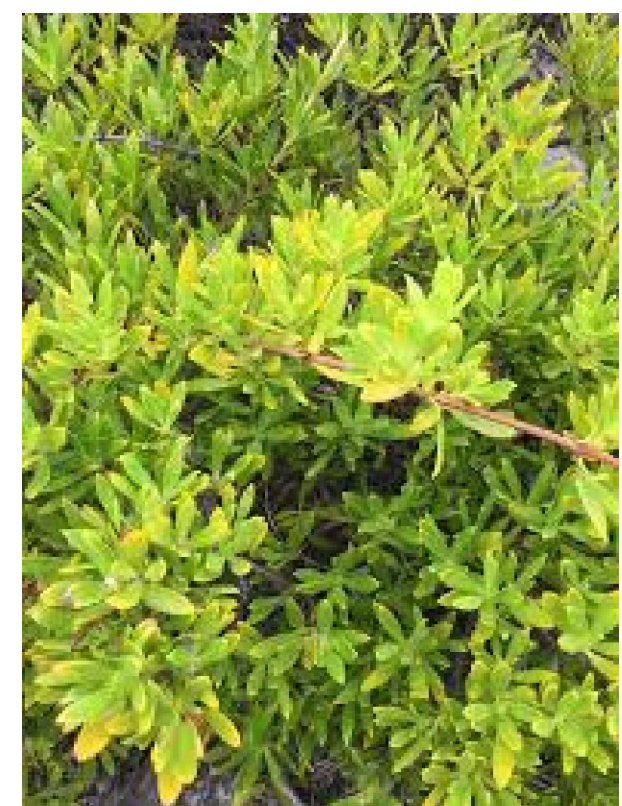

Ernodea littoralis Sw.

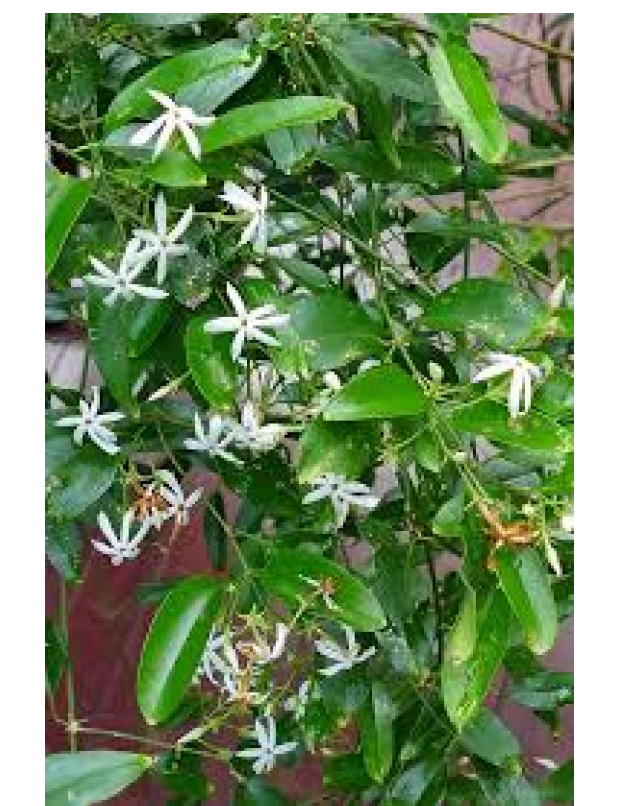

Jasminum simplicifolium

PLANT LIST								
Qty.	Label	Botanical Name	Common name	Height	Spread	Native	Drought tolerance	Specifications
SHRUBS								
36	CHI	<i>Chrysobalanus icaco</i> "Horizontal"	Cocoplum horizontalis	36"	36"	YES	Tolerant	36" o.c.
1	CYC	<i>Cyathea cooperi</i>	Australian Tree Fern	3'	3'	NO	Tolerant	
3	DIM	<i>Dioon mejiae</i>	Palma teosinte	24"	24"	NO	Tolerant	
11	MOD	<i>Monstera deliciosa</i>	Swiss Cheese Plant	24"	24"	NO	Tolerant	24" o.c.
GROUNDCOVER								
40	ERL	<i>Ernodea littoralis Sw.</i>	Beach Creeper	12"	12"	YES	Tolerant	12" o.c.
48	JAS	<i>Jasminum simplicifolium</i>	Wax Jasmin	12"	12"	NO	Tolerant	12" o.c.

PARAMETRIKA LAND & DESIGN
Gabriela Albomoz
Valeria Quintanilla LA6667640



1425 Marseille Dr
1425 Marseille Dr
Miami Beach, FL 33141

Rev #3: 04/05/2025

SHEET TITLE
Landscape plan (1st floor)

ISSUE DATE
03/30/2024

REVISION
March, 2024

DESIGN
GA

DRAWN
TY

SCALE
1/8" = 1'-0"

SEAL
VALERIA QUINTANILLA
LA6667640

SHEET NUMBER
L-102.2

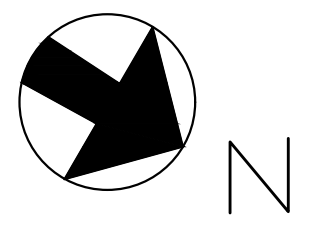

MARSEILLE DR.

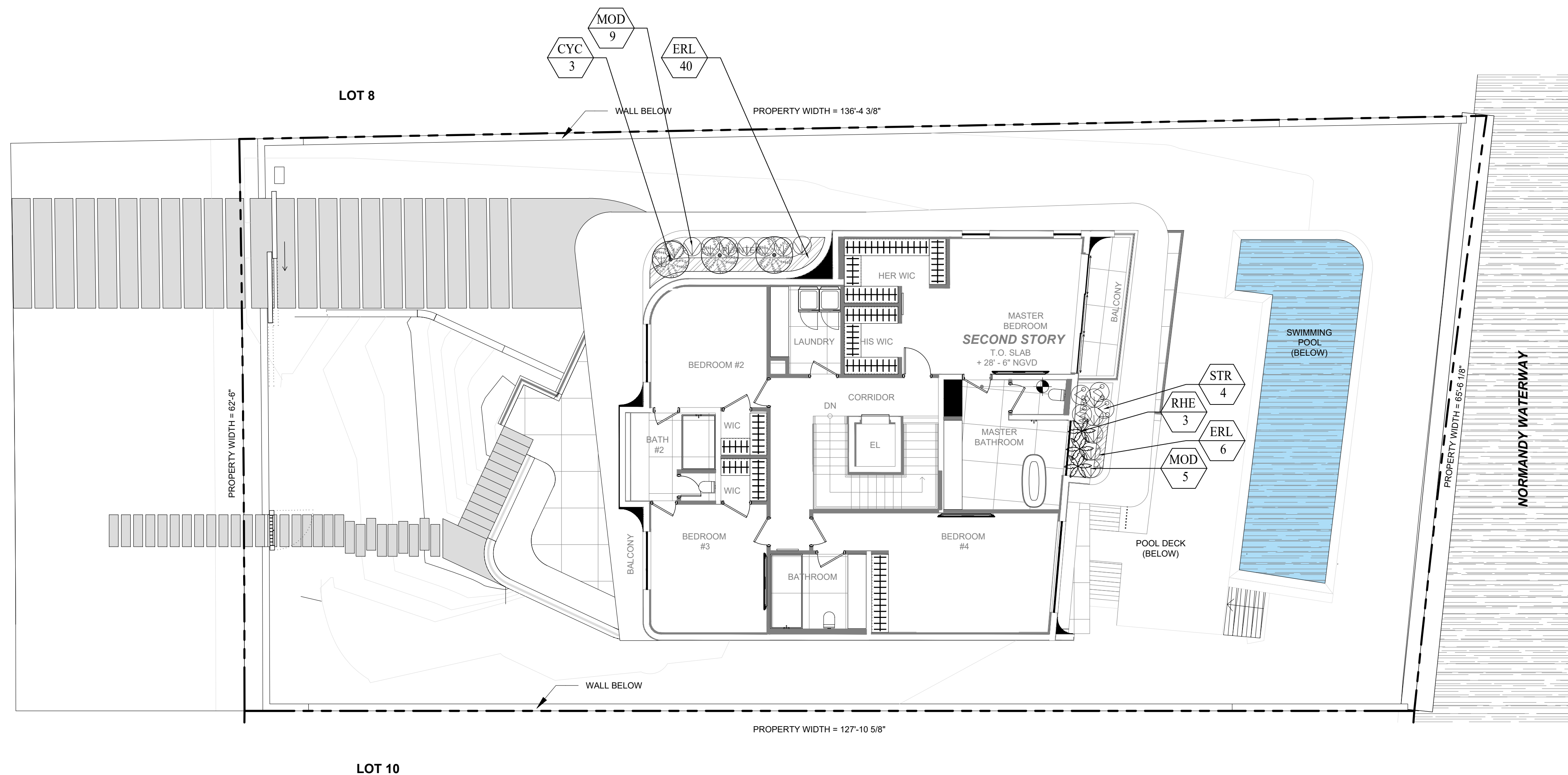

PLANT LIST								
Qty.	Label	Botanical Name	Common name	Height	Spread	Native	rought toleran	Specifications
SHRUBS								
3	CYC	<i>Cyathea cooperi</i>	Australian Tree Fern	3'	3'	NO	Tolerant	
14	MOD	<i>Monstera deliciosa</i>	Swiss Cheese Plant	24"	24"	NO	Tolerant	24" o.c.
3	RHE	<i>Rhapis excelsa</i>	Lady Palm	4'	4'	NO	Tolerant	
4	STR	<i>Strelitzia reginae</i>	Bird of Paradise	24"	24"	NO	Tolerant	24" o.c.
GROUNDCOVER								
6	ERL	<i>Emodea littoralis Sw.</i>	Beach Creeper	12"	12"	YES	Tolerant	12" o.c.
14	JAS	<i>Jasminum simplicifolium</i>	Wax Jasmin	12"	12"	NO	Tolerant	12" o.c.

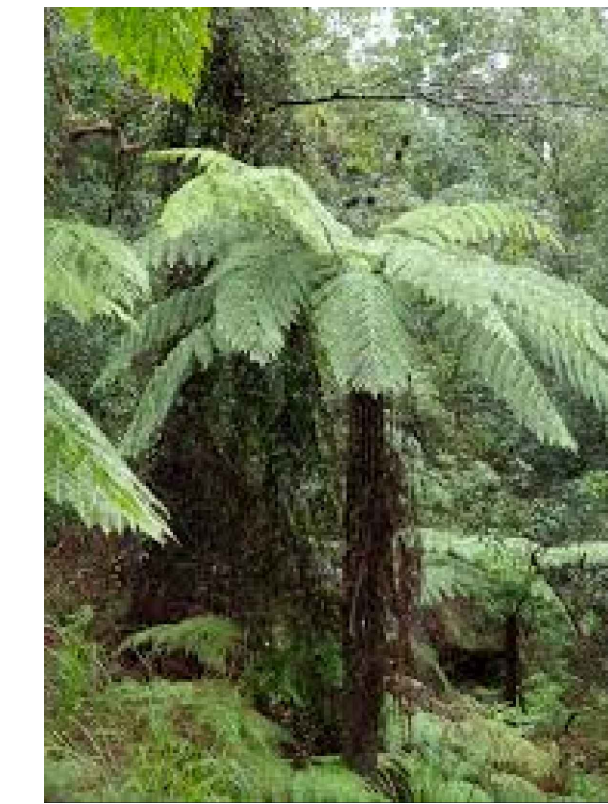

Cyathea cooperi



Monstera deliciosa



Rhapis excelsa



Strelitzia reginae



Emodea littoralis Sw.



Jasminum simplicifolium

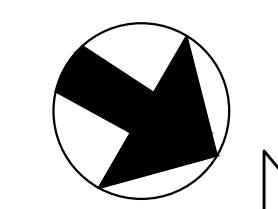

PARAMETRIKA LAND & DESIGN
Gabriela Albomoz
Valeria Quintanilla LA6667640

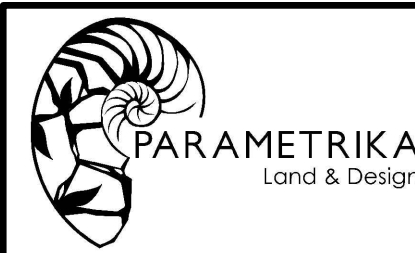

1425 Marseille Dr
1425 Marseille Dr
Miami Beach, FL 33141

Rev #3: 04/05/2025

SHEET TITLE
Landscape plan (2nd floor)

ISSUE DATE
03/30/2024

REVISION
March, 2024

DESIGN
GA

DRAWN
TY

SCALE
1/8" = 1'-0"

SEAL
VALERIA QUINTANILLA
LA6667640

SHEET NUMBER
L-102.3

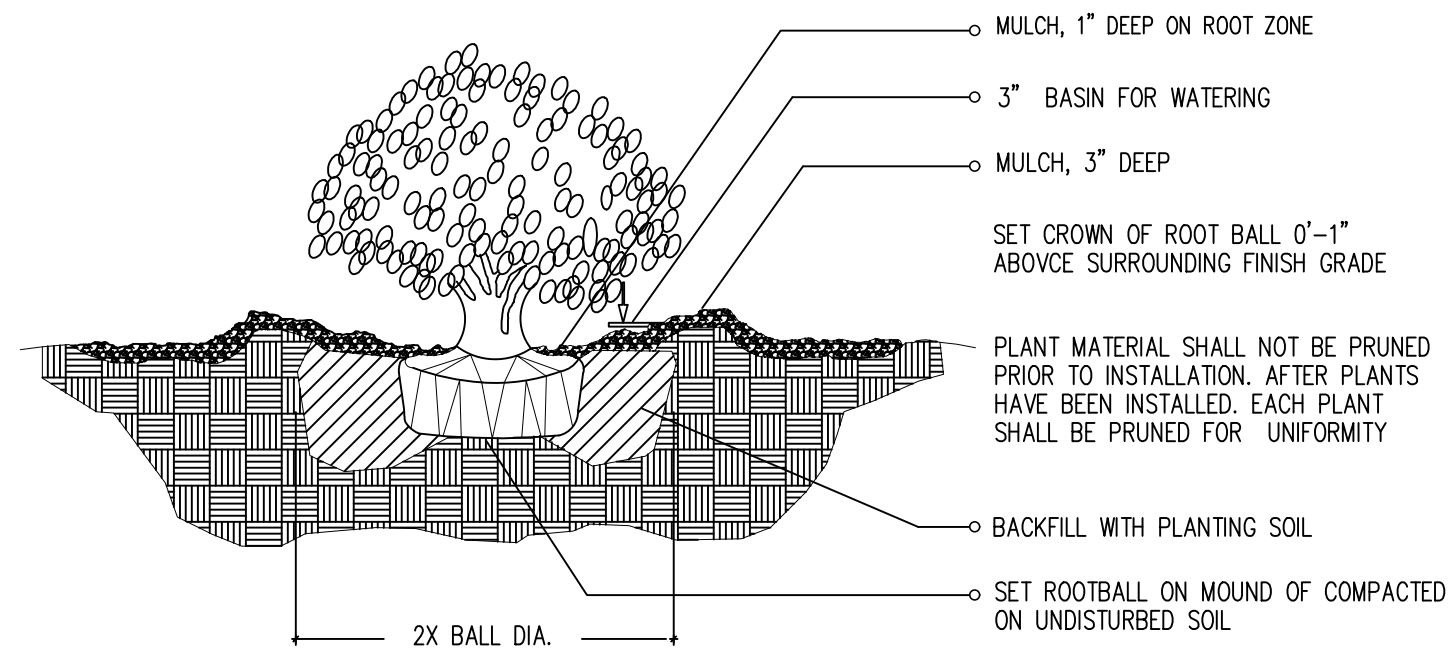

1-1 SHRUB / PLANTING DETAIL

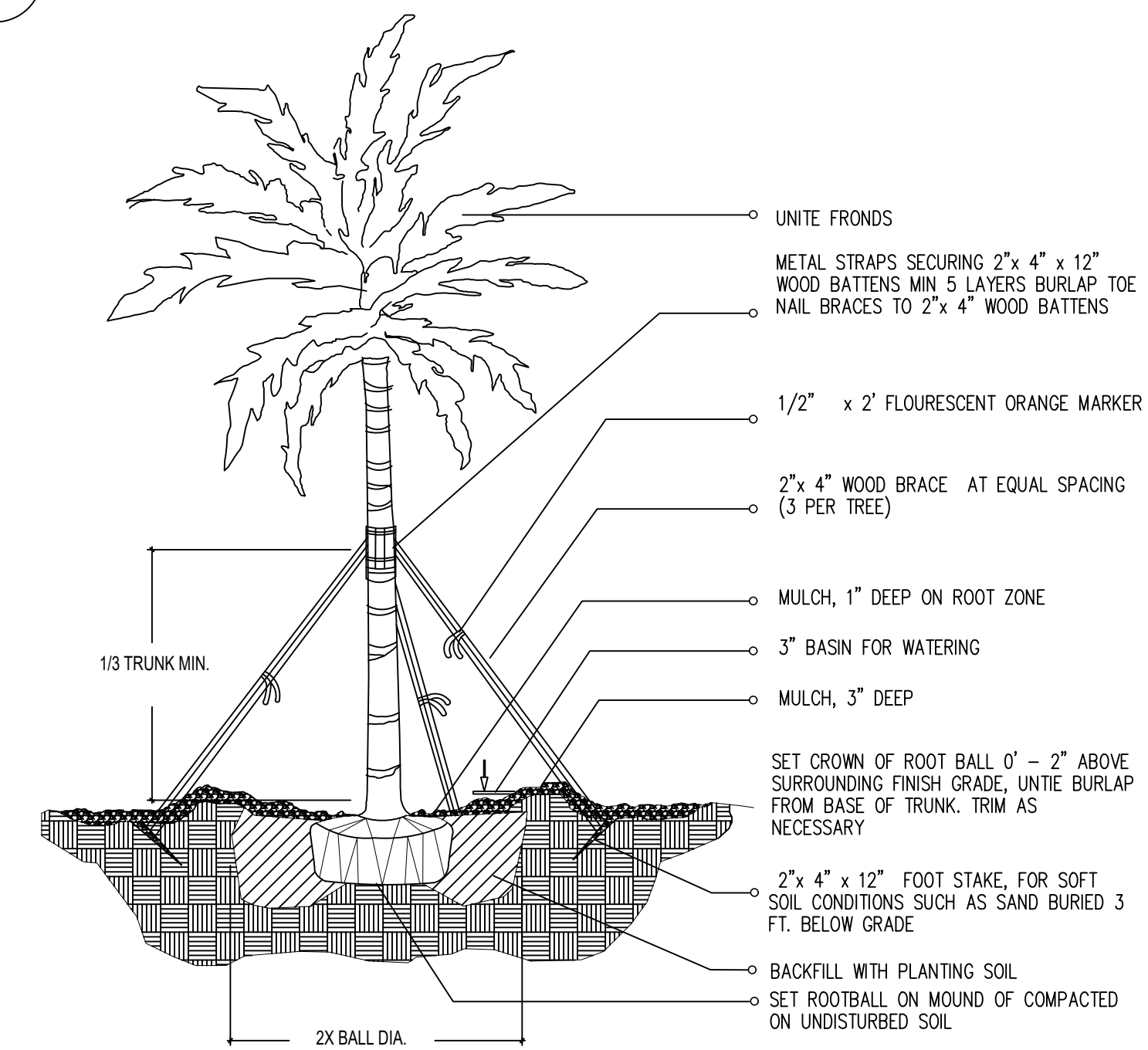

1-2 MULTI-TRUNK AND SMALL TREE (2' cal. and under) / PLANTING DETAIL

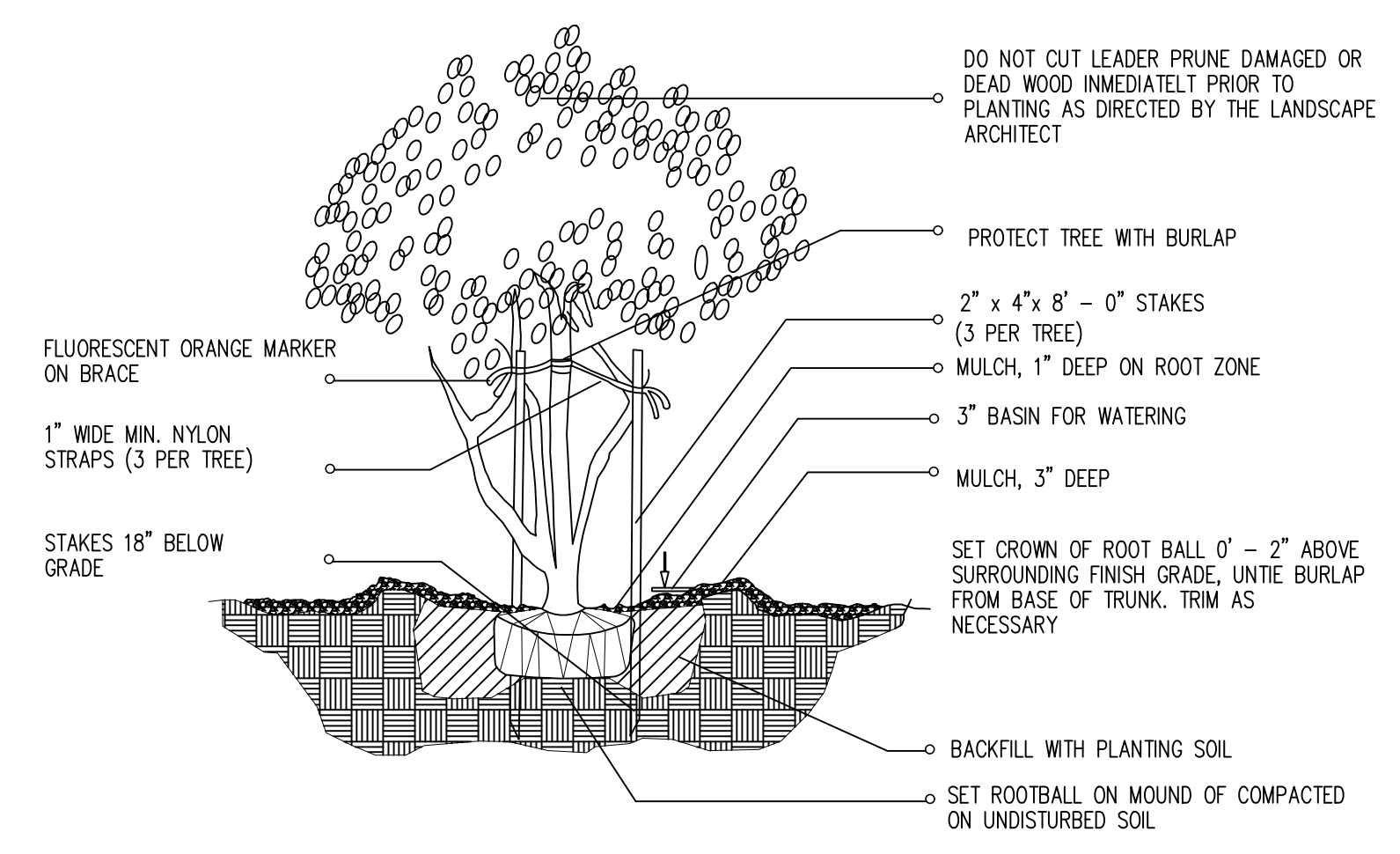

1-3 (2" cal. and over) LARGE TREE / PLANTING DETAIL

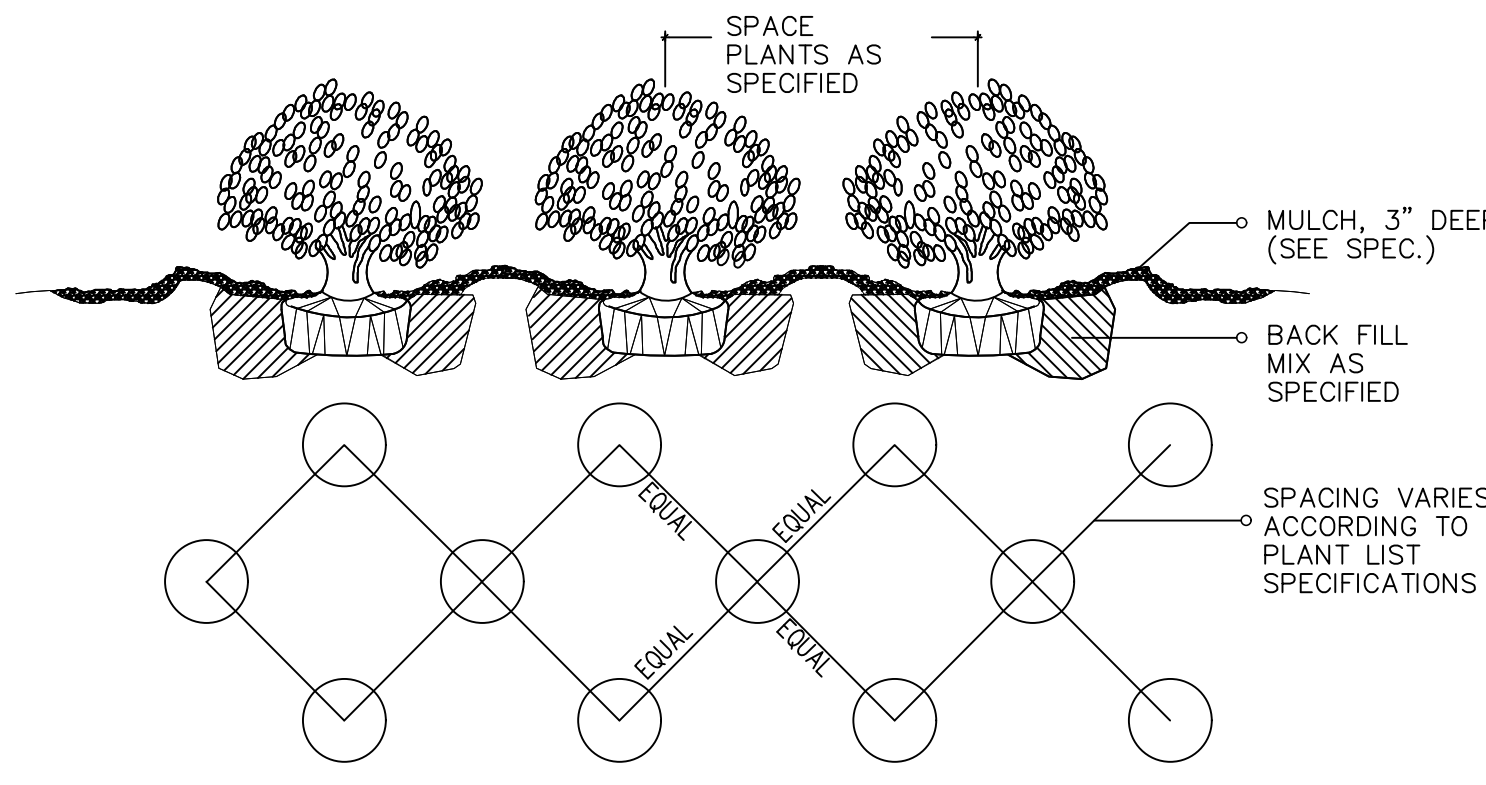

1-6 SHRUB / GROUND COVER SPACING PLANTING DETAIL

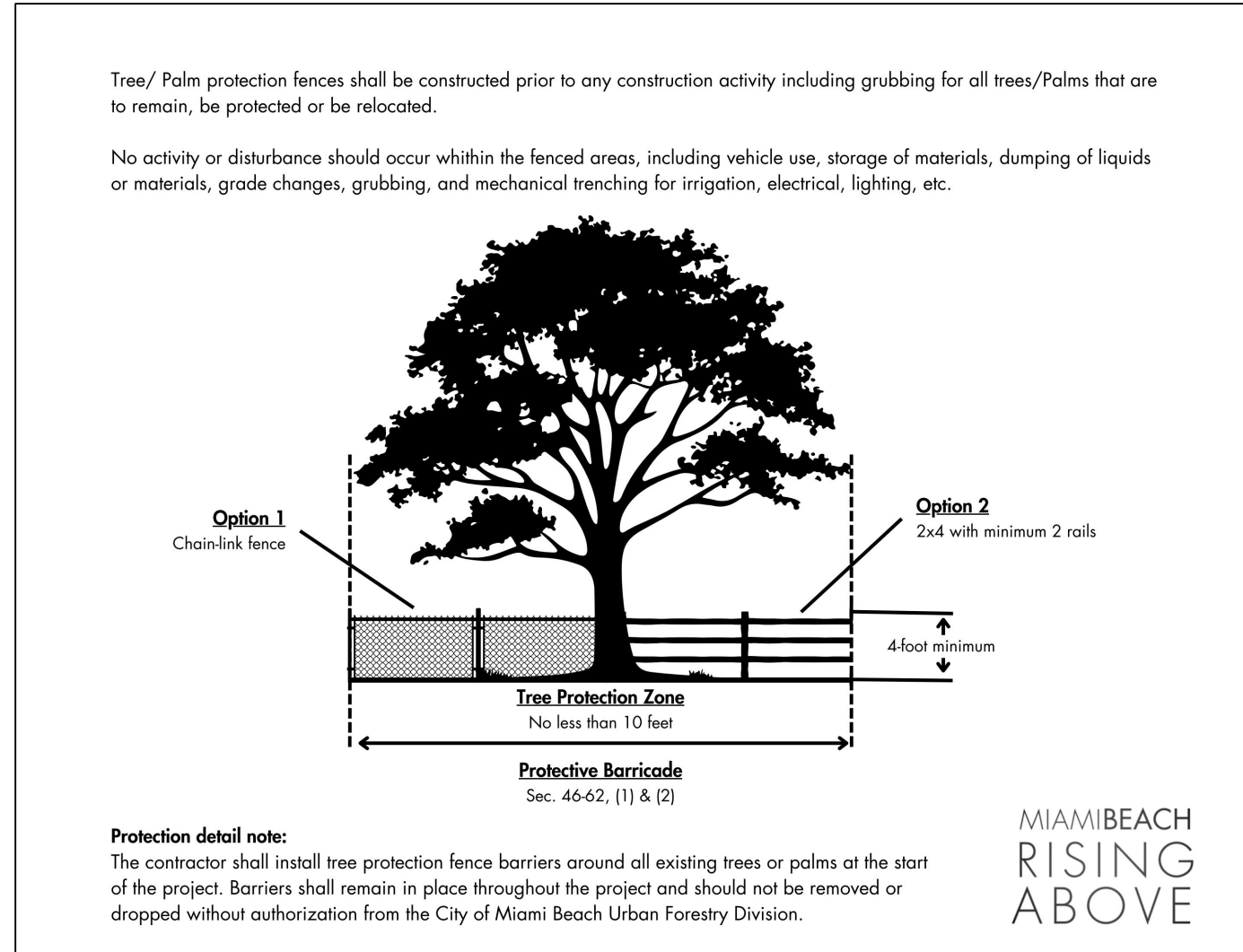

1-4 LARGE PALM / PLANTING DETAIL

LANDSCAPE LEGEND		
INFORMATION REQUIRED TO BE PERMANENTLY AFFIXED TO PLANS		
Transect Zone: RS-4	Lot Area: 8,398.79	Acres: 0.192
OPEN SPACE		
A. Square feet of required Open Space, as indicated on site plan: Lot Area = 8,398.79 s.f. x 50% = 4,200 s.f.	REQUIRED	PROVIDED
	4,200	7,706
B. Square feet of parking lot open space required by Article 9, as indicated on site plan: Number of parking spaces _____ x 10 s.f. per parking space =		
C. Total square feet of landscaped open space required: A+B=	4,200	7,706
LAWN AREA CALCULATION		
A. Square feet of landscaped open space required:	4,200	7,706
B. Maximum lawn area (sod) permitted = 50% x 7,706 s.f.	3,853	2,150
TREES		
A. Number of trees required per net lot acre, less existing number of trees meeting minimum requirements = _____ trees x _____ net lot acres - number of existing trees =	8	8 (2 ex.)
B. % Palms allowed: Number of trees provided x 30% =	2	10 (6 ex.)
C. % Natives required: Number of trees provided x 50% =	3	3
D. % Drought tolerant and low maintenance: Number of trees provided x 20% =	2	5
E. Street Trees (maximum average spacing of 20' o.c.): _____ linear feet along street / 20' =	3	3 (1 ex.)
% Palms permitted to count towards street trees on 1:1 basis x 30%:		
F. Street trees located directly beneath power lines: (maximum average spacing of 25' o.c.): _____ linear feet along street / 25' =		
SHRUBS		
A. Number of shrubs required: Number of trees required x 12 =	144	463
B. % Native shrubs required: Number of shrubs required x 50% =	75	108
LARGE SHRUBS OR SMALL TREE		
A. Number of large shrubs or small trees required: Number of shrubs required x 10% =	14	82
B. % Native large shrubs or small trees required: Number of large shrubs or small trees required x 50% =	7	28

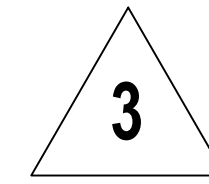

LANDSCAPE NOTES	
1.	Non Cypress variety mulch shall extend under all trees, shrubs and ground cover beds to the closest hard edge or sod border, in a minimum of 3" depth.
2.	All plants shall meet the minimum standard of Florida No. 1 or better as specified in Grade and Standards for Nursery Plants as published by the Division of Plant Industry, Florida Department of Agriculture, latest edition.
3.	All shrubs to be planted a minimum of 24", and ground covers a minimum of 12" from the edge of walks, building walls, pond's edge, etc... Ixora Nona Grant and Raphiolepis Indica to be planted 30" form edge of walkways.
4.	All trees and palms over 8" in height shall be banded to prevent lateral movement for a period of six months from the date of planting. Either wood braces as shown in the planting detail, or the wire and turnbuckle method shall be used. No nails, screws, metal straps or wires are to be used directly against the trees or palms trunks.
5.	All palms except for species such as Coccothrinax, Acoelomathe, Rophis, and other multitrunk palms, shall have straight trunks, free of scars, decay or any damage caused by digging, transport or planting handling of the same.
6.	All work by the Landscape Contractor shall be performed in a professional and sound manner in accordance with established standards of landscape installation practices and workmanship.
7.	Landscape Contractor is responsible for verifying plant quantities prior to bidding. Quantities shown in the plans may vary due to actual site scale, job conditions, etc... Landscape Architect assumes no responsibility for the actual plant count necessary for the successful completion of the work.
8.	Landscape Contractor shall coordinate his work with the General Contractor of Construction Manager in such a manner as to allow for a speedy and orderly completion of all work on the site.
9.	All work shall conform to Miami-Dade County's Landscape Ordinance Chapter 18-A, Ordinance 98-13, and any other municipal landscape ordinance in effect at the projects location, including streets-trees.
10.	Landscape Contractor is required to procure and obtain any necessary permits applicable for the successful completion of this project, if applicable.
11.	Landscape material shall not be allowed to grow in such a manner as to impede streetlight triangle of visibility to property owner or neighbors, so as to materially impede vision between a height of 3 feet and 8 feet.
12.	Landscape Contractor shall call Sunshine State One Call Center of Florida at 1-800-432-4770 (Toll Free) 48 hours before digging.
13.	Landscape Contractor is responsible for inspecting the site and physically observing all site conditions prior to entering into Agreements or Contract with Owner. Landscape Contractor shall coordinate his work with the General Contractor of Construction Manager in such a manner as to allow for a speedy and orderly completion of all work on the site.
14.	Any excess soil, landscape materials and debris from the landscape Contractor's work shall be removed from the site immediately upon completion of his work.
15.	Landscape Contractor shall coordinate the proposed planting in the Planting Plan with the work required in relocating and removal of trees in sheet L-1 (Existing Trees).
16.	One year warranty

TREES & PLANTING TO BE PRESERVED NOTES

TREE AND PALM TRANSPLANTING NOTES:

- Certified arborist's to be hired to supervise and direct all phases of transplanting trees and palms.
- Trees to be relocated shall be pruned a minimum of eight weeks prior to transplanting. Landscape Contractor shall maintain transplanted materials during construction period by watering, moving, spraying, fertilizing, and pruning.
- Landscape Contractor is responsible for verifying locations of all underground and overhead utilities and easements prior to commencing work. All utility companies and/or the General Contractor shall be notified to verify locations prior to digging. Utility trenching is to be coordinated with the Landscape prior to beginning of project. The Owner and Landscape Architect shall not be responsible for damage to utility or irrigation lines.
- The Landscape Contractor shall comply with all local and State codes and shall be responsible for obtaining all applicable permits.
- The Landscape Contractor shall regularly inspect the relocated materials to ensure compliance with standard horticultural practices.
- The Landscape Contractor is responsible for guaranteeing the transplanted trees and palms for a period of one year. At the time of the final inspection all transplanted trees and palms that are not healthy growing condition shall be replaced by the Landscape Contractor.
- Root Pruning and Transplanting Operations: The Landscape Contractor shall take all precautions to minimize shock of root pruning and transplanting in accordance with standard arboriculture procedures including:
 - The diameter of the root-pruning or transplanting circle shall be at a distance away from the trunk equal to 12 times each inch of trunk diameter at breast height.
 - All small roots shall be cleanly cut with a sharp saw, a clean saw or chainsaw depending on the size of the root.
 - Trees shall not be pruned or transplanting to compensate for root loss. Any trimming required shall be as per the International Society of Arboriculture Trimming Standards.
 - For all palms except Sabal palmetto, the lower fronds shall be pruned leaving 9-11 fronds that can be fed without an extensive amount of weight that may damage the heart of the palm. The Sabal palmetto shall have all fronds cut without damaging the bud.
 - After root pruning trees, backfill roots to original existing grade with existing soil free of any deleterious material to root growth.
 - Provide a minimum of 3" mulch over backfill area to prevent weed growth, conserve moisture and prevent evaporation. Keep mulch 6" away from the trunk.
- Provide tree protection as per Tree Protection Detail to ensure that the tree or root system is not damaged during the root-pruning period.
 - After root pruning, during root regeneration period trees shall be watered as per standard horticultural practices.
 - Immediately prior to transplanting tie the branches of the tree up to avoid damage.
 - The root ball shall be wrapped with burlap to protect the soil around the roots and protect the roots from drying out at time of moving from the hole.
 - Finish cutting of root ball for transplanting.
 - Transplanting must occur within 24 hours after being dug for relocation. Trees/Palms should be kept in shade and the canopy kept moist.
 - Digging and preparation of the new hole for the transplant shall be done prior to removing the tree from the existing location.
 - The depth of the new hole shall be minimum equal to the depth of the root ball and the width shall be minimum equal to three times the width of the root ball. The Landscape Contractor is to verify that all new holes have appropriate perforation. Landscape Contractor is to report to the Landscape Architect if water penetration does not meet requirements for healthy plant growth.
 - Trees and palms shall be lifted from the ground with heavy equipment designed specifically for tree relocation so that the trunk and crown is not impacted and damaged by the equipment.
 - The slings used to lift the trees and heavy weight palms shall be non-binding nylon type slings that are wrapped under the root ball to support the weight of tree or heavy palm. Slings shall not be solely wrapped around the trunk of the tree that can cause damage, girdling and result in decline and death of the tree.
 - The slings used to lift the lighter weight palms shall be non-binding nylon type slings that are wrapped around the trunk to support the weight of the palm. Fastening the slings may be necessary so that the trunk or "backs" are not damaged.
 - Trees should be planted 2" max higher than their original planting level prior to relocation. Palms shall be planted at the same elevation prior to relocation.
 - The trees and palms shall be backfilled with existing soil free of deleterious material to plant growth.
 - Trees and palms shall be deep root watered to eliminate air pockets in the backfill mix prior to mulching.
 - A 6" saucer shall be created around the edge of the plant pit to help hold water, see planting detail for additional information.
 - Provide a minimum of 3" layer of mulch over saucer and backfill area outside saucer to prevent the weed growth, conserve moisture, and prevent evaporation. Keep mulch 5" away from the trunk.
 - Install tree and palm bracing as per attached details, to ensure stability of tree and palm during time period to and after transplanting, stake trees and palms after transplanting only is required to keep them stable.
- Over the guarantee period the Landscape Contractor is responsible for resetting any trees/palms that are not vertical when caused by winds less than 75 MPH.
- After transplanting trees and palms, the Landscape Contractor shall be responsible for obtaining water and watering to maintain soil moisture during the guarantee period of a minimum of:
 - First month - Daily; Second month - 3 times per week; Third and Fourth month - 2 times per week; Last Eight months - 1 time per week. For trees over 4" in caliper at the time of planting, the schedule should be: First 6 weeks - Daily; from 1.5 months to 6 months 3 times per week; last 6 months - 1 time per week.

PARAMETRIKA LAND & DESIGN
Gabriela Albomoz
Valeria Quintanilla LA6667640



1425 Marseille Dr
1425 Marseille Dr
Miami Beach, FL 33141

Rev #3: 04/05/2025

SHEET TITLE
Landscape details and notes

ISSUE DATE
03/30/2024

REVISION
March, 2024

DESIGN
GA

DRAWN
TY

SCALE
N/A

SEAL
VALERIA QUINTANILLA LA6667640

SHEET NUMBER
L-103

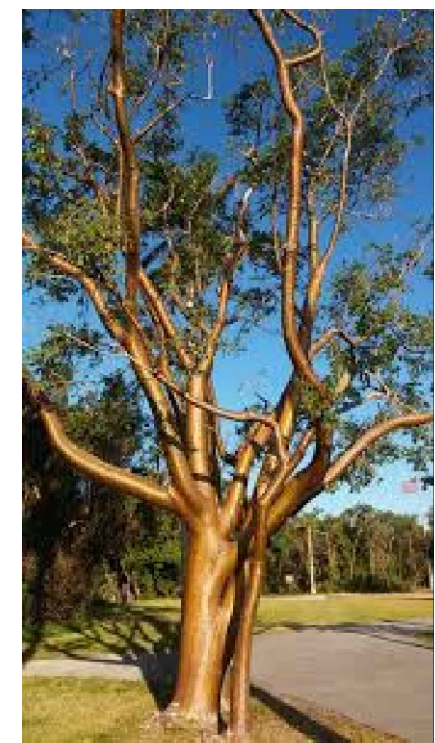

Bursera simaruba



Conocarpus erectus
'sericeus'



Coccoloba uvifera



Elaeocarpus decipiens



Plumeria Rubra



Conocarpus erectus



Dypsis cabadae



Pseudophoenix sargentii



Ptychosperma elegans



Thrinax radiata



Aglaonema nitidum



Alocasia 'Calidora'



Asparagus densiflorus 'Myers'



Begonia semperflorens



Bulbine frutescens

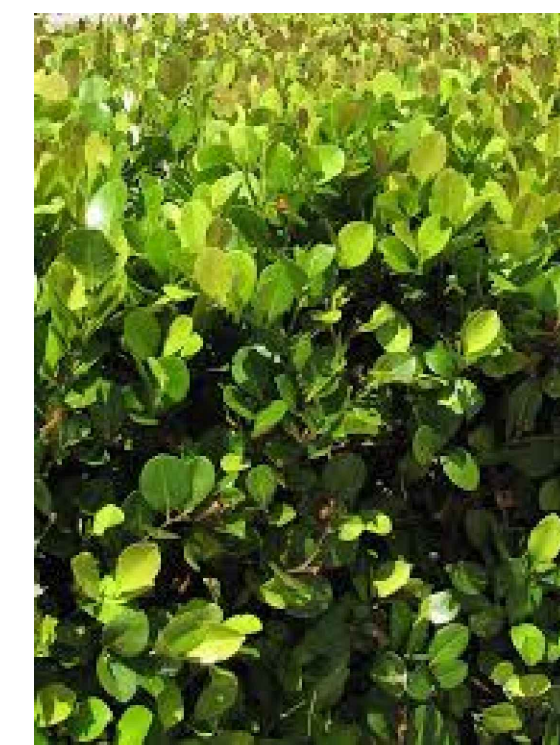

Chrysobalanus icaco 'Green'



Cycas revoluta



Dioon mejiae



Heliconia caribea



Microsorium scolopendrium



Monstera deliciosa



Nephrolepis oblitterata



Pennisetum orientale



Philodendron xanadu



Podocarpus macrophyllum

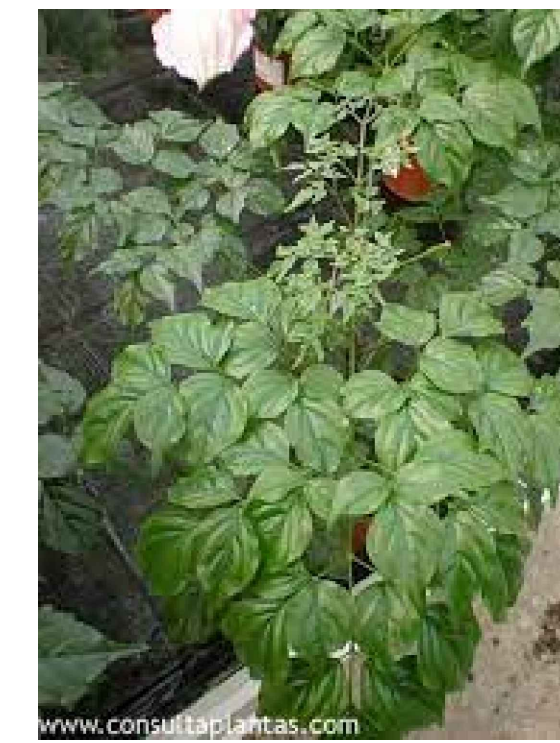

Radermachera sinica



Serenoa repens



Spartina bakeri



Strelitzia reginae



Spathoglottis plicata



Tripsacum floridanum

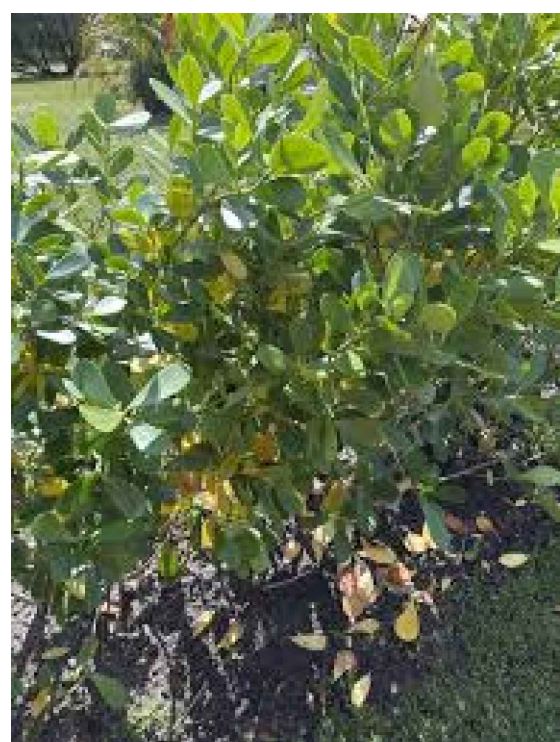

Clusia guttifera

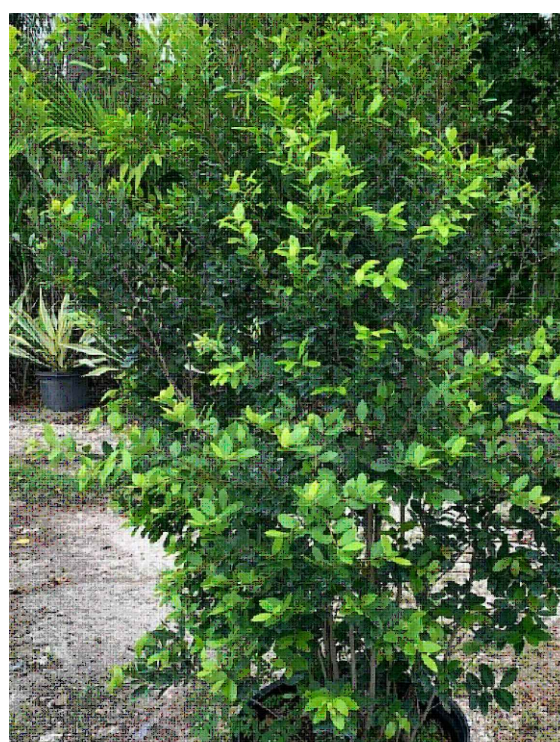

Eugenia foetida



Arachis glabrata



Carissa macrocarpa

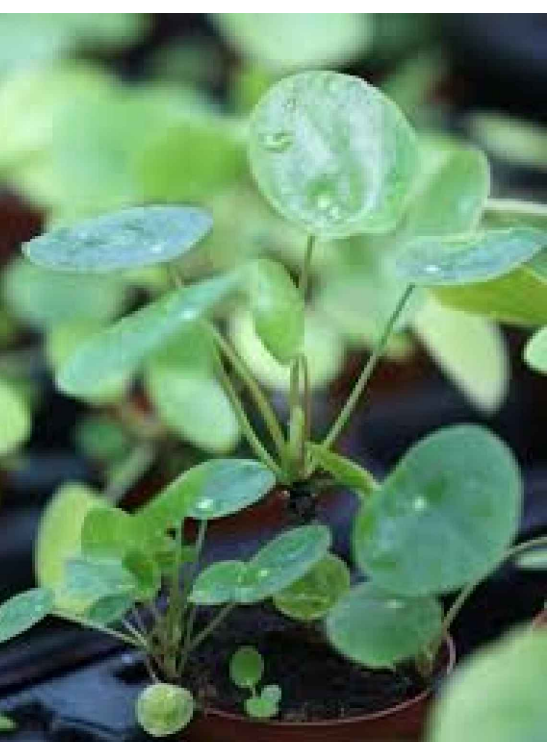

Pilea peperomioides

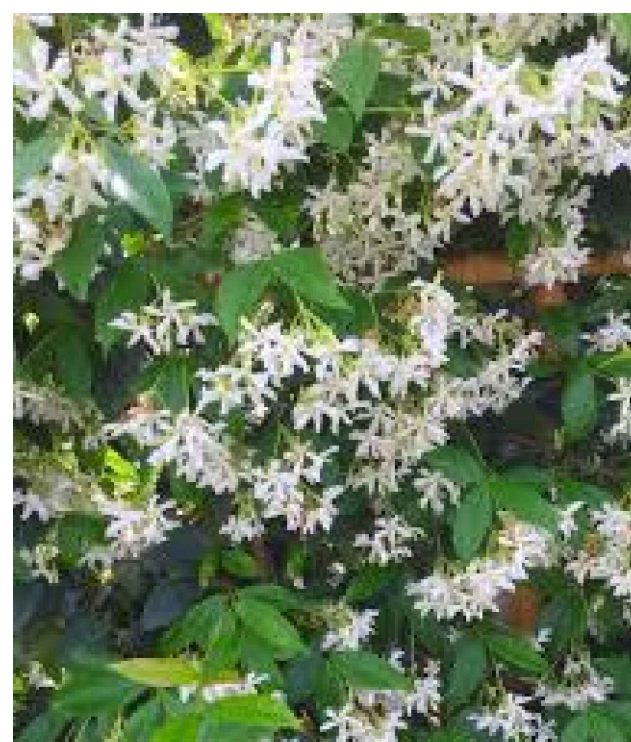

Trachelospermum asiaticum

PARAMETRIKA LAND & DESIGN
Gabriela Albomoz
Valeria Quintanilla LA6667640



1425 Marseille Dr
1425 Marseille Dr
Miami Beach, FL 33141

Rev #3: 04/05/2025

SHEET TITLE
Plant material

ISSUE DATE
02/18/2024

REVISION
FEBRUARY, 2024

DESIGN
GA

DRAWN
TY

SCALE
N/A

SEAL
VALERIA QUINTANILLA
LA6667640

SHEET NUMBER
L-104