

LEGEND

- PROPERTY LINE
- - - 25' FPL EASEMENT
- PAVING, SEE HARDSCAPE PLAN
- PLANTED AREA
- LAWN
- EXISTING TREE TO REMAIN
- PROPOSED TREE
- SHRUB PLANTING

Michael D. Conner
 Digitally signed by Michael D. Conner
 Date: 2025.02.16 16:43:38 -0500

1" = 50'

MICHAEL CONNER, STATE OF FLORIDA REGISTERED PROFESSIONAL ARCHITECT
 THIS ITEM HAS BEEN DIGITALLY SIGNED AND SEALED BY MICHAEL CONNER, R.L.L.A. ON THE DATE INDICATED HEREIN. THIS DOCUMENT IS NOT CONSIDERED SIGNED AND SEALED AND THE SIGNATURE MUST BE VERIFIED ON ANY ELECTRONIC COPY.

LANDSCAPE PLAN

MIAMI BEACH - 72ND STREET COMMUNITY COMPLEX
 299 72ND STREET
 MIAMI BEACH, FLORIDA. 33141

WJ ARCHITECTS
 (727) 822-5566
 www.wjarc.com
 AR64244



©Wannamacher James Architects, Inc.

DRB24 - 1072
 FINAL SUBMITTAL
 FEBRUARY 14, 2025

LA01

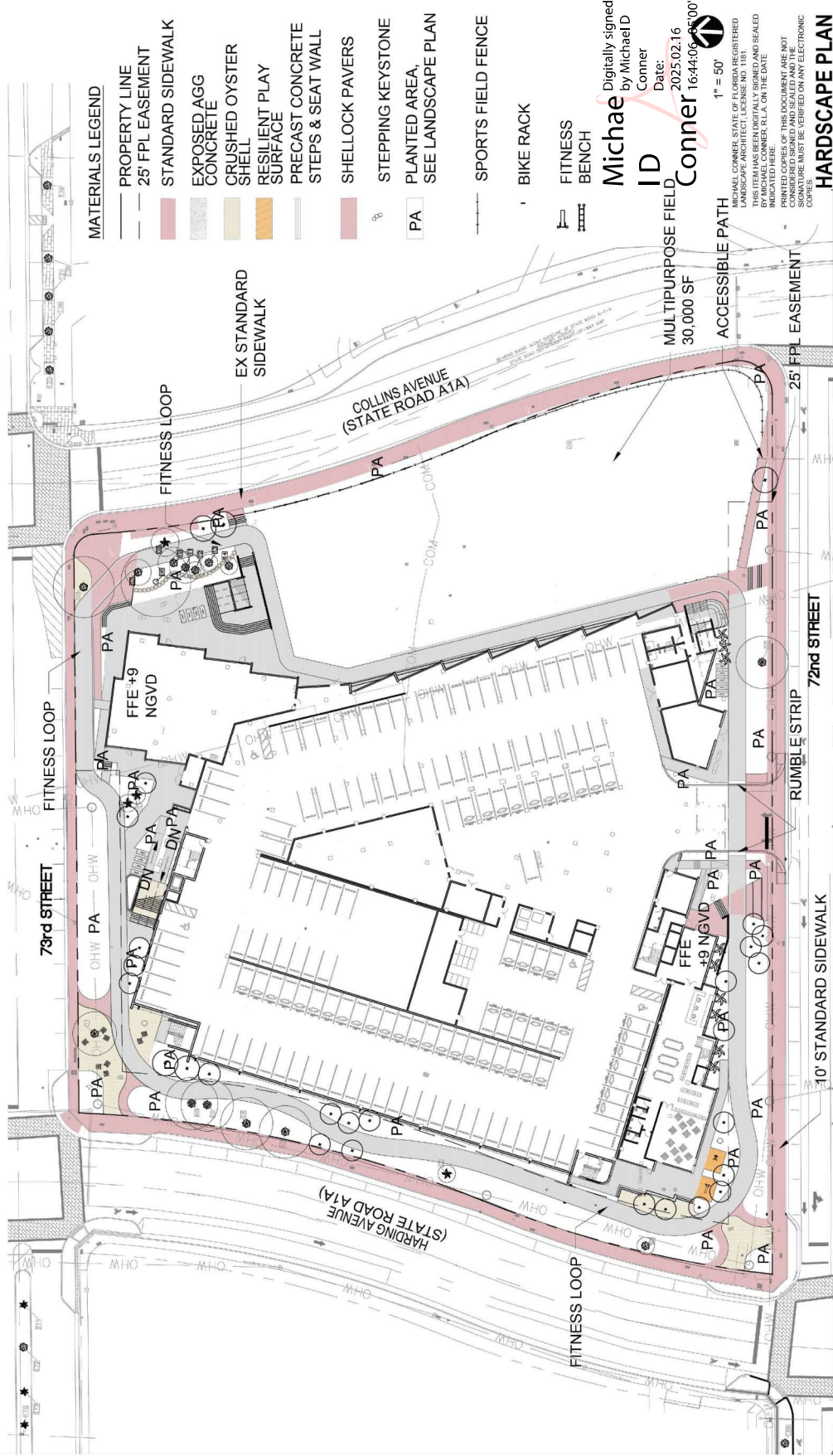

MATERIALS LEGEND

- PROPERTY LINE
- 25' FPL EASEMENT
- STANDARD SIDEWALK
- EXPOSED AGG CONCRETE
- CRUSHED OYSTER SHELL
- RESILIENT PLAY SURFACE
- PRECAST CONCRETE STEPS & SEAT WALL
- SHELLOCK PAVERS
- STEPPING KEYSTONE
- PLANTED AREA, SEE LANDSCAPE PLAN
- SPORTS FIELD FENCE

BIKE RACK

FITNESS BENCH

Digitally signed
by Michael D
Conner
Date: 2025.02.16
16:44:09 -0500

1" = 50'

MICHAEL CONNER, STATE OF FLORIDA REGISTERED ARCHITECT
THIS ITEM HAS BEEN DIGITALLY SIGNED AND SEALED BY MICHAEL CONNER, R.L.L.A. ON THE DATE INDICATED HEREIN. IF THIS DOCUMENT IS NOT CONSIDERED SIGNED AND SEALED AND THE SIGNATURE MUST BE VERIFIED ON ANY ELECTRONIC COPY.

HARDSCAPE PLAN

MIAMI BEACH - 72ND STREET COMMUNITY COMPLEX
299 72ND STREET
MIAMI BEACH, FLORIDA. 33141

WJ ARCHITECTS
(772) 822-5566
www.wjarc.com
AR64244



©Walterman Johnson Architects, Inc.

DRB24 - 1072
FINAL SUBMITTAL
FEBRUARY 14, 2025

LA02

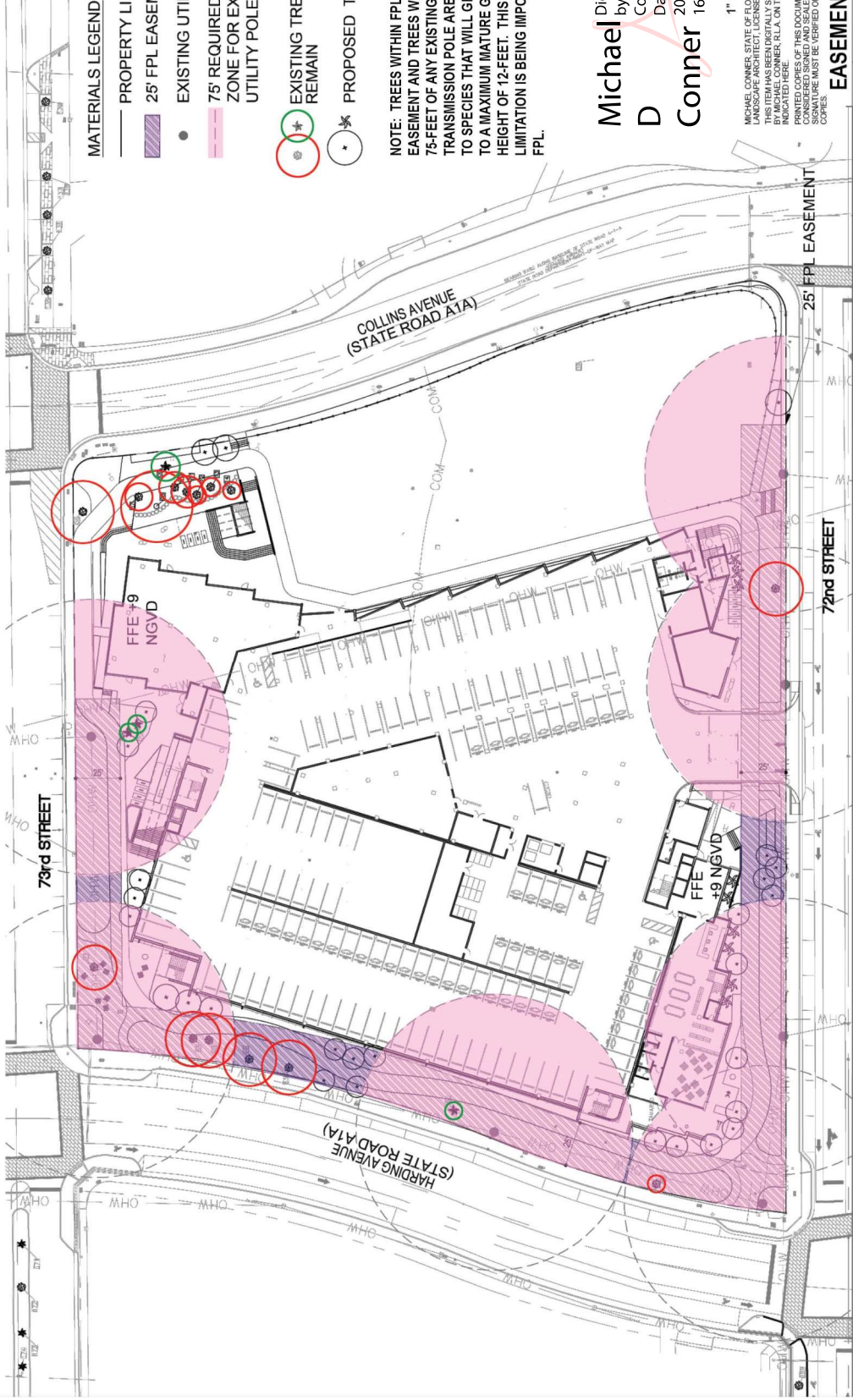

MATERIALS LEGEND

- PROPERTY LINE
- ▨ 25' FPL EASEMENT
- EXISTING UTILITY POLE
- ▨ 75' REQUIRED CLEAR ZONE FOR EXISTING UTILITY POLE
- ⊕ EXISTING TREE TO REMAIN
- ⊗ PROPOSED TREE

NOTE: TREES WITHIN FPL'S EASEMENT AND TREES WITHIN 75- FEET OF ANY EXISTING FPL TRANSMISSION POLE ARE LIMITED TO SPECIES THAT WILL GROW TO A MAXIMUM MATURE GROWTH HEIGHT OF 12- FEET. THIS LIMITATION IS BEING IMPOSED BY FPL.

Michael D Digitally signed by Michael D
Conner 2025.02.16
 Date: 16:44:33 -05:00
 1" = 50'

MICHAEL CONNER, STATE OF FLORIDA - REGISTERED PROFESSIONAL ARCHITECT
 THIS ITEM HAS BEEN DIGITALLY SIGNED AND SEALED BY MICHAEL CONNER, R.L.A. ON THE DATE INDICATED. COPIES OF THIS DOCUMENT ARE NOT CONSIDERED SIGNED AND SEALED AND THE SIGNATURE MUST BE VERIFIED ON ANY ELECTRONIC COPIES.

EASEMENT PLAN

MIAMI BEACH - 72ND STREET COMMUNITY COMPLEX
 299 72ND STREET
 MIAMI BEACH, FLORIDA. 33141

WA WJ ARCHITECTS
 (772) 822-5566
 www.wjarc.com
 AR94244
©Wannermacher Jason Architects, Inc.

DRB24 - 1072
 FINAL SUBMITTAL
 FEBRUARY 14, 2025

LA03

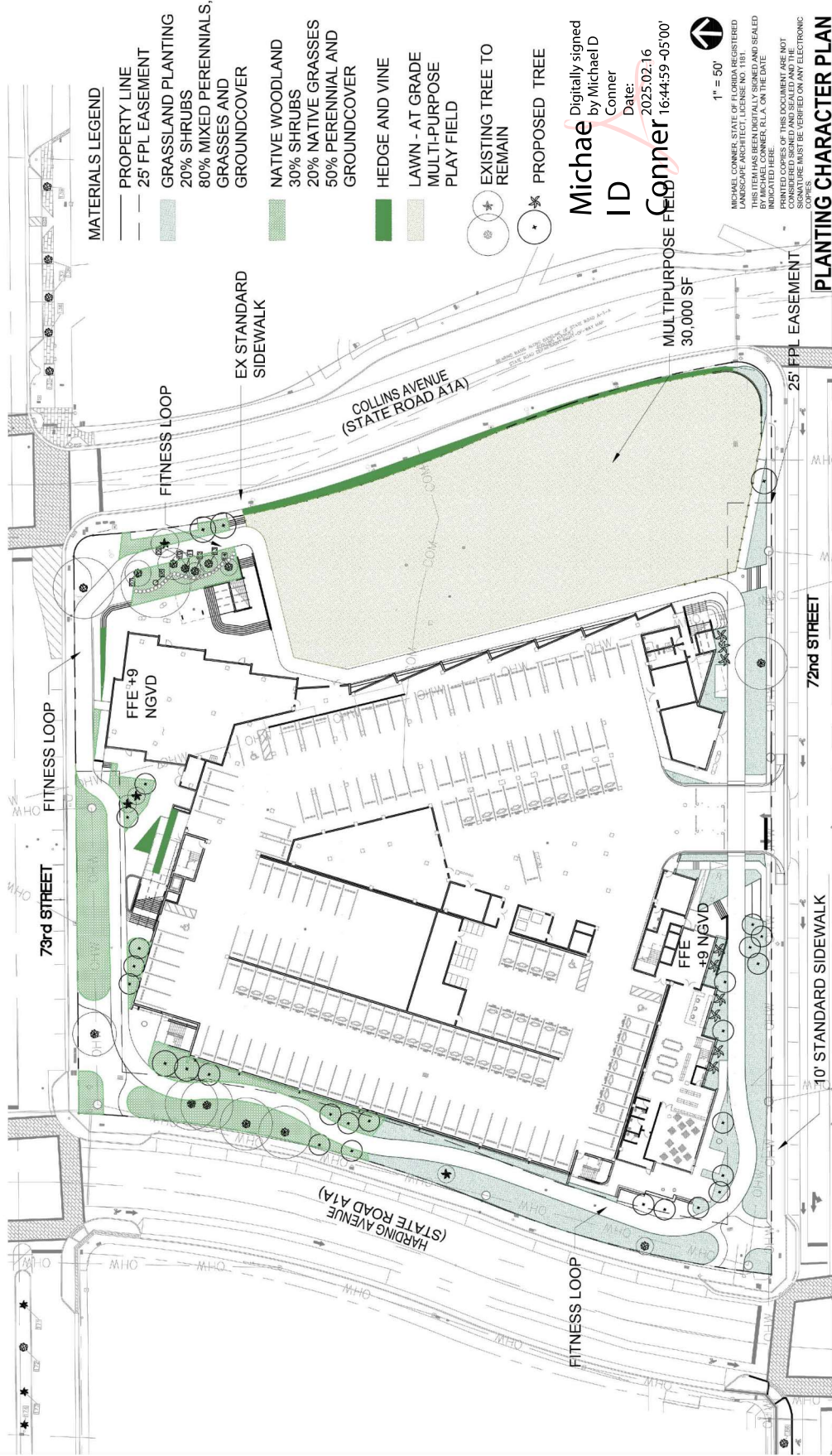

MATERIALS LEGEND

- PROPERTY LINE
- - - 25' FPL EASEMENT
- GRASSLAND PLANTING
- 20% SHRUBS
- 80% MIXED PERENNIALS, GRASSES AND GROUND COVER
- NATIVE WOODLAND
- 30% SHRUBS
- 20% NATIVE GRASSES
- 50% PERENNIAL AND GROUND COVER
- HEDGE AND VINE
- LAWN - AT GRADE
- MULTI-PURPOSE PLAY FIELD
- EXISTING TREE TO REMAIN
- PROPOSED TREE

Michael ID
 Digitally signed by Michael ID
 Conner
 Date: 2025.02.16 16:44:59 -05'00'

Michael Conner
 Digitally signed by Michael Conner
 Date: 2025.02.16 16:44:59 -05'00'



1" = 50'

MICHAEL CONNER, STATE OF FLORIDA REGISTERED PROFESSIONAL ARCHITECT
 THIS ITEM HAS BEEN DIGITALLY SIGNED AND SEALED BY MICHAEL CONNER, R.L.A. ON THE DATE INDICATED HEREIN. THIS DOCUMENT IS NOT CONSIDERED SIGNED AND SEALED AND THE SIGNATURE MUST BE VERIFIED ON ANY ELECTRONIC FILE.

PLANTING CHARACTER PLAN

MIAMI BEACH - 72ND STREET COMMUNITY COMPLEX
 299 72ND STREET
 MIAMI BEACH, FLORIDA. 33141

WJ ARCHITECTS
 (777) 822-5566
 www.wjarc.com
 AR64244



©WattmanArchitects.com

LA04

DRB24 - 1072
 FINAL SUBMITTAL
 FEBRUARY 14, 2025

LANDSCAPE PLANTING - ZONING DATA TABLE

LOT DATA	Zoning Category	GU	(166834.8	Square Feet)
	Lot Area	3.83 Acres	(1665.56	Actual Linear Feet)
	Lot Frontage	1,666 Adjusted Linear Feet		

	LOT TREES	STREET TREES	SHRUBS
MINIMUM REQUIREMENTS			
Applicable Standard	22 per Acre	1 per 20 LF	12 per req'd Tree
Calculated Min Req't's	84.26 Lot Trees	83.3 Street Trees	2028 Shrubs
Adjusted Min Req't's	85 Lot Trees	84 Street Trees	
Credit for Existing Trees	7 Lot Trees T-007 T-008 T-006 T-010 T-011 T-061 T-012 T-013 T-014	8 Street Trees T-001 T-006 T-056 T-061 T-063 T-064 T-065 T-066	
Total Minimum Req'ts Provided	78 Lot Trees Req'd 2 Lot Trees 76 Lot Trees	76 Street Trees Req'd 2 Street Trees 74 Street Trees	2028 Shrubs Req'd 6887 Shrubs Provided 0 Shrubs Deficient
Sum of Tree Deficiency	150 Trees		
Tree Fund Compliance Options (Per Sec. 4.2.4)	\$2,500 per Tree		
Total Tree Fund Contribution	\$375,000		
			203 Lg Shrubs Req'd 203 Shrubs Provided 0 Shrubs Deficient
			50% Min Native Req't 1017 Min Native Req't 3617 Provided

Michael D
Conner

Digitally signed by Michael D Conner
Date: 2025.02.16 16:45:31 -05'00'

MICHAEL CONNER, STATE OF FLORIDA REGISTERED LANDSCAPE ARCHITECT, LICENSE NO. 11911, HAS REVIEWED AND SEALED THIS DOCUMENT AND IS NOT PROVIDING ANY PROFESSIONAL SERVICES IN CONNECTION WITH THIS DOCUMENT. MICHAEL CONNER, R.L.A., ON THE DATE INDICATED HERE.
PRINTED COPIES OF THIS DOCUMENT ARE NOT VALID. ALL SIGNATURES AND E-SEALS MUST BE VERIFIED ON ANY ELECTRONIC COPIES.

MINIMUM REQUIREMENTS PER CHAPTER 4

WJ ARCHITECTS
(727) 822-5566
www.wjarc.com
AR94244



MIAMI BEACH - 72ND STREET COMMUNITY COMPLEX
299 72ND STREET
MIAMI BEACH, FLORIDA. 33141

DRB24 - 1072
FINAL SUBMITTAL
FEBRUARY 14, 2025

LA05

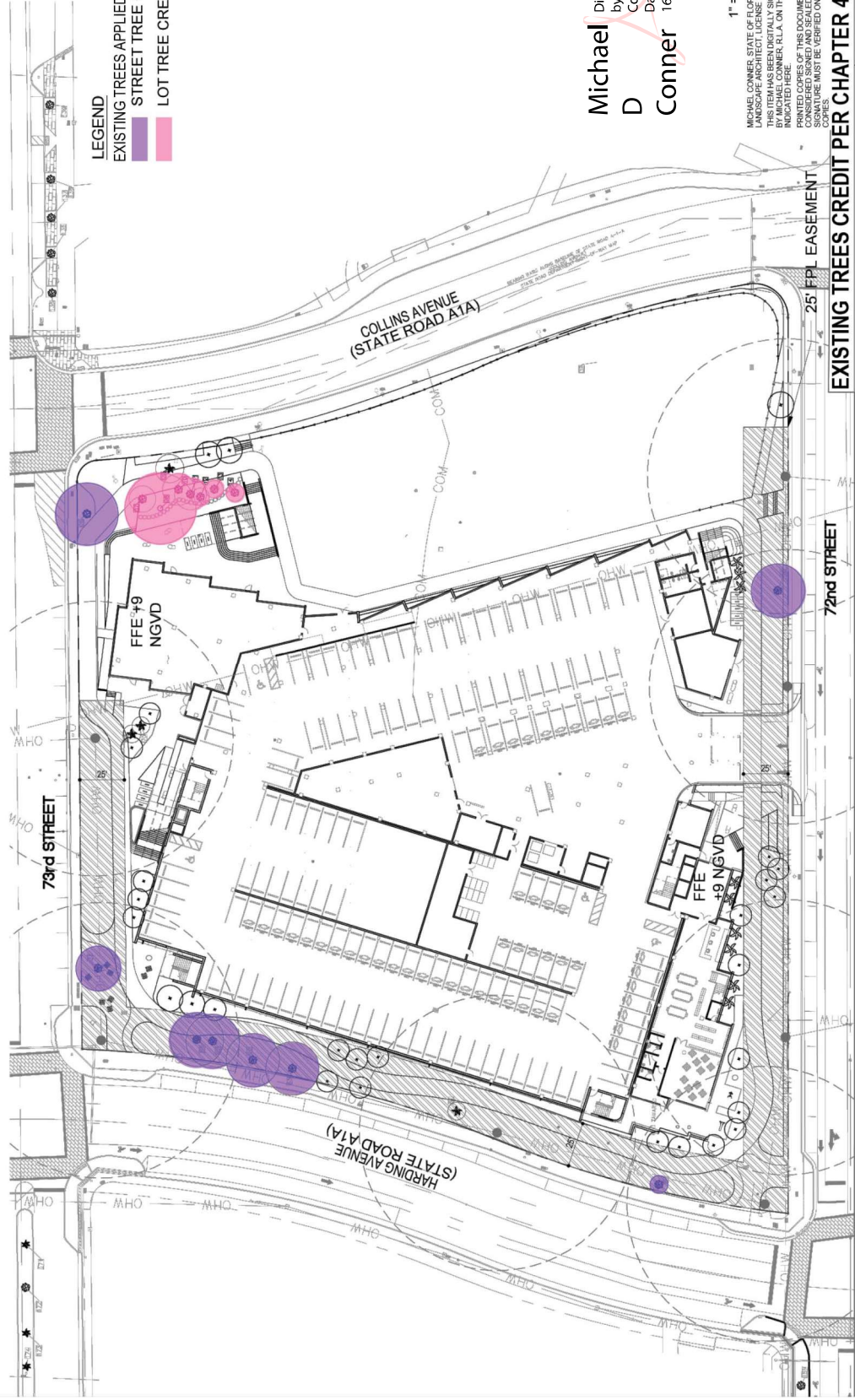

LEGEND
 EXISTING TREES APPLIED AS CREDITS
 STREET TREE CREDIT
 LOT TREE CREDIT

Michael D. Conner
 Digitally signed by Michael D. Conner
 Date: 2025.02.16 16:45:53 -0500



MICHAEL CONNER, STATE OF FLORIDA REGISTERED PROFESSIONAL ARCHITECT
 THIS ITEM HAS BEEN DIGITALLY SIGNED AND SEALED BY MICHAEL CONNER, R.L.A. ON THE DATE INDICATED. THESE CREDITS ARE NOT CONSIDERED SIGNED AND SEALED AND THE SIGNATURE MUST BE VERIFIED ON ANY ELECTRONIC DOCUMENT.

EXISTING TREES CREDIT PER CHAPTER 4.2.3(C)5

MIAMI BEACH - 72ND STREET COMMUNITY COMPLEX

DRB24 - 1072
 FINAL SUBMITTAL
 FEBRUARY 14, 2025

LA06

WJ
 WJ ARCHITECTS
 (727) 822-5566
 www.wjarc.com
 AR64244

299 72ND STREET
 MIAMI BEACH, FLORIDA. 33141

©Wannermacher Jason Architects, Inc.

TREES		Total Contribution for Non-Specimen Trees	\$50,000.00
PALMS		Total Contribution for Specimen Trees	\$892,000.00
Total number of Palms to be Mitigated		30.0	Palms
DBH inches conversion per Palm: 1 palm = 2.0 equivalent inches DBH (Sec 4.2.3(e))		60.0 inches	
Total Contribution for Palms		\$20,000.00	
TOTAL SUM TREE FUND CONTRIBUTION		\$ 962,000.00	
Calculation Details for Tree Mitigation			
NON-SPECIMEN TREES			
TOTAL SUM OF NON-SPECIMEN TREE DBH TO BE REMOVED (Actual Sum)		145.3	
TOTAL SUM OF NON-SPECIMEN TREE DBH TO BE REMOVED (Adjusted Sum)		146.0	
RANGE	Applicable Inches		
0 - 60	60	\$ 20,000.00	
60 - 120	60	\$ 20,000.00	
120 - 180	36	\$ 10,000.00	
EQUIVALENT TREE FUND CONTRIBUTION		\$ 50,000.00	
SPECIMEN TREES			
TOTAL SUM OF NON-SPECIMEN TREE DBH TO BE REMOVED (Actual Sum)		1335.0	
TOTAL SUM OF NON-SPECIMEN TREE DBH TO BE REMOVED (Adjusted Sum)		1336.0	
RANGE	Applicable Inches		Per Code, Specimen trees shall be replaced at a ratio of 2x
0 - 60	60	\$ 20,000.00	x 2 = \$ 40,000.00
60 - 120	60	\$ 20,000.00	x 2 = \$ 40,000.00
120 - 180	60	\$ 20,000.00	x 2 = \$ 40,000.00
180 - 240	60	\$ 20,000.00	x 2 = \$ 40,000.00
240 - 300	60	\$ 20,000.00	x 2 = \$ 40,000.00
300 - 360	60	\$ 20,000.00	x 2 = \$ 40,000.00
360 - 420	60	\$ 20,000.00	x 2 = \$ 40,000.00
420 - 480	60	\$ 20,000.00	x 2 = \$ 40,000.00
480 - 540	60	\$ 20,000.00	x 2 = \$ 40,000.00
540 - 600	60	\$ 20,000.00	x 2 = \$ 40,000.00
600 - 660	60	\$ 20,000.00	x 2 = \$ 40,000.00
660 - 720	60	\$ 20,000.00	x 2 = \$ 40,000.00
720 - 780	60	\$ 20,000.00	x 2 = \$ 40,000.00
780 - 840	60	\$ 20,000.00	x 2 = \$ 40,000.00
840 - 900	60	\$ 20,000.00	x 2 = \$ 40,000.00
900 - 960	60	\$ 20,000.00	x 2 = \$ 40,000.00
960 - 1020	60	\$ 20,000.00	x 2 = \$ 40,000.00
1020 - 1080	60	\$ 20,000.00	x 2 = \$ 40,000.00
1080 - 1140	60	\$ 20,000.00	x 2 = \$ 40,000.00
1140 - 1200	60	\$ 20,000.00	x 2 = \$ 40,000.00
1200 - 1260	60	\$ 20,000.00	x 2 = \$ 40,000.00
1260 - 1320	60	\$ 20,000.00	x 2 = \$ 40,000.00
1320 - 1385	16	\$ 6,000.00	x 2 = \$ 12,000.00
EQUIVALENT TREE FUND CONTRIBUTION		\$ 892,000.00	

TREE REPLACEMENT CHART & TREE FUND CONTRIBUTIONS

Total diameter (inches) of trees to be replaced (or a minimum of 2" DBH x 6' spread in canopy x 1/2 in height)	Total number of replacement trees required (where tree is a minimum of 2" DBH x 6' spread in canopy x 1/2 in height)	Total number of replacement trees required (where tree is a minimum of 4" DBH x 8' spread in canopy x 10 in height)	Contributions to Tree Trust Fund
2"-3"	1	0	or \$1,000.00
4"-6"	2	1	or \$2,000.00
7"-12"	4	2	or \$4,000.00
13"-18"	6	3	or \$6,000.00
19"-24"	8	4	or \$8,000.00
25"-30"	10	5	or \$10,000.00
31"-42"	14	7	or \$14,000.00
43"-48"	16	8	or \$16,000.00
49"-60"	20	10	or \$20,000.00

Michael D Conner
 Digitally signed by Michael D Conner
 Date: 2025.02.16 16:46:16 -0500'

MICHAEL CONNER, STATE OF FLORIDA REGISTERED PROFESSIONAL ARCHITECT
 THIS ITEM HAS BEEN DIGITALLY SIGNED AND SEALED BY MICHAEL CONNER, R.L.A. ON THE DATE INDICATED HEREIN. SIGNATURES OF THIS DOCUMENT ARE NOT CONSIDERED SIGNED AND SEALED AND THE SIGNATURE MUST BE VERIFIED ON ANY ELECTRONIC

OVERALL TREE FUND CALCULATIONS

MIAMI BEACH - 72ND STREET COMMUNITY COMPLEX
 299 72ND STREET
 MIAMI BEACH, FLORIDA, 33141

WJ ARCHITECTS
 (727) 822-5566
 www.wjarc.com
 AR64244



LA07

DRB24 - 1072
 FINAL SUBMITTAL
 FEBRUARY 14, 2025

TREE MITIGATION SCHEDULE															
TREE NO.	BOTANICAL NAME	COMMON NAME	NATIVE	TRUNK#	SIZE			AREA (SF)	ACTION	CONDITION	DBH OF INDIVIDUAL TRUNKS				
					DBH (IN)	HT (FT)	SPRD (FT)				#1	#2	#3	#4	#5
NON-SPECIMEN PALMS															
002 (P)	Veitchia arcaea	Montgomery Palm		1	7.0"	25'	10'	78.5 Sq. Ft.	REMOVE	Poor	7.0"				
003 (P)	Veitchia arcaea	Montgomery Palm		1	6.8"	20'	10'	78.5 Sq. Ft.	REMOVE	Fair	6.8"				
004 (P)	Veitchia arcaea	Montgomery Palm		1	9.8"	20'	12'	113.5 Sq. Ft.	REMOVE	Fair	9.8"				
009 (P)	Biomarckia nobilis	Biomarck Palm		1	11.6"	24'	30'	314.5 Sq. Ft.	REMOVE	Fair	11.6"				
020 (P)	Sabal palmetto	Cabbage Palm	Y	1	11.0"	15'	10'	78.5 Sq. Ft.	REMOVE	Fair	11.0"				
021 (P)	Sabal palmetto	Cabbage Palm		1	9.9"	8'	8'	50.5 Sq. Ft.	REMOVE	Very Poor	9.9"				
022 (P)	Biomarckia nobilis	Biomarck Palm	Y	1	11.4"	28'	20'	314.5 Sq. Ft.	REMOVE	Fair	11.4"				
029 (P)	Cocos nucifera	Coconut Palm		1	9.1"	28'	20'	314.5 Sq. Ft.	REMOVE	Fair	9.1"				
030 (P)	Cocos nucifera	Coconut Palm		1	10.3"	28'	20'	314.5 Sq. Ft.	REMOVE	Fair	10.3"				
031 (P)	Cocos nucifera	Coconut Palm		1	10"	24'	15'	176.5 Sq. Ft.	REMOVE	Fair	10"				
032 (P)	Cocos nucifera	Coconut Palm		1	8.9"	20'	18'	254.5 Sq. Ft.	REMOVE	Fair	8.9"				
037 (P)	Cocos nucifera	Coconut Palm		1	10.0"	30'	15'	176.5 Sq. Ft.	REMOVE	Fair	10.0"				
068 (P)	Veitchia arcaea	Montgomery Palm		1	7.6"	25'	8'	50.5 Sq. Ft.	REMOVE	Fair	7.6"				
072 (P)	Veitchia arcaea	Montgomery Palm		1	7.3"	17'	12'	113.5 Sq. Ft.	REMOVE	Fair	7.3"				
073 (P)	Veitchia arcaea	Montgomery Palm		1	6.5"	17'	12'	113.5 Sq. Ft.	REMOVE	Fair	6.5"				
074 (P)	Veitchia arcaea	Montgomery Palm		1	6.1"	17'	12'	113.5 Sq. Ft.	REMOVE	Fair	6.1"				
103 (P)	Cocos nucifera	Coconut Palm		1	10.0"	28'	20'	314.5 Sq. Ft.	REMOVE	Fair	10.0"				
111 (P)	Cocos nucifera	Coconut Palm		1	9.6"	15'	3'	24.5 Sq. Ft.	REMOVE	Very Poor	9.6"				
112 (P)	Cocos nucifera	Coconut Palm		1	8.7"	28'	15'	176.5 Sq. Ft.	REMOVE	Fair	8.7"				
113 (P)	Cocos nucifera	Coconut Palm		1	8.2"	24'	15'	176.5 Sq. Ft.	REMOVE	Fair	8.2"				
114 (P)	Cocos nucifera	Coconut Palm		1	7.9"	30'	15'	176.5 Sq. Ft.	REMOVE	Fair	7.9"				
120 (P)	Cocos nucifera	Coconut Palm		1	9.7"	30'	8'	50.5 Sq. Ft.	REMOVE	Fair	9.7"				
121 (P)	Veitchia arcaea	Montgomery Palm		1	6"	14'	12'	113.5 Sq. Ft.	REMOVE	Poor	6"				
122 (P)	Veitchia arcaea	Montgomery Palm		1	6"	14'	12'	113.5 Sq. Ft.	REMOVE	Poor	6"				
				TOTAL NUMBER OF NON-SPECIMEN PALMS TO BE REMOVED					24.0						
				TOTAL NON-SPECIMEN PALMS MITIGATION REQUIRED (1 Palm = 1 Tree Equiv)					24.0						
SPECIMEN PALMS															
018 (P)	Biomarckia nobilis	Biomarck Palm		1	13.7"	35'	20'	314.5 Sq. Ft.	REMOVE	Fair	13.7"				
049 (P)	Biomarckia nobilis	Biomarck Palm		1	13.3"	24'	15'	176.5 Sq. Ft.	REMOVE	Fair	13.3"				
050 (P)	Biomarckia nobilis	Biomarck Palm		1	16.2"	27'	15'	176.5 Sq. Ft.	REMOVE	Fair	16.2"				
052 (P)	Biomarckia nobilis	Biomarck Palm		1	15.3"	25'	15'	176.5 Sq. Ft.	REMOVE	Fair	15.3"				
060 (P)	Sabal palmetto	Cabbage Palm		1	12.8"	15'	15'	176.5 Sq. Ft.	REMOVE	Poor	12.8"				
				TOTAL NUMBER OF SPECIMEN PALMS TO BE REMOVED					3.0						
				TOTAL SPECIMEN PALMS MITIGATION REQUIRED (1 Palm = 2 Tree Equiv)					6.0						

Digitally signed
by Michael D
Conner
Date: 2025.02.16
16:47:43 -05'00'

MICHAEL CONNER STATE OF FLORIDA REGISTERED
LANDSCAPE ARCHITECT LICENSE #12456
THIS ITEM HAS BEEN DIGITALLY SIGNED AND SEALED
BY MICHAEL CONNER R.L.A. ON THE DATE
INDICATED HERE.
FOR VALIDATION OF THIS DOCUMENT, SEE NOT
CONSIDERED SIGNED AND SEALED AND THE
SIGNATURE MUST BE VERIFIED ON ANY ELECTRONIC
COPY.

TREE FUND CALCULATIONS (1/3)



WJ ARCHITECTS
(727) 822-5566
www.wjarc.com
AR94244

MIAMI BEACH - 72ND STREET COMMUNITY COMPLEX
299 72ND STREET
MIAMI BEACH, FLORIDA. 33141

DRB24 - 1072
FINAL SUBMITTAL
FEBRUARY 14, 2025

LA08

TREE NO.	BOTANICAL NAME	COMMON NAME	NATIVE	TREE SIZE				ACTION	CONDITION	DBH OF INDIVIDUAL TRUNKS												
				TRUNK#	DBH (IN)	HT (FT)	SPRD (FT)			AREA (SF)	#1	#2	#3	#4	#5							
NON-SPECIMEN TREES																						
034 (T)	Coccoloba uvifera	Sesagapea Tree	Y	1	6.3	25'	15'	176 Sq. Ft.	REMOVE	Poor	6.3											
036 (T)	Coccoloba uvifera	Sesagapea Tree	Y	2	10.5	17'	15'	76.5 Sq. Ft.	REMOVE	Poor	4.4	6.1										
027 (T)	Coccoloba uvifera	Sesagapea Tree	Y	1	8.7	15'	23'	415 Sq. Ft.	REMOVE	Fair	8.7											
039 (T)	Coccoloba uvifera	Sesagapea Tree	Y	1	6.2	8'	5'	20.5 Sq. Ft.	REMOVE	Very Poor	6.2											
040 (T)	Coccoloba uvifera	Sesagapea Tree	Y	1	7.5	15'	10'	78.5 Sq. Ft.	REMOVE	Poor	7.5											
042 (T)	Coccoloba uvifera	Sesagapea Tree	Y	2	8.7	15'	10'	78.5 Sq. Ft.	REMOVE	Poor	2.3	6.4										
043 (T)	Coccoloba uvifera	Sesagapea Tree	Y	1	5.2	12'	15'	176 Sq. Ft.	REMOVE	Very Poor	5.2											
044 (T)	Coccoloba uvifera	Sesagapea Tree	Y	1	5.3	9'	5'	20.5 Sq. Ft.	REMOVE	Very Poor	5.3											
046 (T)	Coccoloba uvifera	Sesagapea Tree	Y	1	6.4	17'	15'	176 Sq. Ft.	REMOVE	Fair	6.4											
048 (T)	Coccoloba uvifera	Sesagapea Tree	Y	1	10.0	20'	20'	314 Sq. Ft.	REMOVE	Fair	10.0											
097 (T)	Sweetenia mahagoni	Mahogany Tree	Y	1	8.0	20'	15'	176 Sq. Ft.	REMOVE	Poor	8.0											
099 (T)	Sweetenia mahagoni	Mahogany Tree	Y	1	9.8	15'	18'	295 Sq. Ft.	REMOVE	Fair	9.8											
100 (T)	Sweetenia mahagoni	Mahogany Tree	Y	1	10.4	22'	22'	380 Sq. Ft.	REMOVE	Fair	10.4											
103 (T)	Sweetenia mahagoni	Mahogany Tree	Y	1	10.3	15'	18'	295 Sq. Ft.	REMOVE	Very Poor	10.3											
105 (T)	Sweetenia mahagoni	Mahogany Tree	Y	1	11.9	15'	18'	295 Sq. Ft.	REMOVE	Poor	11.9											
109 (T)	Sweetenia mahagoni	Mahogany Tree	Y	1	10.9	20'	23'	416 Sq. Ft.	REMOVE	Fair	10.9											
115 (T)	Delonix regia	Royal Poinciana Tree	Y	1	9.2	12'	20'	314 Sq. Ft.	REMOVE	Very Poor	9.2											
TOTAL SUM OF NON-SPECIMEN TREE DBH TO BE REMOVED:										145.3												
TOTAL NON-SPECIMEN TREE DBH MITIGATION REQUIRED:										145.3												

Michael D Conner
 Digitally signed by Michael D Conner
 Date: 2025.02.16 16:48:10 -05'00'

MIKE CONNER, STATE OF FLORIDA, REGISTERED LANDSCAPE ARCHITECT LICENSE NO. 12000
 THIS ITEM HAS BEEN DIGITALLY SIGNED AND SEALED BY MICHAEL CONNER, R.L.L.A. ON THE DATE INDICATED HERE.
 PRINTED COPIES OF THIS DOCUMENT ARE NOT CONSIDERED SIGNED AND SEALED AND THE SIGNATURE MUST BE VERIFIED ON ANY ELECTRONIC COPY.

TREE FUND CALCULATIONS (2/3)

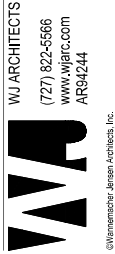

WJ ARCHITECTS
 (727) 822-5566
 www.wjarc.com
 AR94244

MIAMI BEACH - 72ND STREET COMMUNITY COMPLEX
 299 72ND STREET
 MIAMI BEACH, FLORIDA. 33141

DRB24 - 1072
 FINAL SUBMITTAL
 FEBRUARY 14, 2025

LA09

TREE NO.	BOTANICAL NAME	COMMON NAME	NATIVE	TREE SIZE				AREA (SF)	CONDITION	DBH OF INDIVIDUAL TRUNKS				
				TRUNK#	DBH (IN)	HT (FT)	SPRD (FT)			#1	#2	#3	#4	#5
005 (T)	Coccoloba uifera	Seagrape Tree	Y	1	31.2	25'	32'	803 Sq. Ft.	Fair	31.2				
015 (T)	Coccoloba uifera	Seagrape Tree	Y	1	41.3	25'	50'	1,685 Sq. Ft.	Poor	41.3				
017 (T)	Coccoloba uifera	Seagrape Tree	Y	3	32.7	18'	24'	452 Sq. Ft.	Poor	10.5	11.0	11.2		
023 (T)	Coccoloba uifera	Seagrape Tree	Y	2	15.8	25'	20'	314 Sq. Ft.	Fair	9.2	6.6			
025 (T)	Coccoloba uifera	Seagrape Tree	Y	3	17.4	18'	23'	415 Sq. Ft.	Poor	7.3	4.1	6.0		
028 (T)	Coccoloba uifera	Seagrape Tree	Y	1	15.3	25'	25'	400 Sq. Ft.	Fair	15.3				
033 (T)	Coccoloba uifera	Seagrape Tree	Y	2	24.9	30'	35'	962 Sq. Ft.	Fair	18.5	6.4			
034 (T)	Coccoloba uifera	Seagrape Tree	Y	3	42.0	28'	30'	706.5 Sq. Ft.	Fair	15.0	15.0	12.0		
035 (T)	Coccoloba uifera	Seagrape Tree	Y	2	20.3	30'	30'	706.5 Sq. Ft.	Fair	22.9	6.4			
036 (T)	Coccoloba uifera	Seagrape Tree	Y	1	20.1	32'	32'	804 Sq. Ft.	Fair	20.1				
038 (T)	Coccoloba uifera	Seagrape Tree	Y	1	14.3	15'	20'	1,256 Sq. Ft.	Fair	14.3				
041 (T)	Coccoloba uifera	Seagrape Tree	Y	2	13.5	8'	45'	400 Sq. Ft.	Fair	9.0	4.5			
045 (T)	Coccoloba uifera	Seagrape Tree	Y	4	132.6	27'	32'	804 Sq. Ft.	Fair	108.0	7.7	9.9	7.0	
047 (T)	Coccoloba uifera	Seagrape Tree	Y	1	12.5	22'	20'	314 Sq. Ft.	Poor	12.5				
051 (T)	Coccoloba uifera	Seagrape Cluster	Y	4	15.3	15'	20'	314 Sq. Ft.	Poor	3.0	3.4	3.4	5.5	
053 (T)	Coccoloba uifera	Seagrape Tree	Y	2	31.4	25'	45'	1,590 Sq. Ft.	Fair	17.0	14.4			
054 (T)	Coccoloba uifera	Seagrape Tree	Y	1	14.5	25'	36'	1,018 Sq. Ft.	Fair	14.5				
055 (T)	Coccoloba uifera	Seagrape Tree	Y	3	14.2	13'	18'	285 Sq. Ft.	Fair	5.3	2.8	6.1		
057 (T)	Coccoloba uifera	Seagrape Tree	Y	4	43.1	25'	23'	415 Sq. Ft.	Poor	9.4	10.6	9.7	13.4	
059 (T)	Coccoloba uifera	Seagrape Tree	Y	1	26.9	25'	36'	1,018 Sq. Ft.	Poor	26.9				
067 (T)	Betonia regia	Royal Poinciana Tree	Y	1	12.1	15'	30'	706.5 Sq. Ft.	Fair	12.1				
071 (T)	Sweetenia mahagoni	Mahogany Tree	Y	1	20.6	35'	40'	1,256 Sq. Ft.	Fair	20.6				
075 (T)	Sweetenia mahagoni	Mahogany Tree	Y	1	14.7	24'	30'	706.5 Sq. Ft.	Poor	14.7				
076 (T)	Sweetenia mahagoni	Mahogany Tree	Y	1	14.2	22'	25'	490 Sq. Ft.	Poor	14.2				
078 (T)	Sweetenia mahagoni	Mahogany Tree	Y	1	20.3	35'	32'	1,077 Sq. Ft.	Fair	20.3				
079 (T)	Sweetenia mahagoni	Mahogany Tree	Y	1	17.2	35'	35'	500 Sq. Ft.	Fair	17.2				
080 (T)	Sweetenia mahagoni	Mahogany Tree	Y	1	18.6	35'	35'	662 Sq. Ft.	Fair	18.6				
081 (T)	Sweetenia mahagoni	Mahogany Tree	Y	1	12.5	25'	35'	962 Sq. Ft.	Poor	12.5				
082 (T)	Sweetenia mahagoni	Mahogany Tree	Y	1	17.0	19'	25'	400 Sq. Ft.	Fair	17.0				
083 (T)	Sweetenia mahagoni	Mahogany Tree	Y	1	22.6	35'	40'	1,256 Sq. Ft.	Poor	22.6				
084 (T)	Sweetenia mahagoni	Mahogany Tree	Y	1	14.2	25'	25'	490 Sq. Ft.	Poor	14.2				
085 (T)	Sweetenia mahagoni	Mahogany Tree	Y	1	17.5	28'	36'	1,077 sq. ft.	REMOVE	17.5				
086 (T)	Conocarpus erectus	Buttonwood Tree	Y	1	18.1	20'	40'	1,256 Sq. Ft.	REMOVE	18.1				
087 (T)	Coccoloba uifera	Seagrape Cluster	Y	1	27.0	12',16'	20'	314 Sq. Ft.	REMOVE	27.0				
088 (T)	Conocarpus erectus	Buttonwood Tree	Y	2	44.6	25'	35'	962 Sq. Ft.	REMOVE	28.1	16.5			
089 (T)	Conocarpus erectus	Buttonwood Tree	Y	3	50.4	25'	45'	1,590 Sq. Ft.	REMOVE	20.4	16.3	13.7		
090 (T)	Conocarpus erectus	Buttonwood Tree	Y	2	24.4	10'	20'	314 Sq. Ft.	REMOVE	10.1	14.3			
091 (T)	Coccoloba uifera	Seagrape Tree	Y	3	41.6	30'	35'	962 Sq. Ft.	REMOVE	13.2	14.5	13.9		
092 (T)	Coccoloba uifera	Seagrape Tree	Y	3	60.3	38'	50'	1,962.5 Sq. Ft.	REMOVE	14.6	17.7	28.0		
093 (T)	Sweetenia mahagoni	Mahogany Tree	Y	1	12.4	30'	22'	380 Sq. Ft.	REMOVE	12.4				
094 (T)	Sweetenia mahagoni	Mahogany Tree	Y	1	20.5	27'	36'	1,077 Sq. Ft.	REMOVE	20.5				
095 (T)	Sweetenia mahagoni	Mahogany Tree	Y	1	14.7	27'	25'	490 Sq. Ft.	REMOVE	14.7				
096 (T)	Sweetenia mahagoni	Mahogany Tree	Y	1	14.8	25'	25'	490 Sq. Ft.	REMOVE	14.8				
098 (T)	Sweetenia mahagoni	Mahogany Tree	Y	1	18.4	27'	30'	706.5 Sq. Ft.	REMOVE	18.4				
101 (T)	Sweetenia mahagoni	Mahogany Tree	Y	1	15.3	25'	25'	490 Sq. Ft.	REMOVE	15.3				
102 (T)	Sweetenia mahagoni	Mahogany Tree	Y	1	16.0	25'	30'	706.5 Sq. Ft.	REMOVE	16.0				
104 (T)	Sweetenia mahagoni	Mahogany Tree	Y	1	15.3	27'	35'	962 Sq. Ft.	REMOVE	15.3				
106 (T)	Sweetenia mahagoni	Mahogany Tree	Y	1	15.5	25'	25'	490 Sq. Ft.	REMOVE	15.5				
107 (T)	Sweetenia mahagoni	Mahogany Tree	Y	1	15.1	25'	30'	706.5 Sq. Ft.	REMOVE	15.1				
108 (T)	Sweetenia mahagoni	Mahogany Tree	Y	1	15.3	25'	32'	490 Sq. Ft.	REMOVE	15.3				
117 (T)	Sweetenia mahagoni	Mahogany Tree	Y	1	23.8	38'	36'	1,107 Sq. Ft.	REMOVE	23.8				
118 (T)	Sweetenia mahagoni	Mahogany Tree	Y	1	19.9	28'	36'	1,107 Sq. Ft.	REMOVE	19.9				
119 (T)	Sweetenia mahagoni	Mahogany Tree	Y	1	16.7	24'	25'	490 Sq. Ft.	REMOVE	16.7				
123 (T)	Sweetenia mahagoni	Mahogany Tree	Y	1	12.8	25'	25'	490 Sq. Ft.	REMOVE	12.8				
TOTAL SUM OF SPECIMEN TREE DBH TO BE REMOVED: 1334.3														

Michael D Conner
Digitally signed by Michael D Conner
Date: 2025.02.16 16:48:36 -05'00'

MIAMI ARCHITECTS, INC. REGISTERED PROFESSIONAL ARCHITECT LICENSE #12543
THIS ITEM HAS BEEN DIGITALLY SIGNED AND SEALED BY MICHAEL CONNER, R.L.A. ON THE DATE INDICATED HERE.
SIGNATURE OF THIS DOCUMENT ARE NOT CONSIDERED SIGNED AND SEALED AND THE SIGNATURE MUST BE VERIFIED ON ANY ELECTRONIC COPY.

TREE FUND CALCULATIONS (3/3)

MIAMI BEACH - 72ND STREET COMMUNITY COMPLEX
299 72ND STREET
MIAMI BEACH, FLORIDA. 33141

WJ ARCHITECTS
(727) 822-5566
www.wjarc.com
AR94244





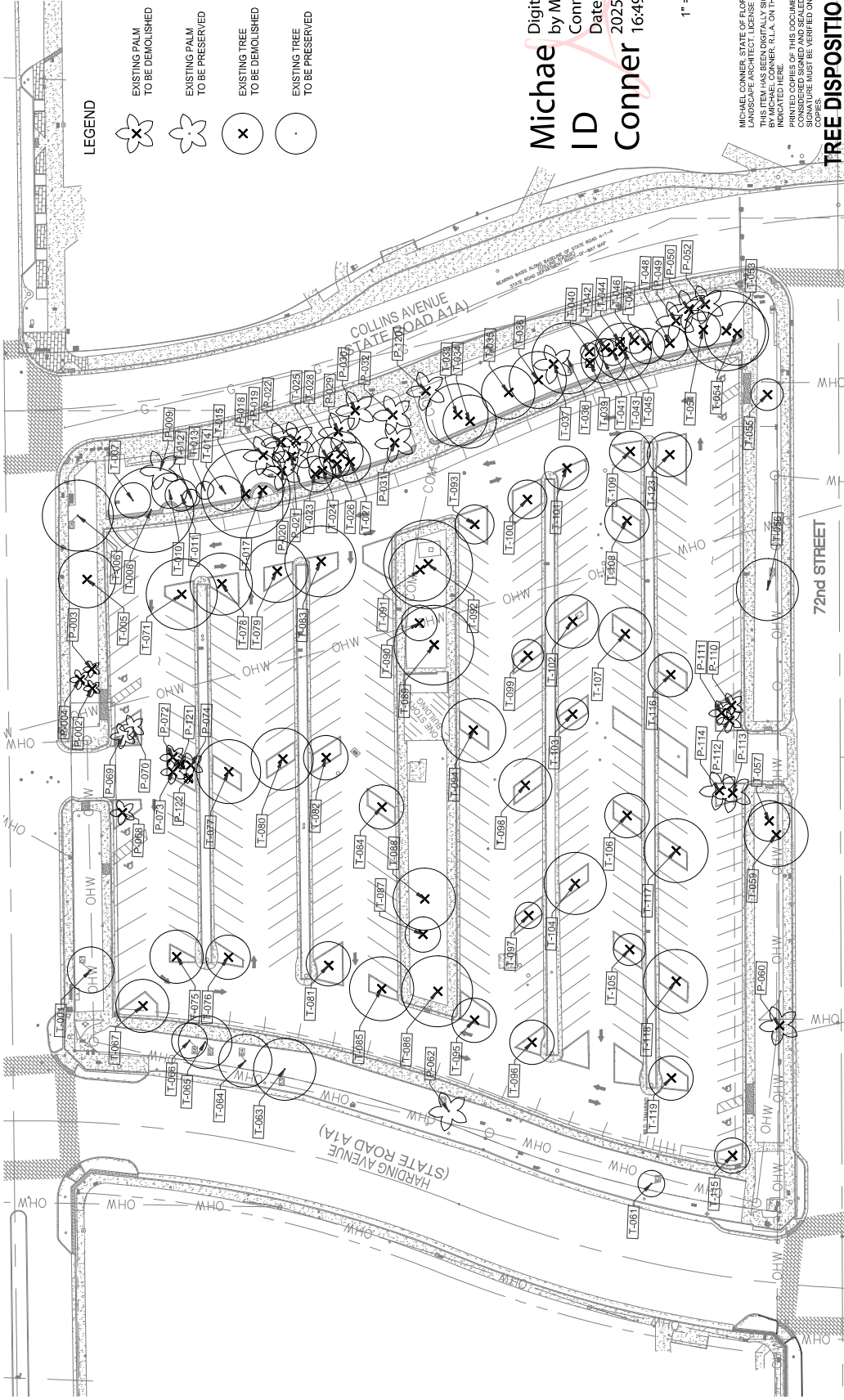

LA10
DRB24 - 1072
FINAL SUBMITTAL
FEBRUARY 14, 2025

WJ Architects, Inc.



LEGEND

-  EXISTING PALM TO BE DEMOLISHED
-  EXISTING PALM TO BE PRESERVED
-  EXISTING TREE TO BE DEMOLISHED
-  EXISTING TREE TO BE PRESERVED

Digitally signed
by Michael D
Conner
Date: 2025.02.16
16:49:25 -05'00'



1" = 50'

MICHAEL CONNER, STATE OF FLORIDA REGISTERED LANDSCAPE ARCHITECT, LICENSE NO. 1181. THIS ITEM HAS BEEN DIGITALLY SIGNED AND SEALED BY MICHAEL CONNER, A.L.A., ON THE DATE INDICATED HERE. PRINTED COPIES OF THIS DOCUMENT ARE NOT CONSIDERED SIGNED AND SEALED AND THE SIGNATURE SHOULD BE VERIFIED ON ANY ELECTRONIC COPIES.

TREE DISPOSITION PLAN

MIAMI BEACH - 72ND STREET COMMUNITY COMPLEX
299 72ND STREET
MIAMI BEACH, FLORIDA. 33141

WJ ARCHITECTS
(727) 822-5566
www.wjarc.com
AR94244



©WhitmanTadpole Architects, Inc.

DRB24 - 1072
FINAL SUBMITTAL
FEBRUARY 14, 2025

LA12

TREE NO.	BOTANICAL NAME	COMMON NAME	NATIVE	TREE SIZE					ACTION	CONDITION	DBH OF INDIVIDUAL TRUNKS				
				TRUNK#	DBH (IN)	HT (FT)	SPRD (FT)	AREA (SF)			#1	#2	#3	#4	#5
001	Delonix regia	Royal Poinciana Tree	N	1	15"	20'	26'	530 Sq. Ft.	PROTECT	Fair	15"				
002	Veitchia arecina	Montgomery Palm		1	7.9"	25'	10'	78.5 Sq. Ft.	REMOVE	Poor	7.9"				
003	Veitchia arecina	Montgomery Palm		1	6.8"	20'	10'	78.5 Sq. Ft.	REMOVE	Fair	6.8"				
004	Veitchia arecina	Montgomery Palm		1	9.8"	20'	12'	113 Sq. Ft.	REMOVE	Fair	9.8"				
005	Coccoloba urifera	Seagrape Tree	Y	1	31.2"	25'	32'	803 Sq. Ft.	REMOVE	Fair	31.2"				
006	Coccoloba urifera	Seagrape Tree	Y	3	69"	35'	40'	1,256 Sq. Ft.	PROTECT	Fair	22.1"	16.6"	21.3"		
007	Coccoloba urifera	Seagrape Tree	Y	2	8.9"	12'	20'	314 Sq. Ft.	PROTECT	Fair	5"	3.9"			
008	Coccoloba urifera	Seagrape Tree	Y	1	55.1"	35'	48'	1,810 Sq. Ft.	PROTECT	Poor	17"	21.4"	16.7"		
009	Bismarckia nobilis	Bismarck Palm	Y	1	13.5"	35'	15'	176 Sq. Ft.	PROTECT	Good	13.5"				
010	Coccoloba urifera	Seagrape Tree	Y	2	10.9"	15'	20'	314 Sq. Ft.	PROTECT	Fair	4.4"	6.5"			
011	Coccoloba urifera	Seagrape Tree	Y	1	9.3"	18'	18'	254 Sq. Ft.	PROTECT	Fair	9.3"				
012	Coccoloba urifera	Seagrape Tree	Y	1	5.7"	15'	10'	76.5 Sq. Ft.	PROTECT	Very Poor	5.7"				
013	Coccoloba urifera	Seagrape Tree	Y	1	9.1"	12'	10'	113 Sq. Ft.	PROTECT	Very Poor	9.1"				
014	Coccoloba urifera	Seagrape Tree	Y	1	6.9"	10'	20'	314 Sq. Ft.	PROTECT	Very Poor	6.9"				
015	Coccoloba urifera	Seagrape Tree	Y	1	41.3"	25'	50'	1,983 Sq. Ft.	REMOVE	Poor	41.3"				
017	Coccoloba urifera	Seagrape Tree	Y	3	32.7"	18'	24'	452 Sq. Ft.	REMOVE	Poor	10.5"	11"	11.2"		
018	Bismarckia nobilis	Bismarck Palm	Y	1	13.7"	35'	20'	314 Sq. Ft.	REMOVE	Fair	13.7"				
019	Bismarckia nobilis	Bismarck Palm	Y	1	11.6"	24'	20'	314 Sq. Ft.	REMOVE	Fair	11.6"				
020	Sabal palmetto	Cabbage Palm	Y	1	11"	15'	10'	78.5 Sq. Ft.	REMOVE	Fair	11"				
021	Bismarckia nobilis	Bismarck Palm	Y	1	9.9"	8'	8'	50 Sq. Ft.	REMOVE	Very Poor	9.9"				
022	Bismarckia nobilis	Bismarck Palm	Y	1	11.4"	28'	20'	314 Sq. Ft.	REMOVE	Fair	11.4"				
023	Coccoloba urifera	Seagrape Tree	Y	2	15.8"	25'	20'	314 Sq. Ft.	REMOVE	Fair	9.2"	6.6"			
024	Coccoloba urifera	Seagrape Tree	Y	1	6.3"	25'	15'	176 Sq. Ft.	REMOVE	Poor	6.3"				
025	Coccoloba urifera	Seagrape Tree	Y	3	17.4"	18'	23'	415 Sq. Ft.	REMOVE	Poor	7.3"	4.1"	6"		
026	Coccoloba urifera	Seagrape Tree	Y	2	10.5"	17'	15'	76.5 Sq. Ft.	REMOVE	Poor	4.4"	6.1"			
027	Coccoloba urifera	Seagrape Tree	Y	1	8.7"	15'	23'	415 Sq. Ft.	REMOVE	Fair	8.7"				
028	Coccoloba urifera	Seagrape Tree	Y	1	15.3"	25'	25'	490 Sq. Ft.	REMOVE	Fair	15.3"				
029	Cocos nucifera	Coconut Palm	Y	1	9.1"	28'	20'	314 Sq. Ft.	REMOVE	Fair	9.1"				
030	Cocos nucifera	Coconut Palm	Y	1	10.3"	28'	20'	314 Sq. Ft.	REMOVE	Fair	10.3"				
031	Cocos nucifera	Coconut Palm	Y	1	10"	24'	15'	176 Sq. Ft.	REMOVE	Fair	10"				
032	Cocos nucifera	Coconut Palm	Y	1	8.9"	20'	18'	254 Sq. Ft.	REMOVE	Fair	8.9"				
033	Coccoloba urifera	Seagrape Tree	Y	2	24.9"	30'	35'	962 Sq. Ft.	REMOVE	Fair	18.5"	6.4"			
034	Coccoloba urifera	Seagrape Tree	Y	3	4.9"	28'	30'	106.5 Sq. Ft.	REMOVE	Fair	15"	15"	12"		
035	Coccoloba urifera	Seagrape Tree	Y	2	29.3"	30'	30'	106.5 Sq. Ft.	REMOVE	Fair	22.9"	6.4"			
036	Coccoloba urifera	Seagrape Tree	Y	1	20.1"	32'	32'	804 Sq. Ft.	REMOVE	Fair	20.1"				
037	Cocos nucifera	Coconut Palm	Y	1	10.1"	30'	15'	176 Sq. Ft.	REMOVE	Fair	10.1"				
038	Coccoloba urifera	Seagrape Tree	Y	1	14.3"	15'	40'	1,256 Sq. Ft.	REMOVE	Fair	14.3"				
039	Coccoloba urifera	Seagrape Tree	Y	1	6.2"	8'	5'	70 Sq. Ft.	REMOVE	Very Poor	6.2"				
040	Coccoloba urifera	Seagrape Tree	Y	1	7.5"	15'	10'	76.5 Sq. Ft.	REMOVE	Poor	7.5"				
041	Coccoloba urifera	Seagrape Tree	Y	2	13.5"	8'	25'	465 Sq. Ft.	REMOVE	Poor	9"	4.5"			
042	Coccoloba urifera	Seagrape Tree	Y	2	8.7"	15'	10'	76.5 Sq. Ft.	REMOVE	Poor	2.3"	6.4"			
043	Coccoloba urifera	Seagrape Tree	Y	1	5.2"	12'	15'	176 Sq. Ft.	REMOVE	Very Poor	5.2"				
044	Coccoloba urifera	Seagrape Tree	Y	1	5.3"	9'	5'	20 Sq. Ft.	REMOVE	Very Poor	5.3"				
045	Coccoloba urifera	Seagrape Tree	Y	4	35.4"	27'	32'	804 Sq. Ft.	REMOVE	Fair	10.8"	7.7"	9.9"	7"	
046	Coccoloba urifera	Seagrape Tree	Y	1	6.4"	17'	15'	176 Sq. Ft.	REMOVE	Fair	6.4"				
047	Coccoloba urifera	Seagrape Tree	Y	1	12.5"	22'	20'	314 Sq. Ft.	REMOVE	Poor	12.5"				
048	Coccoloba urifera	Seagrape Tree	Y	1	10"	20'	20'	314 Sq. Ft.	REMOVE	Fair	10"				
049	Bismarckia nobilis	Bismarck Palm	Y	1	13.3"	24'	15'	176 Sq. Ft.	REMOVE	Fair	13.3"				
050	Bismarckia nobilis	Bismarck Palm	Y	1	16.2"	27'	15'	176 Sq. Ft.	REMOVE	Fair	16.2"				

Michael D Conner
Digitally signed by Michael D Conner
Date: 2025.02.16 16:49:55 -05'00'

UNLESS OTHERWISE SPECIFIED, THIS DOCUMENT IS REGISTERED BY MICHAEL CONNER, R.L.A. ON THE DATE PRINTED COPIES OF THIS DOCUMENT ARE NOT CONSIDERED SIGNED AND SEALED AND THE SIGNATURE MUST BE VERIFIED ON ANY ELECTRONIC COPIES.

TREE DISPOSITION SCHEDULE (1/13)



WJ ARCHITECTS
(727) 822-5666
www.wjarc.com
AR94244

MIAMI BEACH - 72ND STREET COMMUNITY COMPLEX
299 72ND STREET
MIAMI BEACH, FLORIDA. 33141

DRB24 - 1072
FINAL SUBMITTAL
FEBRUARY 14, 2025
LA13

TREE NO.	BOTANICAL NAME	COMMON NAME	NATIVE	TREE DISPOSITION SCHEDULE					DBH OF INDIVIDUAL TRUNKS					
				TRUNK#	DBH (IN)	HT (FT)	SPRD (FT)	AREA (SF)	ACTION	CONDITION	#1	#2	#3	#4
051	Coccoloba uvifera	Seagrape Cluster	Y	4	15.3"	15'	20'	314.5 Sq. Ft.	REMOVE	Poor	3"	3.4"	3.4"	5.5"
052	Bismarckia nobilis	Bismarck Palm	Y	1	15.3"	25'	15'	176.5 Sq. Ft.	REMOVE	Fair	15.3"			
053	Coccoloba uvifera	Seagrape Tree	Y	2	31.4"	25'	45'	1,590.5 Sq. Ft.	REMOVE	Fair	17"	14.4"		
054	Coccoloba uvifera	Seagrape Tree	Y	1	14.5"	25'	36'	1,015.5 Sq. Ft.	REMOVE	Fair	14.5"			
055	Coccoloba uvifera	Seagrape Tree	Y	3	14.2"	13'	18'	355.5 Sq. Ft.	REMOVE	Fair	5.2"	2.8"	6.1"	
056	Swietenia mahagoni	Mahogany Tree	Y	1	18"	27'	35'	962.5 Sq. Ft.	PROTECT	Fair	18"			
057	Coccoloba uvifera	Seagrape Tree	Y	4	4.3"	25'	23'	415.5 Sq. Ft.	REMOVE	Poor	9"	10.6"	9.7"	13.4"
058														
059	Coccoloba uvifera	Seagrape Tree	Y	1	26.9"	15'	36'	1,019.5 Sq. Ft.	REMOVE	Poor	26.9"			
060	Sabal palmetto	Cabbage Palm	Y	1	12.8"	15'	15'	176.5 Sq. Ft.	REMOVE	Poor	12.8"			
061	Lythium latifolium	Wild Tamarind	Y	2	8"	13'	15'	176.5 Sq. Ft.	PROTECT	Good	4"	3.9"		
062	Sabal palmetto	Cabbage Palm	Y	1	10.2"	12'	10'	78.5 Sq. Ft.	PROTECT	Fair	10.2"			
063	Delonix regia	Royal Poinciana Tree	Y	1	13.3"	15'	35'	962.5 Sq. Ft.	PROTECT	Fair	13.3"			
064	Delonix regia	Royal Poinciana Tree	Y	1	13.4"	18'	30'	706.5 Sq. Ft.	PROTECT	Poor	13.4"			
065	Coccoloba uvifera	Seagrape Tree	Y	2	25.4"	25'	30'	706.5 Sq. Ft.	PROTECT	Fair	12.2"	13.2"		
066	Coccoloba uvifera	Seagrape Tree	Y	1	23.2"	30'	20'	314.5 Sq. Ft.	PROTECT	Fair	23.2"			
067	Delonix regia	Royal Poinciana Tree	Y	1	12.1"	15'	30'	706.5 Sq. Ft.	REMOVE	Fair	12.1"			
068	Veitchia arcuata	Montgomery Palm	Y	1	7.6"	25'	8'	50.5 Sq. Ft.	REMOVE	Fair	7.6"			
069	Veitchia arcuata	Montgomery Palm	Y	1	7.3"	22'	15'	176.5 Sq. Ft.	PROTECT	Fair	7.3"			
070	Veitchia arcuata	Montgomery Palm	Y	1	20.6"	35'	40'	1,256.5 Sq. Ft.	REMOVE	Fair	20.6"			
071	Swietenia mahagoni	Mahogany Tree	Y	1	7.3"	17'	12'	113.5 Sq. Ft.	REMOVE	Fair	7.3"			
072	Veitchia arcuata	Montgomery Palm	Y	1	6.5"	17'	12'	113.5 Sq. Ft.	REMOVE	Fair	6.5"			
073	Veitchia arcuata	Montgomery Palm	Y	1	6.1"	17'	12'	113.5 Sq. Ft.	REMOVE	Fair	6.1"			
074	Veitchia arcuata	Montgomery Palm	Y	1	14.7"	24'	30'	706.5 Sq. Ft.	REMOVE	Poor	14.7"			
075	Swietenia mahagoni	Mahogany Tree	Y	1	14.2"	22'	25'	490.5 Sq. Ft.	REMOVE	Poor	14.2"			
076	Swietenia mahagoni	Mahogany Tree	Y	1	20.3"	25'	36'	1,017.5 Sq. Ft.	REMOVE	Fair	20.3"			
077	Swietenia mahagoni	Mahogany Tree	Y	1	17.3"	35'	35'	962.5 Sq. Ft.	REMOVE	Fair	17.3"			
078	Swietenia mahagoni	Mahogany Tree	Y	1	18.6"	35'	35'	962.5 Sq. Ft.	REMOVE	Fair	18.6"			
079	Swietenia mahagoni	Mahogany Tree	Y	1	17.5"	35'	35'	962.5 Sq. Ft.	REMOVE	Poor	17.5"			
080	Swietenia mahagoni	Mahogany Tree	Y	1	12"	19'	25'	490.5 Sq. Ft.	REMOVE	Fair	12"			
081	Swietenia mahagoni	Mahogany Tree	Y	1	17"	25'	25'	490.5 Sq. Ft.	REMOVE	Poor	17"			
082	Swietenia mahagoni	Mahogany Tree	Y	1	22.6"	35'	40'	1,256.5 Sq. Ft.	REMOVE	Fair	22.6"			
083	Swietenia mahagoni	Mahogany Tree	Y	1	14.2"	25'	25'	490.5 Sq. Ft.	REMOVE	Poor	14.2"			
084	Swietenia mahagoni	Mahogany Tree	Y	1	17.5"	28'	36'	1,017.5 Sq. Ft.	REMOVE	Fair	17.5"			
085	Swietenia mahagoni	Mahogany Tree	Y	1	18.1"	20'	40'	1,256.5 Sq. Ft.	REMOVE	Fair	18.1"			
086	Conocarpus erectus	Seagrape Cluster	Y	1	27"	12'-16'	20'	314.5 Sq. Ft.	REMOVE	Fair	27"			
087	Coccoloba uvifera	Seagrape Cluster	Y	2	44.6"	25'	35'	962.5 Sq. Ft.	REMOVE	Fair	28"	16.5"		
088	Conocarpus erectus	Seagrape Cluster	Y	2	50.4"	25'	45'	1,590.5 Sq. Ft.	REMOVE	Fair	20"	16.3"	13.7"	
089	Conocarpus erectus	Seagrape Cluster	Y	3	60.3"	38'	50'	1,962.5 Sq. Ft.	REMOVE	Fair	10"	14.3"	14.3"	
090	Conocarpus erectus	Seagrape Cluster	Y	2	24.4"	10'	20'	314.5 Sq. Ft.	REMOVE	Poor	10"	14.3"		
091	Coccoloba uvifera	Seagrape Tree	Y	3	41.6"	30'	35'	962.5 Sq. Ft.	REMOVE	Fair	13"	14.5"	17.7"	28"
092	Coccoloba uvifera	Seagrape Tree	Y	3	60.3"	38'	50'	1,962.5 Sq. Ft.	REMOVE	Fair	15"	17.7"	17.7"	
093	Swietenia mahagoni	Mahogany Tree	Y	1	12.4"	30'	22'	380.5 Sq. Ft.	REMOVE	Fair	12.4"			
094	Swietenia mahagoni	Mahogany Tree	Y	1	20.5"	27'	36'	1,017.5 Sq. Ft.	REMOVE	Poor	20.5"			
095	Swietenia mahagoni	Mahogany Tree	Y	1	14.7"	27'	25'	490.5 Sq. Ft.	REMOVE	Fair	14.7"			
096	Swietenia mahagoni	Mahogany Tree	Y	1	14.8"	25'	25'	490.5 Sq. Ft.	REMOVE	Fair	14.8"			
097	Swietenia mahagoni	Mahogany Tree	Y	1	8"	20'	15'	176.5 Sq. Ft.	REMOVE	Poor	8"			
098	Swietenia mahagoni	Mahogany Tree	Y	1	18.4"	27'	30'	706.5 Sq. Ft.	REMOVE	Fair	18.4"			
099	Swietenia mahagoni	Mahogany Tree	Y	1	9.8"	15'	18'	355.5 Sq. Ft.	REMOVE	Fair	9.8"			
100	Swietenia mahagoni	Mahogany Tree	Y	1	10.4"	22'	22'	380.5 Sq. Ft.	REMOVE	Fair	10.4"			

Michael D Conner
 Digitally signed by Michael D Conner
 Date: 2025.02.16 16:50:21 -05'00'

MICHAEL CONNER, STATE OF FLORIDA, REGISTERED LANDSCAPE ARCHITECT, LICENSE NO. 1181.
 THIS ITEM HAS BEEN DIGITALLY SIGNED AND SEALED IN THE PRESENCE OF A NOTARY PUBLIC IN THE STATE OF FLORIDA, MIAMI BEACH, FLA., ON THE DATE INDICATED HERE.
 PRINTED COPIES OF THIS DOCUMENT ARE NOT CONSIDERED SIGNED AND SEALED AND THE SIGNATURE SHOULD BE VERIFIED ON ANY ELECTRONIC COPIES.

TREE DISPOSITION SCHEDULE (2/3)



MIAMI BEACH - 72ND STREET COMMUNITY COMPLEX
 299 72ND STREET
 MIAMI BEACH, FLORIDA. 33141

DRB24 - 1072
 FINAL SUBMITTAL
 FEBRUARY 14, 2025

LA14

TREE DISPOSITION SCHEDULE

TREE NO.	BOTANICAL NAME	COMMON NAME	NATIVE	SIZE						ACTION	CONDITION	DBH OF INDIVIDUAL TRUNKS			
				TRUNK#	DBH (IN)	HT (FT)	SPRD (FT)	AREA (SF)	#1			#2	#3	#4	#5
101 (T)	Swietenia mahagoni	Mahogany Tree	Y	1	15.3"	25'	25'	30'	490 Sq. Ft.	REMOVE	Poor	15.3"			
102 (T)	Swietenia mahagoni	Mahogany Tree	Y	1	16"	25'	30'	706.5 Sq. Ft.		REMOVE	Poor	16"			
103 (T)	Swietenia mahagoni	Mahogany Tree	Y	1	10.3"	15'	18'	255 Sq. Ft.		REMOVE	Very Poor	10.3"			
104 (T)	Swietenia mahagoni	Mahogany Tree	Y	1	15.3"	27'	35'	962 Sq. Ft.		REMOVE	Fair	15.3"			
105 (T)	Swietenia mahagoni	Mahogany Tree	Y	1	11.9"	15'	18'	255 Sq. Ft.		REMOVE	Poor	11.9"			
106 (T)	Swietenia mahagoni	Mahogany Tree	Y	1	15.5"	25'	25'	490 Sq. Ft.		REMOVE	Fair	15.5"			
107 (T)	Swietenia mahagoni	Mahogany Tree	Y	1	15.1"	27'	30'	706.5 Sq. Ft.		REMOVE	Poor	15.1"			
108 (T)	Swietenia mahagoni	Mahogany Tree	Y	1	13.3"	25'	25'	490 Sq. Ft.		REMOVE	Fair	13.3"			
109 (T)	Swietenia mahagoni	Mahogany Tree	Y	1	10.9"	20'	23'	416 Sq. Ft.		REMOVE	Fair	10.9"			
110 (P)	Cocon nucifera	Coconut Palm		1	8.7"	24'	15'	176.5 Sq. Ft.		REMOVE	Fair	8.7"			
111 (P)	Cocon nucifera	Coconut Palm		1	9.6"	15'	3'	7 Sq. Ft.		REMOVE	Very Poor	9.6"			
112 (P)	Cocon nucifera	Coconut Palm		1	8.7"	28'	15'	176.5 Sq. Ft.		REMOVE	Fair	8.7"			
113 (P)	Cocon nucifera	Coconut Palm		1	8.2"	24'	15'	176.5 Sq. Ft.		REMOVE	Fair	8.2"			
114 (P)	Cocon nucifera	Coconut Palm		1	7.9"	30'	15'	176.5 Sq. Ft.		REMOVE	Fair	7.9"			
115 (T)	Delonix regia	Royal Poinciana Tree		1	9.2"	12'	20'	314 Sq. Ft.		REMOVE	Very Poor	9.2"			
116 (T)	Swietenia mahagoni	Mahogany Tree	Y	1	16.5"	30'	25'	490 Sq. Ft.		REMOVE	Fair	16.5"			
117 (T)	Swietenia mahagoni	Mahogany Tree	Y	1	23.8"	28'	36'	1,107 Sq. Ft.		REMOVE	Fair	23.8"			
118 (T)	Swietenia mahagoni	Mahogany Tree	Y	1	19.9"	28'	36'	1,107 Sq. Ft.		REMOVE	Fair	19.9"			
119 (T)	Swietenia mahagoni	Mahogany Tree	Y	1	16.7"	24'	25'	490 Sq. Ft.		REMOVE	Poor	16.7"			
120 (P)	Cocon nucifera	Coconut Palm		1	9.7"	30'	8'	50 Sq. Ft.		REMOVE	Fair	9.7"			
121 (P)	Veitchia arecina	Montgomery Palm		1	6"	14'	12'	113 Sq. Ft.		REMOVE	Poor	6"			
122 (P)	Veitchia arecina	Montgomery Palm		1	6"	14'	12'	113 Sq. Ft.		REMOVE	Poor	6"			
123 (T)	Swietenia mahagoni	Mahogany Tree	Y	1	12.8"	25'	25'	490 Sq. Ft.		REMOVE	Fair	12.8"			

Michael D
Digitally signed
by Michael D
Conner
Date: 2025.02.16
16:50:47 -05'00'

MICHAEL CONNER, STATE OF FLORIDA REGISTERED PROFESSIONAL ARCHITECT LICENSE NO. 18110
THIS DRAWING AND ALL INFORMATION CONTAINED HEREIN IS UNLESS OTHERWISE SPECIFICALLY INDICATED BY MICHAEL CONNER, P.L.L.C. ON THE DATE INDICATED HERE.
PRINTED COPIES OF THIS DOCUMENT ARE NOT VALID. THIS DOCUMENT IS VALID ONLY AS AN ELECTRONIC SIGNATURE MUST BE VERIFIED ON ANY ELECTRONIC COPIES.

TREE DISPOSITION SCHEDULE (3/3)



WJ ARCHITECTS
(727) 822-5566
www.wjarc.com
AR94244

MIAMI BEACH - 72ND STREET COMMUNITY COMPLEX
299 72ND STREET
MIAMI BEACH, FLORIDA. 33141

DRB24 - 1072
FINAL SUBMITTAL
FEBRUARY 14, 2025

LA15

**CITY OF MIAMI BEACH
LANDSCAPE LEGEND**

INFORMATION REQUIRED TO BE PERMANENTLY AFFIXED TO PLANS
Zoning District GU Lot Area 166,835 sf

Acres 3.83 ac **NOTES**

OPEN SPACE

- A. Square feet of required Open Space as indicated on site plan:
Lot Area = 166,835 s.f. x 0 % = 0 s.f.
- B. Square feet of parking lot open space required as indicated on site plan:
Number of parking spaces 0 x 10 s.f. parking space =
- C. Total square feet of landscaped open space required: A+B=

REQUIRED/ ALLOWED	PROVIDED
<u>0</u>	<u>49,257 sf</u>
<u>0</u>	<u>-</u>
<u>0</u>	<u>49,257 sf</u>

--- No parking lot proposed

LAWN AREA CALCULATION

- A. Square feet of landscaped open space required
- B. Maximum lawn area (sod) permitted= 20 % x 0 s.f.
- All lawn areas shown on plans are designated for sports use

<u>0</u>	<u>49,257 sf</u>
<u>0</u>	<u>0</u>

TREES

- A. Number of trees required per lot or net lot acre, less existing number of trees meeting minimum requirements=
22 trees x 3.83 net lot acres - number of existing trees =
- B. % Natives required: Number of trees provided x 30% =
78 (*1) 2
- C. % Low maintenance / drought and salt tolerant required:
Number of trees provided x 50%=
39 2
- D. Street Trees (maximum average spacing of 20' o.c.)
1 linear feet along street divided by 20' =
76 (*2) 2
- E. Street tree species allowed directly beneath power lines:
(maximum average spacing of 20' o.c.):
1.048 linear feet along street divided by 20' =
53 (*3) 0

<u>78 (*1)</u>	<u>2</u>
<u>24</u>	<u>2</u>

--- (*1): 85 Req'd minus 7 Credit for existing trees

--- (*2): 84 Req'd minus 8 Credit for existing trees

--- (*3): Because these are 'Transmission Lines,' FPL has limited all vegetation to 12' Max ht at maturity, no trees allowed

SHRUBS

- A. Number of shrubs required: Sum of lot and street trees required x 12=
2028 6887
- B. % Native shrubs required: Number of shrubs provided x 50%=
1014 3617

<u>2028</u>	<u>6887</u>
<u>1014</u>	<u>3617</u>

LARGE SHRUBS OR SMALL TREES

- A. Number of large shrubs or small trees required: Number of required shrubs x 10%=
203 203
- B. % Native large shrubs or small trees required: Number of large shrubs or small trees provided x 50%=
102 109

<u>203</u>	<u>203</u>
<u>102</u>	<u>109</u>

WJ ARCHITECTS
(727) 822-5566
www.wjarc.com
AR94244



©WinnMadier Jensen Architects, Inc.

MIAMI BEACH - 72ND STREET COMMUNITY COMPLEX
299 72ND STREET
MIAMI BEACH, FLORIDA. 33141

LANDSCAPE LEGEND FORM

DRB24 - 1072
FINAL SUBMITTAL
FEBRUARY 14, 2025

LA17

Michael Digitally signed
by Michael D
ID Conner

Date: 2025.02.16
Conner 16:51:34-05'00'

MICHAEL CONNER, STATE OF FLORIDA REGISTERED
LANDSCAPE ARCHITECT, LICENSE NO. 1181
THIS ITEM HAS BEEN DIGITALLY SIGNED AND SEALED
BY MICHAEL CONNER, R.L.A. ON THE DATE
INDICATED HERE.
FOR VALIDATION OF THIS DOCUMENT, USE A PDF
VIEWER THAT CAN VERIFY DIGITALLY SIGNED AND SEALED AND THE
SIGNATURE MUST BE VERIFIED ON ANY ELECTRONIC
COPIES.

UNDERSTORY SCHEDULE						
SYMBOL	CODE	QTY	BOTANICAL / COMMON NAME	SIZE	SPACING	REMARKS
SHRUB AREAS						
CR		13	Chamaecrista cataractarum	3 G, Full to Base, 2' OA Ht, 18" Sprd	48" o.c.	
CV		37	Calliandra verticillata	3 G, Full to Base, 2' OA Ht, 18" Sprd	24" o.c.	
CS		155	Conocarpus erectus f. sericeus	3 G, Full to Base, 18" OA Ht, 18" Sprd	18" o.c.	FL Native
DV		587	Dianella tasmanica 'Variegata'	1 G, Full to Base, 12" OA Ht, 12" Sprd	12" o.c.	
GP		415	Gaillardia pumila	1 G, Full to Base, 12" OA Ht, 12" Sprd	18" o.c.	
HD		495	Helianthus debilis	1 G, Full to Base, 12" OA Ht, 12" Sprd	18" o.c.	FL Native
LM		278	Limonium carolinianum	1 G, Full to Base, 12" OA Ht, 12" Sprd	12" o.c.	
MD		286	Monarda deliciosa	3 G, Full to Base, 2' OA Ht, 18" Sprd	24" o.c.	
MC		845	Muhlenbergia capillaris	3 G, Full to Base, 2' OA Ht, 18" Sprd	24" o.c.	FL Native
NM		189	Nephrolepis biserrata	3 G, Full to Base, 2' OA Ht, 18" Sprd	24" o.c.	FL Native
NE		403	Nephrolepis exaltata	1 G, Full to Base, 2' OA Ht, 2' Sprd	18" o.c.	FL Native
PO		399	Podocarpus neriifolius	3 G, Full to Base, 2' OA Ht, 18" Sprd	24" o.c.	FL Native
PB		212	Philodendron x Burle Marx'	3 G, Full to Base, 2' OA Ht, 18" Sprd	24" o.c.	
PR		77	Philodendron x Rojo Congo'	7 G, Full to Base, 3' OA Ht, 3' Sprd	30" o.c.	
PM		264	Podocarpus macrophyllus	3 G, Full to Base, 2' OA Ht, 18" Sprd	24" o.c.	
PP		56	Podocarpus macrophyllus 'Pinguicis'	3 G, Full to Base, 2' OA Ht, 18" Sprd	24" o.c.	
PN2		96	Psychotria nervosa	3 G, Full to Base, 2' OA Ht, 18" Sprd	24" o.c.	FL Native
PN		81	Psychotria nervosa 'Little Psycho'	3 G, Full to Base, 2' OA Ht, 18" Sprd	24" o.c.	FL Native
SL		453	Sophora tomentosa occidentalis	3 G, Full to Base, 18" OA Ht, 18" Sprd	18" o.c.	
SB		471	Spartina bakeri	3 G, Full to Base, 2' OA Ht, 18" Sprd	24" o.c.	FL Native
TP		665	Tradescantia pallida	1 G, Full to Base, 12" OA Ht, 12" Sprd	12" o.c.	
TF		603	Triplaris flammula	3 G, Full to Base, 2' OA Ht, 18" Sprd	24" o.c.	FL Native
SOD						
SSF		30,046 sf	Stenotaphrum secundatum	Sod		
			St. Augustine Grass			

TREE/PALM CANOPY SCHEDULE					
SYMBOL	CODE	QTY	BOTANICAL / COMMON NAME	SIZE	REMARKS
TREES / SMALL TREES					
	BS	1	Bursera simaruba Gumbo Limbo	FG, 14' Min OAH, 4" Min DBH, 8' Min Spread, Florida No. 1	FL Native
	LL	19	Ligustrum lucidum Glossy Privet	FG, 10' Min OAH, 3 Multi-trunk, 2.5" Min DBH, Florida No. 1	FL Native
	LV	5	Ligustrum lucidum 'Variegata' Variegated Privet	FG, 10' Min OAH, 3 Multi-trunk, 2.5" Min DBH, Florida No. 1	FL Native
	SP	9	Sabal palmetto Cabbage Palmetto	FG, 14'-16" OAH, Candle-cut	FL Native
	SM	3	Sweetenia mahagoni Manogany	FG, 14' Min OAH, 4" Min DBH, 8' Min Spread, 6' Min CT, Florida No. 1	FL Native

LARGE SHRUB / SMALL TREE SCHEDULE					
SYMBOL	CODE	QTY	BOTANICAL / COMMON NAME	SIZE	REMARKS
SHRUBS					
	IC	109	Ilex cassine Dartwood Holly	FG, 6' Min OAH, 4" Min Spread, 2' Clear Trunk, Single Trunk, Florida No. 1	
	JI	94	Jatropha integrifolia Spicy Jatropha	FG, 6' Min OAH, 4" Min Spread, 2' Clear Trunk, Single Trunk, Florida No. 1	

Michael D
Conner
Digitally signed
by Michael D
Conner
Date: 2025.02.16
16:52:01 -05'00'

MICHAEL CONNER, STATE OF FLORIDA REGISTERED PROFESSIONAL ARCHITECT
THIS ITEM HAS BEEN DIGITALLY SIGNED AND SEALED BY MICHAEL CONNER, R.L.L.A. ON THE DATE INDICATED HEREIN.
SIGNATURES OF THIS DOCUMENT ARE NOT VALID UNLESS THE DOCUMENT IS SIGNED AND SEALED AND THE SIGNATURE MUST BE VERIFIED ON ANY ELECTRONIC DOCUMENT.

PLANTING SCHEDULE

MIAMI BEACH - 72ND STREET COMMUNITY COMPLEX
299 72ND STREET
MIAMI BEACH, FLORIDA, 33141

WJ ARCHITECTS
(772) 822-5566
www.wjarc.com
AR64244



DRB24 - 1072
FINAL SUBMITTAL
FEBRUARY 14, 2025

LA18

©Wannmacher Jensen Architects, Inc.

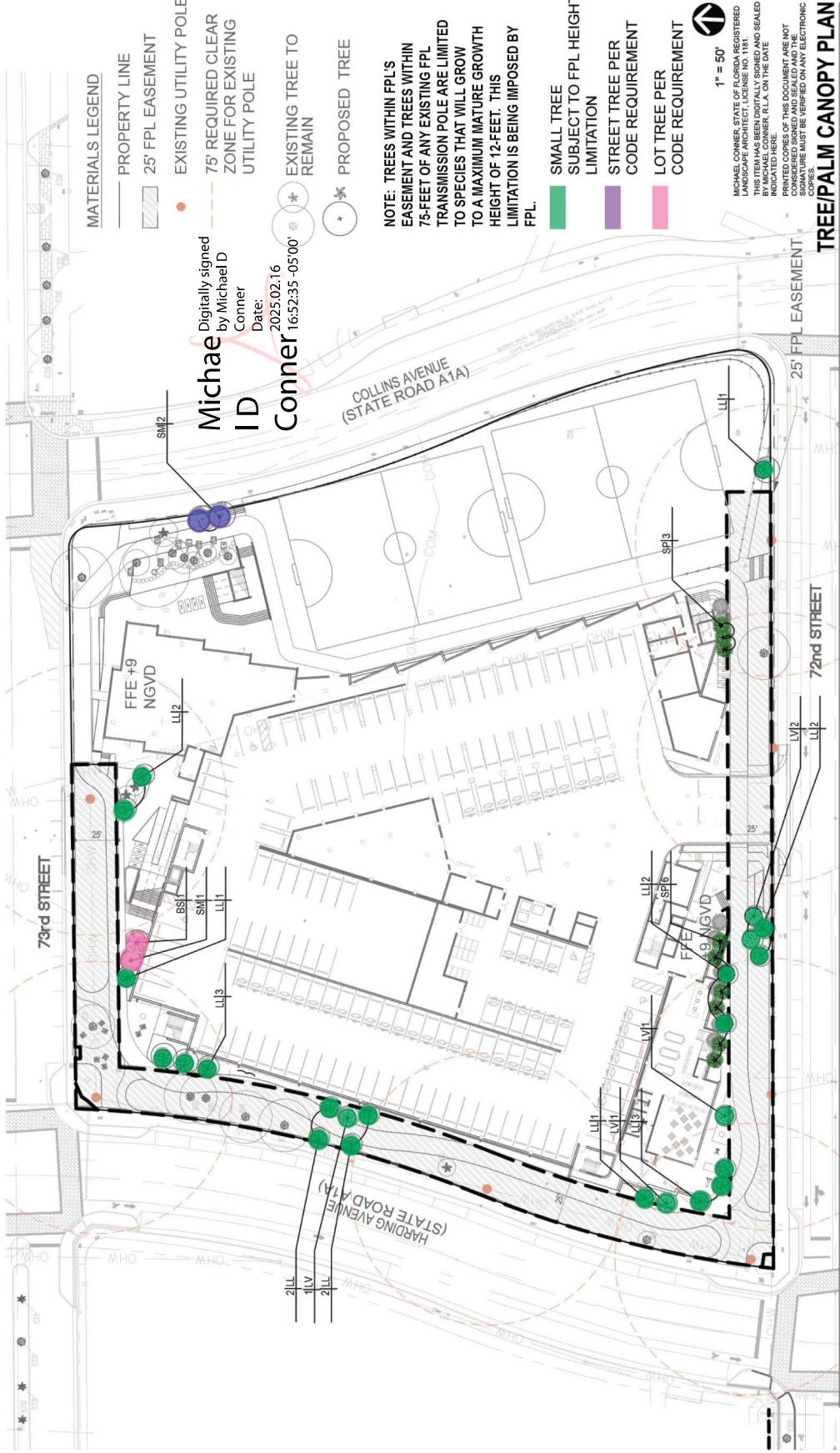

DRB24 - 1072
FINAL SUBMITTAL
FEBRUARY 14, 2025

MIAMI BEACH - 72ND STREET COMMUNITY COMPLEX
 299 72ND STREET
 MIAMI BEACH, FLORIDA. 33141

WJ ARCHITECTS
 (777) 822-5666
 www.wjarc.com
 AR84244

LA19

TREE/PALM CANOPY PLAN

WJ ARCHITECTS
 (777) 822-5666
 www.wjarc.com
 AR84244

MIAMI BEACH - 72ND STREET COMMUNITY COMPLEX
 299 72ND STREET
 MIAMI BEACH, FLORIDA. 33141

DRB24 - 1072
FINAL SUBMITTAL
FEBRUARY 14, 2025

LA19

TREE/PALM CANOPY PLAN

WJ ARCHITECTS
 (777) 822-5666
 www.wjarc.com
 AR84244



MATERIALS LEGEND

- PROPERTY LINE
- ▨ 25' FPL EASEMENT
- EXISTING UTILITY POLE
- 75' REQUIRED CLEAR ZONE FOR EXISTING UTILITY POLE
- ⊙ EXISTING TREE TO REMAIN
- ⊙* PROPOSED TREE
- CU. STRUCTURAL SOIL

CU. STRUCTURAL SOIL
24-INCH DEEP MIN. (TYP)

Michael D Digitally signed
by Michael D
Conner
Date: 2025.02.16
16:53:02 -05'00'



MICHAEL CONNER, STATE OF FLORIDA - REGISTERED PROFESSIONAL ENGINEER
THIS ITEM HAS BEEN DIGITALLY SIGNED AND SEALED BY MICHAEL CONNER, R.L.A. ON THE DATE INDICATED HEREIN.
ALL OTHERS OF THIS DOCUMENT ARE NOT CONSIDERED SIGNED AND SEALED AND THE SIGNATURE MUST BE VERIFIED ON ANY ELECTRONIC COPIES.

SOILS PLAN

WA
WJ ARCHITECTS
(777) 822-5666
www.wjarc.com
AR84244
©Wanneracher Jensen Architects, Inc.

MIAMI BEACH - 72ND STREET COMMUNITY COMPLEX
299 72ND STREET
MIAMI BEACH, FLORIDA. 33141

LA20

DRB24 - 1072
FINAL SUBMITTAL
FEBRUARY 14, 2025



MATERIALS LEGEND

- PROPERTY LINE
- ▨ 25' FPL EASEMENT
- EXISTING UTILITY POLE
- 75' REQUIRED CLEAR ZONE FOR EXISTING UTILITY POLE
- ⊙ EXISTING TREE TO REMAIN
- ⊙* PROPOSED TREE

NOTE: TREES IN FPL EASEMENT MUST BE 75' FROM EXISTING UTILITY POLE AND REACH A MATURE HEIGHT UNDER 14'

Michael D Conner Digitally signed by Michael D Conner
 Date: 2025.02.16 16:53:25 -05'00'

1" = 50'
 MICHAEL CONNER, STATE OF FLORIDA REGISTERED PROFESSIONAL ARCHITECT
 THIS ITEM HAS BEEN DIGITALLY SIGNED AND SEALED BY MICHAEL CONNER, R.L.A. ON THE DATE INDICATED HEREIN.
 IF THIS DOCUMENT IS NOT CONSIDERED SIGNED AND SEALED AND THE SIGNATURE MUST BE VERIFIED ON ANY ELECTRONIC DEVICE.

LARGE SHRUB PLAN

MIAMI BEACH - 72ND STREET COMMUNITY COMPLEX
 299 72ND STREET
 MIAMI BEACH, FLORIDA. 33141

WJ ARCHITECTS
 (727) 822-5566
 www.wjarc.com
 AR84244
 ©Wannerbacher Jensen Architects, Inc.

DRB24 - 1072
 FINAL SUBMITTAL
 FEBRUARY 14, 2025

LA21



Bursera simaruba
GUMBO LIMBO



Ligustrum lucidum Variegata
VARIEGATED PRIVET

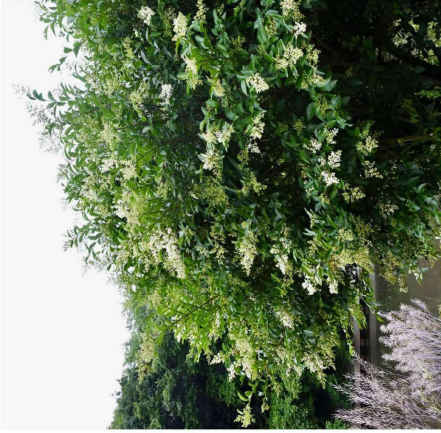

Ligustrum lucidum
GLOSSY PRIVET



Sabal palmetto
CABBAGE PALM



Swietenia mahagoni
MAHOGANY

Michael D
Digitally signed
by Michael D
Conner
Date: 2025.02.16
16:54:21 -05'00'

MICHAEL CONNER, STATE OF FLORIDA REGISTERED
PROFESSIONAL ARCHITECT, HAS REVIEWED AND
THIS ITEM HAS BEEN DIGITALLY SIGNED AND SEALED
BY MICHAEL CONNER R.L.A. ON THE DATE
INDICATED HERE.
SIGNATURES OF THIS DOCUMENT ARE NOT
CONSIDERED SIGNED AND SEALED AND THE
SIGNATURE MUST BE VERIFIED ON ANY ELECTRONIC
COPY.

TREE/PALM CANOPY PALETTE

WA
WJ ARCHITECTS
(727) 822-5666
www.wjarc.com
AR94244

©Warrenbacher Jensen Architects, Inc.

MIAMI BEACH - 72ND STREET COMMUNITY COMPLEX
299 72ND STREET
MIAMI BEACH, FLORIDA. 33141

DRB24 - 1072
FINAL SUBMITTAL
FEBRUARY 14, 2025

LA23



Ilex cassine
DAHOON HOLLY

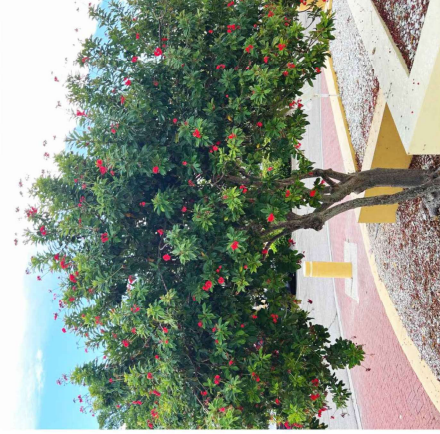

Jatropha integririma
SPICY JATROPHA

Digitally signed
by Michael D
Conner
Date: 2025.02.16
16:54:44 -05'00'

MICHAEL CONNER, STATE OF FLORIDA REGISTERED
PROFESSIONAL ARCHITECT, NO. 12573
THIS ITEM HAS BEEN DIGITALLY SIGNED AND SEALED
BY MICHAEL CONNER, R.L.A. ON THE DATE
INDICATED HERE
SIGNATURE AND DATE OF THIS DOCUMENT ARE NOT
CONSIDERED SIGNED AND SEALED AND THE
SIGNATURE MUST BE VERIFIED ON ANY ELECTRONIC
COPY.

LARGE SHRUB PALETTE



WJ ARCHITECTS
(727) 822-5666
www.wjarc.com
AR84244

©Warrenbacher Jensen Architects, Inc.

MIAMI BEACH - 72ND STREET COMMUNITY COMPLEX
299 72ND STREET
MIAMI BEACH, FLORIDA. 33141

DRB24 - 1072
FINAL SUBMITTAL
FEBRUARY 14, 2025

LA24



Alcantarea imperialis
IMPERIAL BROMELIAD



Gaillardia pulchella
ANNUAL GAILLARDIA / BLANKET FLOWER



Muhlenbergia capillaris
PINK MUHLY GRASS



Chamaedorea cataractarum
CAT PALM



Helianthus debilis
DUNE SUNFLOWER



Nephrolepis biserrata
MACHO FERN



Codiaeum variegatum
CROTON



Ilex vomitoria
YAUPON HOLLY



Nephrolepis exaltata
BOSTON FERN



Corocarpus erectus f. sericeus
SILVER BUTTONWOOD



Liriope muscari
LILYTURF

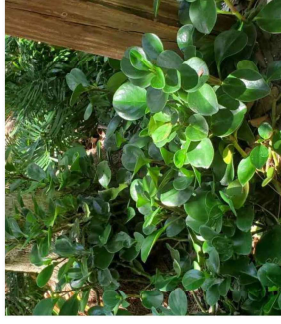

Peperomia obtusifolia
BABY RUBBERPLANT



Dianella lasmanica Variegata
VARIEGATED FLAX LILY



Monstera deliciosa
SPLIT-LEAF PHILODENDRON

Michael Digitally signed
by Michael D
Conner
Date: 2025.02.16
Conner 16:55:57 -05'00'

MICHAEL CONNER, STATE OF FLORIDA REGISTERED
LANDSCAPE ARCHITECT
THIS ITEM HAS BEEN DIGITALLY SIGNED AND SEALED
BY MICHAEL CONNER, R.L.A. ON THE DATE
INDICATED HERE
SIGNATURES OF THIS DOCUMENT ARE NOT
CONSIDERED SIGNED AND SEALED AND THE
SIGNATURE MUST BE VERIFIED ON ANY ELECTRONIC

UNDERSTORY PLANTING PALETTE (1/2)



WJ ARCHITECTS
(727) 822-5666
www.wjarc.com
AR94244

MIAMI BEACH - 72ND STREET COMMUNITY COMPLEX
299 72ND STREET
MIAMI BEACH, FLORIDA. 33141

LA25

DRB24 - 1072
FINAL SUBMITTAL
FEBRUARY 14, 2025



Philodendron 'Burla Marx'
BURLE MARX PHILODENDRON



Philodendron 'Rejo Congo'
ROJO CONGO PHILODENDRON



Podocarpus macrophyllus
PODOCARPUS



Podocarpus macrophyllus 'Pringles'
PRINGLES DWARF YEW PODOCARPUS



Psychotria nervosa
WILD COFFEE



Psychotria nervosa 'Little Psycho'
LITTLE PSYCHO WILD COFFEE



Sophora tomentosa occidentalis
YELLOW NECKLACEPOD



Spartina bakeri
SAND CORDGRASS



Tradescantia pallida
PURPLE SPIDERWORT / PURPLE QUEEN



Tripsacum dactyloides
FAKAHATCHEE GRASS

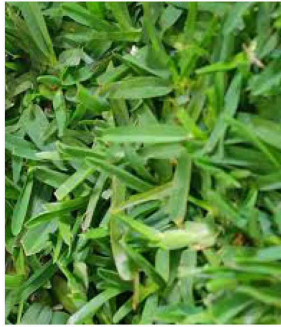

Stenotaphrum secundatum
ST. AUGUSTINE GRASS

Michael D Digitally signed
by Michael D
Conner
Date: 2025.02.16
Conner 16:56:20 -05'00'

MICHAEL CONNER, STATE OF FLORIDA REGISTERED
PROFESSIONAL ARCHITECT
THIS ITEM HAS BEEN DIGITALLY SIGNED AND SEALED
BY MICHAEL CONNER R.L.A. ON THE DATE
INDICATED HERE
SIGNATURES OF THIS DOCUMENT ARE NOT
CONSIDERED SIGNED AND SEALED AND THE
SIGNATURE MUST BE VERIFIED ON ANY ELECTRONIC
DOCUMENT

UNDERSTORY PLANTING PALETTE (2/2)



WJ ARCHITECTS
(727) 822-5666
www.wjarc.com
AR94244

©Warrenbacher Jensen Architects, Inc.

MIAMI BEACH - 72ND STREET COMMUNITY COMPLEX
299 72ND STREET
MIAMI BEACH, FLORIDA. 33141

LA26

DRB24 - 1072
FINAL SUBMITTAL
FEBRUARY 14, 2025

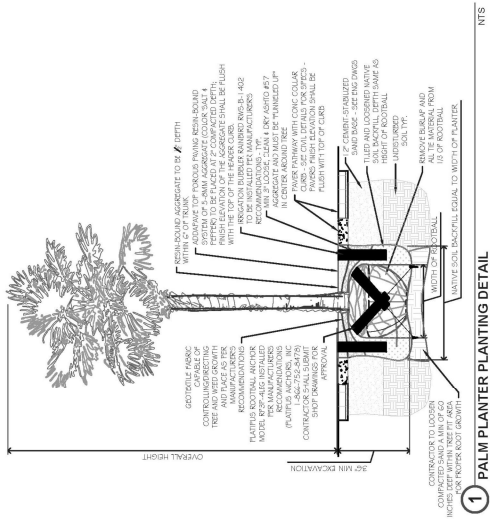

1 PALM PLANTER PLANTING DETAIL

N/S

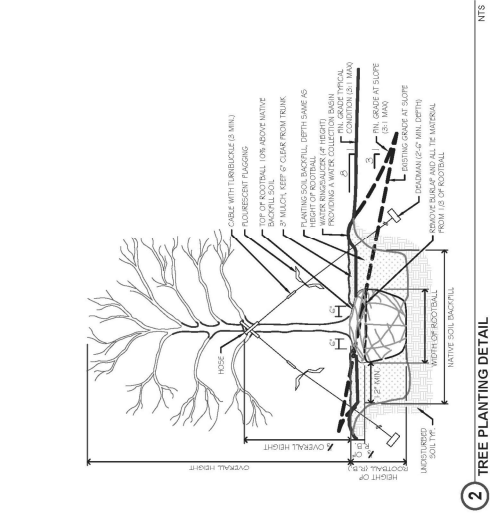

2 TREE PLANTING DETAIL

N/S

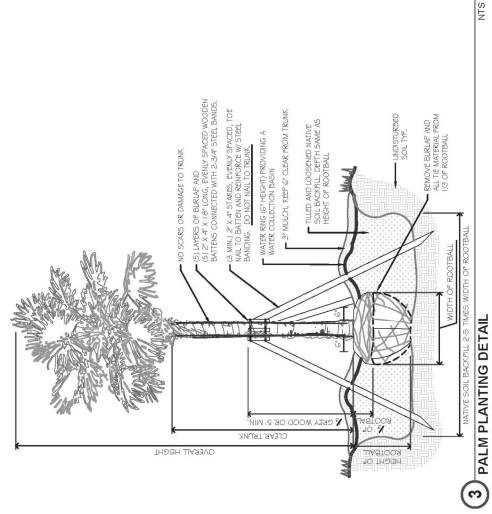

3 PALM PLANTING DETAIL

N/S

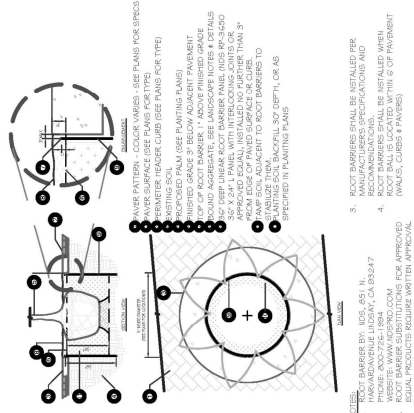

4 36\"/>

N/S

Michael D Conner
Digitally signed
by Michael D Conner
Date: 2025.02.16 16:56:45 -05'00'

MICHAEL CONNER, STATE OF FLORIDA REGISTERED ARCHITECT
THIS ITEM HAS BEEN DIGITALLY SIGNED AND SEALED BY MICHAEL CONNER R.L.A. ON THE DATE INDICATED HEREIN. ANY CHANGES TO THIS DOCUMENT ARE NOT CONSIDERED SIGNED AND SEALED AND THE SIGNATURE MUST BE VERIFIED ON ANY ELECTRONIC DOCUMENT.

TYPICAL PLANTING DETAILS

MIAMI BEACH - 72ND STREET COMMUNITY COMPLEX
299 72ND STREET
MIAMI BEACH, FLORIDA. 33141



©Warrencher Jensen Architects, Inc.

DRB24 - 1072
FINAL SUBMITTAL
FEBRUARY 14, 2025

LA27

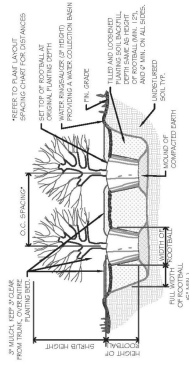

1 SHRUB PLANTING DETAIL

NIS

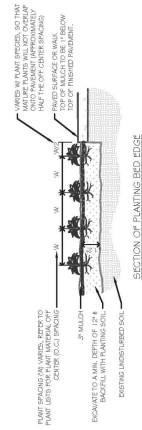

2 SPACING & LAYOUT DETAIL

NIS

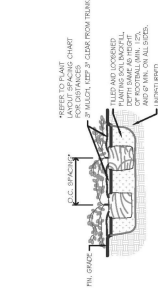

3 GROUND COVER PLANTING DETAIL

NIS

GROUND COVER / SHRUB SPACING (FT)	ROW SPACING (FT)
4	5
6	8
8	10
10	12
12	15
15	18
18	21
21	24
24	27
27	30
30	33
33	36
36	39
39	42
42	45
45	48
48	51
51	54
54	57
57	60
60	63
63	66
66	69
69	72
72	75
75	78
78	81
81	84
84	87
87	90
90	93
93	96
96	99
99	102
102	105
105	108
108	111
111	114
114	117
117	120
120	123
123	126
126	129
129	132
132	135
135	138
138	141
141	144
144	147
147	150
150	153
153	156
156	159
159	162
162	165
165	168
168	171
171	174
174	177
177	180
180	183
183	186
186	189
189	192
192	195
195	198
198	201
201	204
204	207
207	210
210	213
213	216
216	219
219	222
222	225
225	228
228	231
231	234
234	237
237	240
240	243
243	246
246	249
249	252
252	255
255	258
258	261
261	264
264	267
267	270
270	273
273	276
276	279
279	282
282	285
285	288
288	291
291	294
294	297
297	300
300	303
303	306
306	309
309	312
312	315
315	318
318	321
321	324
324	327
327	330
330	333
333	336
336	339
339	342
342	345
345	348
348	351
351	354
354	357
357	360
360	363
363	366
366	369
369	372
372	375
375	378
378	381
381	384
384	387
387	390
390	393
393	396
396	399
399	402
402	405
405	408
408	411
411	414
414	417
417	420
420	423
423	426
426	429
429	432
432	435
435	438
438	441
441	444
444	447
447	450
450	453
453	456
456	459
459	462
462	465
465	468
468	471
471	474
474	477
477	480
480	483
483	486
486	489
489	492
492	495
495	498
498	501
501	504
504	507
507	510
510	513
513	516
516	519
519	522
522	525
525	528
528	531
531	534
534	537
537	540
540	543
543	546
546	549
549	552
552	555
555	558
558	561
561	564
564	567
567	570
570	573
573	576
576	579
579	582
582	585
585	588
588	591
591	594
594	597
597	600
600	603
603	606
606	609
609	612
612	615
615	618
618	621
621	624
624	627
627	630
630	633
633	636
636	639
639	642
642	645
645	648
648	651
651	654
654	657
657	660
660	663
663	666
666	669
669	672
672	675
675	678
678	681
681	684
684	687
687	690
690	693
693	696
696	699
699	702
702	705
705	708
708	711
711	714
714	717
717	720
720	723
723	726
726	729
729	732
732	735
735	738
738	741
741	744
744	747
747	750
750	753
753	756
756	759
759	762
762	765
765	768
768	771
771	774
774	777
777	780
780	783
783	786
786	789
789	792
792	795
795	798
798	801
801	804
804	807
807	810
810	813
813	816
816	819
819	822
822	825
825	828
828	831
831	834
834	837
837	840
840	843
843	846
846	849
849	852
852	855
855	858
858	861
861	864
864	867
867	870
870	873
873	876
876	879
879	882
882	885
885	888
888	891
891	894
894	897
897	900
900	903
903	906
906	909
909	912
912	915
915	918
918	921
921	924
924	927
927	930
930	933
933	936
936	939
939	942
942	945
945	948
948	951
951	954
954	957
957	960
960	963
963	966
966	969
969	972
972	975
975	978
978	981
981	984
984	987
987	990
990	993
993	996
996	999
999	1002

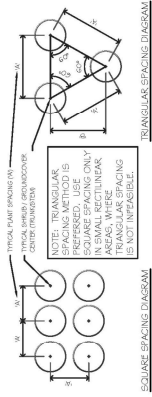

4 GROUND COVER & SHRUB DETAIL (ALL AREAS)

NIS

Michael D Conner
 Digitally signed by Michael D Conner
 Date: 2025.02.16 16:57:11 -05'00'

MICHAEL CONNER, STATE OF FLORIDA REGISTERED PROFESSIONAL ARCHITECT
 THIS ITEM HAS BEEN DIGITALLY SIGNED AND SEALED BY MICHAEL CONNER, R.L.A. ON THE DATE INDICATED HEREIN.
 THIS DOCUMENT AND ITS CONTENTS ARE NOT CONSIDERED SIGNED AND SEALED AND THE SIGNATURE MUST BE VERIFIED ON ANY ELECTRONIC COPY.

TYPICAL PLANTING DETAILS

WJ ARCHITECTS
 (777) 822-5666
 www.wjarc.com
 AR94244

MIAMI BEACH - 72ND STREET COMMUNITY COMPLEX
 299 72ND STREET
 MIAMI BEACH, FLORIDA. 33141

DRB24 - 1072
 FINAL SUBMITTAL
 FEBRUARY 14, 2025

LA28