

NOT FOR CONSTRUCTION  
 These Design And Drawings Are The Copyrighted Property Of Revuelta Architecture International P.A. and May Not Be Reproduced, Excerpted, or Modified Without the Written Consent of the Architect.  
 File: BIM2020-01-01-REVUELTA-ARCHITECTURE-INTERNATIONAL-PA-AMAN-HOTEL-AND-RESIDENCES-AMMAN-HISTORIC-HOTEL-By-Envario-Date: 6/20/2025

**revuelta**  
 architecture  
 international

**Miami**  
 Santiago, Chile

revuelta-architecture.com  
 2950 SW 27TH AVE  
 SUITE 110  
 MIAMI, FL 33133  
 T: 305.590.5000  
 F: 305.590.5040

**AMAN HOTEL AND  
 RESIDENCES**  
 3425 COLLINS AVE.  
 MIAMI BEACH, FL 33140

Owner Information  
**OKO GROUP**  
 4100 N.E. 2ND AVENUE  
 MIAMI, FL 33137  
 (305) 573-1158

Luis O. Revuelta  
 AR-0007972

**HPB - SEPTEMBER 16, 2025**

Date  
 6/20/2025  
 Scale  
 AS SHOWN  
 Project No.  
 1933  
 Sheet Name

CREATE A VERTICAL LATTICE SCREEN RESEMBLING GUITAR STRINGS.  
 THE APPROVED DESIGN CONTEMPLATED A THIN ALUMINUM PROFILE OF 1/2" X 3"

**CURRENT APPROVAL DESIGN INTENT**

CURRENT APPROVAL DESIGN  
 INTENT  
 Sheet No.

**A-201**

LEVEL 13 OMITTED

NOT FOR CONSTRUCTION

HONEY WHITE - RESILIENT MATERIALITY  
WOOD PRINT ALUMINIUM



DG013

APPLIED MATERIALITY

ORIGINAL LATTICE PROFILE PRESENTED **STRUCTURAL CHALLENGES** TENDING TO BEND UNDER LOCAL WIND LOADS.

THE PROFILE BECAME 6 TIMES **LARGER** THAN ORIGINAL CONCEPT WHEN ENGINEERED TO STRUCTURAL INTEGRITY STANDARDS DEVIATING FROM THE DESIGN INTENT.

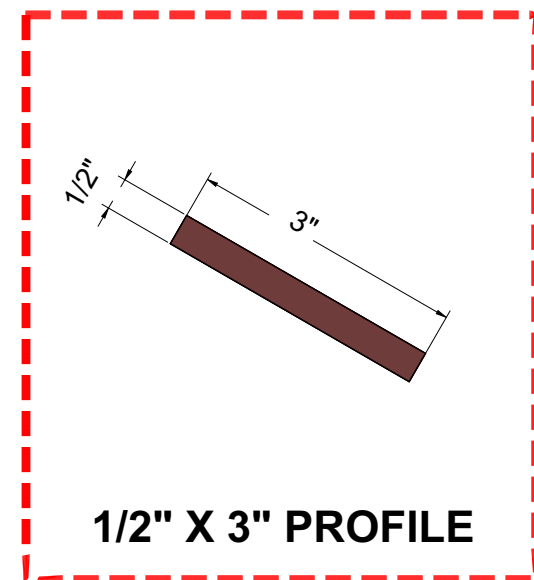
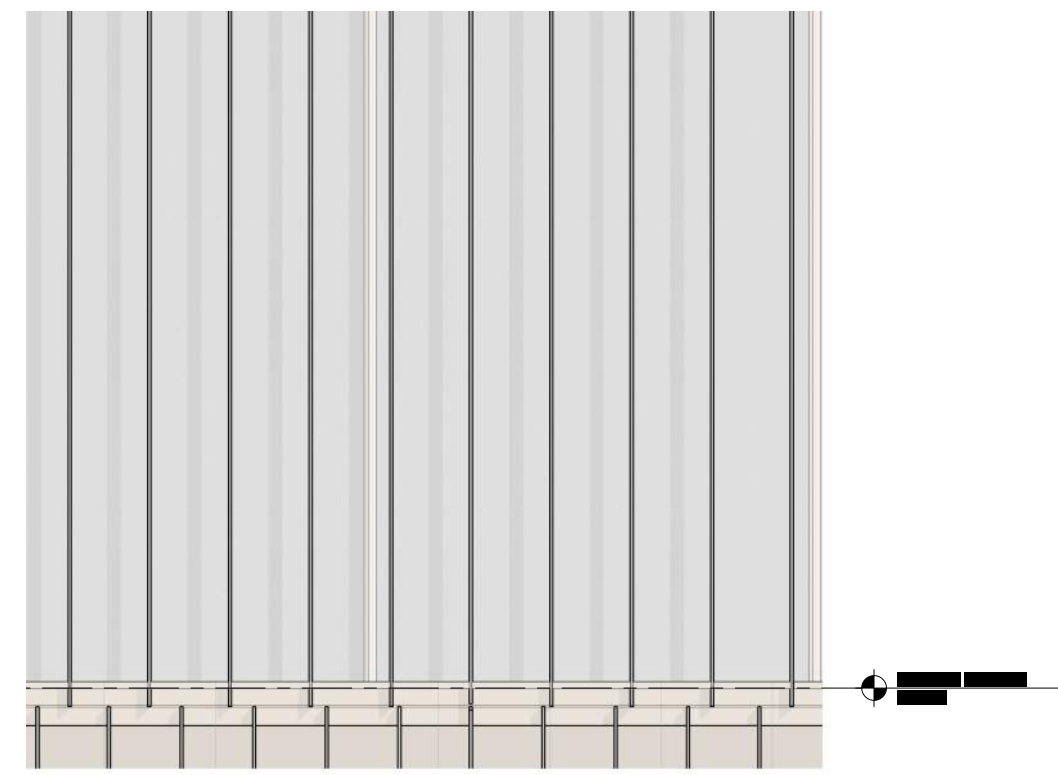
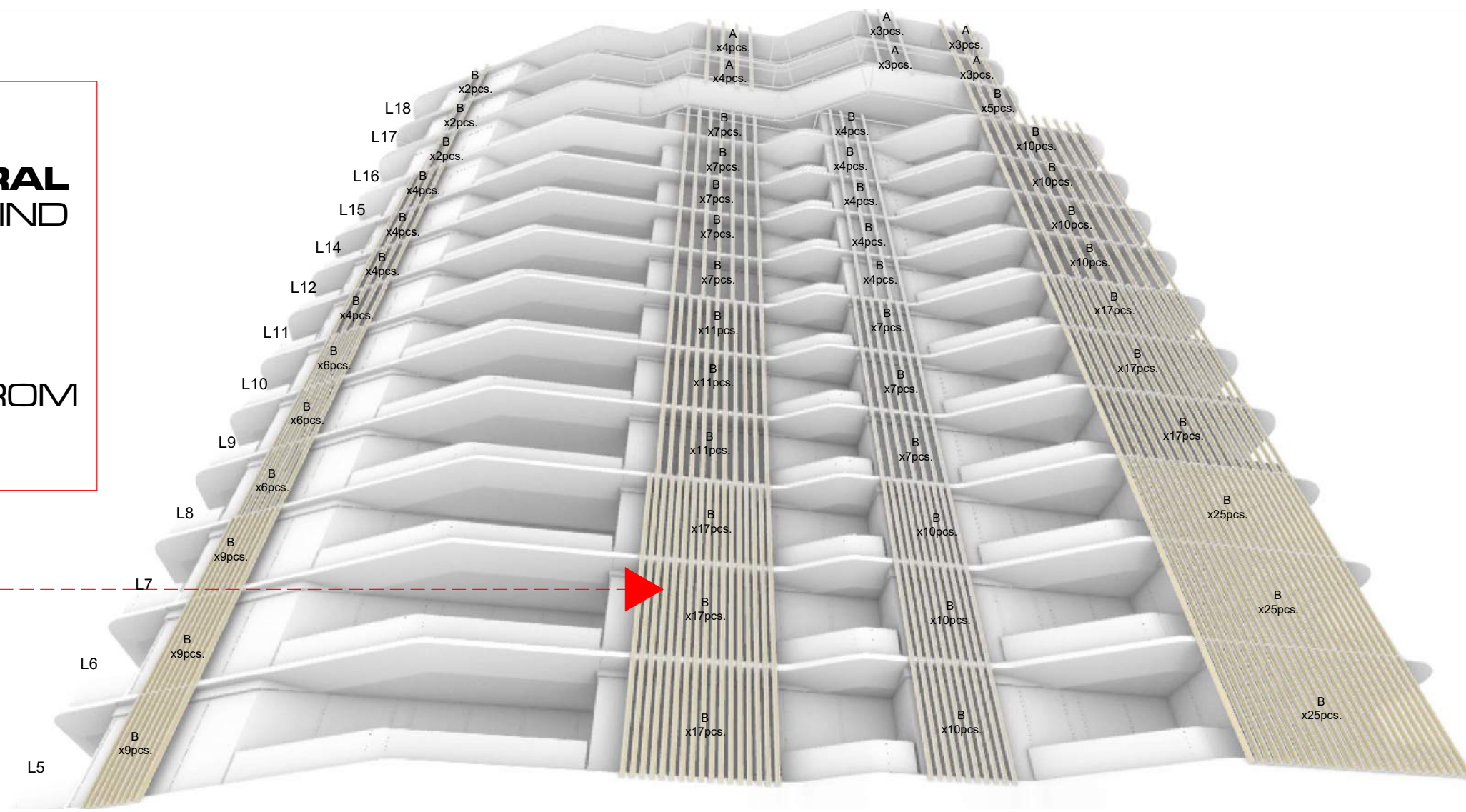

1/2" X 3" PROFILE

ENGINEERED PROFILE

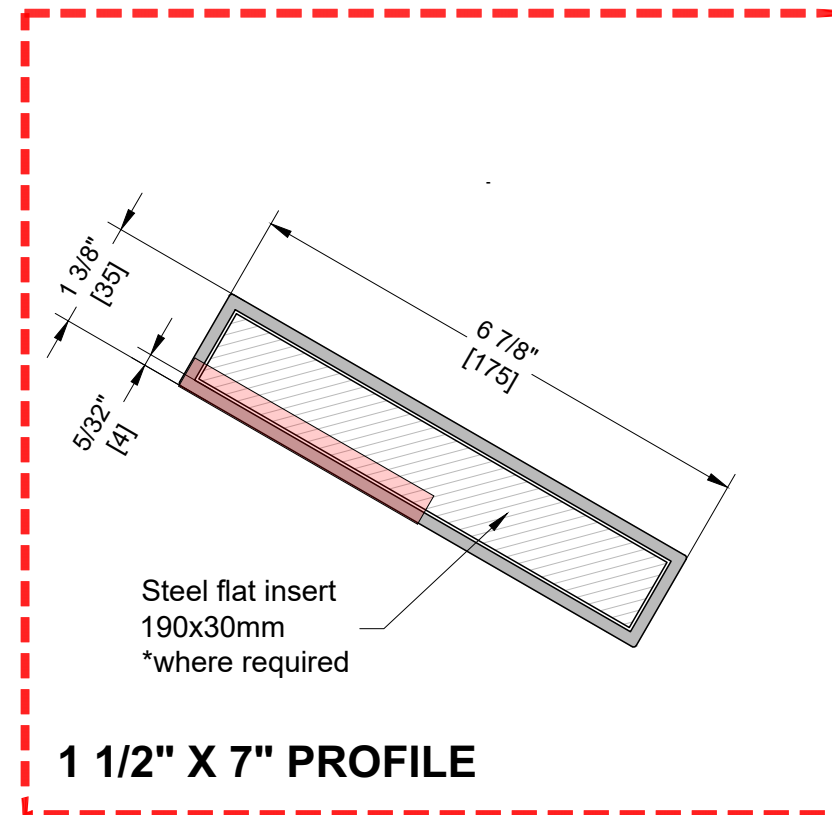

1 1/2" X 7" PROFILE

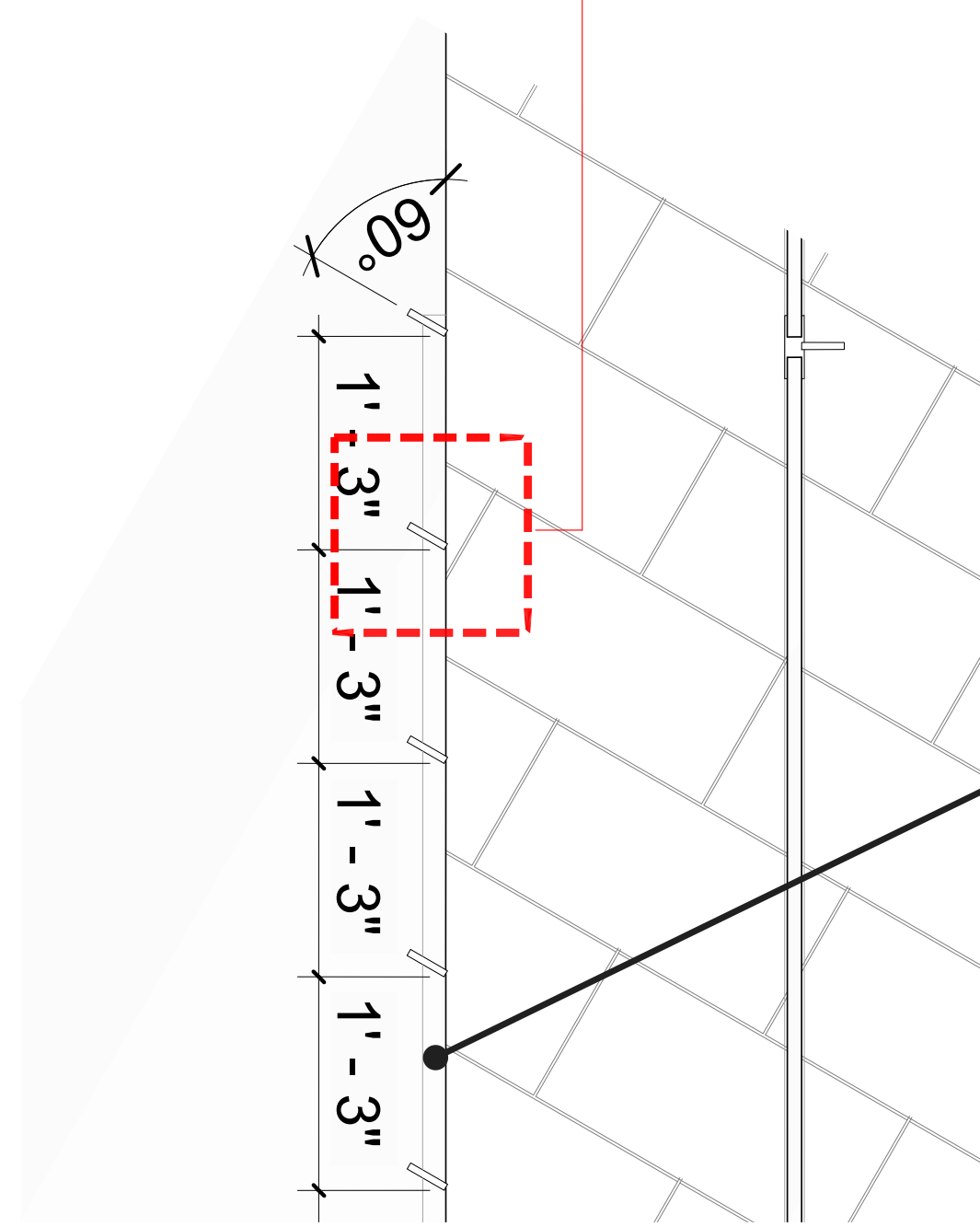
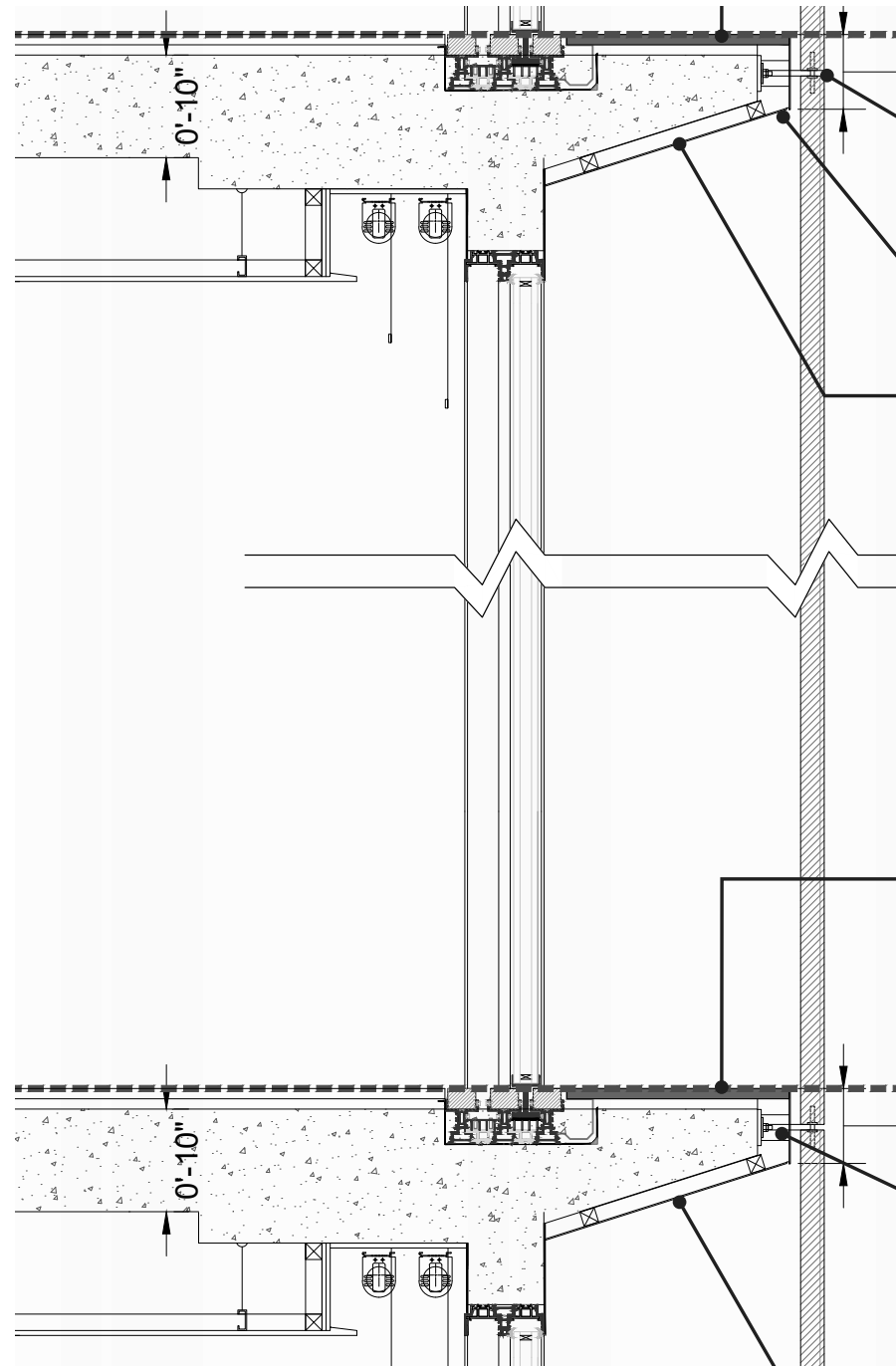

DESIGN INTENT

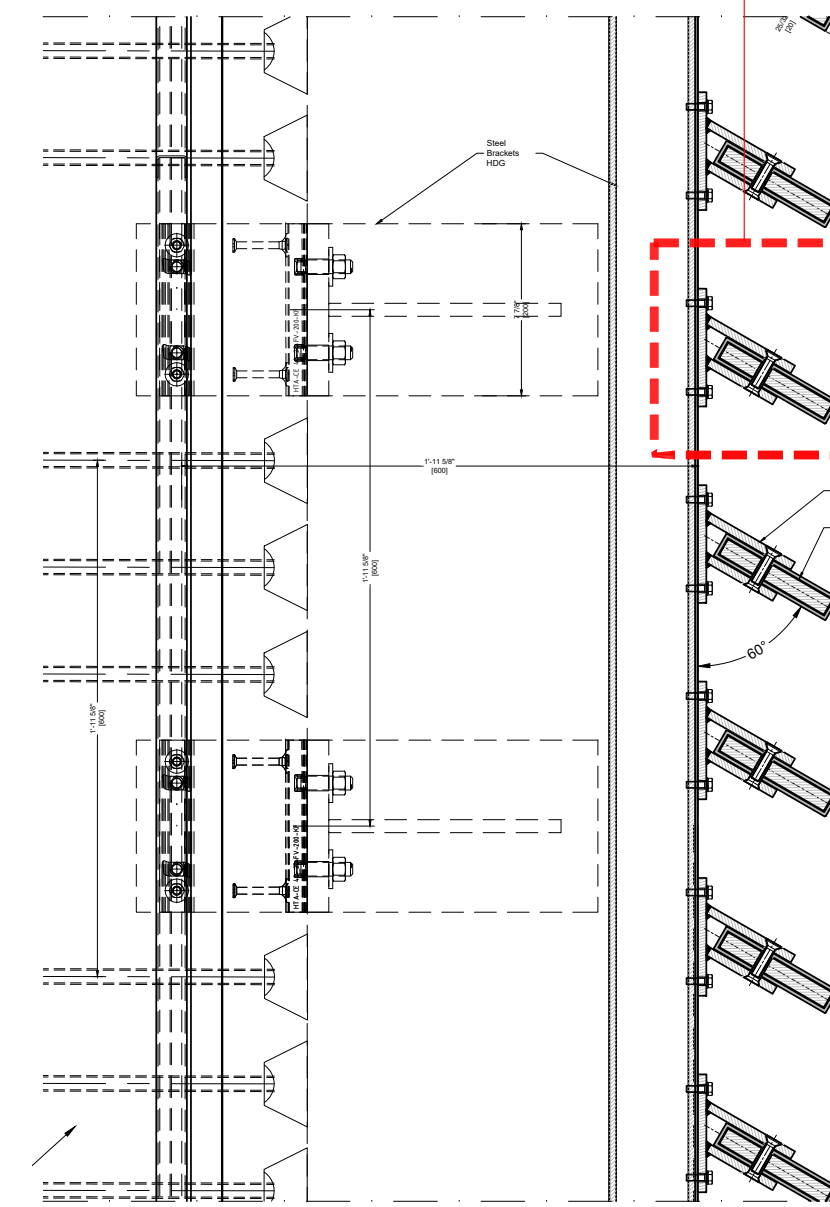
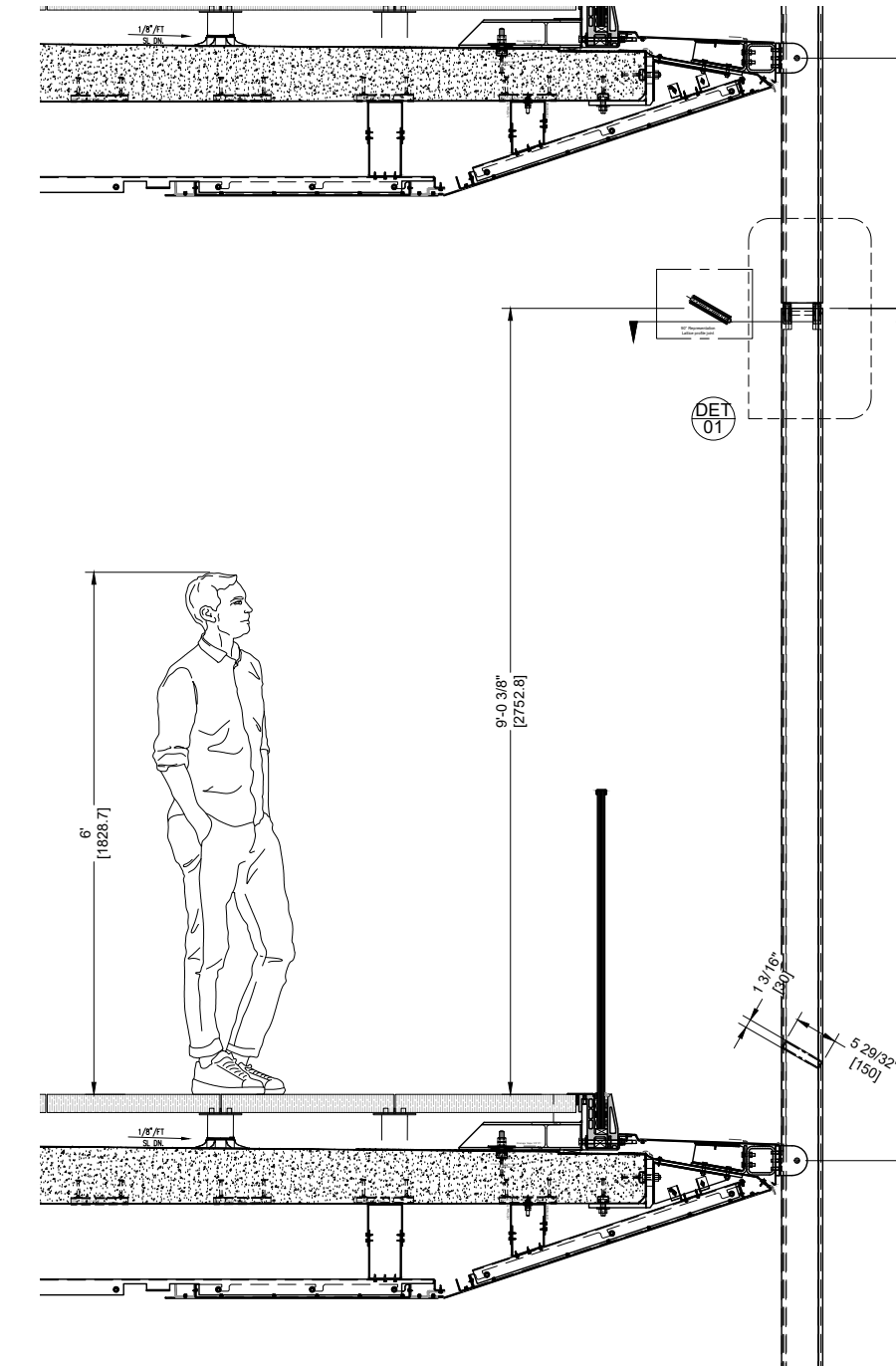

ENGINEERED DESIGN

**APPROVED DESIGN FAILS TO MEET STRUCTURAL INTEGRITY STANDARDS**

revuelta  
architecture  
international

Miami  
Santiago, Chile  
revuelta-architecture.com  
2950 SW 27TH AVE  
SUITE 110  
MIAMI, FL 33133  
T: 305.590.5000  
F: 305.590.5040

Project  
**AMAN HOTEL AND  
RESIDENCES**  
3425 COLLINS AVE.  
MIAMI BEACH, FL 33140

Owner Information

**OKO GROUP**  
4100 N.E. 2ND AVENUE  
MIAMI, FL 33137  
(305) 573-1158

Luis O. Revuelta  
AR-0007972

HPB - SEPTEMBER 16, 2025

Date  
6/20/2025  
Scale  
AS SHOWN  
Project No.  
1933  
Sheet Name

APPROVED DESIGN FAILS TO  
MEET STRUCTURAL INTEGRITY  
STANDARDS

Sheet No.

**A-202**

LEVEL 13 OMITTED

NOT FOR CONSTRUCTION

These Design and Drawings Are The Copyrighted Property Of Revuelta Architecture International P.A. and May Not Be Reproduced, Excerpted, or Modified Without the Written Consent of the Architect. File: BIM2023-01-BAISERVIERE - BIM2023-01-BAISERVIERE - AMAN HOTEL & RESIDENCES/AMAN HISTORIC HOTEL - By Enrique - Date: 6/20/2025

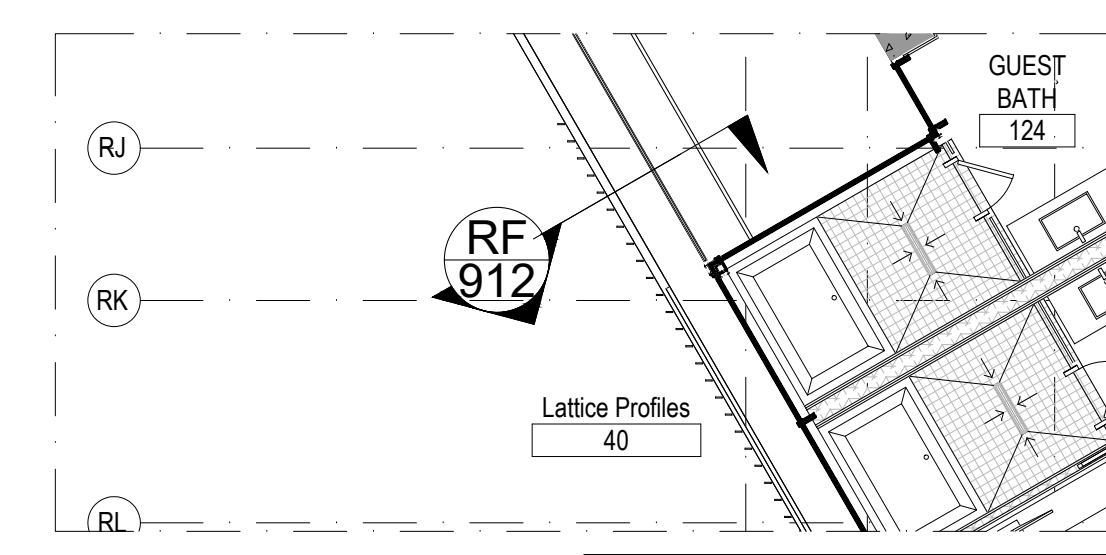
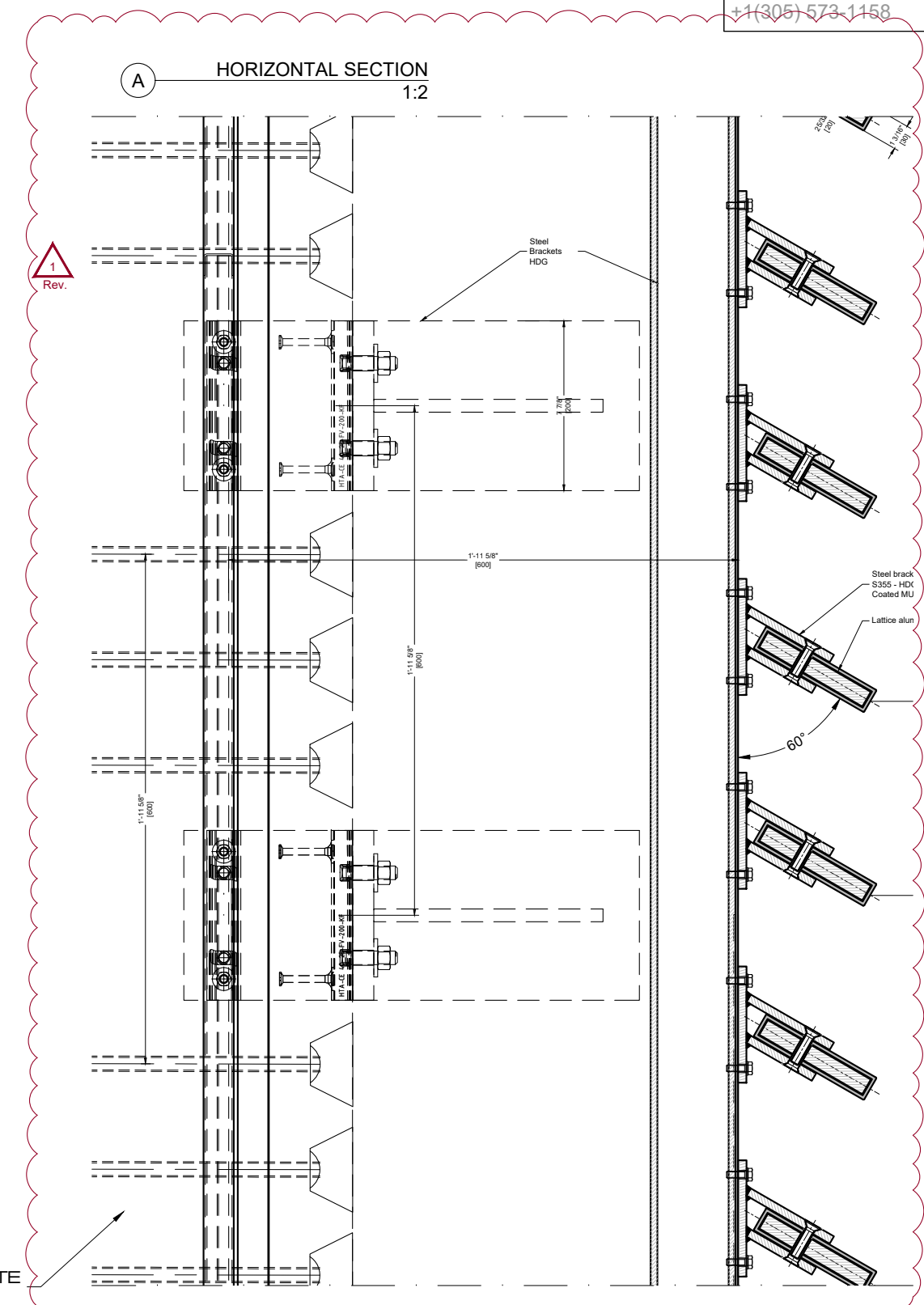
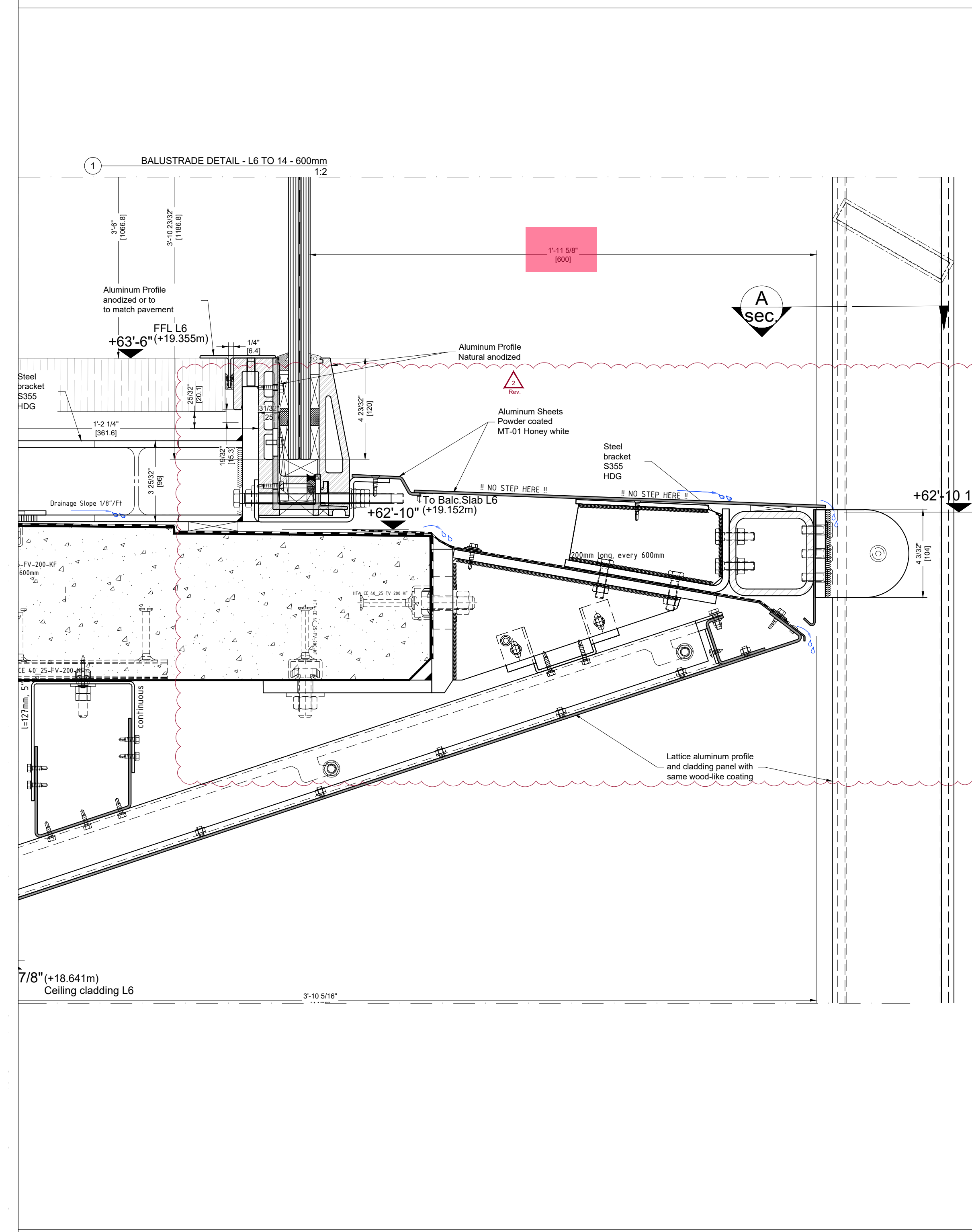

Apr 2023	NP/OLO	structural connection update	02
Feb 2023	NP/OLO	horizontal section added	01
Dec 2022	NP/OLO	Drawing start date	00
1/2023	NP/OLO	revision	00
Project Name		AMAN HOTEL AND RESIDENCES	Scale: Draw: ANSI E1 42" x 30"
Drawing Title		BALUSTRADE DETAIL L6 TO 14 - WITH LATTICE L6 TO 14	
LPI	UF	110488	RF-912 02

May, 2023 - PROGRESS SET - DESIGN ASSIST  
NOT FOR CONSTRUCTION

Project:  
AMAN HOTEL & RESIDENCES  
3425 COLLINS AVE.  
MIAMI BEACH, FL 33140

Client:  
OKO GROUP  
4100 N.E. 2ND AVENUE  
SUITE 307  
MIAMI, FL 33137  
(305) 573-1158

**ENGINEERED DESIGN**

**ORIGINAL LATTICE PROFILE PRESENTED STRUCTURAL CHALLENGES** TENDING TO BEND UNDER LOCAL WIND LOADS.

THE PROFILE BECAME 6 TIMES **LARGER** THAN ORIGINAL CONCEPT WHEN ENGINEERED TO STRUCTURAL INTEGRITY STANDARDS DEVIATING FROM THE DESIGN INTENT.

**APPROVED DESIGN FAILS TO MEET STRUCTURAL INTEGRITY STANDARDS**

LEVEL 13 OMITTED

**revuelta**  
architecture  
international

Miami  
Santiago, Chile

revuelta-architecture.com  
2850 SW 27TH AVE  
SUITE 110  
MIAMI, FL 33133  
T: 305.590.5000  
F: 305.590.5040

Project

**AMAN HOTEL AND RESIDENCES**  
3425 COLLINS AVE.  
MIAMI BEACH, FL 33140

Owner Information

**OKO GROUP**  
4100 N.E. 2ND AVENUE  
MIAMI, FL 33137  
(305) 573-1158

Luis O. Revuelta  
AR-0007972

HPB - SEPTEMBER 16, 2025

Date  
6/20/2025  
Scale  
AS SHOWN  
Project No.  
1933  
Sheet Name

APPROVED DESIGN FAILS TO MEET STRUCTURAL INTEGRITY STANDARDS

Sheet No. **A-203**





