

FOR REFERENCE ONLY



HPB SUBMITTAL



NATURALFICIAL
6915 Red Rd Suite 224, Coral Gables, FL 33143
T 786.717.6564

THIS ITEM HAS BEEN DIGITALLY SIGNED
AND SEALED BY PETER ANSELMO ON 04.17.2023

LINCOLN ROAD 100 BLOCK
MIAMI BEACH, FL 33139

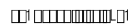

SCALE: NTS

DATE:
11/06/2023

L-1.02

FOR REFERENCE ONLY

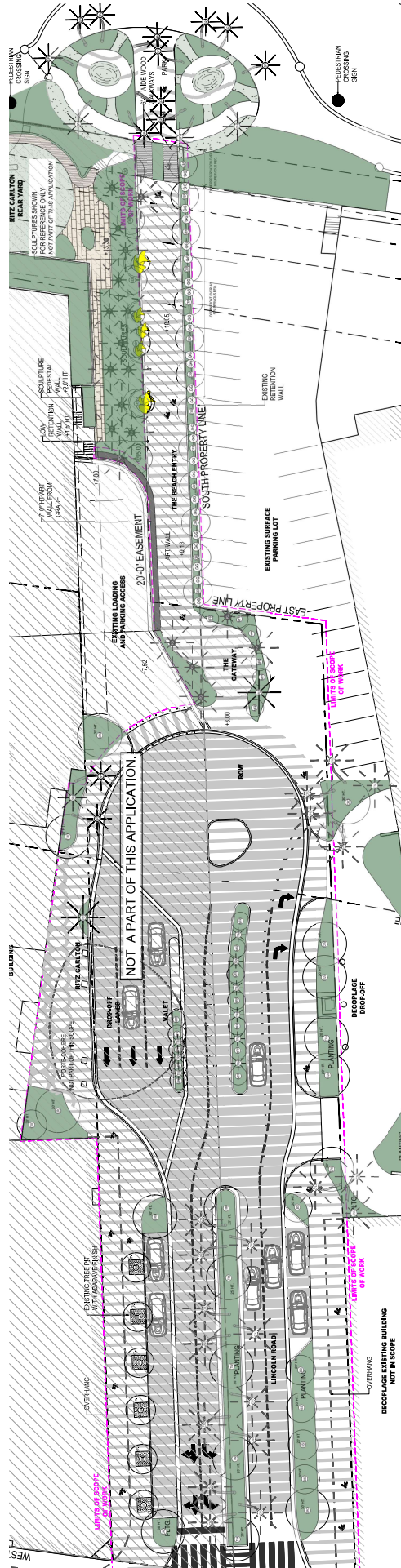

NOTE: THERE SHALL BE NO IMPACT ON DUNE SYSTEM.

NOTE: ALL LANDSCAPE WORK NORTH OF SOUTH PROPERTY LINE IS PART OF THE PRIVATE APPLICATION AND IS SHOWN FOR REFERENCE ONLY.

NOTE: SEE SHEET L-3.11 FOR LANDSCAPE LIST

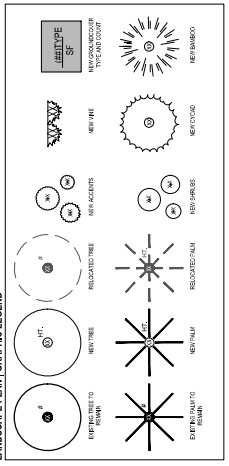

DATE: 11/06/2023

L-3.10

SCALE: 1" = 40'-0"

LINCOLN ROAD 100 BLOCK
MIAMI BEACH, FL 33139

THIS ITEM HAS BEEN DIGITALLY SIGNED
AND SEALED BY PETER ANSELMO, D.M.A., 12/2023

NATURALFICIAL
6915 Red Rd Suite 224, Coral Gables, FL 33143
T 786.717.6564



HPB SUBMITTAL

FOR REFERENCE ONLY



NOTE: IRRIGATION PLAN TO BE DEVELOPED IN SUBSEQUENT SUBMITTALS.

HPB SUBMITTAL

L-5.10

DATE: 11/06/2023

LINCOLN ROAD 100 BLOCK
MIAMI BEACH, FL 33139

NATURALFICIAL
6915 Red Rd Suite 224, Coral Gables, FL 33143
T 786.717.6564



WWW.NATURALFICIAL.COM



SCALE: NTS

