

MARCH, 2024
Landscape set

MARSEILLE LOT 11
Residential

DRAWING INDEX

Sheet No.	Sheet Title
L-101	TREE DISPOSITION PLAN
L-102	LANDSCAPE PLAN
L-103	LANDSCAPE DETAILS AND NOTES
L-104	PLANT MATERIAL

PARAMETRIKA LAND & DESIGN
Gabriela Alborno
Theresa Wymer LA6667363



MARSEILLE LOT 11
Miami Beach, FL 33141

SHEET TITLE
Cover sheet

ISSUE DATE
03/30/2024

REVISION
March, 2024

DESIGN
GA

DRAWN
TY

SCALE

SEAL

THERESA WYMER
LA6667363

SHEET NUMBER

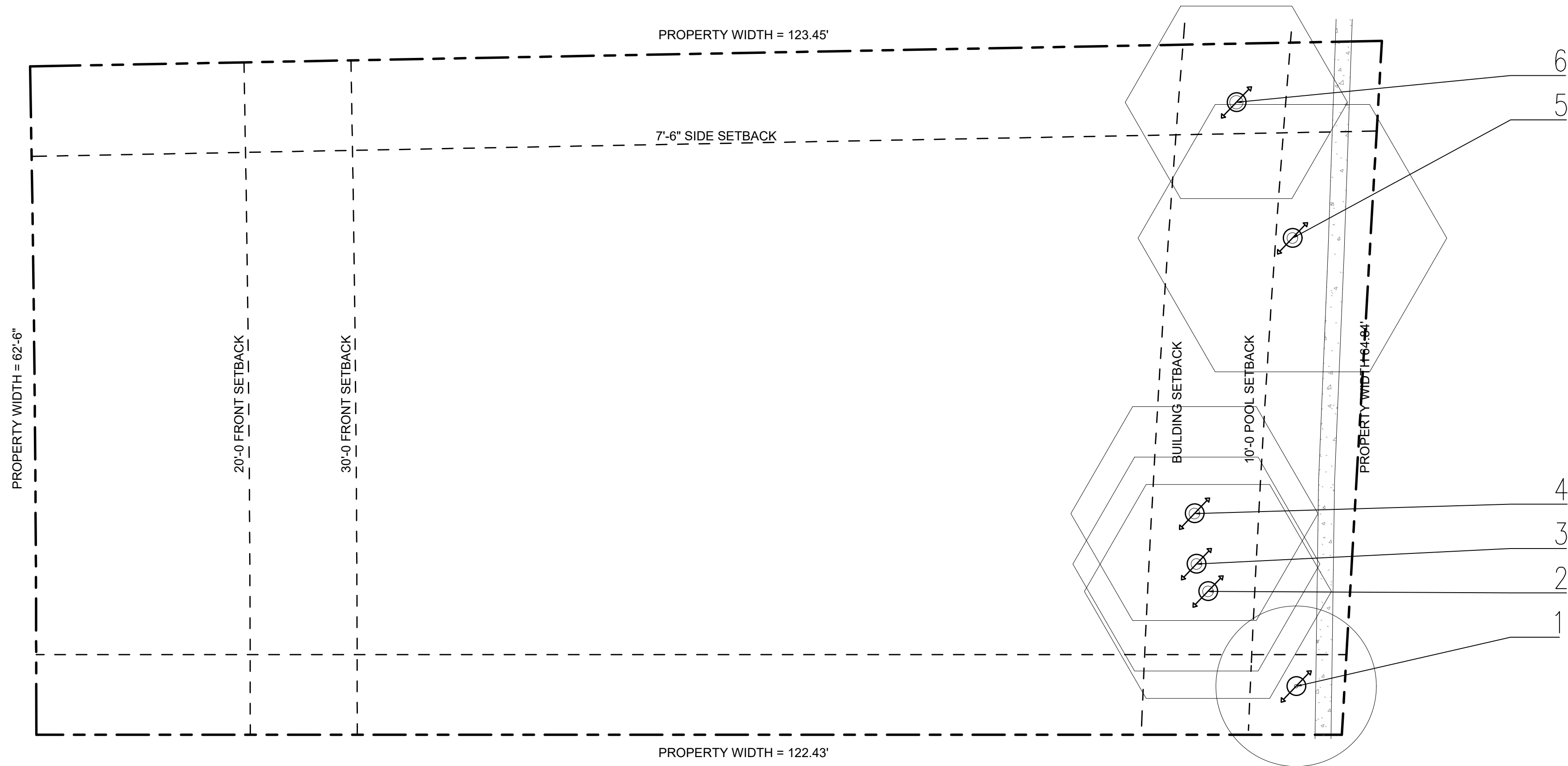

#	SCIENTIFIC NAME NAME	COMMON NAME	DBH in	HGT ft	CAN ft	CONDITION	DEPOSITION
1	CUPRESSUS SEMPERVIRENS	CYPRESS TREE	04	20	15	Good	Relocate
2	COCOS NUCIFERA	COCONUT	12	18	20	Good	Relocate
3	COCOS NUCIFERA	COCONUT	12	18	20	Good	Relocate
4	COCOS NUCIFERA	COCONUT	12	18	20	Good	Relocate
5	COCOS NUCIFERA	COCONUT	12	35	25	Good	Relocate
6	ARECACEAE	PALM	15	06	18	Good	Relocate

LEGEND

TO RELOCATE
 TO REMOVE
 TO REMAIN
 ANSI TREE PROTECTION ZONE
(FOR EVERY INCH [1] OF TRUNK DIA., THERE WILL BE 1' (FT.) OF DISTANCE OUT FROM THE TRUNK)

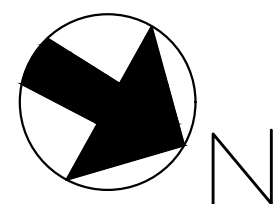

PARAMETRIKA LAND & DESIGN
 Gabriela Albomoz
 Theresa Wymer LA6667363



MARSEILLE LOT 11
 Miami Beach, FL 33141

SHEET TITLE
Tree disposition plan

ISSUE DATE
03/30/2024

REVISION
March, 2024

DESIGN
GA

DRAWN
TY

SCALE
1/8" = 1'-0"

SEAL
 THERESA WYMER
 LA6667363

SHEET NUMBER
L-101

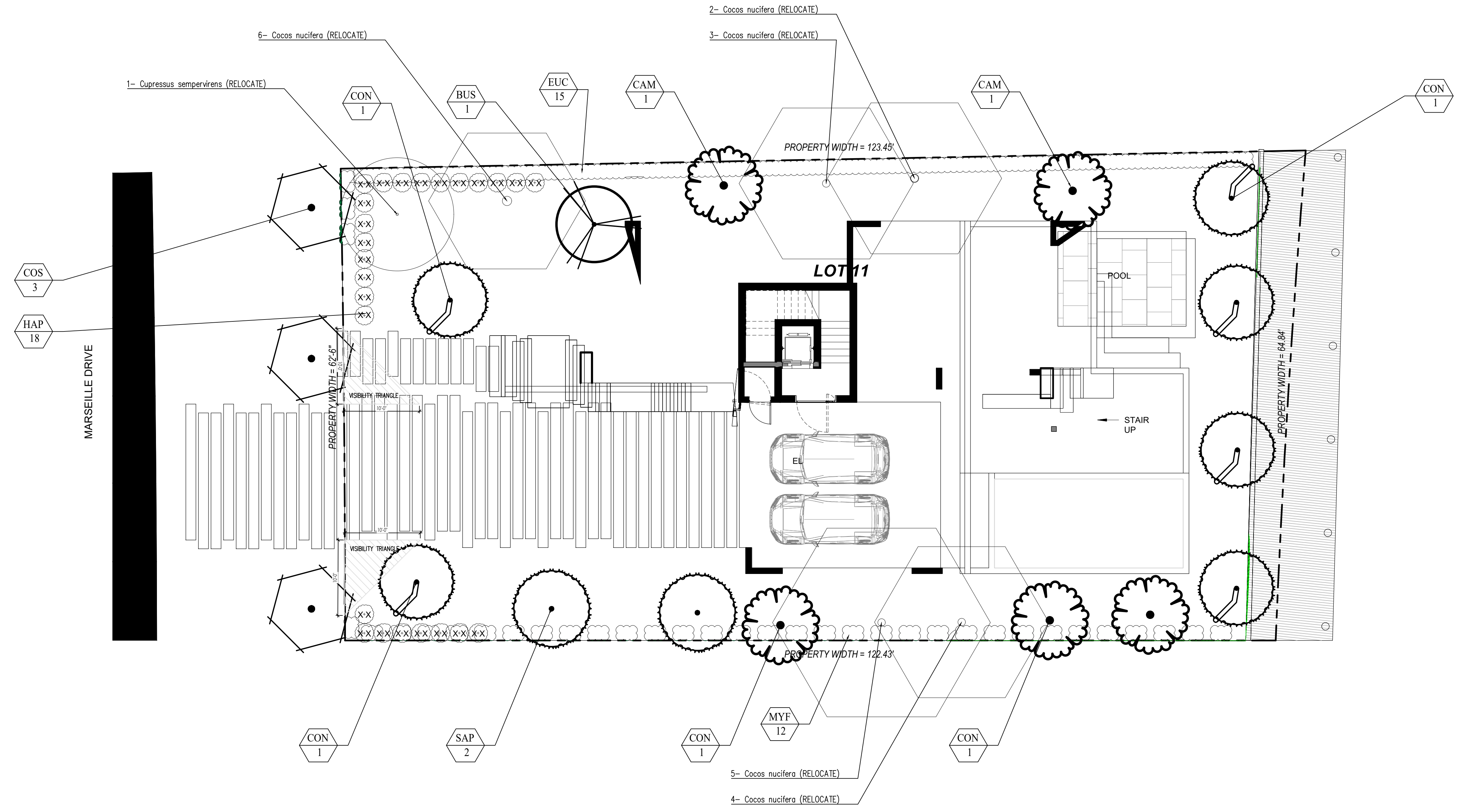

PROPOSED PLANT LIST						
SYM	BOTANICAL NAME	COMMON NAME	SPEC	NATIVE	DROUGHT	QTY
TREES + PALMS						
CAM	<i>Caryota mitis</i>	Fishtail Palm	24' HT			5
CON	<i>Cocos nucifera</i>	Coconut Palm	24'-26' HT CRV TRUNK			6
BUS	<i>Bursera simaruba</i>	Gumbo Limbo Tree	20'-22' OA 10"-12" DBH	*		1
SAP	<i>Sabal Palmetto</i>	Cabbage Palm	24'-26' OA DBL	*		3
SHRUBS + ACENTS						
EUC	<i>Eugenia confusa</i>	Redberry Stopper	25G 48" OC	*		15
MYF	<i>Myrcianthes fragrans</i>	Simpson Stopper	25G 48" OC	*	*	12
HAP	<i>Hamelia patens</i>	Fire Bush	15G 36" OC	*		18

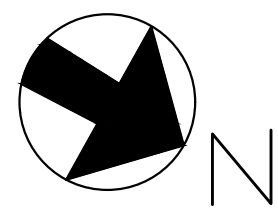

PARAMETRIKA LAND & DESIGN
Gabriela Alborno
Theresa Wymer LA6667363

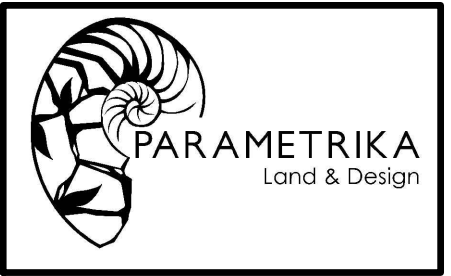

MARSEILLE LOT 11
Miami Beach, FL 33141

SHEET TITLE
Landscape plan

ISSUE DATE
03/30/2024

REVISION
March, 2024

DESIGN
GA

DRAWN
TY

SCALE
1/8" = 1'-0"

SEAL
THERESA WYMER
LA6667363

SHEET NUMBER
L-102

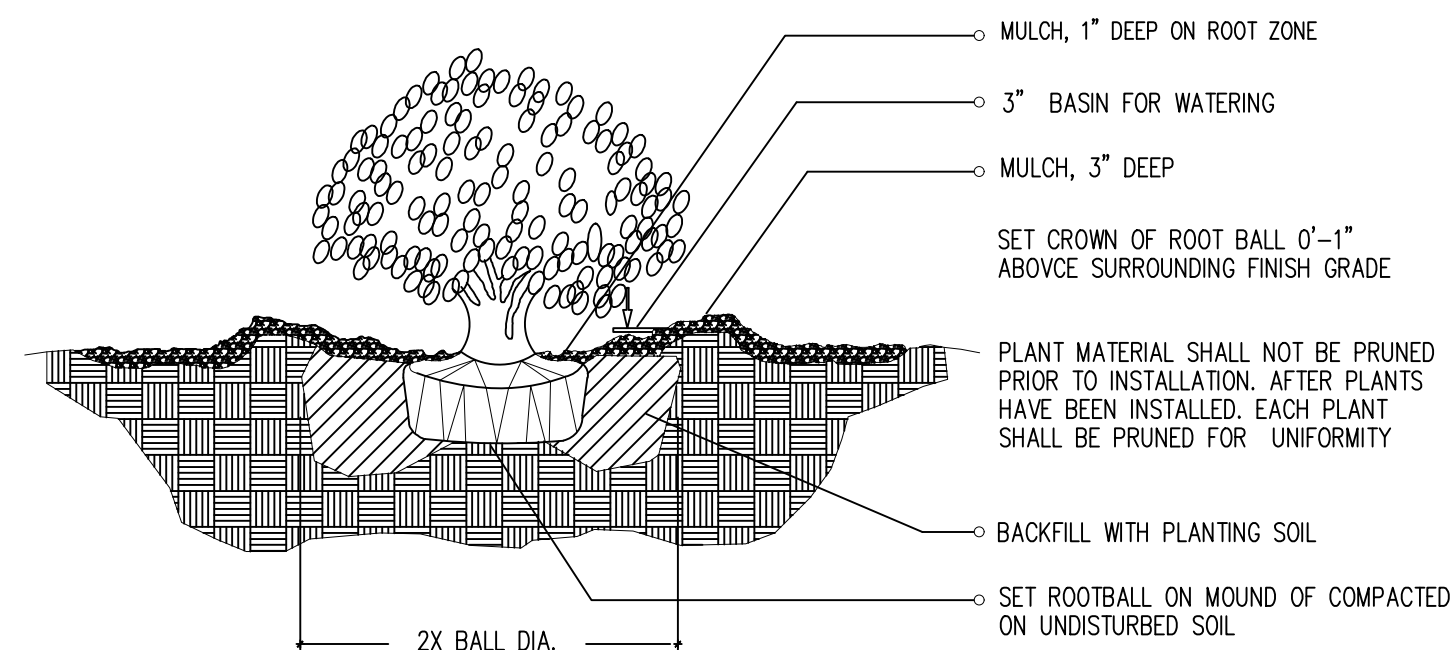

1-1 SHRUB / PLANTING DETAIL

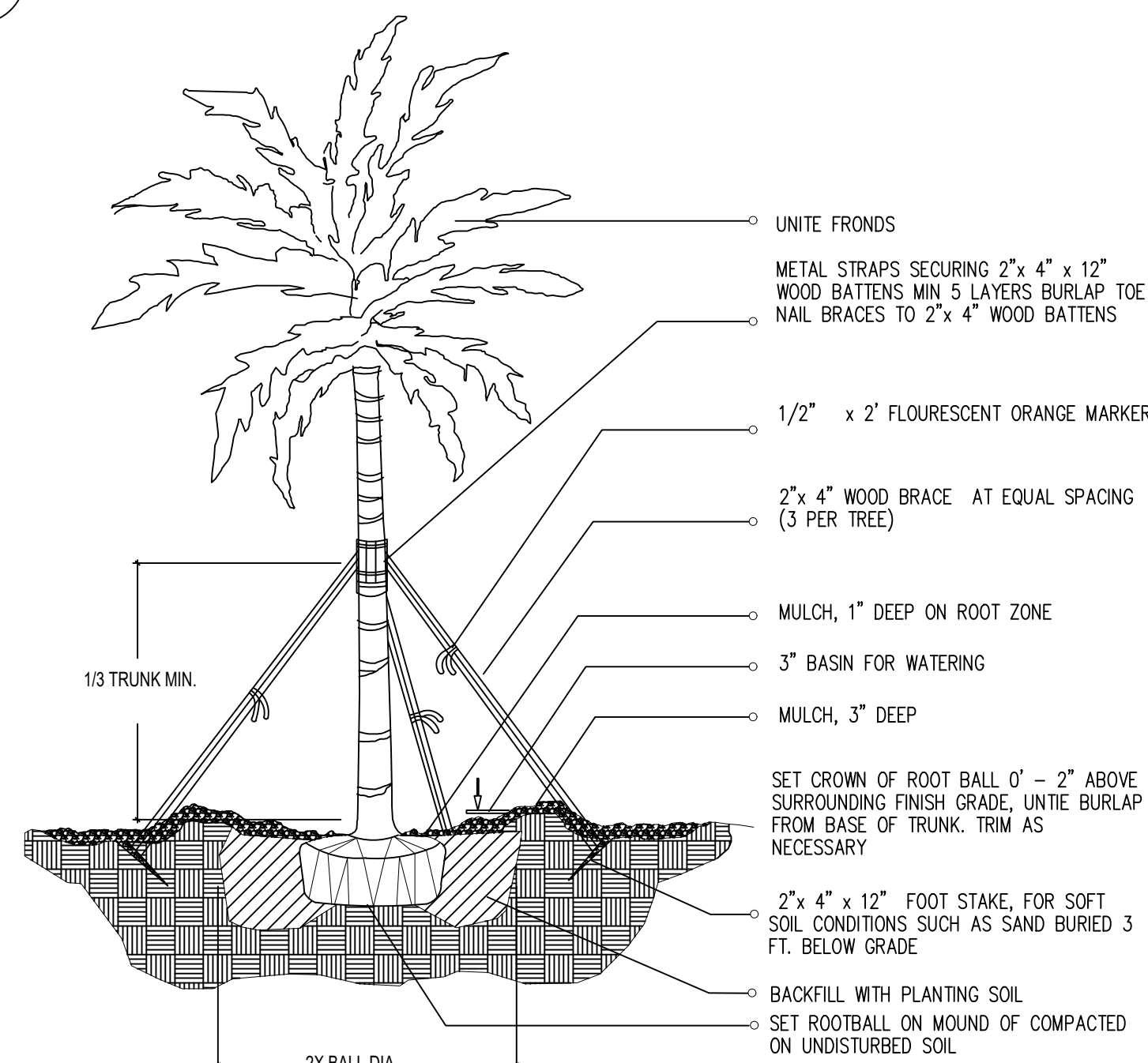

1-4 LARGE PALM / PLANTING DETAIL

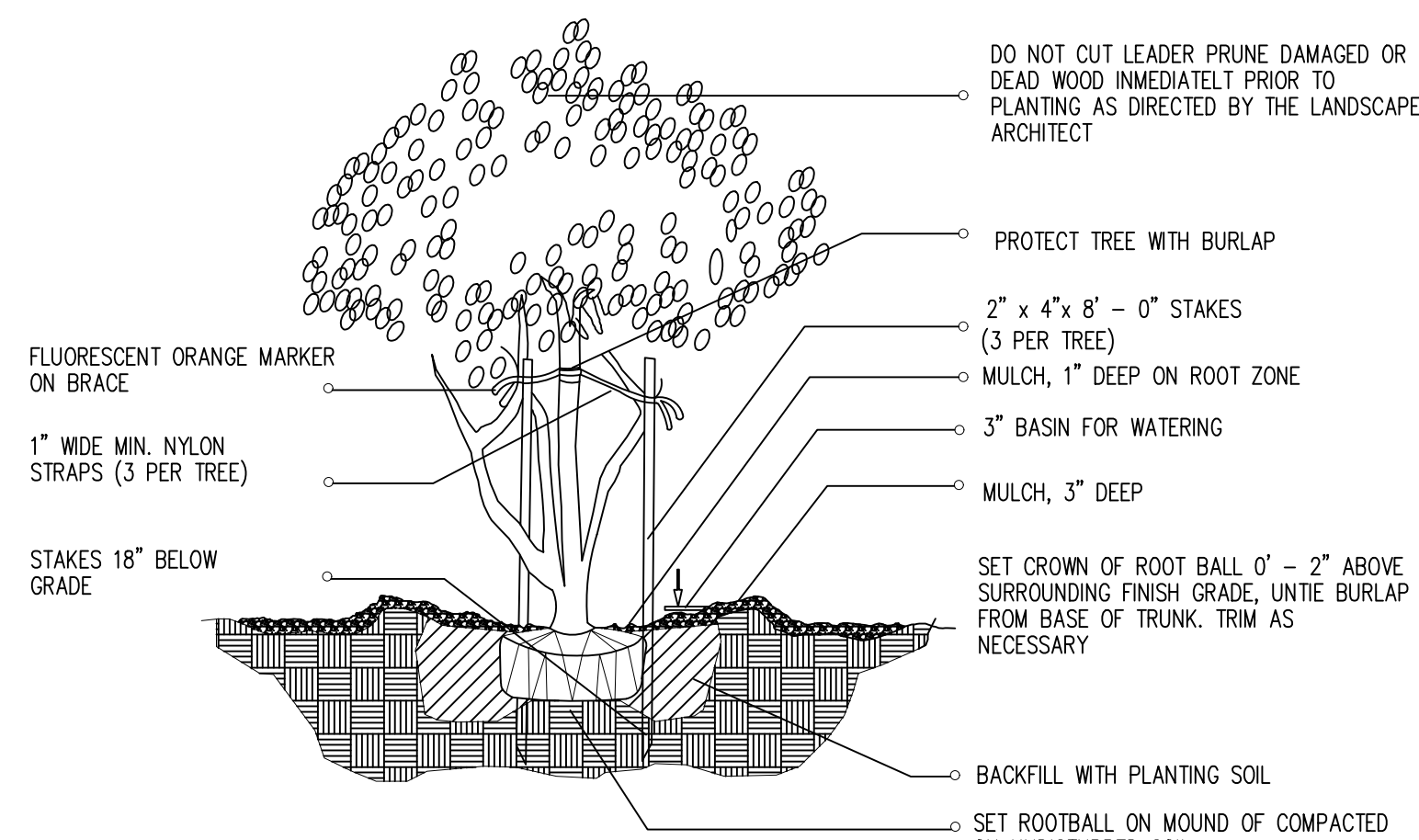

1-2 MULTI-TRUNK AND SMALL TREE (2' cal. and under) / PLANTING DETAIL

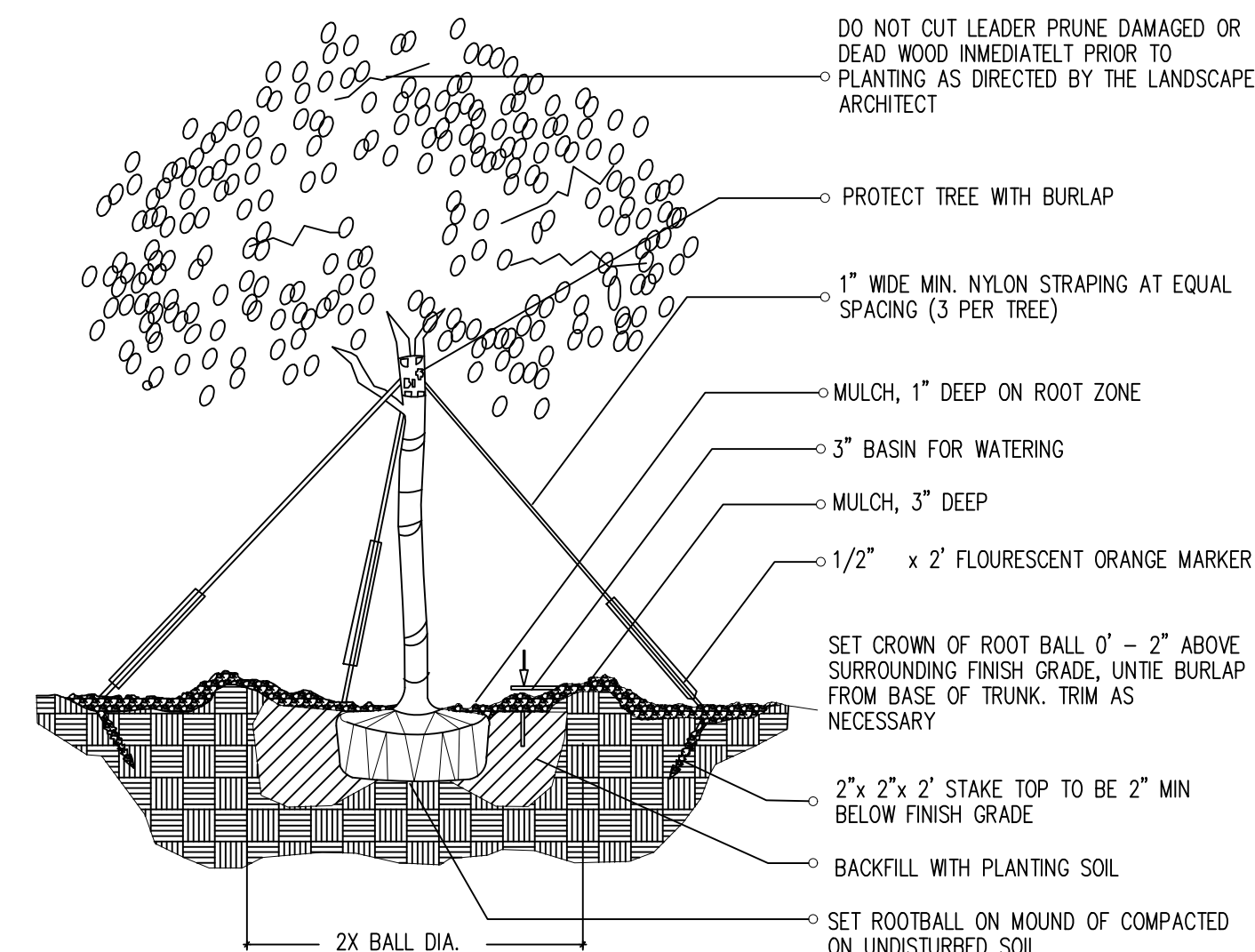

1-3 (2" cal. and over) LARGE TREE / PLANTING DETAIL

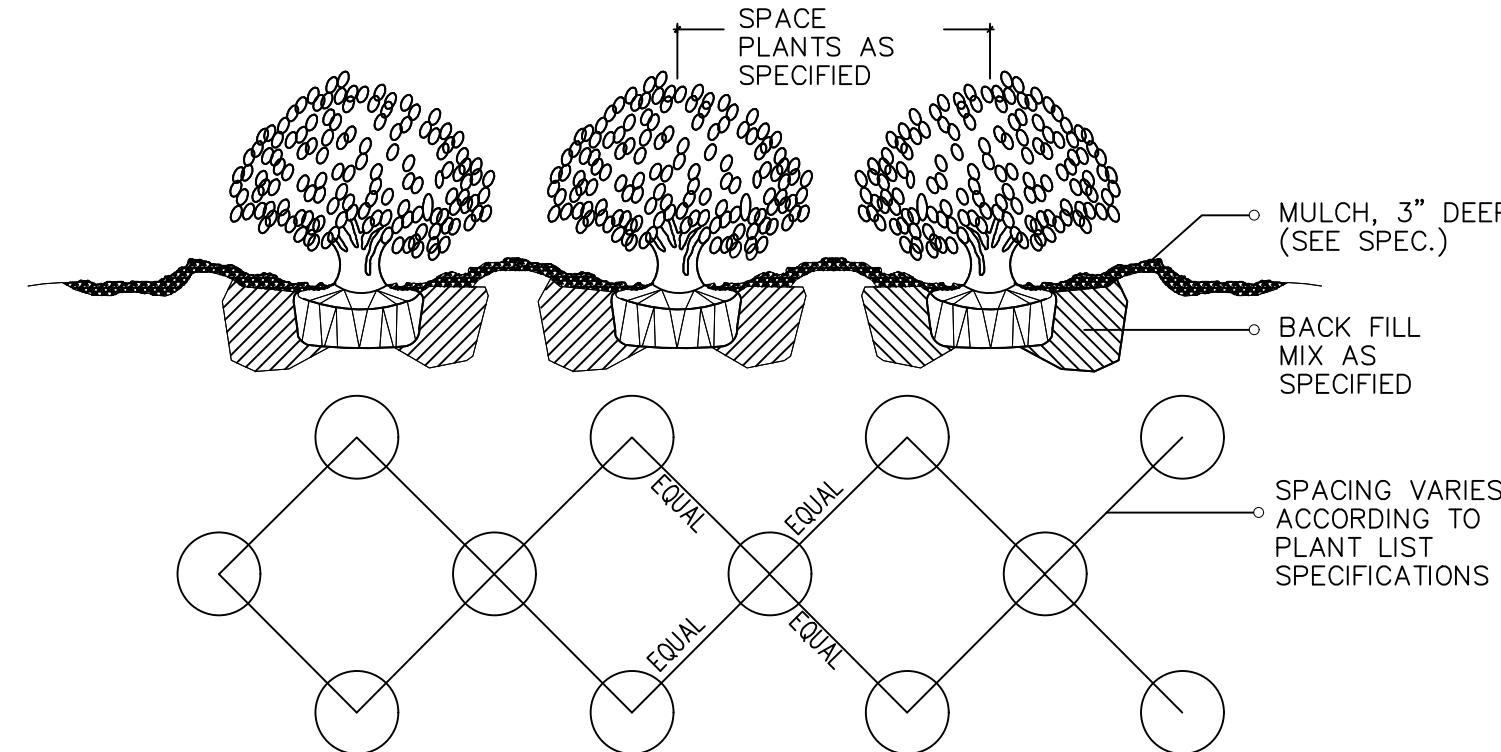

1-6 SHRUB / GROUND COVER SPACING PLANTING DETAIL

LANDSCAPE LEGEND			
INFORMATION REQUIRED TO BE PERMANENTLY APPLIED TO PLANS			
Transect Zone	RS-4	Lot Area	7,977 Acres
OPEN SPACE		REQUIRED	PROVIDED
A. Square feet of required Open Space, as indicated on site plan: Lot Area = 7,977 s.f. x .50 % = 3,989 s.f.		3,989	7,735
B. Square feet of parking lot open space required by Article 9, as indicated on site plan: Number of parking spaces _____ x 10 s.f. per parking space =			
C. Total square feet of landscaped open space required: A+B=		3,989	7,735
LAWN AREA CALCULATION			
A. Square feet of landscaped open space required:		3,989	7,735
B. Maximum lawn area (sod) permitted = .50 % x 7,735 s.f.		3,868	2,592
TREES			
A. Number of trees required per net lot acre, less existing number of trees meeting minimum requirements = _____ net lot acres - number of existing trees =		7	2 (1 ex.)
B. % Palms allowed: Number of trees provided x 30% =		5	19 palms (5 ex.)
C. % Natives required: Number of trees provided x 30% =		1	1
D. % Drought tolerant and low maintenance: _____ Number of trees provided x 20% =		1	1
E. Street Trees (maximum average spacing of 20' o.c.): _____ linear feet along street / 20 =		3	3
% Palms permitted to count towards street trees on 1:1 basis x 30%:			
F. Street trees located directly beneath power lines: (maximum average spacing of 25' o.c.): _____ linear feet along street / 25 =			
SHRUBS			
A. Number of shrubs required: Number of trees required x 12 =		84	0
B. % Native shrubs required: Number of shrubs required x 50% =		23	0
LARGE SHRUBS OR SMALL TREE			
A. Number of large shrubs or small trees required: Number of shrubs required x 10% =		9	45
B. % Native large shrubs or small trees required: Number of large shrubs or small trees required x 50% =		5	45

- LANDSCAPE NOTES**
- Non Cypress variety mulch shall extend under all trees, shrubs and ground cover beds to the closest hard edge or soil border, in a minimum of 3" depth.
 - All plants shall meet the minimum standard of Florida No. 1 or better as specified in Grade and Standards for Nursery Plants as published by the Division of Plant Industry, Florida Department of Agriculture, latest edition.
 - All shrubs to be planted a minimum of 24", and ground covers a minimum of 12" from the edge of walks, building walls, pond's edge, etc., *Ilex nana* *Genet* and *Raphiopholis Indica* to be planted 30" from edge of walkways.
 - All trees and palms over 8" in height shall be braced to prevent lateral movement for a period of six months from the date of planting. Either wood braces or shown in the planting detail, or the wire and turnbuckle method shall be used. No nails, screws, metal straps or wires are to be used directly against the trees or palms trunks.
 - All palms except for species such as *Cocos*, *Acroelaphie*, *Raphis*, and other multi-trunk palms, shall have straight trunks, free of scars, decay or any damage caused by digging, transport or planting handling of the same.
 - All work by the Landscape Contractor shall be performed in a professional and sound manner in accordance with established standards of landscape installation practices and watering.
 - Landscape Contractor is responsible for verifying plant quantities prior to bidding. Quantities shown in the plans may vary due to actual site scale, job conditions, etc., Landscape Architect assumes no responsibility for the actual plant count necessary for the successful completion of the work.
 - Landscape Contractor and his subcontractors shall be licensed and insured as required by the municipality, county, state or any other governmental agency requiring a license or insurance in order for the Landscape Contractor to perform its work.
 - All work shall conform to Miami-Dade County's landscape ordinance, Chapter 18-A, ordinance # 98-13, and any other municipal landscape ordinance in effect at the project's location, including streets-trees.
 - Landscape Contractor is required to procure and obtain any necessary permits applicable for the successful completion of this project, if applicable.
 - Landscape material shall not be allowed to grow in such a manner as to impede streetfront triangle of visibility to property owner or neighbors, so as to materially impede vision between a height of 3 feet and 8 feet.
 - Landscape Contractor shall call Sunshine State One Call Center of Florida at 1-800-422-4770 (Call Free) 48 hours before digging.
 - Landscape Contractor is responsible for inspecting the site and physically observing all the site conditions prior to entering into Agreements or Contract with Owner. Landscape Contractor shall coordinate his work with the General Contractor of Construction Manager in such a manner as to allow for a speedy and orderly completion of all work on the site.
 - Any excess soil, landscape materials and debris from the landscape Contractor's work shall be removed from the site immediately upon completion of his work.
 - Landscape Contractor shall coordinate the proposed planting in the Planting Plan with the work required in relocating and removal of trees in sheet L-1 (Existing trees).
 - One year warranty

- TREES & PLANTING TO BE PRESERVED NOTES**
- TREE AND PALM TRANSPLANTING NOTES:**
- Certified arborist is to be hired to supervise and direct all phases of transplanting trees and palms.
 - Trees to be relocated shall be root pruned a minimum of eight weeks prior to transplanting. Landscape Contractor shall maintain transplanted materials during construction period by watering, moving, spraying, fertilizing, and pruning.
 - Landscape Contractor is responsible for verifying locations of all underground and overhead utilities and easements prior to commencing work. All utility companies and/or the General Contractor shall be notified to verify locations prior to digging. Utility trenching is to be coordinated with the Landscape prior to beginning of project. The Owner and Landscape Architect shall not be responsible for damage to utility or irrigation lines.
 - The Landscape Contractor shall comply with all local and state codes and shall be responsible for obtaining all applicable permits.
 - The Landscape Contractor shall regularly inspect the relocated materials to ensure compliance with standard horticultural practices.
 - The Landscape Contractor is responsible for guaranteeing the transplanted trees and palms for a period of one year. At the time of the final inspection of transplanted trees and palms that are not in healthy growing condition shall be replaced by the Landscape Contractor.
 - Root Pruning and Transplanting Operations: The Landscape Contractor shall take all precautions to minimize shock of root pruning and transplanting in accordance with standard arboriculture procedures including:
 - The diameter of the root-pruning or transplanting circle shall be at a distance away from the trunk equal to 12 times each inch of trunk diameter at breast height.
 - All small roots shall be cleanly cut with a sharp spade, a clean saw or chainsaw depending on the size of the root.
 - Trees shall not be pruned at transplanting to compensate for root loss. Any trimming required shall be as per the International Society of Arboriculture Trimming Standards.
 - For all palms except Sabal palmetto, the lower fronds shall be pruned leaving 9-11 fronds that can be tied without an extensive amount of weight that may damage the heart of the palm. The Sabal palmetto shall have all fronds cut without damaging the bud.
 - After root pruning trees, backfill roots to original existing grade with existing soil free of any deleterious material to root growth.
 - Provide a minimum of 3" mulch over backfill area to prevent weed growth, conserve moisture and prevent evaporation. Keep mulch 6" away from the trunk.
 - Provide tree protection as per Tree Protection Detail to ensure that the tree or root system is not damaged during the root pruning period.
 - After root pruning, during root regeneration period trees shall be watered as per standard horticultural practices.
 - The root ball shall be wrapped with burlap to protect the soil around the roots and protect the roots from drying out at time of moving from the hole.
 - Finish cutting of root ball for transplanting.
 - Transporting must occur within 24 hours after being dug for relocation. Trees/Palms should be kept in shade and the canopy kept moist.
 - Digging and preparation of the new hole for the transplant shall be done prior to removing the tree from the existing location.
 - The depth of the new hole shall be minimum equal to the depth of the root ball and the width shall be minimum equal to three times the width of the root ball. The Landscape Contractor is to verify that all new holes have appropriate percolation. Landscape Contractor is to report to the Landscape Architect if water percolation does not meet requirements for healthy plant growth.
 - Trees and palms shall be lifted from the ground with heavy equipment designed specifically for tree relocation so that the trunk and crown is not impacted and damaged by the equipment.
 - The slings used to lift the trees and heavy weight palms shall be non-binding nylon type slings that are wrapped around the root ball to support the weight of tree or heavy palm. Slings shall not be solely wrapped around the trunk of the tree that can cause damage, girdling and result in decline and death of the tree.
 - The slings used to lift the lighter weight palms shall be non-binding nylon type slings that are wrapped around the trunk to support the weight of the palm. Padding the sling may be necessary so that the trunk or "backs" are not damaged.
 - Tree should be planted 2" max higher than their original planting level prior to relocation. Palms shall be planted at the same elevation prior to relocation. The tree and palm shall be centrally positioned in the planting hole and set straight, plumb or normal to the growth pattern prior to transplanting.
 - The trees and palms shall be backfilled with existing soil free of deleterious material to plant growth.
 - Trees and palms shall be deep root watered to eliminate air pockets in the backfill mix prior to mulching.
 - A 6" saucer shall be created around the edge of the plant pit to help hold water, see planting detail for additional information.
 - Provide a minimum of 3" layer of mulch over saucer and backfill area outside saucer to prevent the weed growth, conserve moisture, and prevent evaporation. Keep mulch 6" away from the trunk.
 - Initial tree and palm bracing as per attached details, to ensure stability of tree and palm during time period to and after transplanting, stake trees and palms after transplanting only is required to keep them stable.
 - Over the guarantee period the Landscape Contractor is responsible for resetting any trees/palms that are not vertical when caused by winds less than 75 MPH.
 - After transplanting trees and palms, the Landscape Contractor shall be responsible for obtaining water and watering to maintain soil moisture during the guarantee period of a minimum of:
 - First month - Daily; Second month - 3 times per week; Third and Fourth month - 2 times per week; Last Eight months - 1 time per week. For trees over 4" in caliper at the time of planting, the schedule should be: First 6 weeks - Daily; from 1.5 months to 6 months 3 times per week; last 6 months - 1 time per week.

PARAMETRIKA LAND & DESIGN
Gabriela Albomoz
Theresa Wymer LA6667363



MARSEILLE LOT 11
Miami Beach, FL 33141

SHEET TITLE
Landscape details and notes

ISSUE DATE
03/30/2024

REVISION
March, 2024

DESIGN
GA

DRAWN
TY

SCALE
N/A

SEAL
THERESA WYMER
LA6667363

SHEET NUMBER
L-103



Caryota mitis



Cocos nucifera

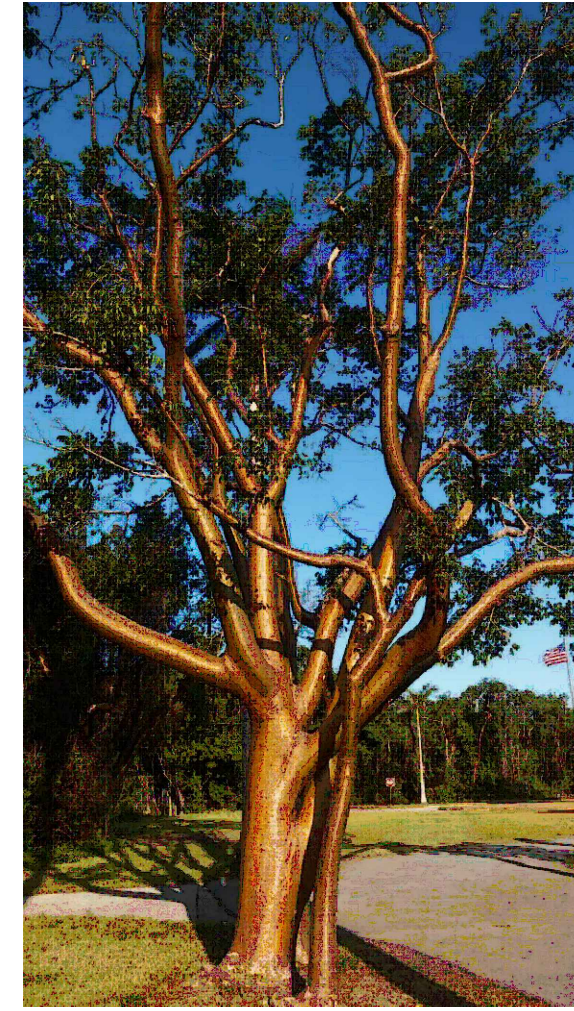

Bursera simaruba



Sabal Palmetto



Eugenia confusa



Myrcianthes fragrans



Hamelia patens

PARAMETRIKA LAND & DESIGN
Gabriela Albomoz
Theresa Wymer LA6667363



MARSEILLE LOT 11
Miami Beach, FL 33141

N/A

SHEET TITLE
Plant material

ISSUE DATE
02/18/2024

REVISION
FEBRUARY, 2024

DESIGN
GA

DRAWN
TY

SCALE
N/A

SEAL

THERESA WYMER
LA6667363

SHEET NUMBER
L-104