

CITY OF MIAMI BEACH ZONING ATLAS

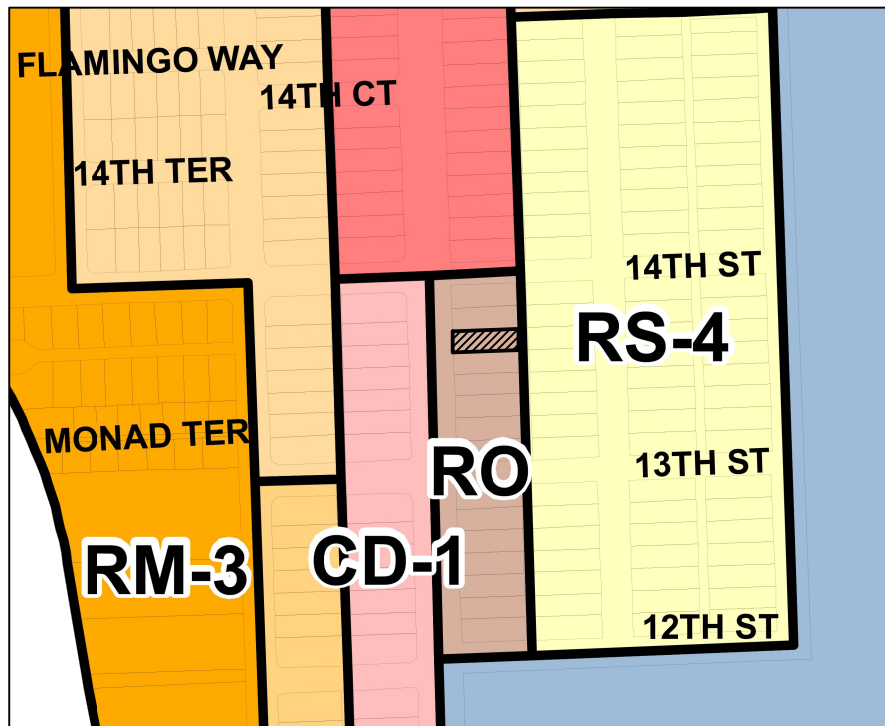

**LEGAL DESCRIPTION:**

Lot 14, Block 108, OCEAN BEACH ADDITION NO. 3, according to the Plat thereof, as recorded in Plat Book 2, at Page 81 of the Public Records of Miami-Dade County, Florida.

**ADDRESS:** 1343 Alton Road, Miami Beach, FL 33139

**FOLIO:** 02-4203-009-8920

**PREPARED FOR:** LITTLE BEACH HOUSE MONTESSORI SCHOOL

**ORDER:** 240718

**DATE:** August 5, 2024

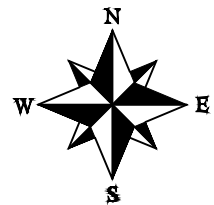

SCALE: 1"= 125'

**375-FOOT RADIUS MAP:**

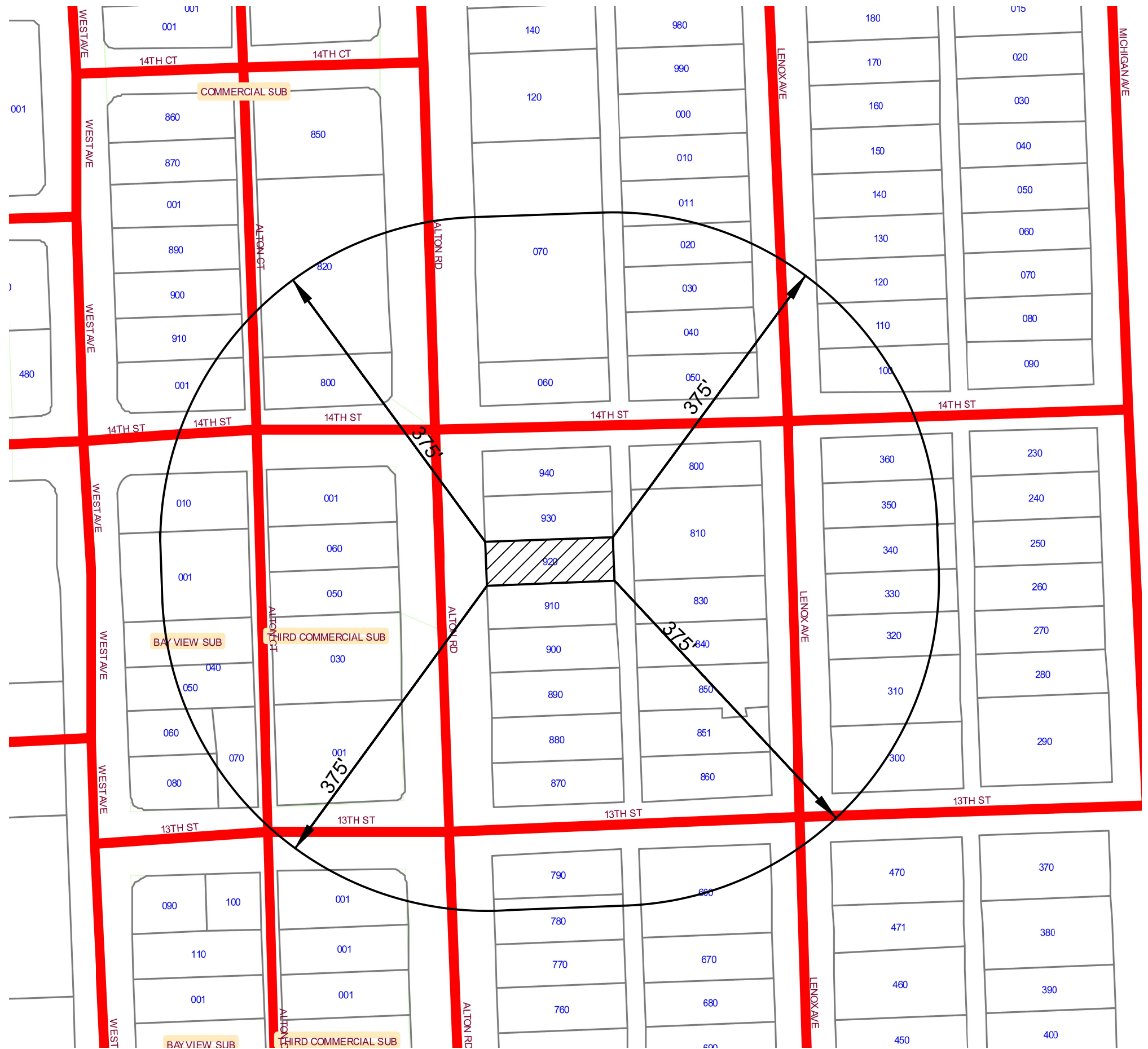

**The Zoning Specialists Group, Inc.**

7729 NW 146th Street  
Miami Lakes FL 33016

Ph: (305) 828-1210

[www.thezoningspecialistsgroup.com](http://www.thezoningspecialistsgroup.com)