

1 LARGE TREE PLANTING DETAIL
3/16" = 1'-0"
CD-PL-01

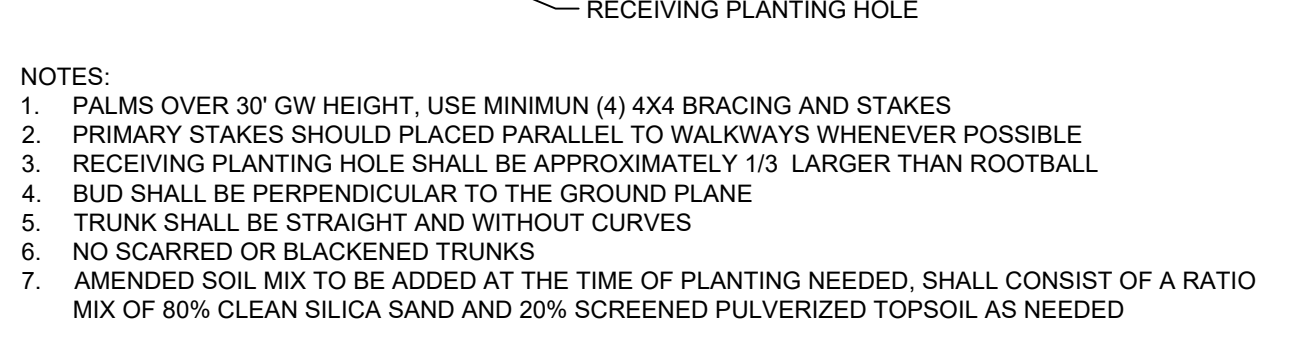

2 PALM PLANTING DETAIL
3/16" = 1'-0"
CD-PL-05

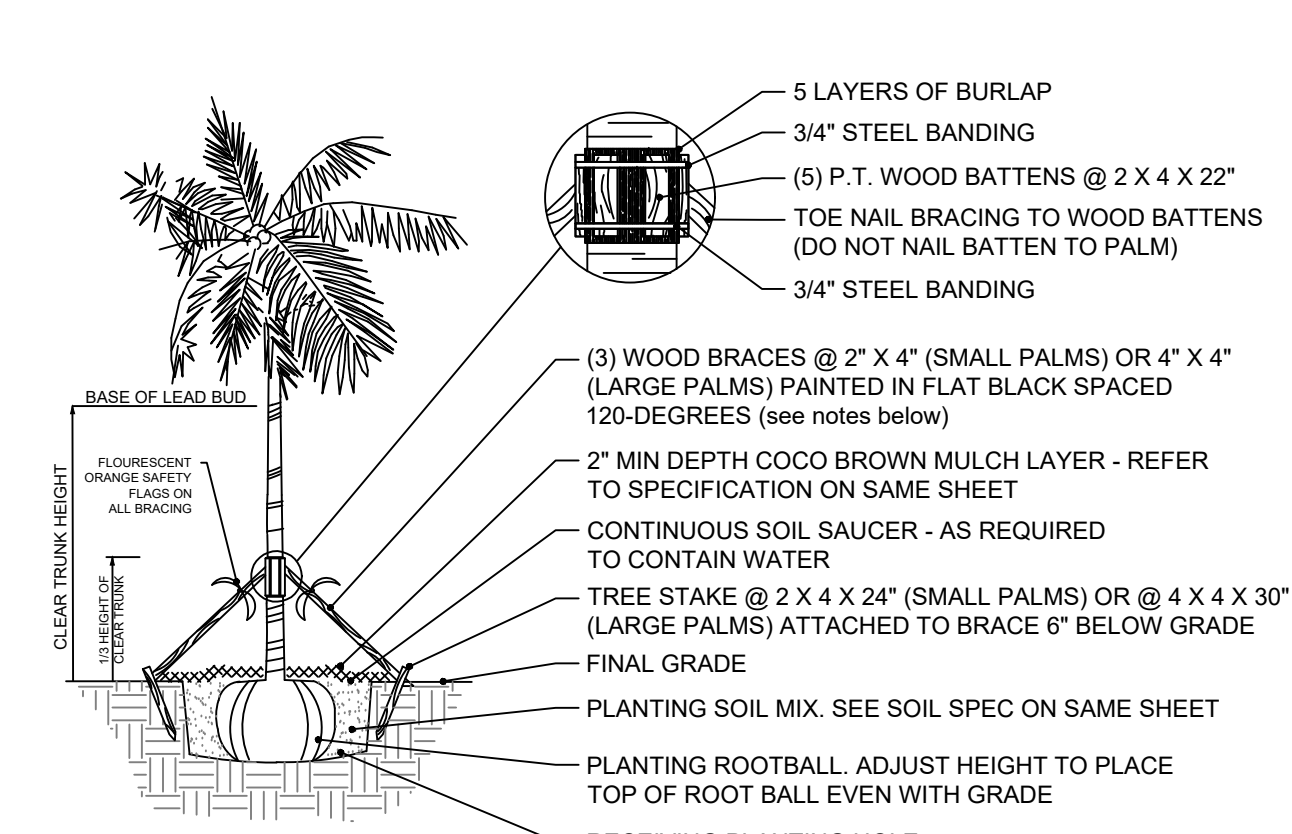
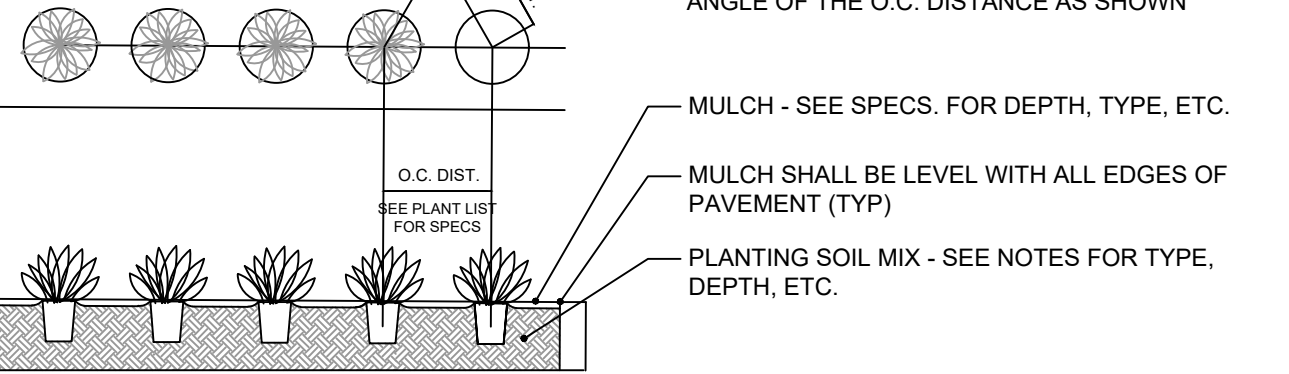

3 GROUNDCOVER PLANTING DETAIL
3/8" = 1'-0"
CD-PL-08

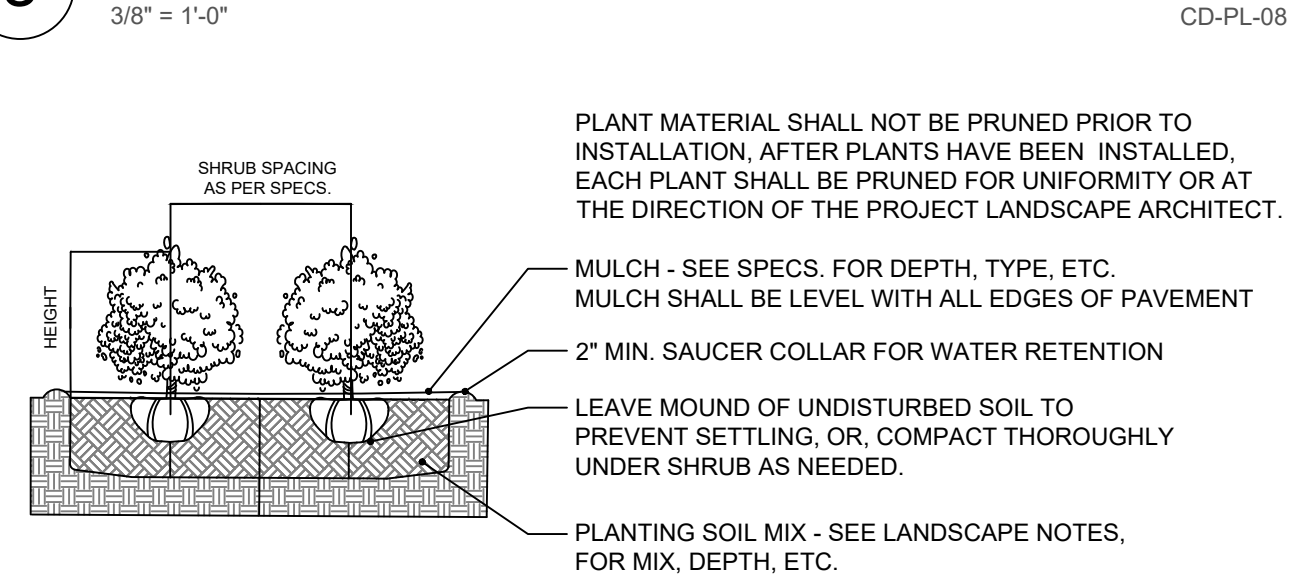

4 SHRUB PLANTING DETAIL
3/8" = 1'-0"
CD-PL-07

CITY OF MIAMI BEACH
LANDSCAPE LEGEND
INFORMATION REQUIRED TO BE PERMANENTLY AFFIXED TO PLANS

Zoning District RM-1 Lot Area 22,646 SF Acres .51 SF

	REQUIRED/ ALLOWED	PROVIDED
OPEN SPACE		
A. Square feet of required Open Space as indicated on site plan: Lot Area = 22,646 SF, s.f. x .30 % = 6,793 s.f.	6,739	6,739
B. Square feet of parking lot open space required as indicated on site plan: Number of parking spaces <u>22</u> x 10 s.f. parking space =	220	220
C. Total square feet of landscaped open space required: A+B=	6,959	6,959
LAWN AREA CALCULATION		
A. Square feet of landscaped open space required		
B. Maximum lawn area (sod) permitted = <u>50</u> % x 6,739 s.f.	3,369	1,100
TREES		
A. Number of trees required per lot or net lot acre, less existing number of trees meeting minimum requirements = <u>28</u> trees x <u>.51</u> net lot acres - number of existing trees =	15	40
B. % Natives required: Number of trees provided x 30% =	5	40
C. % Low maintenance / drought and salt tolerant required: Number of trees provided x 50% =	8	12
D. Street Trees (maximum average spacing of 20' o.c.) <u>300</u> linear feet along street divided by 20' =	15	15
E. Street tree species allowed directly beneath power lines: (maximum average spacing of 20' o.c.): _____ linear feet along street divided by 20' =	N/A	N/A
SHRUBS		
A. Number of shrubs required: Sum of lot and street trees required x 12 =	360	360
B. % Native shrubs required: Number of shrubs provided x 50% =	180	180
LARGE SHRUBS OR SMALL TREES		
A. Number of large shrubs or small trees required: Number of required shrubs x 10% =	36	36
B. % Native large shrubs or small trees required: Number of large shrubs or small trees provided x 50% =	18	18

PLANT SCHEDULE LANDSCAPE

SYMBOL	CODE	QTY	COMMON NAME	BOTANICAL NAME	NATIVE	SPECIFICATIONS
TREES						
	BA	4	VERAWOOD	BULNESIA ARBOREA	NO	200 GAL, 18" HT, 8" SP, 5" DBH, STANDARD
	BS	3	GUMBO LIMBO	BURSERIA SIMARUBA	YES	22-24" HT, 12" SP, 12" DBH, STANDARD
	CG	2	BRIDAL VEIL	CAESALPINIA GRANADILLO	NO	300 GAL, 18-20" HT, 10-12" SP, 6" DBH, STANDARD
	EF	26	SPANISH STOPPER	EUGENIA FOETIDA	YES	20' HT, 8" SP, 5" DBH, 3" CT, STANDARD
	MF	2	SIMPSON'S STOPPER	MYRCIANTHES FRAGRANS	YES	14' HT, 10" SP, 4" DBH, MULTI-TRUNK, EQUAL TO TREEWORLD
	PR	18	BAY RUM	PIMENTA RACEMOSA	NO	20' HT, 8-10' SP, 6" DBH, 3-4" CT, STANDARD
PALMS						
	DC	3	CABADA PALM	DYPISIA CABADAE	NO	16-18" HT, FULL TO BASE, FLORIDA FANCY
	RX	44	LADY PALM	RHAPIS EXCELSA	NO	15 GAL, 4' HT, 4' SP, FLORIDA FANCY, FULL
	SP	27	CABBAGE PALM	SABAL PALMETTO	YES	20-24" CT, STAGGERED HEIGHTS TO SCREEN, CHARACTER LEANING, SLICK, FLORIDA FANCY
	TR	10	THATCH PALM	THRINAX RADIATA	YES	6-8' HT, 3-4" CT, SINGLE, VARYING HEIGHTS, FLORIDA FANCY
SHRUB AREAS						
	CAW	113	WILD CINNAMON	CANELLA WINTERANA	YES	25 GAL, 5' HT, 2' SP, FULL, GRADE #1
	CLG	65	SMALL LEAF CLUSIA	CLUSIA GUTTIFERA	NO	15 GAL, 5' HT, 3" SP, FULL, 30" O.C.
	EUF	65	SPANISH STOPPER SHRUB	EUGENIA FOETIDA	YES	25 GAL, 5' HT MIN, 2-3" SP MIN, FULL, GRADE #1
GROUND COVERS						
	ARG	899	PERENNIAL PEANUT	ARACHIS GLABRATA	YES	1 GAL, 12" O.C., FULL
	CAM	622	DWARF CARISSA	CARISSA MACROCARPA 'EMERALD BLANKET'	NO	3 GAL, 12" O.C., FULL
	LIR	622	LILYTURF 'BIG BLUE'	LIRIOPE MUSCARI 'BIG BLUE'	NO	1 GAL, 12" O.C., FULL
	MIC	622	WART FERN	MICROSORUM SCOLOPENDRIA	NO	3 GAL, 12" O.C., FULL
	MOD2	152	SWISS CHEESE PLANT	MONSTERA DELICIOSA	NO	7 GAL, 18" O.C., FULL
	XAN	152	XANADU	PHILODENDRON 'XANADU'	NO	3 GAL, 18" O.C., FULL
	PBM	273	BURLE MARX	PHILODENDRON X 'BURLE MARX'	NO	3 GAL, 18" O.C., FULL
	MIN	617	JASMINE MINIMA	TRACHELOSPERMUM ASIATICUM 'MINIMA'	NO	1 GAL, 12" O.C., FULL
	TRF	152	FAKAHATCHEE GRASS	TRIPSACUM FLORIDANUM	YES	3 GAL, 12" O.C., FULL
	ZAP	617	COONTIE	ZAMIA PUMILA	YES	1 GAL, 12" HT, 12" O.C.
	SOD	2,474 SF	EMPIRE ZOYSIA	ZOYSIA X 'EMPIRE'	NO	OVER 2" TOPSOIL BED, SEE PLANTING SPECS

LANDSCAPE NOTES

- ALL PLANT MATERIAL SHALL BE FLORIDA GRADE NO. 1 OR BETTER.
- CONTRACTOR SHALL BECOME FAMILIAR WITH THE LOCATION OF, AVOID, AND PROTECT ALL UTILITY LINES, BURIED CABLES, AND OTHER UTILITIES.
- TREE, PALM, ACCENT AND BED LINES ARE TO BE LOCATED IN THE FIELD AND APPROVED BY THE LANDSCAPE ARCHITECT PRIOR TO INSTALLATION.
- ALL PLANTING SOIL SHALL BE 50-50 TOPSOIL: SAND MIX, FREE OF CLAY, STONES, ROCKS, OR OTHER FOREIGN MATTER. THIS SPECIFICATION INCLUDES ALL BACKFILL FOR BERMS AND OTHER LANDSCAPE AREAS.
- THE SITE CONTRACTOR SHALL BE RESPONSIBLE TO BRING ALL GRADES TO WITHIN 2" OF FINAL GRADES. THIS SHALL INCLUDE A 2" APPLICATION OF 50-50 TOPSOIL: SAND MIX FOR ALL LANDSCAPE AND AREAS TO BE SODDED.
- ALL PLANTING BEDS SHALL BE MULCHED TO A DEPTH OF 2" w/ APPROVED NATURAL SHREDDED COCO BROWN MULCH FREE FROM WEEDS AND PESTS. NO 'NUGGETS', 'CYPRESS MULCH' OR 'RED DYED MULCH' TO BE ACCEPTED. KEEP MULCH 6" AWAY FROM TREE OR PALM TRUNKS AS PER INDUSTRY RECOMMENDATIONS.
- SOD SHALL BE 'EMPIRE TURF' ZOYSIA GRASS IN ALL LAWN AREAS AS SHOWN ON THE PLANS. SOD SHALL BE STRONGLY ROOTED, FREE FROM WEED, FUNGUS, INSECTS AND DISEASE. CONTRACTOR SHALL SOD ALL AREAS AS INDICATED ON THE PLANS OR AS DIRECTED. PAYMENT SHALL BE DETERMINED BY THE TOTAL MEASURED SODDED AREAS X THE UNIT PRICE SUBMITTED AND FIELD VERIFIED. SOD SHALL CARRY A 5-MONTH WARRANTY.
- ALL TREES, PALMS, SHRUBS AND GROUNDCOVERS, AND SOD / LAWN SHALL CARRY A ONE-YEAR WARRANTY FROM THE DATE OF FINAL ACCEPTANCE.
- IRRIGATION SHALL PROVIDE FOR A 100% COVERAGE WITH 50% OVERLAP MINIMUM AND BE PROVIDED BY A FULLY AUTOMATIC IRRIGATION SYSTEM W/ RAIN MOISTURE SENSOR ATTACHED TO CONTROLLER. ALL FLORIDA BUILDING CODE APPENDIX "F" IRRIGATION REQUIREMENTS SHALL BE STRICTLY ADHERED TO FOR INSTALLATION AND PREVAILING WATER MANAGEMENT DISTRICT RESTRICTIONS AND REGULATIONS SHALL BE IN COMPLIANCE FOR POST-INSTALLATION WATERING SCHEDULES.

Rev.	Date	Rev.	Date
1		1	
2		2	
3		3	
4		4	
5		5	
6		6	
7		7	
8		8	
9		9	
10		10	
11		11	
12		12	
13		13	
14		14	
15		15	
16		16	
17		17	
18		18	
19		19	
20		20	
21		21	
22		22	
23		23	
24		24	

ALL DRAWINGS AND WRITTEN MATERIAL APPEARING HEREIN CONSTITUTE THE ORIGINAL AND UNPUBLISHED WORK OF KOBİ KARP ARCHITECTURE, INC. AND MAY NOT BE REPRODUCED, COPIED, OR TRANSMITTED IN ANY FORM OR BY ANY MEANS, WITHOUT THE WRITTEN CONSENT OF KOBİ KARP ARCHITECTURE, INC. © 2024 KOBİ KARP ARCHITECTURE, INC. ALL RIGHTS RESERVED.

ZONING PHASE

1709 JEFFERSON AVE
MIAMI BEACH, FL 33139



CHRISTOPHER CAWLEY, P.L.A.
P.O. BOX 10000, MIAMI BEACH, FL 33152

Owner:
Name: --
Address: --
Address: --
Tel: --
Email: --

Consultant:
Name: --
Address: --
Address: --
Tel: --
Email: --

Consultant:
Name: --
Address: --
Address: --
Tel: --
Email: --

Consultant:
Name: --
Address: --
Address: --
Tel: --
Email: --

Consultant:
Name: --
Address: --
Address: --
Tel: --
Email: --

Consultant:
Name: --
Address: --
Address: --
Tel: --
Email: --

Architect:
Kobi Karp Architecture and Interior Design, Inc.
371 NW 29th STREET
Miami, Florida 33137 USA
Tel: +1(305) 573 1818
Fax: +1(305) 573 3766



KOBİ KARP
Lic. # AR0012578

PLANT LIST, LANDSCAPE CODE, DETAILS + NOTES

Date:	01.14.24	Sheet No.	
Scale:			L2.00
Project:			

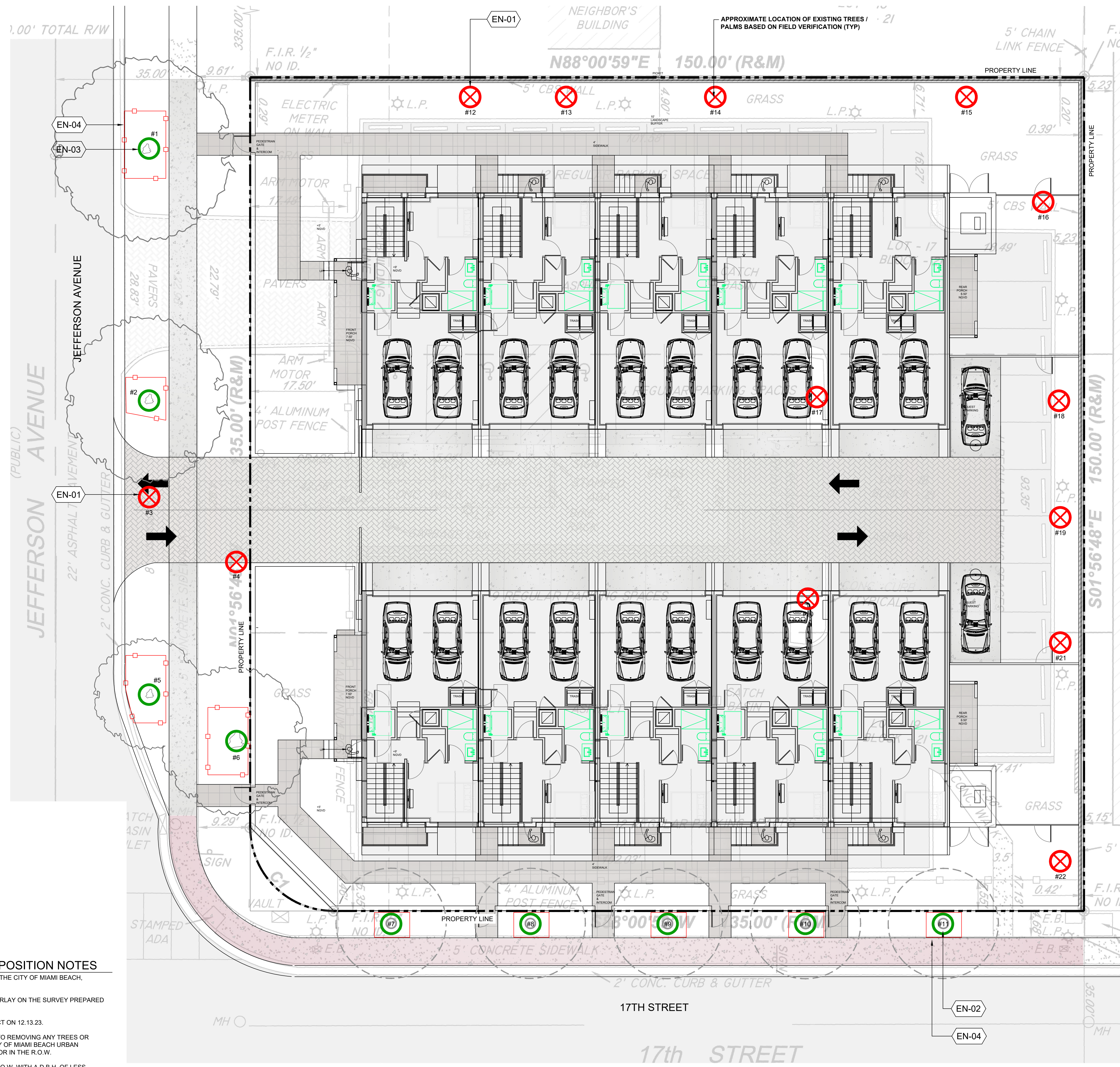

EXISTING TREE SURVEY LEGEND

- TREE or PALM TO BE REMOVED. SEE CHART L3.01
- TREE or PALM TO REMAIN. PRESERVE + PROTECT
- TREE or PALM PROTECTION FENCE

EXISTING NOTE SCHEDULE

- | SYMBOL | DESCRIPTION |
|--------|---|
| EN-01 | TREE / PALM TO BE REMOVED (TYP). SEE DISPOSITION CHART ON SHEET L3.01 FOR MORE INFORMATION. |
| EN-02 | EXISTING ROYAL PALMS #7 - #11 IN R.O.W. TO REMAIN. SEE DISPOSITION CHART ON SHEET L3.01 FOR MORE INFORMATION. |
| EN-03 | EXISTING WILD TAMARIND TREES #1 + 3 AND TABEBUIA TREE #5 IN R.O.W. TO REMAIN. |
| EN-04 | EXISTING TREE PROTECTION BARRIER (TYP). LOCATION SHOWN SCHEMATICALLY, FIELD ADJUST AS NECESSARY. |

C.M.B. CHAPTER 46, DIVISION 2 - TREE INVENTORY + DISPOSITION NOTES

- THIS 'EXISTING TREE INVENTORY + DISPOSITION PLAN' HAS BEEN PREPARED IN ACCORDANCE WITH THE CITY OF MIAMI BEACH, CHAPTER 46 - ENVIRONMENT, DIVISION 2, TREE PRESERVATION + PROTECTION ORDINANCE.
- EXISTING TREE, PALM, + VEGETATION INFORMATION AS INDICATED HAS BEEN PREPARED AS AN OVERLAY ON THE SURVEY PREPARED BY LANNES AND GARCIA, INC. DATED 10.09.23
- THE INFORMATION AS PRESENTED HEREIN HAS BEEN FIELD VERIFIED BY THE LANDSCAPE ARCHITECT ON 12.13.23.
- MIAMI BEACH P+Z AND URBAN FORESTRY DEPARTMENT MUST APPROVE LANDSCAPE PLANS PRIOR TO REMOVING ANY TREES OR PALMS WITH A D.B.H. GREATER THAN 2". A WRITTEN TREE REMOVAL PERMIT IS REQUIRED FROM CITY OF MIAMI BEACH URBAN FORESTRY / PUBLIC WORKS FOR THE REMOVAL OF TREES / PALMS WITH A D.B.H. GREATER THAN 2" OR IN THE R.O.W.
- THE OWNER RESERVES THE RIGHT TO REMOVE ANY VEGETATION NOT LOCATED WITHIN THE CITY R.O.W. WITH A D.B.H. OF LESS THAN 2" WITHOUT OBTAINING A TREE REMOVAL PERMIT.
- THERE ARE NO TREES OR PALMS LOCATED ON THIS PROPERTY THAT WILL REQUIRE TEMPORARY IRRIGATION. ALL EXISTING TREES + PALMS ARE MATURE AND ARE CURRENTLY THRIVING WITHOUT SUPPLEMENTAL IRRIGATION WATER.

Rev.	Date	Rev.	Date
1		1	
2		2	
3		3	
4		4	
5		5	
6		6	
7		7	
8		8	
9		9	
10		10	
11		11	
12		12	
13		13	
14		14	
15		15	
16		16	
17		17	
18		18	
19		19	
20		20	
21		21	
22		22	
23		23	
24		24	

ZONING PHASE

1709 JEFFERSON AVE
MIAMI BEACH, FL 33139

**CHRISTOPHER
CAWLEY
LANDSCAPE
ARCHITECTURE**

CHRISTOPHER CAWLEY, RLA
FRENCH LANTIER, LA BREVETEE

Owner:	Name	-
	Address	-
	Address	-
	Tel:	-
	Email:	-
Consultant:	Name	-
	Address	-
	Address	-
	Tel:	-
	Email:	-
Consultant:	Name	-
	Address	-
	Address	-
	Tel:	-
	Email:	-
Consultant:	Name	-
	Address	-
	Address	-
	Tel:	-
	Email:	-
Consultant:	Name	-
	Address	-
	Address	-
	Tel:	-
	Email:	-

Architect:
Kobi Karp Architecture and Interior Design, Inc.
371 NW 25th STREET
Miami, Florida 33137 USA
Tel: +1(305) 573 1818
Fax: +1(305) 573 3766

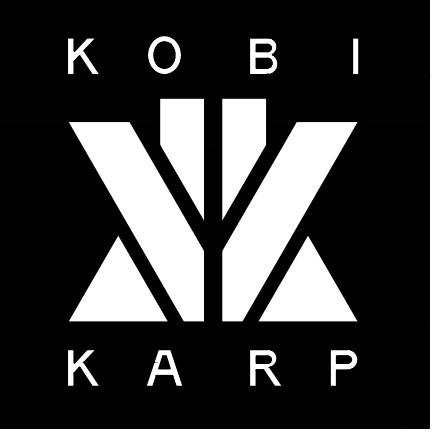

KOBI KARP
Lic. # AR0012578

EXISTING TREE SURVEY + DISPOSITION PLAN

1/8" = 1'-0"
0 5 10 24'

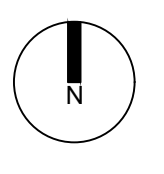

Date:	01.14.24	Sheet No.	L3.00
Scale:			
Project:			

TREE + PALM PROTECTION FENCES SHALL BE CONSTRUCTED PRIOR TO ANY CONSTRUCTION ACTIVITY INCLUDING GRUBBING FOR ALL TREES OR PALMS THAT ARE TO REMAIN, BE PROTECTED, OR BE RELOCATED ON-SITE. TPF SHALL BE MAINTAINED AND SHALL REMAIN UNTIL WRITTEN APPROVAL HAS BEEN RECEIVED FROM CITY URBAN FORESTER AFTER ALL SITE WORK HAS BEEN COMPLETED.

NO ACTIVITY OR DISTURBANCE SHOULD OCCUR WITHIN THE FENCED AREAS, INCLUDING VEHICLE USE, STORAGE OF MATERIALS, DUMPING OF LIQUIDS OR MATERIALS, GRADE CHANGES, GRUBBING, AND MECHANICAL TRENCHING FOR IRRIGATION, ELECTRICAL, LIGHTING, ETC. WITHOUT URBAN FORESTER APPROVAL.

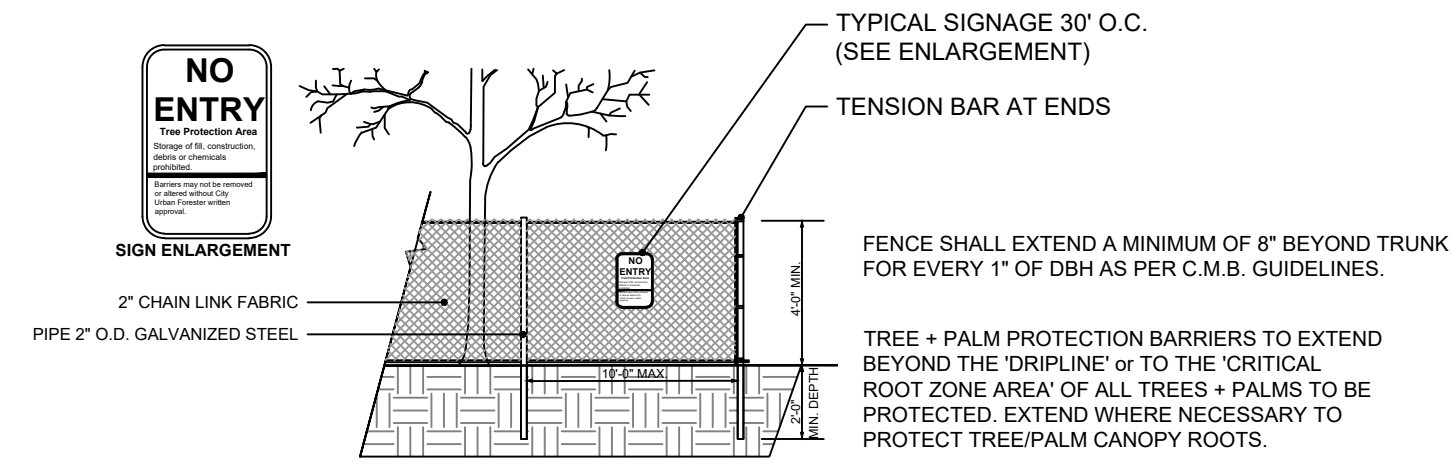

1 TREE + PALM PROTECTION DETAIL (CHAINLINK FENCE)
3/16" = 1'-0" CD-PL-06

EXISTING TREE INVENTORY + DISPOSITION CHART

NUMBER	COMMON NAME	BOTANICAL NAME	SPECIMEN	D.B.H. (IN)	HEIGHT (FT)	SPREAD (FT)	CONDITION	DISPOSITION	MITIGATION	COMMENTS
1	WILD TAMARIND	Lysiloma latisiliquum	YES	20	32	33	FAIR	REMAIN	N/A	PRESERVE + PROTECT DURING CONSTRUCTION
2	WILD TAMARIND	Lysiloma latisiliquum	YES	20	30	30	FAIR	REMAIN	N/A	PRESERVE + PROTECT DURING CONSTRUCTION
3	WILD TAMARIND	Lysiloma latisiliquum	NO	11	28	20	FAIR	REMOVE	11" DBH	IN CONFLICT WITH SITE DESIGN, MITIGATION PROVIDED.
4	YELLOW TRUMPET TREE	Tabebuia caraiba	YES	16	31	28	FAIR	REMOVE	16" DBH	IN CONFLICT WITH SITE DESIGN, MITIGATION PROVIDED.
5	YELLOW TRUMPET TREE	Tabebuia caraiba	YES	19	31	20	FAIR	REMAIN	N/A	PRESERVE + PROTECT DURING CONSTRUCTION
6	LIVE OAK	Quercus virginiana	YES	17	31	30	FAIR	REMAIN	N/A	PRESERVE + PROTECT DURING CONSTRUCTION
7	ROYAL PALM	Roystonea Regia	YES	17	45	16	FAIR	REMAIN	N/A	PRESERVE + PROTECT DURING CONSTRUCTION
8	ROYAL PALM	Roystonea Regia	YES	17	45	16	FAIR	REMAIN	N/A	PRESERVE + PROTECT DURING CONSTRUCTION
9	ROYAL PALM	Roystonea Regia	YES	17	45	16	FAIR	REMAIN	N/A	PRESERVE + PROTECT DURING CONSTRUCTION
10	ROYAL PALM	Roystonea Regia	YES	17	45	16	FAIR	REMAIN	N/A	PRESERVE + PROTECT DURING CONSTRUCTION
11	ROYAL PALM	Roystonea Regia	YES	17	45	16	FAIR	REMAIN	N/A	PRESERVE + PROTECT DURING CONSTRUCTION
12	GUMBO LIMBO	Bursera simaruba	YES	28	28	28	FAIR	REMOVE	28" DBH	IN CONFLICT WITH SITE DESIGN, MITIGATION PROVIDED.
13	GUMBO LIMBO	Bursera simaruba	YES	14	23	15	FAIR	REMOVE	14" DBH	IN CONFLICT WITH SITE DESIGN, MITIGATION PROVIDED.
14	GUMBO LIMBO	Bursera simaruba	YES	13	23	15	FAIR	REMOVE	13" DBH	IN CONFLICT WITH SITE DESIGN, MITIGATION PROVIDED.
15	BLACK OLIVE	Bucida buceras	YES	17	38	35	FAIR	REMOVE	17" DBH	IN CONFLICT WITH SITE DESIGN, MITIGATION PROVIDED.
16	BLACK OLIVE	Bucida buceras	YES	15	38	38	FAIR	REMOVE	15" DBH	IN CONFLICT WITH SITE DESIGN, MITIGATION PROVIDED.
17	GUMBO LIMBO	Bursera simaruba	YES	13	18	15	FAIR	REMOVE	13" DBH	IN CONFLICT WITH SITE DESIGN, MITIGATION PROVIDED.
18	GUMBO LIMBO	Bursera simaruba	YES	21	30	14	FAIR	REMOVE	21" DBH	IN CONFLICT WITH SITE DESIGN, MITIGATION PROVIDED.
19	GUMBO LIMBO	Bursera simaruba	YES	17	34	21	FAIR	REMOVE	17" DBH	IN CONFLICT WITH SITE DESIGN, MITIGATION PROVIDED.
20	GUMBO LIMBO	Bursera simaruba	YES	12	18	15	FAIR	REMOVE	12" DBH	IN CONFLICT WITH SITE DESIGN, MITIGATION PROVIDED.
21	GUMBO LIMBO	Bursera simaruba	YES	26	34	21	FAIR	REMOVE	26" DBH	IN CONFLICT WITH SITE DESIGN, MITIGATION PROVIDED.
22	BLACK OLIVE	Bucida buceras	YES	18	38	33	FAIR	REMOVE	18" DBH	IN CONFLICT WITH SITE DESIGN, MITIGATION PROVIDED.

TOTAL TREE DBH LOSS: 221"
TREE MITIGATION REQUIRED: (74) REPLACEMENT TREES @ 12' HT x 2" D.B.H. x 6' SP

TREE + PALM MITIGATION SUMMARY

REMOVED (TOTAL DBH OF TREES)	REPLACEMENT TREES REQ.	REPLACEMENT TREES PROVIDED
221" OF DBH	74 @ 12' HT + 2" DBH + 6' SP OR 37 @ 16' HT + 4" DBH + 8' SP	97 REPLACEMENT TREES PROVIDED @ 12' HT + 2" DBH + 6' SP BREAKDOWN: (26) NATIVE SPANISH STOPPER TREES @ 20' HT + 5" DBH + 8' SP = 52 REPLACEMENT TREES (3) NATIVE GUMBO LIMBO TREES @ 22' HT + 12" DBH + 12' SP = 9 REPLACEMENT TREES (16) BAY RUM TREES @ 20' HT + 6" DBH + 8' SP = 36 REPLACEMENT TREES

TREE DISPOSITION SUMMARY

	TOTAL	REMAIN	REMOVE	RELOCATE
TREES	17	4	13	0
PALMS	5	5	0	0

Rev.	Date	Rev.	Date
1		1	
2		2	
3		3	
4		4	
5		5	
6		6	
7		7	
8		8	
9		9	
10		10	
11		11	
12		12	
13		13	
14		14	
15		15	
16		16	
17		17	
18		18	
19		19	
20		20	
21		21	
22		22	
23		23	
24		24	
25		25	

ALL DRAWINGS AND WRITTEN MATERIAL APPEARING HEREIN CONSTITUTE THE ORIGINAL AND UNPUBLISHED WORK OF KOBİ KARP ARCHITECTURE, INC. AND MAY NOT BE REPRODUCED, COPIED, OR TRANSMITTED IN ANY FORM OR BY ANY MEANS, ELECTRONIC OR MECHANICAL, WITHOUT THE EXPRESS WRITTEN CONSENT OF KOBİ KARP ARCHITECTURE, INC. © 2018 KOBİ KARP ARCHITECTURE, INC. ALL RIGHTS RESERVED.

ZONING PHASE

1709 JEFFERSON AVE
MIAMI BEACH, FL 33139

CHRISTOPHER
CRAWLEY
LANDSCAPE
ARCHITECTURE

CHRISTOPHER CRAWLEY, RLA
Florida License LA 98827876

Owner:
Name --
Address --
Address --
Tel: --
Email --

Consultant:
Name --
Address --
Address --
Tel: --
Email --

Consultant:
Name --
Address --
Address --
Tel: --
Email --

Consultant:
Name --
Address --
Address --
Tel: --
Email --

Consultant:
Name --
Address --
Address --
Tel: --
Email --

Consultant:
Name --
Address --
Address --
Tel: --
Email --

Consultant:
Name --
Address --
Address --
Tel: --
Email --

Architect:
Kobi Karp Architecture and Interior Design, Inc.
371 NW 25th STREET
Miami, Florida 33137 USA
Tel: +1(305) 573 1818
Fax: +1(305) 573 3766



KOBİ KARP
Lic. # AR0012578

PLANT MATERIALS | TREES + PALMS



BS | GUMBO LIMBO TREE
Bursera simaruba

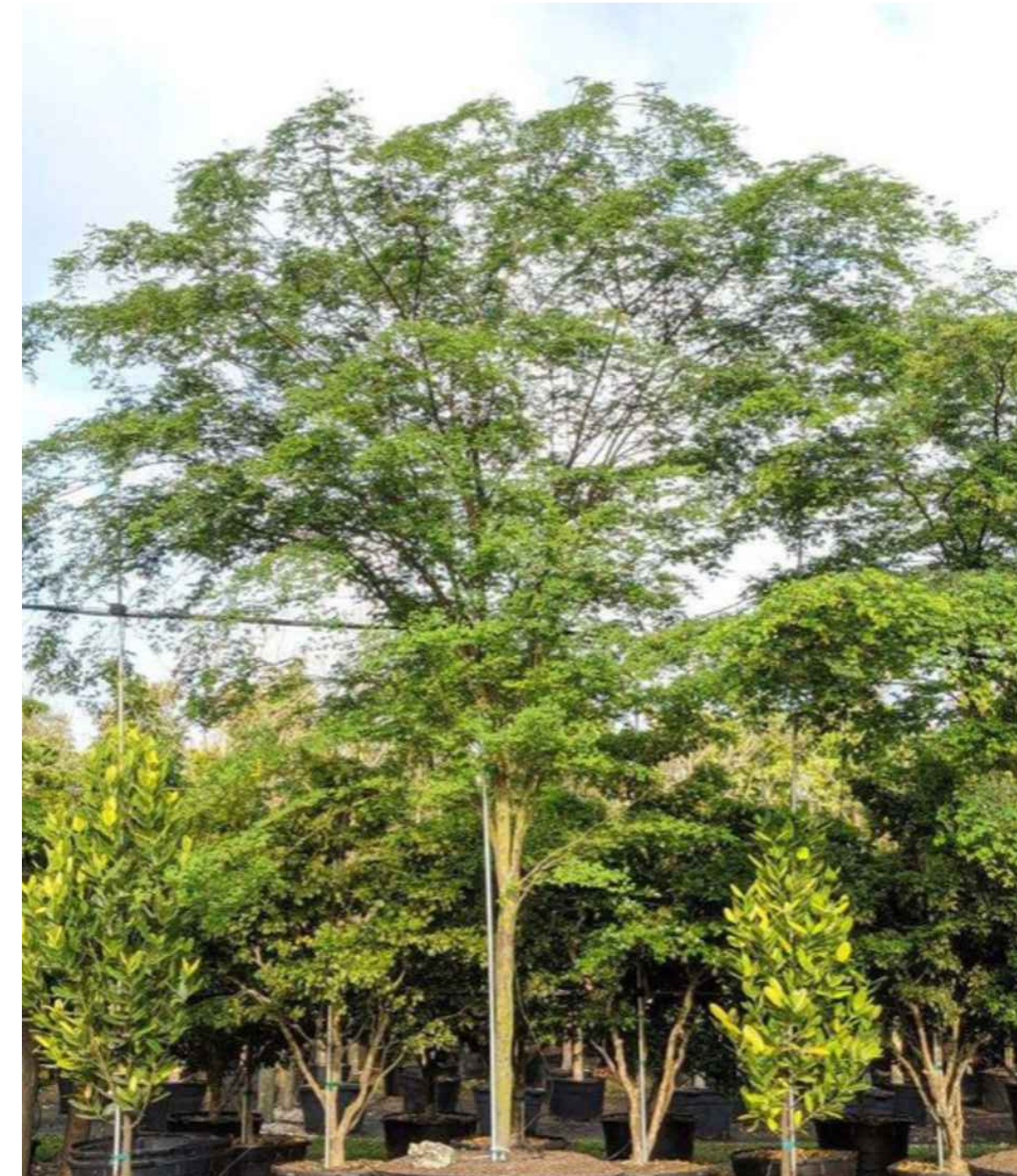

CG | BRIDAL VEIL
Caesalpinia granadillo



BA | VERAWOOD TREE
Bulnesia arborea

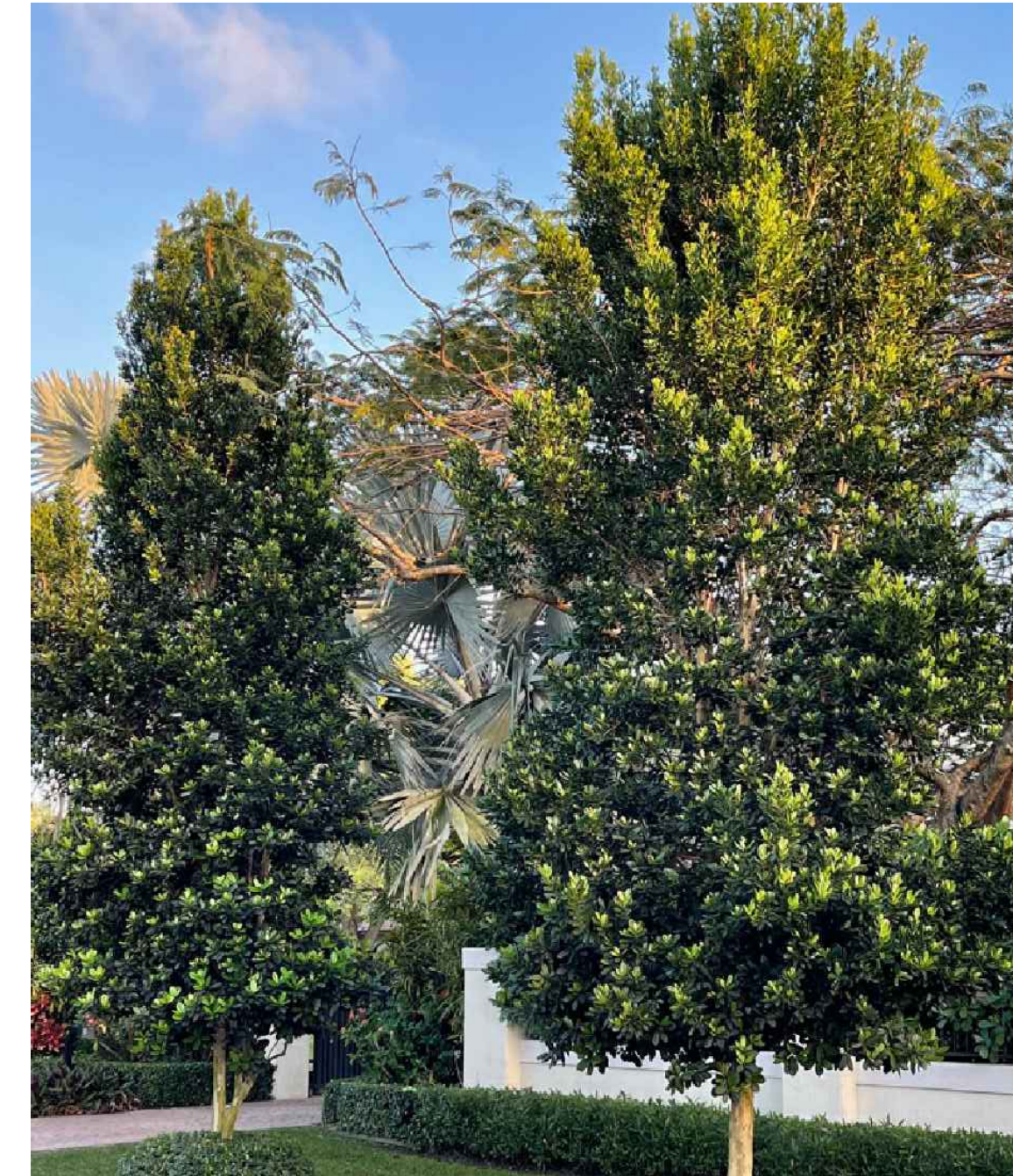

PR | BAY RUM TREE
Pimenta racemosa



MF | SIMPSON STOPPER TREE
Myrcianthes fragrans



EF | SPANISH STOPPER TREE
Eugenia foetida



SP | SABAL PALM
Sabal palmetto



TR | THATCH PALM
Thrinax radiata



DC | CABADA PALM
Dypsis cabadae



RX | LADY PALM
Rhapis excelsa

Rev.	Date	Rev.	Date
1		1	
2		2	
3		3	
4		4	
5		5	
6		6	
7		7	
8		8	
9		9	
10		10	
11		11	
12		12	
13		13	
14		14	
15		15	
16		16	
17		17	
18		18	
19		19	
20		20	
21		21	
22		22	
23		23	
24		24	
25		25	

ALL DRAWINGS AND WRITTEN MATERIAL APPEARING HEREIN CONSTITUTE THE ORIGINAL AND UNPUBLISHED WORK OF KOBİ KARP A.S. AND MAY NOT BE REPRODUCED, COPIED, OR OTHERWISE TRANSMITTED IN ANY FORM OR BY ANY MEANS WITHOUT THE EXPRESS WRITTEN CONSENT OF KOBİ KARP A.S. REVISED EDITION, NO. 01.14.24

ZONING PHASE

1709 JEFFERSON AVE
MIAMI BEACH, FL 33139

CHRISTOPHER
CRAWLEY
LANDSCAPE
ARCHITECTURE

CHRISTOPHER CRAWLEY, RLA
Florida License LA 96897976

Owner:
Name --
Address --
Address --
Tel: --
Email --

Consultant:
Name --
Address --
Address --
Tel: --
Email --

Consultant:
Name --
Address --
Address --
Tel: --
Email --

Consultant:
Name --
Address --
Address --
Tel: --
Email --

Consultant:
Name --
Address --
Address --
Tel: --
Email --

Consultant:
Name --
Address --
Address --
Tel: --
Email --

Consultant:
Name --
Address --
Address --
Tel: --
Email --

Architect:
Kobi Karp Architecture and Interior Design, Inc.
371 NW 25th STREET
Miami, Florida 33137 USA
Tel: +1(305) 573 1818
Fax: +1(305) 573 3766



KOBİ KARP
Lic. # AR0012578

PLANT MATERIAL IMAGES

Date:	01.14.24	Sheet No.	L4.00
Scale:			
Project:			

PLANT MATERIALS | ACCENTS, SHRUBS + GROUNDCOVERS



PSL | DWARF BAHAMA COFFEE SHRUB
Psychotria ligustrifolia



ZAP | COONTIE
Zamia pumila

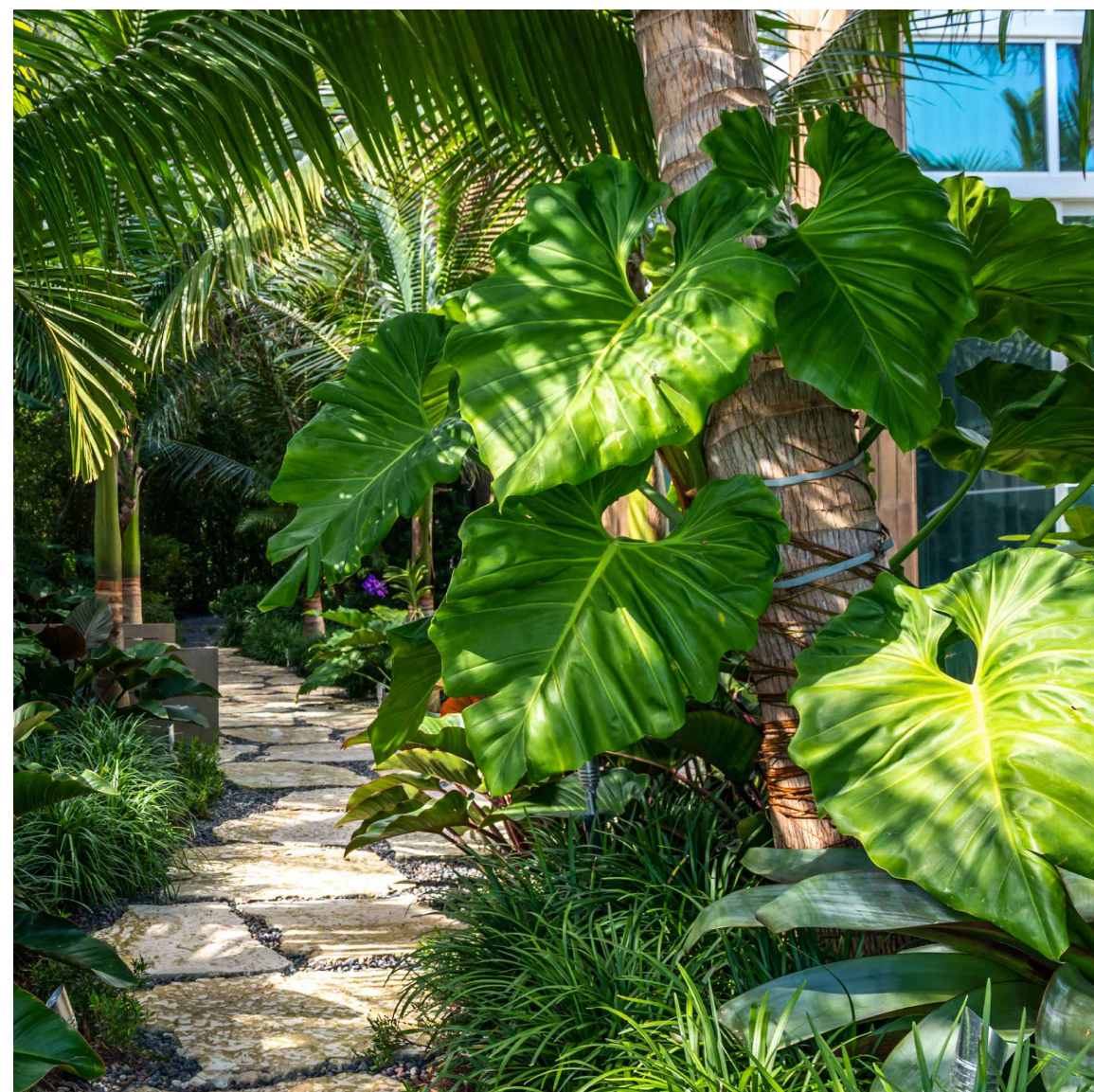

PHW | PHILODENDRON 'WILSONII'
Philodendron 'Wilsonii'



MOD | SWISS CHEESE PLANT
Monstera deliciosa



LIR | LIRIOPE
Liriope muscari 'Big Blue'

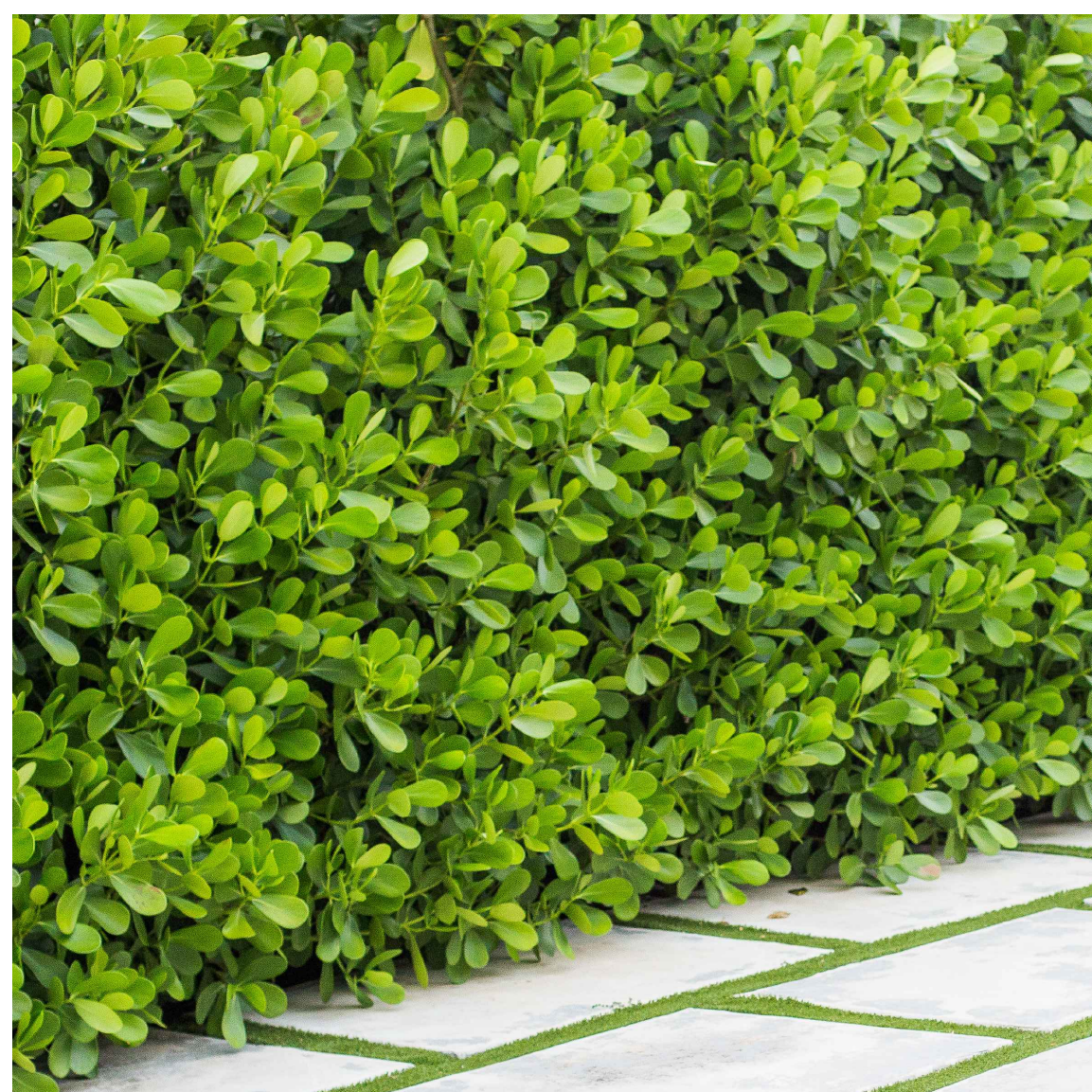

CLG | SMALL LEAF CLUSIA
Clusia guttifera



ALO | ELEPHANT EAR
Alocasia



SER | SILVER SAW PALMETTO
Serenia repens



MIC | WART FERN
Microsorium scolopendrium

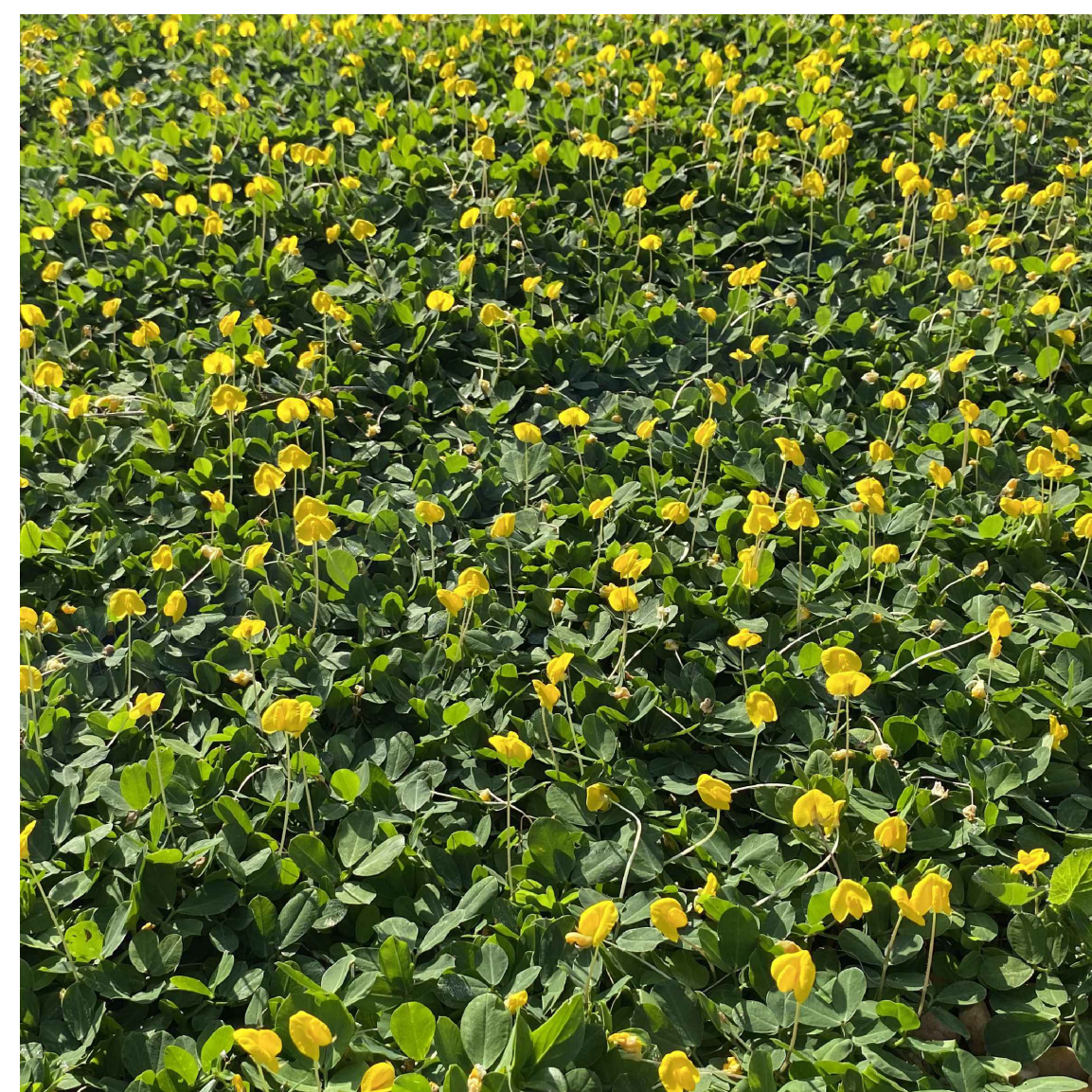

ARG | PERENNIAL PEANUT
Arachis glabrata



PRC | PHILODENDRON 'ROJO CONGO'
Philodendron 'Rojo Congo'



XAN | PHILODENDRON XANADU
Philodendron 'Xanadu'

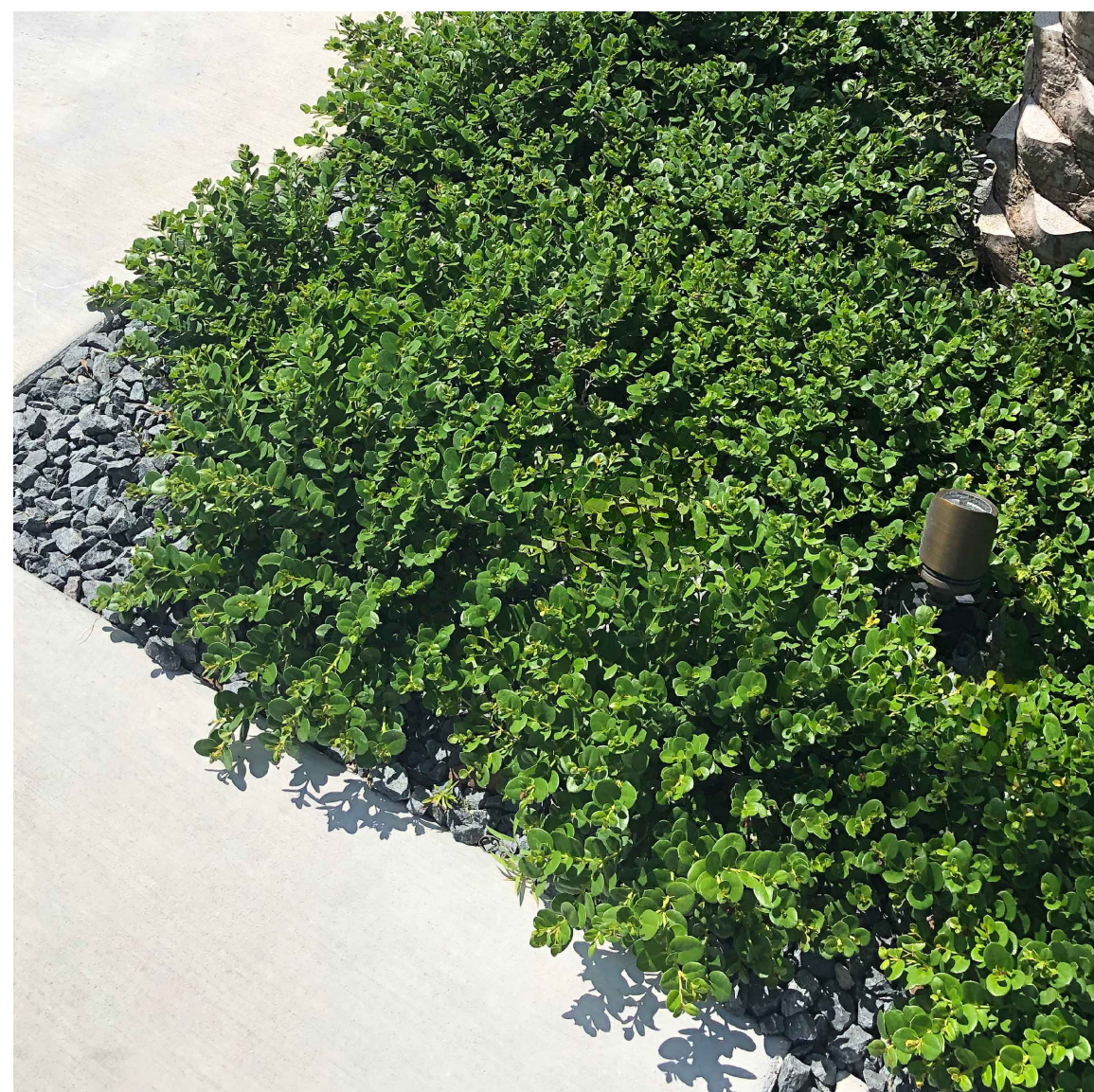

CAM | NATAL PLUM
Carissa macrocarpa



TRF | DWARF FAKAHATCHEE
Tripsacum floridana



ERL | GOLDEN BEACH CREEPER
Ernodea littoralis

Rev.	Date	Rev.	Date
1		1	
2		2	
3		3	
4		4	
5		5	
6		6	
7		7	
8		8	
9		9	
10		10	
11		11	
12		12	
13		13	
14		14	
15		15	

ALL DRAWINGS AND WRITTEN MATERIAL APPEARING HEREIN CONSTITUTE THE ORIGINAL AND UNPUBLISHED WORK OF KOBİ KARP AIA, AND MAY NOT BE REPRODUCED, COPIED, OR TRANSMITTED IN ANY FORM OR BY ANY MEANS, WITHOUT THE EXPRESS WRITTEN CONSENT OF KOBİ KARP ARCHITECTURE, INC. © 2018 KOBİ KARP ARCHITECTURE, INC. ALL RIGHTS RESERVED.

ZONING PHASE

1709 JEFFERSON AVE
MIAMI BEACH, FL 33139

CHRISTOPHER
CRAWLEY
LANDSCAPE
ARCHITECTURE

CHRISTOPHER CRAWLEY, RLA
Florida License LA 66667676

Owner:
Name --
Address --
Tel: --
Email --

Consultant:
Name --
Address --
Tel: --
Email --

Consultant:
Name --
Address --
Tel: --
Email --

Consultant:
Name --
Address --
Tel: --
Email --

Consultant:
Name --
Address --
Tel: --
Email --

Consultant:
Name --
Address --
Tel: --
Email --

Architect:
Kobi Karp Architecture and Interior Design, Inc.
371 NW 28th STREET
Miami, Florida 33137 USA
Tel: +1(305) 573 1818
Fax: +1(305) 573 3766



KOBİ KARP
Lic. # AR0012578

PLANT MATERIAL IMAGES

Date:	01.14.24	Sheet No.	L4.01
Scale:			
Project:			